



Microwave :UBCM44SS.1

Product reference code:UBCM44SS.1

Modified by:Eason

Modification:

00_2018.11.03 New document

UBCM44SS.1 Exploded drawing

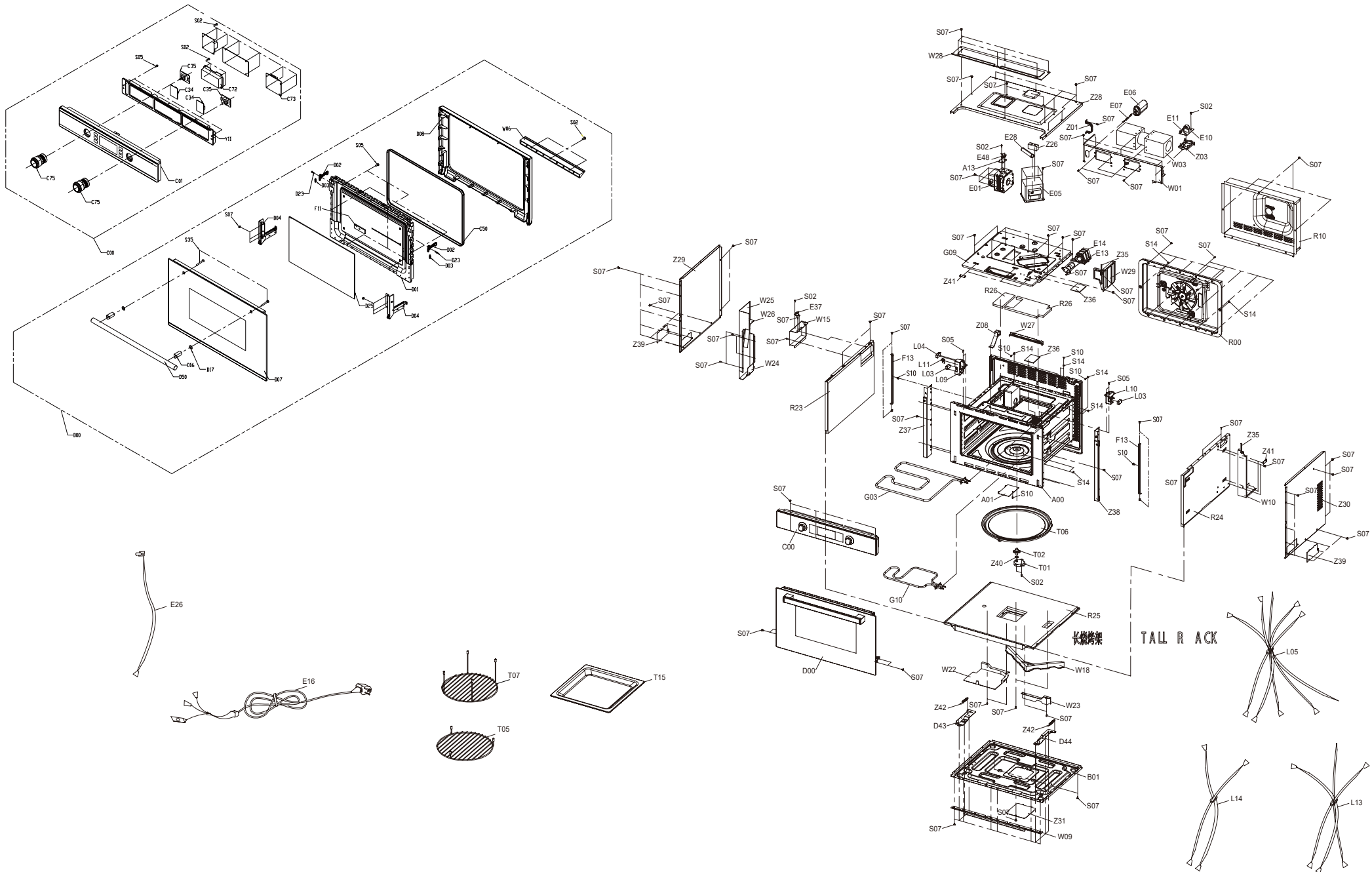

UBCM44SS.1 parts list

No.	Ref part code	factory Part Code	Part Name		Qty
A00	261500140500	12270000004732	Cavity Assembly	腔体组件	1
A01	262100100001	12570000000067	Wave Guide Cover	波导盖	1
A13	261502900400	122700000008133	Thermostat Bracket	温控器支架	1
B01	261501408702	122700000005158	Baseplate	底板	1
C00	69416735	17270000012550	Control Panel Assembly	控制盒组件	1
C01	261300285301	12170000002256	Control Panel	控制面板	1
C50	262101400106	126700000000041	Sealing Ring	密封圈	1
C75	291301000068	12171100000788	Knob Assembly	旋钮组件	2
D00	69416740	12270000B41863	Door Assembly	炉门组件	1
D01	261500200800	12270000002725	Door Frame Drop Glue Assembly	门体滴胶组件	1
D02	261300500202	122700000004651	Latch	金属门钩	2
D03	262010000100	129700000000385	Spring	弹簧	2
D04	263604100003	122700000006170	Hinge Assembly*L	铰链组件	1
D04	263604100004	122700000006183	Hinge Assembly*R	铰链组件	1
D07	69416730	12170000A14843	Door Drop Glue Assembly	门面滴胶组件	1
D08	261300601800	121700000009531	Door Gasket	门封	1
D23	261513900800	129700000000031	Door Shaft	门轴	2
D25	262101300028	125700000000025	Heat Insulation Glass	隔热玻璃	1
D50	261509403701	129700000000583	Handle	金属拉手	1
D16	261509403601	129700000000041	handle holder	金属拉手座	1
D17	262100800110	126700000000046	Rubber Gasket	橡胶垫	2
D43	261504500600	122700000008181	Hinge Bracket*L	铰链支架	1
D44	261504500500	122700000008182	Hinge Bracket*R	铰链支架	1
E01	261200100130	174700000000804	Magnetron	磁控管	1
E05	261200200050	174700000003522	H.V.Transformer	高压变压器	1
E06	251200701305	174700000000683	H.V.Capacitor	高压电容	1
E07	261200900020	174700000001007	H.V.Diode	高压二极管	1
E10+E11	263604400009	171700000002914	Noise Fliter Assembly	滤波板组件	1
E13	25108155	174700000009104	Integrated Lamp	一体化灯	1
E14	261514400101	122700000000202	Lamp Shade	灯罩	1
E16	261201003280	174700000000121	Power Cord	电源线	1
E26	256401001151	171700000004580	Sensor Assembly	传感器组件	1
E28	261203300130	174700000001561	H.V.Fuse	保险管	1
E33	62101150	174700000009112	Thermostat 160°C/95°C	突跳式温控器	1
E37	62101155	174700000009120	Thermostat 150°C/90°C	突跳式温控器	1
E48	261201300440	174700000001483	Thermostat 100°C/80°C	突跳式温控器	1
F11	261355300301	121700000003981	Bracket	隔墙支架	1
F13	261514104500	122700000008213	Fixing Bracket	固定支架	2
G03	261201700520	174700000001044	Heater	金属发热管	1
G09	263604000020	122700000003369	Heat Insulator Assembly	隔热板组件	1
G10	261201702380	174700000001085	Heater	金属发热管	1
L03	251201600974	174700000002315	Microswitch Interlock	微动开关	2
L04	25109030	174700000008424	Microswitch Monitor	微动开关	1
L05	261202808740	174700000001415	Main Wire Harness	线束	1
L09	25107685	121700000111191	Latch Board*L	联锁支架	1
L10	25107690	121700000111190	Latch Board*R	联锁支架	1
L11	261301100200	121700000007317	Interlock Lever	联锁杠杆	1
L13	261202700020	174700000001212	Main Wire Harness	线束	1
L14	261202802630	174700000001462	Main Wire Harness	线束	1
R00	253602160934	122700000005285	Convection Assembly	热风对流组件	1
R10	261505700100	122700000006280	Heat Insulator	隔热板	1
R11	262100600042	124700000000036	Heat Insulation Cotton*U	隔热棉	2
R23	263604000009	122700000003376	Heat Insulator Assembly*L	隔热板组件	1
R24	263604000010	122700000003361	Heat Insulator Assembly*R	隔热板组件	1
R26	262100600008	124700000000012	Heat Insulation Cotton	隔热棉	1
T01	261200300060	11002014000043	Synchronous Motor	同步电机	1
T02	262200100007	125700000000020	Ceramic Coupler	陶瓷驱动轴	1
T05	261511709200	129700000000284	Rack	烧烤架	1
T06	261512900104	122700000003329	Metal Turntable	金属转盘	1
T07	261511703000	129700000000324	Rack	烧烤架	1
W01	261517201300	122700000008243	Fixing Bracket	固定支架	1
W03	261200600080	11002017000177	Brushless DC Motor	罩极电机	1
W06	261302200600	121700000000657	Wind Guide	塑料导风件	1
W10	261503400200	122700000008437	Air Duct	导风板	1
W15	261503202500	122700000000160	Wind Guide Cover	金属导风罩	1
W18	261302200200	121700000000659	Wind Guide	塑料导风件	1
W22	261302200100	121700000000630	Wind Guide	塑料导风件	1
W23	261302200300	121700000000631	Wind Guide	塑料导风件	1
W24	261517700200	122700000008179	Guide Plate Bracket	导风板支架	1
W25	261503100400	122700000008466	Air Damper	挡风板	1
W26	261517700100	122700000008178	Guide Plate Bracket	导风板支架	1
W27	261504100100	122700000008446	Air Duct	导风板	1
W28	261517201500	122700000008147	Metal Bracket	支架	1
W29	261503400100	122700000008408	Air Duct	导风板	1
Y11	261563800200	122700000008170	Control Plate Bracket	控制板支架	1
Z01	261501500100	122700000006217	Capacitor Holder	电容器夹	1
Z03	261310600100	121700000009426	Filter Mounting Plate	滤波板安装板	1
Z08	251307500003	121700000003919	Wire Clamp	线夹	2
Z26	262100800092	126700000000047	Rubber Gasket	橡胶垫	1
Z28	261561200501	122700000005899	Cover	外罩	1
Z29	261561400101	122700000005841	Cover	外罩	1
Z30	261561500101	122700000005628	Cover	外罩	1
Z31	261518500100	122700000000203	Metal Cover	金属保护罩	1
Z35	261507700100	129700000000037	Wire Supporter	线架	2
Z36	262101700001	125700000000937	Lamp Glass	灯玻璃	2
Z37	261563500301	122700000008187	Front Plate Side Bracket	前板侧支架	1
Z38	261550800601	122700000005547	Front Plate Bracket	前板支架	1
Z39	261514200300	122700000003558	Mounting Plate	安装板	2
Z40	262200300001	121700000000070	Pad	垫片	1
Z41	262155600002	121700000007374	Sealing Cover	密封盖	5
Z42	262030200900	129700000000357	Spring*R	弹簧	1
Z42	262030200801	129700000000381	Spring*L	弹簧	1

UBCM44SS.1 Wiring diagram

DOOR CLOSE, COOK OFF

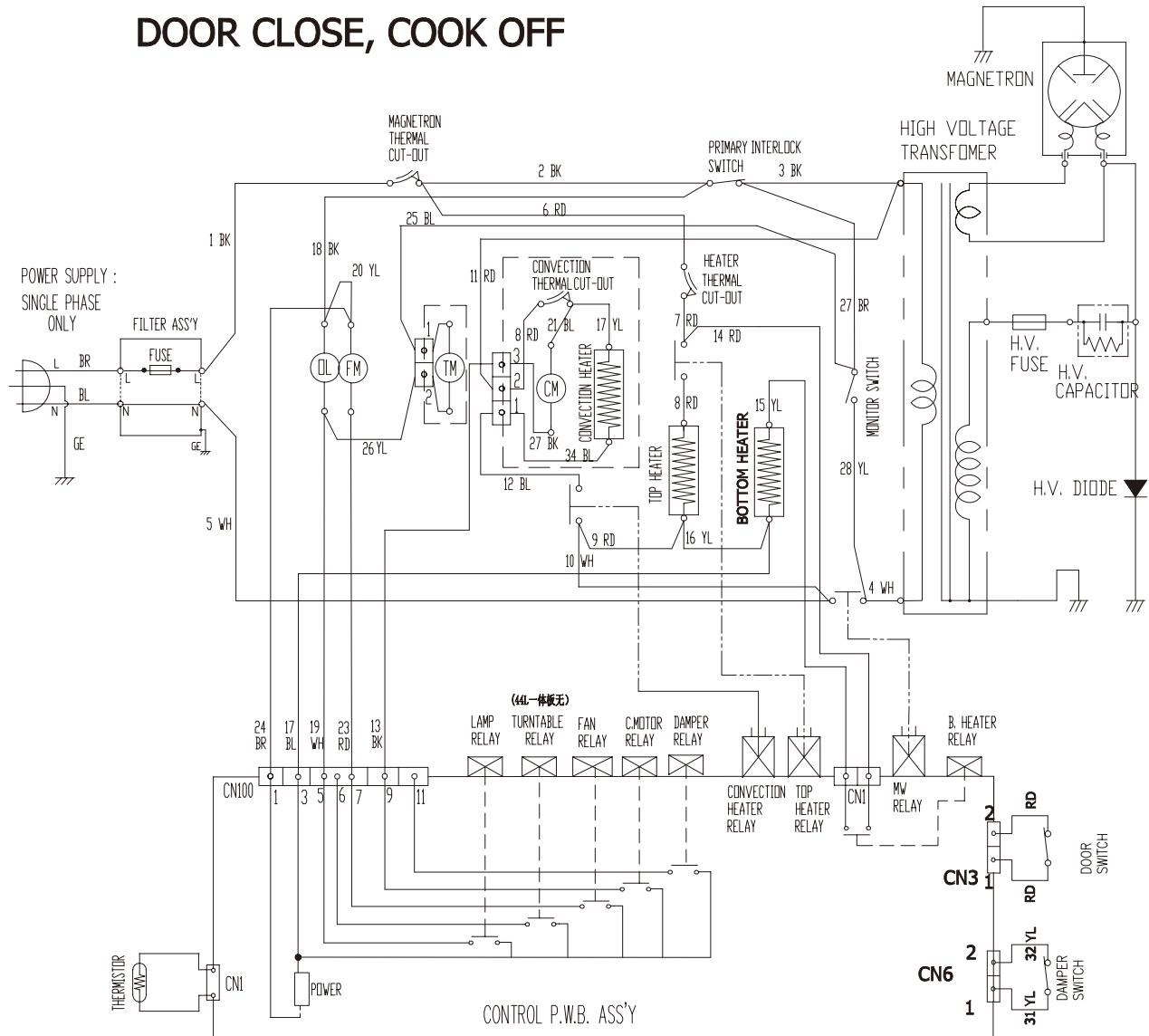

NOTE :

(DL) : OVEN LAMP

(FM) : FAN MOTOR

(CM) : CONVECTION FAN MOTOR

(TM) : TRAY MOTOR

(DM) : DAMPER MOTOR