

# Built-in Electric Oven

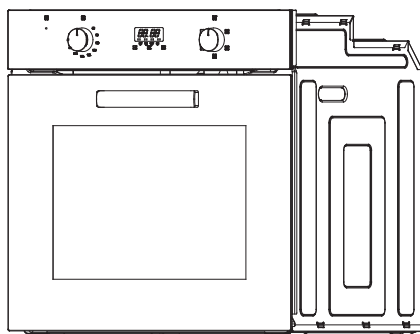

UBAS610SS  
UBAS609G



**WARNING:** Read the instructions before using the appliance.

## Checking instructions

These instructions are for your safety. Please read the following instructions carefully before proceeding with the installation and use of this appliance. Keep the instruction manuals for future reference.



**WARNING:** All installation work must be carried out by a suitably qualified person, strictly following local building regulations and these instructions.

To avoid the risks that are always present when you use an electrical appliance it is important that this oven is installed correctly and that you read the safety instructions carefully to avoid misuse and hazards. After unpacking the oven please check that it is not damaged. If in doubt, do not use the appliance but contact Customer Services on 0344 8001128.

Check the package and make sure you have all of the parts listed and decide upon the appropriate location for your product. If this product contains glass please take care with fitting or handing to prevent personal injury or damage to the product. The specification plate shown on this appliance displays all the necessary identification information for ordering replacement parts. If you sell the appliance, give it away, or leave it behind when you move house, please ensure that you pass on this manual so that the new owner can become familiar with the appliance and its safety warnings.

## Safety

All installation work must be carried out by a suitably qualified person, strictly following local building regulations and these instructions.

- ☒ **WARNING:** Ensure that the appliance is switched off at the fused spur before replacing the lamp to avoid the possibility of electric shock.
- ☒ **WARNING:** Accessible parts may become hot during use. Children should be kept away.
- ☒ **WARNING:** If the door or door seals are damaged, the oven must not be operated until it has been repaired. Contact Customer Services for advice.
- ☒ During installation do not allow the supply cord to touch the hot parts of the appliance.

- ☑ Make sure that the supply cord is not caught under or in the appliance and avoid damage to the supply cord.
- ☑ Do not install the appliance outdoors in a damp place or in an area which may be prone to water leaks such as under or near a sink unit. In the event of a water leak allow the machine to dry naturally. Do not use and contact Customer Services for advice.
- ☑ Please dispose of the packing material carefully.
- ☑ Do not use flammable sprays in close vicinity to the appliance.
- ☑ **WARNING:** This appliance can be used by children aged from 8 years and above and persons with reduced physical, sensory or mental capabilities or lack of experience and knowledge if they have been given supervision or instruction concerning use of the appliance in a safe way and understand the hazards involved. Children shall not play with the appliance.
- ☑ Cleaning and user maintenance shall not be made by children without supervision. Keep the appliance and its supply cord out of the reach of children less than 8 years old.
- ☑ If the supply cord becomes damaged, it must be replaced by the manufacturer, its service agent or similarly qualified persons in order to avoid a danger or injury.
- ☑ The appliance is not intended to be operated by means of an external timer or separated remote control system.
- ☑ The appliance is for domestic use only and only for cooking food. Do not use this appliance as a source of heat.
- ☑ The manufacturer declines all liability for personal or material damage as a result of misuse or incorrect installation of this appliance.

- ☒ Danger of burns! During use the appliance becomes hot. Care should be taken to avoid touching heating elements inside the oven.
- ☒ Do not lean on the door or place any objects on the door of the appliance. This can damage the door hinges.
- ☒ The oven must be installed in accordance with installation instructions and all dimensions must be followed.
- ☒ Before connecting the appliance to the power supply, check that the power supply voltage and current rating corresponds with the power supply details shown on the appliance rating label.
- ☒ Never use a damaged appliance! Disconnect the appliance from the electrical outlet and contact your retailer if it is damaged.
- ☒ Danger of electric shock! Do not attempt to repair the appliance yourself. In case of malfunction, repairs are to be conducted by qualified personnel only.
- ☒ To avoid damaging the cord, do not squeeze, bend or chafe it on sharp edges. Keep it away from hot surfaces and open flames.
- ☒ Lay out the cord in such a way that no unintentional pulling or tripping over it is possible. Keep the appliance and its cord out of reach of children.
- ☒ Do not operate the appliance with wet hands or while standing on a wet floor.
- ☒ Always turn the appliance off before disconnecting it from the power supply.
- ☒ Disconnect the oven from the power supply when not in use and before cleaning.
- ☒ **WARNING:** This appliance is supplied with a three core supply cord and must be connected direct to the mains electricity supply via a omni-polar or double pole switch having a 3mm minimum contact gap on each connector.

- ✓ The fused spur should be installed in an easily reachable place so that in case of emergency the appliance can be disconnected from power immediately.
- ✓ The fixed wiring must be protected against heat surfaces.
- ✓ Do not hang any objects on the handle of the oven door.
- ✓ **CAUTION:** Do not cover the bottom of the oven with aluminium foil or other objects. There is a risk of fire and damage to the enamel in the oven!
- ✓ Do not allow aluminium foil, plastic, paper or fabric contact with heating elements. Never leave the appliance unattended during use, especially when cooking with flammable substances (e.g. hot oil, fat, etc.).
- ✓ Do not store or never use harsh chemicals, sprays, flammable or non-food in or near the oven. This oven is designed specifically for heating or cooking food. The use of corrosive chemicals in heating or cleaning will damage the unit and may cause injury.
- ✓ Should any food inside the oven catch fire, keep the door closed. Switch the oven off and disconnect the power supply. Always exercise caution when opening the door.
- ✓ Move to the side, and open the door slowly to vent the hot air and/or steam. Make sure your face is away from the opening and make sure there are no children or pets near the oven.
- ✓ Only use utensils that are suitable for use in this type of oven.
- ✓ The oven should be cleaned regularly and any food deposits removed.
- ✓ Do not use harsh abrasive cleaners or sharp metal scrapers to clean the oven door glass. They can scratch the surface, which may result in shattering of the glass.
- ✓ A steam cleaner is not to be used.

- ☒ **WARNING:** The appliance and its accessible parts become hot during use. Care should be taken to avoid touching heating elements.
- ☒ Children less than 8 years of age shall be kept away unless continuously supervised.
- ☒ The appliance must not be installed behind a decorative door in order to avoid overheating.

# Let's get started...



## Getting **started...**

02

Checking instructions

02

Safety

02

Before you start

08



## In more **detail...**

09

Your product

09

Function &amp; Settings

10

Care and maintenance

13

Troubleshooting

16

Technical data

17

Recycling &amp; disposal

17



## Appendix

Installation

18

# Before you start

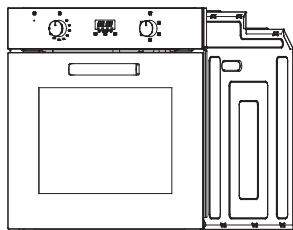

[01] x 1



[06] x 4



[05] x 4

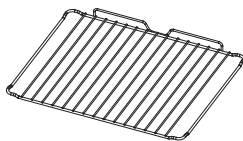

[02] x 1

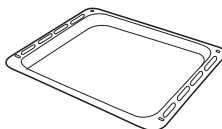

[04] x 1

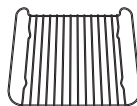

[03] x 1

To avoid the risks that are always present when you use an electrical appliance it is important that this appliance is installed correctly and that you read the safety instructions carefully to avoid misuse and hazards.

Please keep this instruction booklet for future reference and pass it on to any future owners. After unpacking the appliance please check that it is not damaged. If in doubt, do not use the appliance but contact the customer service helpline.

Check the package and make sure you have all of the parts listed.

Decide on the appropriate location for your product.

This product contains glass, please take care when fitting or handling to prevent personal injury or damage to the product.

If you sell the appliance, give it away, or leave it behind when you move house, make sure you also pass on this manual so that the new owner can become familiar with the appliance and its safety warnings.

**Note!** Before using the oven for the first time we recommend that the oven is switched on and set to its highest temperature. Keep the oven door closed and leave the appliance on for 1.5 hours with nothing in it.

Ensure adequate ventilation during this process by opening doors and windows in the room. Any odours created during this operation are due to the evaporation of substances used to protect the appliance during storage prior to installation.



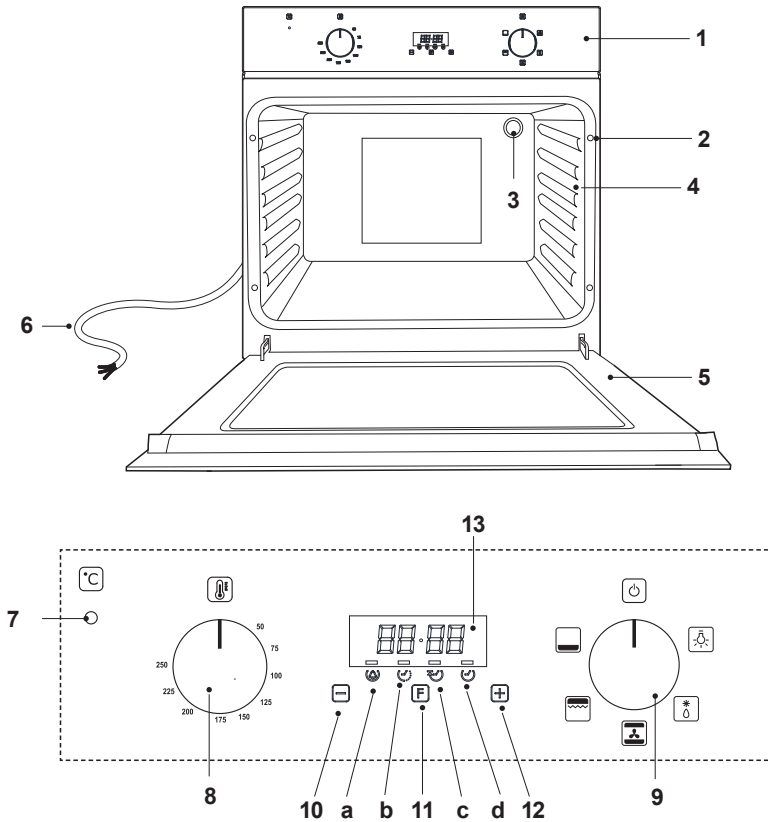

- |                             |                      |
|-----------------------------|----------------------|
| 1. Control panel.           | 2. Fixing openings   |
| 3. Oven lamp                | 4. Shelf level       |
| 5. Door                     | 6. Power cable       |
| 7. Temperature indicator    | 8. Temperature knob  |
| 9. Cooking mode knob        | 10. Reduce Minutes   |
| 11. Timer function selector | 12. Increase Minutes |
| 13. Display                 |                      |

Description of the timer functions:

- |                                     |   |
|-------------------------------------|---|
| a Warning alarm                     | b Cooking in automatic mode (duration)          |
| c End of cooking time (time at end) | d Setting the clock.Clock with 24-hour display. |

## Setting the clock

Once the appliance is connected to the power source, the display shows 12:00 and the ☺ indicator will flash until we enter the right time. The clock is now available for setting in 24-hour format.

To set the right time, press  $\square$  or  $\oplus$  to adjust. There is a 5-second lapse for acceptance during which no button must be touched. The rate of change will increase considerably a few seconds after the buttons have been depressed.

To change the clock time, we can press  $\text{F}$  4 times until the ☺ indicator flashes and set the correct time with  $\square$  and  $\oplus$ .



**WARNING:** any power cut cancels the programmed functions, including the clock. When the power supply returns, the ☺ indicator will flash and can be reprogrammed.

## Using the oven

The oven is controlled by a thermostat (8) between 50 °C and 250 °C, depending on the temperature required. The temperature indicator (7) turns on and off to indicate the temperature control during use.

The required cooking mode is selected using the multi-functional control button (9). The functions that may be selected are:

Icon	Function	Description
	Oven Light	The oven light will illuminate in the oven cavity. All other cooking modes are disabled. Note: The oven light also illuminates during all operation modes.
	Defrosting	Only the fan comes on and the food is thawed by ventilation without heat.
	Grill	Only the top heating element switches on. Heat is distributed by natural convection and this means that the top half of the oven is warmer than the bottom half. Food should be placed on a higher shelf if the food is to be crisped. It is recommended that the oven is preheated for 10-15 minutes before commencing cooking.
	Fan-Assisted Circular Element Mode	Provides uniform heating with the fan and allows different dishes to be cooked at the same time on different levels.
	Fan-Assisted Grill	This provides fast browning so that food remains juicy. For convection baking, this is the most energy-efficient function.

## Setting warning alarm

You have the possibility to set a timer to remind you to turn on the oven. You can also use this function as a kitchen timer to set a time frame for other tasks not necessarily related to this oven.

An independent audible signal that can be set to a maximum time of 23 hours and 59 minutes. To set the time, press **F** once. The alarm  indicator will flash for 5 seconds, during which time we can select the required time by pressing **-** and **+**. The countdown will start immediately. At the end of the time, the indicator will flash and an intermittent sound signal will be triggered, which can be interrupted by pressing **-**, **+** or **F**. If it is not stopped, it will do so automatically after 2 minutes.

To adjust the alarm time, press **F** once and repeat the above process. To cancel, press **F** and then **-** until the alarm timer becomes zero.



**Note!** The warning alarm does not control any of the oven functions.

## Setting Semi-automatic (Can use one of the following method.)

### (A) as per cooking time

This function is used to cook in the desired time range (up to 10 hours). Before using this function, ensure to: Place the food into the oven first, Set the desired cooking function and temperature.

By pressing **F** twice, set the cooking time using **-** and **+**. The cooking will start immediately and appear on the  indicator. At the end of the set time, the cooking will be interrupted and the intermittent sound signal will be heard. Cancel it as indicated above.

### (B) as per cooking end time

This function is used to cook in the desired end time (up to 10 hours). Before using this function, ensure to: Place the food into the oven first, Set the desired cooking function and temperature.

By pressing **F** three times, set the chosen cooking end time using **-** and **+**. The cooking will start immediately and appear on the  indicator. When the cooking time ends, the cooking will stop and the intermittent sound signal will be heard. Cancel it as indicated above.

To adjust the setting, press **F** three times and repeat the above process. To cancel, press **F** three times and then press **-** until the cooking end time is the same as the clock time.





**Note!** that the oven will continue to work after the end of the cooking process and when the alarm has been stopped. It must be turned off manually.

## Setting Automatic cooking

This function is used to cook for a certain duration and stop at a certain end time. Before using this function, ensure to: Place the food into the oven first.

### Start and end of cooking:

1. Programme the cooking time by pressing **F** twice and selecting the required time with **-** and **+**.
2. Set the end of the cooking time by pressing **F** 3 times and selecting the required time with **-** and **+**.
3. Select the required temperature and function using the thermostat controls and selector.

After these operations, the  and  indicators will continue to be shown on the display, showing that the oven has been programmed.

### Practical example:

We want to cook for 45 minutes and for the cooking to end at 2 p.m.

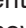
1. We press **F** twice and select 0.45 by using **-** and **+**.
2. We press **F** three times and select 14.00 with **-** and **+**.
3. After these operations, the current time will reappear on the display and the  and  indicators will show that our programming has been memorised.
4. At 1.15 p.m. (2 p.m. less 45 minutes), the oven will start automatically.
5. At 2 p.m. the cooking will stop automatically and the intermittent sound signal will be heard.
6. We can switch it off by pressing any button.



**Note!** that the oven will continue to work after the end of the cooking process and when the alarm has been stopped. It must be turned off manually.

The programming status can be seen at any time by pressing **F**. After programming finish, pressing any buttons will return the product to manual operation.

If warning alarm is used, the display will show warning alarm instead of the clock.

Owing that the cooking timer is according to the clock of the product, so the actual total time set by these functions may have variance up to a maximum of 59 seconds.

## Cleaning

Before cleaning or performing maintenance, disconnect the oven from the power supply.

To extend the life of your oven, it must be cleaned frequently, keeping in mind that:

- Do not use abrasive powders or corrosive substances which could ruin the surfaces.
- The inside of the oven should preferably be cleaned immediately after use, when it is still warm, with hot water and soap. The soap should be rinsed away and the interior dried thoroughly. Avoid using abrasive detergents (for example cleaning powders, etc.) and abrasive sponges for dishes or acids (such as lime scale remover, etc.) as these could damage the enamel. If the grease spots and dirt are particularly tough to remove, use a special product for oven cleaning, following the instructions provided with the product.
- If the oven is in use for an extended period of time, condensation may form. Once the oven has cooled, remove the condensation using a dry cloth.
- There is a rubber seal surrounding the oven opening which creates a heat seal. Check the condition of this seal on a regular basis. If necessary, clean it and avoid using abrasive products or objects to do so. Should it become damaged, please contact the customer services helpline. We recommend you avoid using the oven until it has been repaired.
- Never put aluminium foil or baking trays etc. on the bottom of the oven cavity, as the build up of heat could compromise cooking and even damage the enamel.
- Clean the glass door (5) using non-abrasive products or sponges and dry it with a soft cloth:
  1. Open the door (5).
  2. Clean all oven accessories with warm water or washing up liquid and polish dry with a soft clean cloth.
  3. Clean the oven interior with a soft clean cloth.
  4. Wipe the front of the appliance with a damp cloth.
  5. Let the oven and all accessories dry well.



**WARNING!** Always switch off the electricity supply before carrying out maintenance work on the oven. In the event of a fault, contact customer services.



**WARNING!** Ensure that the appliance is switched off and completely cool before replacing the lamp to avoid the possibility of electric shock or burns.

## Oven cleaning system equipped with the AQUASMART SYSTEM

1 Take out the internal components: tray, screen, side screens.

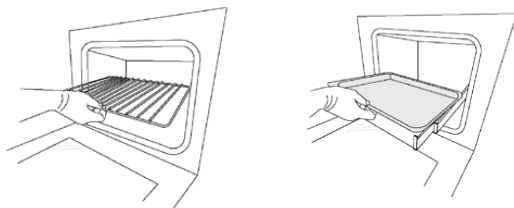

2. Pour 200 ml of soapy water on the bottom of the oven.

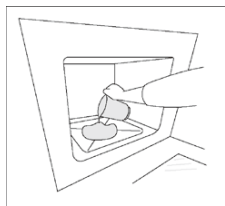

3. Turn on  and set the oven at 200° for 15 minutes

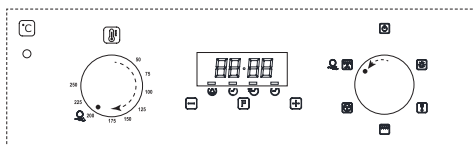

4 Move the temperature control from 200°C to 0°C. Let the oven cool down for 20 minutes.

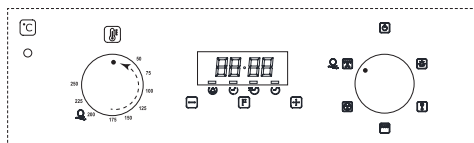

5 Move the AquaSmart function to 0. Wipe clean with a rag or soft cloth.

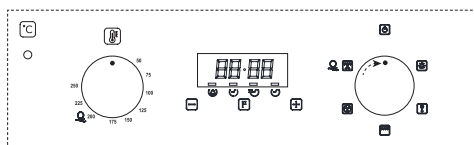

## Replacing the oven light bulb

Remove all pans and grills from inside the oven to easily access the lamp cover (3). Unscrew the glass cover and remove the old lamp. Dispose of it safely and ecologically. Insert a new G9 halogen lamp into the lamp holder.

**Note:** Please do not handle the lamp with bare skin to avoid reducing its life. Use a cloth or tissue. Replace the lamp cover.

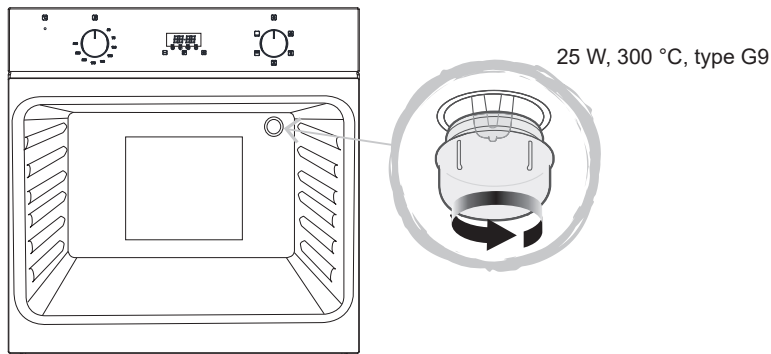

## Removing the Door From the Oven

To simplify cleaning interior of the oven, the door (5) can be removed. Follow below steps to do so:

1. Open the door (5) fully to position "A".
2. Lift the two mobile links of the hinges to position "B".
3. Close the door (5) to the half-way position.
4. Lift the door (5) upwards and remove it by sliding the hinges outwards. Hold the door (5) by the sides close to the hinges when doing this.
5. After cleaning, replace the door (5) in the reverse order.

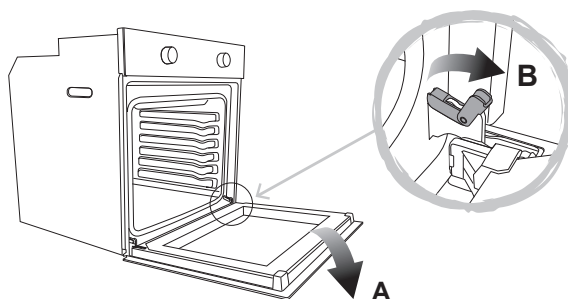

# Care and maintenance

## Removing the Inner Glass for Cleaning

To simplify cleaning, the Inner glass panel can be removed.

After loosening 2 screws fixing the side supports of the glass, remove the supports and then the glass panel.

Handle with care!

After cleaning, replace the glass panel in the reverse order.

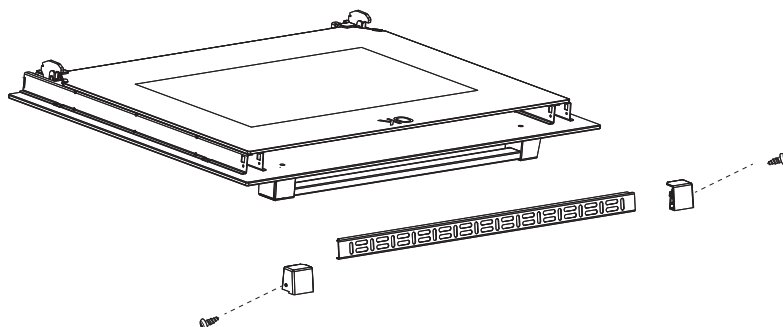

## Trouble shooting

FAQ	Solution
What should I do if the oven does not heat up?	<p>Check to see if one of the following actions resolves the issue:</p> <p>The oven may not be switched on. Switch on the oven.</p> <p>Check to see if the required settings have been applied.</p> <p>A household fuse may have blown or a circuit breaker may have tripped. Replace the fuses or reset the circuit. If this happens repeatedly, call the Service Centre.</p>
What should I do if, even though the oven function and temperature have been set, the oven does not heat up?	<p>There may be problems with the internal electrical components.</p> <p>Call the Service Centre.</p>
What should I do if I cannot change the set temperature?	Make sure to have used the temperature knob
What should I do if the oven light does not illuminate?	The oven light is faulty. Replace the oven light bulb
The grill does not heat up properly?	The grill power is set too low. Turn the temperature control to a higher temperature.



## Technical data

The manufacturer declines all liability for damage caused to persons and objects due to incorrect or improper installation of the appliance.

Supply voltage	220-240V~50/60Hz
Maximum Power	2000-2380W

Item	Symbol	Value Declared	Unit
Model identification	UBAS610SS & UBAS609G		
Type of oven	Single fan oven		
Mass of the appliance	M	25	kg
Number of cavities		1	
Heat source per cavity (electricity or gas)	Electricity		
Volume per cavity	V	60	L
Energy consumption (electricity) required to heat a standardised load in a cavity of an electric heated oven during a cycle in conventional mode per cavity (electric final energy)	EC electric cavity	0.74	kWh/cycle
Energy consumption required to heat a standardised load in a cavity of an electric heated oven during a cycle in fan-forced mode per cavity (electric final energy)	EC electric cavity	0.84	kWh/cycle
Energy Efficiency Index per cavity	EEl cavity	90.2	
The measurement and calculation method of the above table was done in accordance with commission regulation (EU) No 65/2014 & 66/2014.			

## Recycling & disposal

Waste electrical products (WEEE) should not be disposed of with household waste.

Please recycle where facilities exist. Check with your local governmental authority, domestic waste disposal services or the retailer where the product was bought for recycling advice.

The wheelie bin symbol on the product or its packaging indicates that this product cannot be treated as normal household waste. This product must be handed over to an electric and electronic equipment collection point for recycling. On ensuring that this product is disposed of correctly, you will help to avoid possible negative consequences for the environment and public health, which could occur if this product is not handled correctly.



# Installation

All installation must be carried out by a competent person or qualified electrician. Before connecting the mains supply ensure that the mains voltage corresponds to the voltage on the rating plate.

## 1.Plug connection

This appliance is equipped with a plug(conforming to BS1363) fitted with a 13 amp fuse.Should the fuse fail, then it must bereplaced with an ASTA approved fuse (conforming to BS1362) of the same rating.

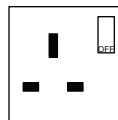

## 2.Direct Connection(If no plug)

This appliance must be connected directly to the mains using an omnipolar circuit breaker with a minimum opening of 3 mm between contacts.

The installer must ensure that the correct electrical connection has been made and that it complies with the wiring diagram.

The cable must not be bent or compressed.

Regularly check the power cord for damage. If the supply cord is damaged, it must be replaced by a special cord or assembly available from the manufacturer or its service agent.

**WARNING: This is a Class I appliance and MUST be earthed.**

This appliance is supplied with a 3 core mains cable coloured as follows:

Brown = L or Live

Blue = N or Neutral

Green and Yellow = E or Earth 

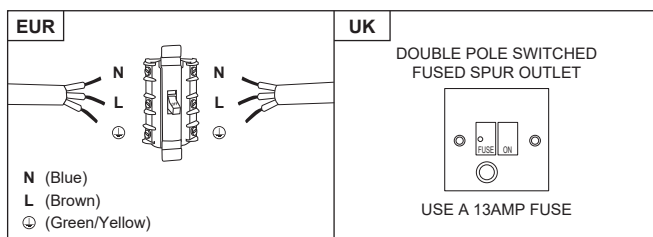

**The fuse must be rated at 13 Amps.**

To avoid the risks that are always present when you use an electrical appliance it is important that this appliance is installed correctly and that you read the safety instructions carefully to avoid misuse and hazards. Please keep this instruction booklet for future reference and pass it on to any future owners. After unpacking the appliance please check that it is not damaged. If in doubt, do not use the appliance but contact Customer Services.

The manufacturer declines all liability for damage caused to persons and objects due to incorrect or improper installation of the appliance. Any permanent electrical installation must comply with the latest wiring regulations applicable to your country and for your own safety a qualified electrician or contractor should undertake the electrical installation.

01

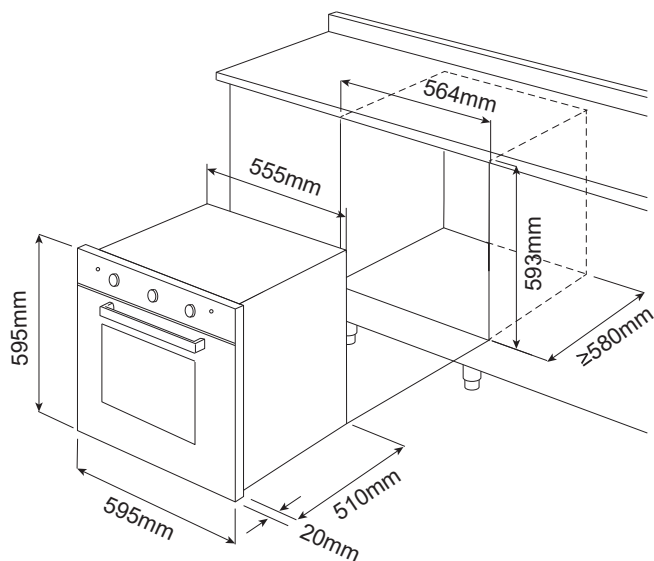

02

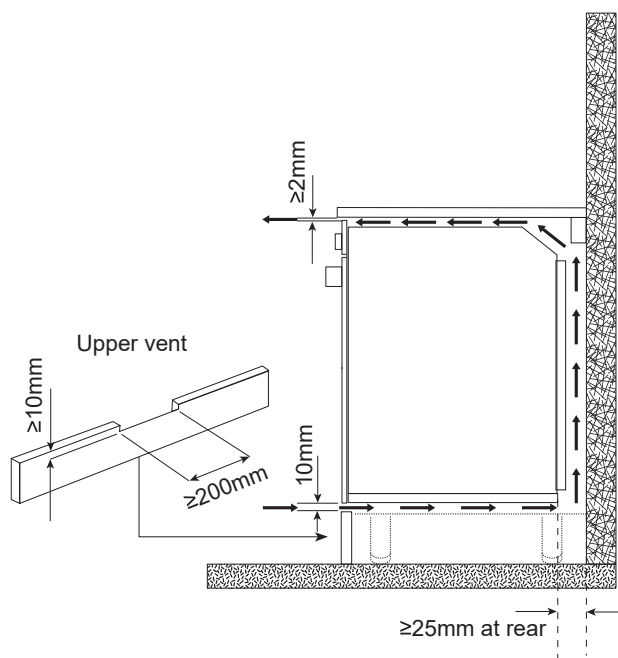

03

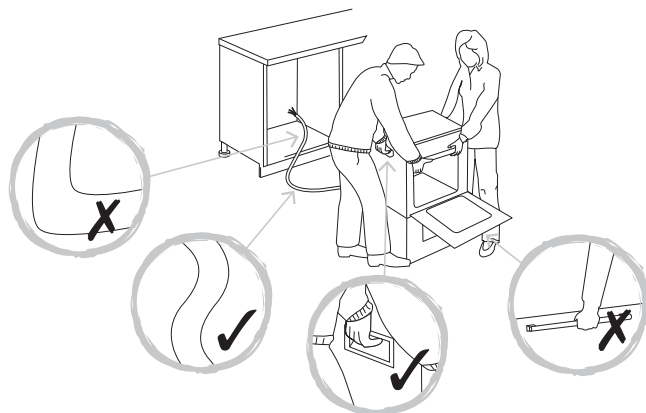

04

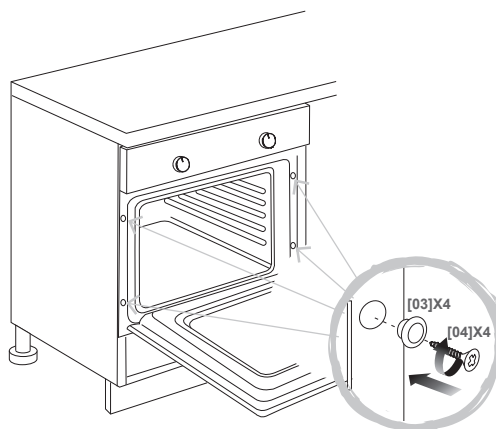

05

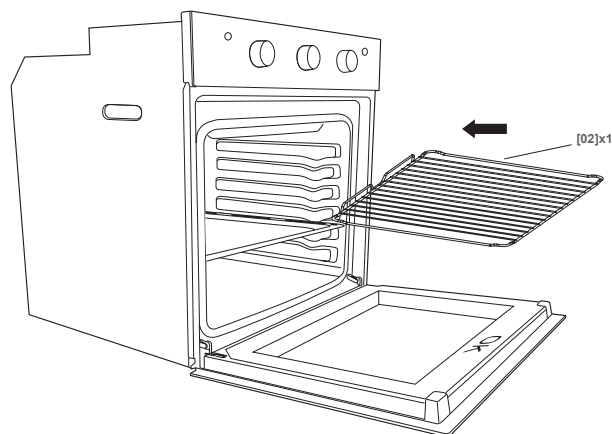

AAUK Ltd,  
Unit 3 Normandy Landings,  
Pope Street,  
Castleford,  
WF6 2AG