



Microwave Oven:AMC35SS

Version:00

Date:2014-05-23

AMC35SS Exploded drawing

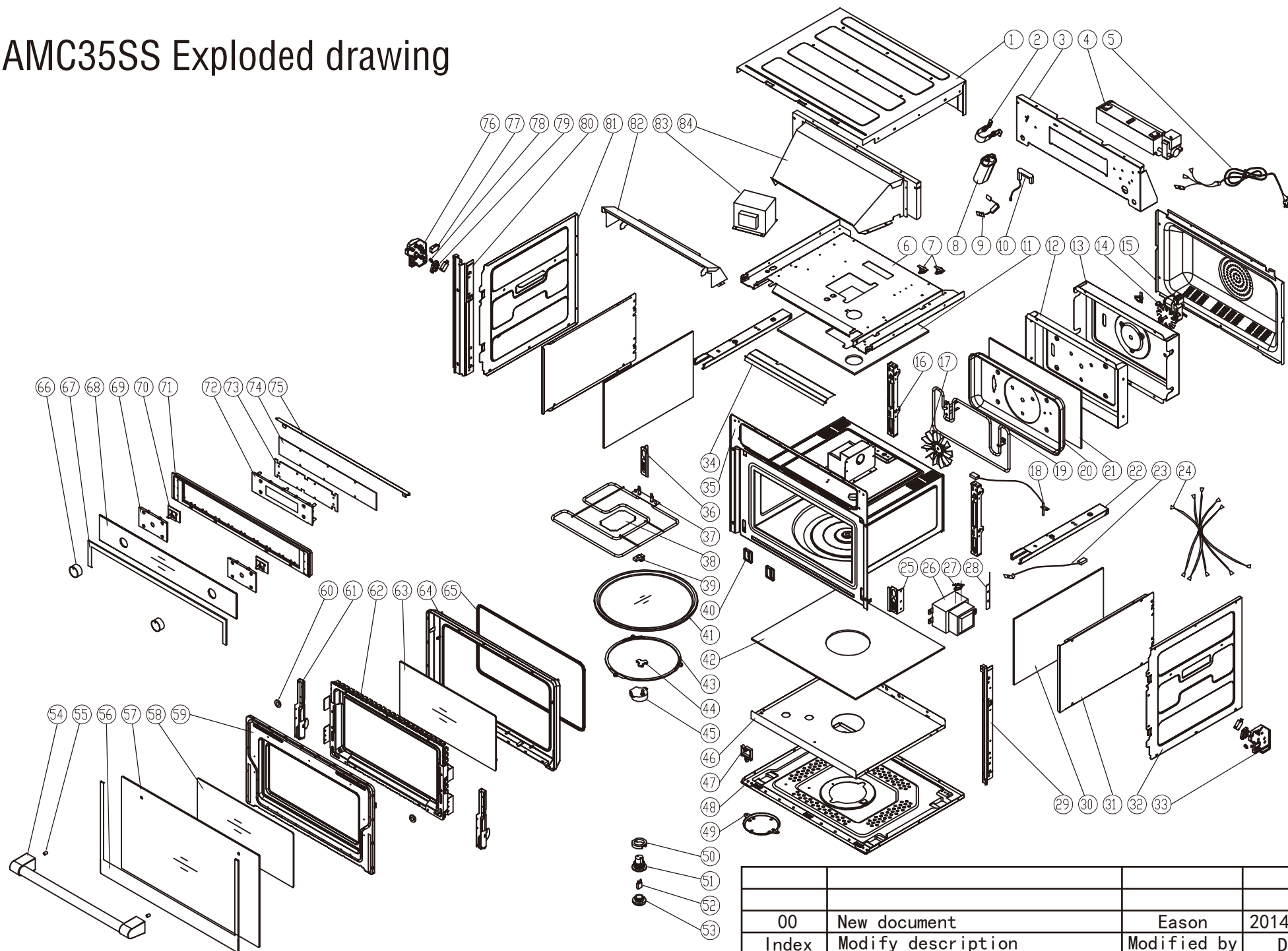

00	New document	Eason	2014. 5. 23
Index	Modify description	Modified by	Date

AMC35SS parts list

NO.	Part code	part description	Quantity
1	34021001	The top cover plate	1
2	34006001	Capacitor Holder	1
3	34005001	Rear Fixed Plate	1
4	34161001	cooling fan assy	1
5	34163002	Power cord	1
6	34004001	the upper Fixed Plate	1
7	36154001	110℃ Thermostat	2
8	34154001	H.V Capacitor	1
9	34157001	H.V Diode	1
10	34155002	H.V Fuse	1
11	34315001	Heat Preservation Fibre	1
12	33503001	Mid back plate for Cov	1
13	33502001	Outer back plate for Cov	1
14	33315016	Cov fan assy	1
15	33501001	The rear cover plate	1
16	34016001	Cavity Rear Fixed	2
17	33315016	Cov fan assy	1
18	33323003	Temperature Probe	1
19	34159002	Rear Heater	1
20	33504001	Inner Plate for Cov	1
21	33546001	Rear Heat Preservation Fibre	1
22	34001001	Guide Air Bracket	2
23	34165001	Temperature Sensor	1
24	34162003	Internal wiring	1
25	34008001	Right Hinge Bracket	1
26	34150001	Magnetron	1
27	34152001	Thermostat	2
28	34027001	block wind plate	1
29	34012002	Right Strengthen Plate	1
30	36102001	Side Heat Preservation Fibre	2
31	36005001	Side Heat Preservation Plate	2
32	34022001	Right side cover plate	1
33	34206001	Right Lock bracket	1
34	34002001	Guide Air plate(1)	1
35	34505004	Cavity assy	1
36	34007001	Left Hinge Bracket	1
37	34159001	Heater	1
38	34316001	Mica	1
39	34318001	Heater Holder	1
40	34209001	decoration ring	2
41	34313001	Glass tray	1
42	33518001	Bottom Heat Preservation Fibre	1
43	34317001	Tray guide assy	1
44	34308001	Coupler	1
45	34156001	rotating tray motor	1
46	36003001	Bottom Heat Preservation Plate	1
47	31051002	Wire Holder	2
48	34019001	Base Plate	1
49	34018001	rotating tray motor cover	1
50	34160001	Locknut	1
51	34160001	Lamp Holder	1
52	34160001	Lamp	1
53	34160001	Lamp Cup	1
54	33190007	1#handle	1
55	34203001	Handle Washer	2
56	34040001	Door Decorative Piece	1
57	34301004	Door glass(out)	1
58	34303001	Door glass(middle)	1
59	34202001	Door bracket	1
60	20302021	Metal Washer	2
61	34312001	Hinge(#8)	2
62	34502003	Metal Door assy	1
63	36043001	Door glass(inner)	1
64	34201001	Gasket Door	1
65	36115001	door seal	1
66	32244031	21#knob	2
67	34039003	Control Panel Decoratvie Piece	1
68	34304016	Control Panel Glass	1
69	36210004	Switch Bracket	2
70	36150004	Encode Swtich	2
71	36206001	Panel Bracket	1
72	36207003	Display Bracket	1
73	34208026	Display PCB	1
74	34207007	Power PCB	1
75	34014002	Top Strengthen Plate	1
76	34204001	Left Lock bracket	1
77	34164001	Micro Switch	3
78	34319001	Interlock Sping	2
79	34205001	Lever Switch	2
80	34010002	Left Strengthen Plate	1
81	34023001	left side cover plate	1
82	34003001	Guide Air plate (2)	1
83	34153001	H.V.Transformer	1
84	34024001	Guide Air Assy	1