



Double oven:AMF72BK

Version:01

Date:2015-06-12

Product reference code:AMF72BK

AMF72BK Exploded drawing

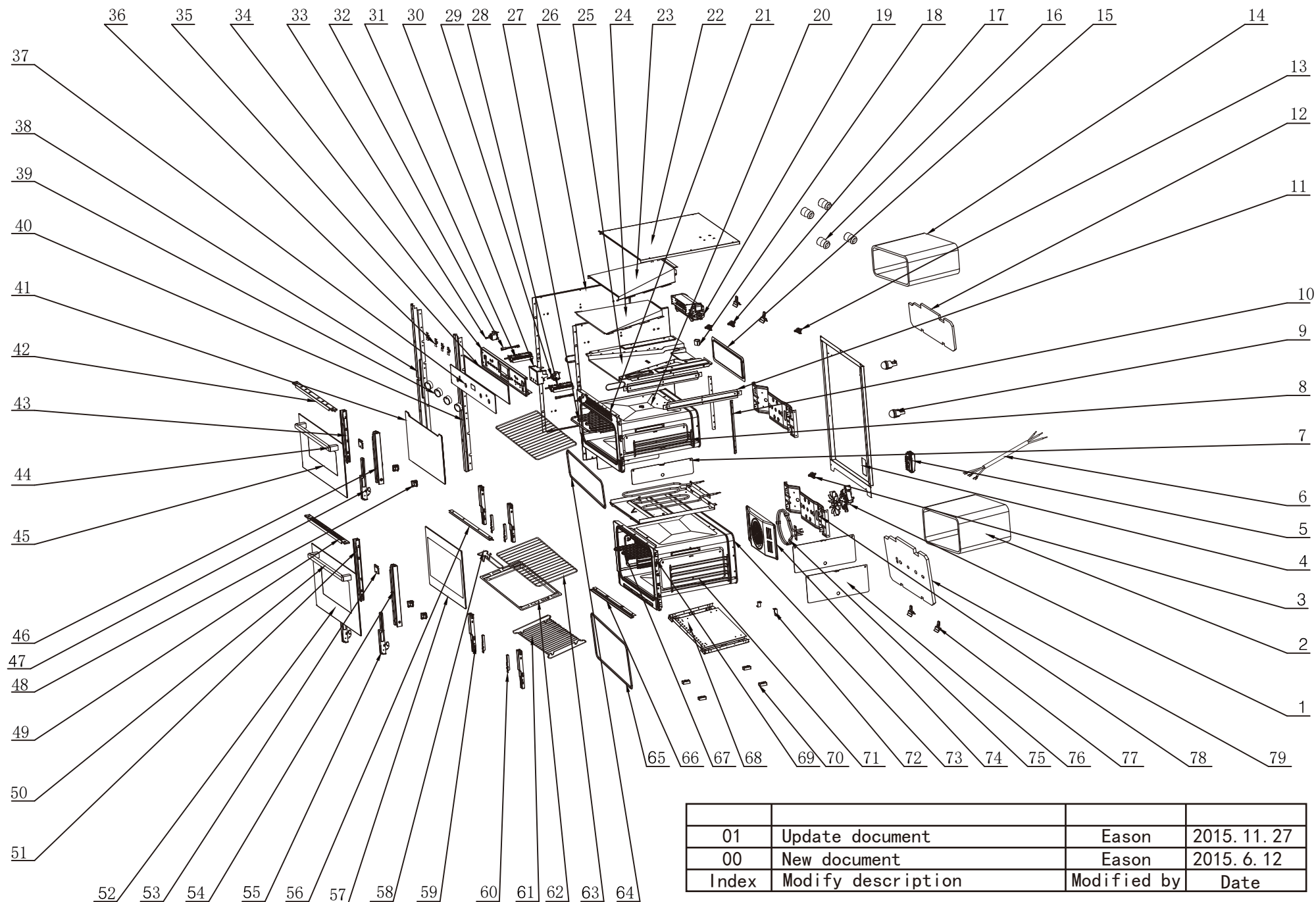

01	Update document	Eason	2015. 11. 27
00	New document	Eason	2015. 6. 12
Index	Modify description	Modified by	Date

AMF72BK parts list

No.	part code	Part description	chinese description	Qty	Remark
1	33315002	grill fan assembly	循环风机组件	1	
2	33120002	heat preservation fibre	内胆圈保温纤维（下）	1	
3	36154001	Thermostat 110℃	温控器 SF1-068 110℃	1	From June 2015 to start using
	33311013	overheat protector (290℃)	290℃限温器	1	From June 2015 to stop using
4	33030021	back cover board	外壳后盖板-AD-K25(C)-09	1	
5	33005016	terminal box	接线盒-AD-K25(A)-22	1	
6	32307016	power cord-European style	无头-1.5米-H05VV-F 头部3个鳄鱼齿	1	
7	33039015	side rack panel	导轨支架垫板-AD-K25(B)-06	2	
8	33140011	side rack	左右导轨支架-AD-K25(B)-12	2	
9	33302002	lamp assembly	灯头组件	2	
10	33027012	connect board for top and bottom cavity	上下内胆连接板-AD-K25(A)-11	2	
11	33027014	fixing panel for exhausting pipe base board	排烟道底板固定板-AD-K25(A)-13	2	
12	33121002	heat preservation fibre	底盖保温纤维（上）	1	
13	33308027	over heat protector 100℃	过热保护器-100℃	1	From June 2015 to start using
	33311013	overheat protector (290℃)	290℃限温器	1	From June 2015 to stop using
14	33120002	heat preservation fibre	内胆圈保温纤维（上）	1	
15	33001037	back catalytic line	背部易洁板-AD-K25(B)-07	1	
16	33141002	guide rail bracket fixing axis	导轨支架固定轴	4	
17	33310003	heat dissipation thermostat	45℃散热温控器	2	
18	33215013	exhausting pipe	排烟筒-AD-K25(B)-05	1	
19	33313020	cooling fan assembly	散热风机组件（双排气）	1	
20	33058060	top cavity assembly	内胆组件（上）-AD-K25(B)-20-00	1	
21	33018113	cavity panel	内胆面板(上)-AD-K25(B)-20-01	1	
22	33031014	top cover plate	外壳上盖板-AD-K25(A)-01	1	
23	33028004	exhausting pipe top cover board	排烟道上盖板-自洁烤箱专用	1	
24	33026004	exhausting pipe middle cover board	排烟道中盖板-自洁烤箱专用	1	
25	33027002	exhausting pipe base board	排烟道底板-自洁烤箱专用	1	
26	33033017	side plate (left&right)	外壳左右侧板-AD-K25(C)-06	2	
27	33303006	top heating element	顶层电热管	1	
28	33301035	function switch	档位开关（5功能）	1	
29	33311018	temperature adjuster	温控开关-K25(A)-21	1	
30	33300011	sensor touch timer (3 button)	三键定时器（红色）-触摸	1	
31	33301034	function switch	档位开关（4功能）	1	
32	33312001	indicator light	指示灯	2	
33	33311007	temperature adjuster	温控开关-900*480烤箱专用	1	
34	33018148	fixing panel for switch	开关面板固定板-AD-K25(C)-05	1	
35	90134002	single adhesive tape	黑色单面胶		
36	33006001	connect board switch	开关固定连接板	4	
37	33101464	control panel assembly	开关面板（4功能-5功能）三键触摸-AD-K25(C)	1	
38	33014092	left bracket for out cover plate	外壳左支架-AD-K25（C）-07	1	
39	32244048	knob.21	21号旋钮	4	
40	33014093	left bracket for out cover plate	外壳右支架-AD-K25（C）-08	1	
41	33103023	inner glass(top door)	内玻璃-上（镀膜）-AD-K25(B)-10-02	1	
42	33014087	door frame top bracket	门上支架(前面开孔)-AD-K25(A)-10-01	1	
43	33014080	door frame left bracket	门框左支架-AD-K25(B)-10-04	1	
44	33190007	hand H1	1号拉手	1	
45	33102370	door panel	门面板-AD-K25(B)-10-01	1	
46	33014079	door frame right bracket	门框右支架-AD-K25(B)-10-05	1	
47	33180018	hinge 12	铰链组件-12号铰链	2	
48	33014049	fixing panel for inner glass	内玻璃左下固定块	2	
	33014050	fixing panel for inner glass	内玻璃右下固定块	2	
49	33014250	top bracket for oven door	门上支架-PN-K15(A)-20-01	1	
50	33190007	hand H1	1号拉手	1	
51	33014084	door frame left bracket	门框左支架-PN-K25(C)-10-03	1	
52	33102418	door panel	门面板-AD-K25(C)-10-01	1	
53	33006012	fixing board for handle	拉手固定板	2	
54	33014083	door frame right bracket	门框右支架-PN-K25(C)-10-04	1	
55	33180019	hinge 3 assembly	铰链组件-13号铰链	2	
56	33027015	cavity panel connector	内胆面板连接板（前）-AD-K25(A)-09	1	
57	33103029	inner glass	内玻璃(镀膜)-AD-K25（C）-10-02	1	
58	33172001	handle for rack	搁架抓手	2	
59	33024006	side bracket for cavity(left&right)	内胆左右支架-AD-K25(A)-05	2	
60	33005014	fixing board for hinge	铰链固定板-AD-K25(A)-06	4	
61	33170003	Tray-shallow	烤盘架(浅)	1	
62	33224003	baking tray	油脂收集盘	1	
63	33170001	grill rack	搁架	2	
64	33803013	door seal assembly	门封条组件-K25（B）	1	
65	33803014	door seal assembly	门封条组件-K25（C）	1	
66	33027016	bottom support for cavity panel	内胆面板下支撑-AD-K25(A)-12	2	
67	33303009	top heating element	顶层电热管-5功能	1	
68	33029015	bottom cover plate	外壳底板-AD-K25(A)-03	1	
69	33018149	cavity panel	内胆面板(下)-PN-K25(C)-20-01	1	
70	33237030	the support for bottom cover plate	底板支撑块-PN-K24-08	4	
71	36038003	side rack	导轨支架 AD-K25(C)-01	2	
72	33006063	the bottom support for cavity	内胆下支撑-AD-K25(C)-13	2	
73	33058062	cavity assembly	内胆组件（下）-AD-K25(C)-20-00	1	
74	33001022	the cover plate for back heating element	背部电热管挡板-2(PN-K14-06)	1	
75	33303040	rear element	背部电热管-PN-K14-12	1	
76	33540001	side rack panel	导轨支架垫板 AD-K25(c)-02	2	
77	33035001	thermostat switch sensor fixer	温控开关探头固定夹	10	
78	33016001	back bracket for cavity	内胆后支架	2	
79	33121002	heat preservation fibre	底盖保温纤维（下）	1	