



Double oven:AMF72VSS

Version:01

Date:2015-12-03

Product reference code:AMF72VSS

AMF72VSS Exploded drawing

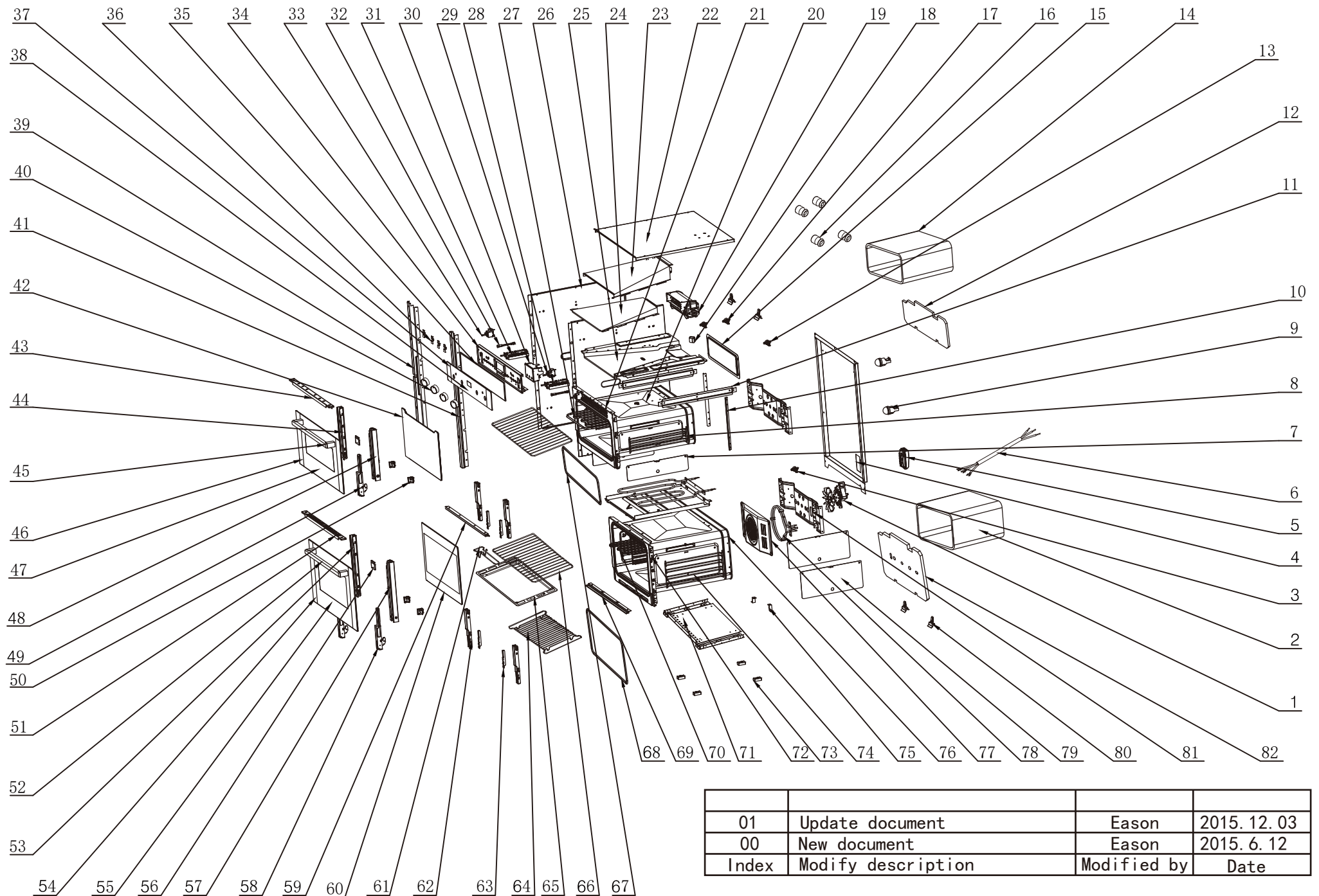

01	Update document	Eason	2015. 12. 03
00	New document	Eason	2015. 6. 12
Index	Modify description	Modified by	Date

AMF72VSS parts list

No.	part code	Part description	Qty	Remark	chinese description
1	33315002	grill fan assembly	1		循环风机组件
2	33120002	heat preservation fibre	1		内胆圈保温纤维（下）
3	33311013	overheat protector (290℃)	1	From June 2015 to stop using	
	36154001	Thermostat (110℃)	1	From June 2015 to start using	温控器 SF1-068
4	33030021	back cover board	1		外壳后盖板-AD-K25(C)-09
5	33005016	terminal box	1		接线盒-AD-K25(A)-22
6	32307016	power cord-European style	1		无头-1.5米-H05VV-F 头部3个鳄鱼齿
7	33039015	side rack panel	2		导轨支架垫板-AD-K25(B)-06
8	33140011	side rack	2		左右导轨支架-AD-K25(B)-12
9	33302002	lamp assembly	2		灯头组件
10	33027012	connect board for top and bottom cavity	2		上下内胆连接板-AD-K25(A)-11
11	33027014	fixing panel for exhausting pipe base board	2		排烟道底板固定板-AD-K25(A)-13
12	33121002	heat preservation fibre	1		底盖保温纤维（上）
13	33308027	over heat protector100℃	1	From June 2015 to start using	过热保护器-100℃
	33311013	overheat protector (290℃)	1	From June 2015 to stop using	
14	33120002	heat preservation fibre	1		内胆圈保温纤维（上）
15	33001037	back catalytic line	1		背部易洁板-AD-K25(B)-07
16	33141002	guide rail bracket fixing axis	4		导轨支架固定轴
17	33310003	heat dissipation thermostat	2		45℃散热温控器
18	33215013	exhausting pipe	1		排烟筒-AD-K25(B)-05
19	33313020	cooling fan assembly	1		散热风机组件-配双排气系统
20	33058060	top cavity assembly	1		内胆组件（上）-AD-K25(B)-20-00
21	33018113	cavity panel	1		内胆面板(上)-AD-K25(B)-20-01
22	33031014	top cover plate	1		外壳上盖板-AD-K25(A)-01
23	33028004	exhausting pipe top cover board	1		排烟道上盖板-自洁烤箱专用
24	33026004	exhausting pipe middle cover board	1		排烟道中盖板-自洁烤箱专用
25	33027002	exhausting pipe base board	1		排烟道底板-自洁烤箱专用
26	33033017	side plate (left&right)	2		外壳左右侧板-AD-K25(C)-06
27	33303006	top heating element	1		顶层电热管
28	33301035	function switch	1		档位开关（5功能）
29	33311018	temperature adjuster	1		温控开关-K25(A)-21
30	33300011	sensor touch timer (3 button)	1		三键定时器（红色）-触摸
31	33301034	function switch	1		档位开关（4功能）
32	33312001	indicator light	2		指示灯
33	33311007	temperature adjuster	1		温控开关-900*480烤箱专用
34	33018148	fixing panel for switch	1		开关面板固定板-AD-K25(C)-05
35	90134002	single adhesive tape			黑色单面胶
36	33006001	connect board switch	4		开关面板连接板-PN-K4-18
37	33007168	control panel decorate board	2		开关面板装饰板-PN-K25(C)-11
38	33101464	control panel assembly	1		开关面板（4功能-5功能）三键触摸-AD-K25(C)
39	33014092	right bracket for out cover plate	1		外壳左支架-AD-K25（C）-07
40	32244031	knob.21	4		21号旋钮
41	33014093	left bracket for out cover plate	1		外壳右支架-AD-K25（C）-08
42	33103023	inner glass(top door)	1		内玻璃-上（镀膜）-AD-K25(B)-10-02
43	33014087	door frame top bracket	1		门上支架(前面开孔)-AD-K25(A)-10-01
44	33014080	door frame left bracket	1		门框左支架-AD-K25(B)-10-04
45	33190007	handle H1	1		1号拉手
46	33015283	door panel decorate board	2		门面板装饰板(上)-AD-K25(B)
47	33102370	door panel	1		门面板-AD-K25(B)-10-01
48	33014079	door frame right bracket	1		门框右支架-AD-K25(B)-10-05
49	33180018	hinge 12	2		铰链组件-12号铰链
50	33014049	fixing panel for inner glass	2		内玻璃左下固定块
	33014050	fixing panel for inner glass	2		内玻璃右下固定块
51	33014250	top bracket for oven door	1		门上支架-PN-K15(A)-20-01
52	33190007	handle H1	1		1号拉手
53	33014084	door frame left bracket	1		门框左支架-PN-K25(C)-10-03
54	33015284	door panel decorate board	2		门面板装饰板-AD-K25(C)
55	33102418	door panel	1		门面板-AD-K25(C)-10-01
56	33006012	fixing board for handle	2		拉手固定板
57	33014083	door frame right bracket	1		门框右支架-PN-K25(C)-10-04
58	33180019	hinge 3 assembly	2		铰链组件-13号铰链
59	33027015	cavity panel connector	1		内胆面板连接板（前）-AD-K25(A)-09
60	33103029	inner glass	1		内玻璃(镀膜)-AD-K25（C）-10-02
61	33172001	handle for rack	2		搁架抓手
62	33024006	side bracket for cavity(left&right)	2		内胆左右支架-AD-K25(A)-05
63	33005014	fixing board for hinge	4		铰链固定板-AD-K25(A)-06
64	33170003	tray-shallow	1		烤盘架(浅)
65	33224003	baking tray	1		油脂收集盘
66	33170001	grill rack	2		搁架
67	33803013	door seal assembly	1		门封条组件-K25（B）
68	33803014	door seal assembly	1		门封条组件-K25（C）
69	33027016	bottom support for cavity panel	2		内胆面板下支撑-AD-K25(A)-12
70	33303009	top heating element	1		顶层电热管-5功能
71	33029015	bottom cover plate	1		外壳底板-AD-K25(A)-03
72	33018149	cavity panel	1		内胆面板(下)-PN-K25(C)-20-01
73	33237030	the support for bottom cover plate	4		底板支撑块-PN-K24-08
74	36038003	side rack	2		导轨支架 AD-K25(C)-01
75	33006063	the bottom support for cavity	2		内胆下支撑-AD-K25(C)-13
76	33058062	cavity assembly	1		内胆组件（下）-AD-K25(C)-20-00
77	33001022	the cover plate for back heating element	1		背部电热管挡板-2(PN-K14-06)
78	33303040	rear element	1		背部电热管-PN-K14-12
79	33540001	side rack panel	2		导轨支架垫板 AD-K25(c)-02
80	33035001	thermostat switch sensor fixer	10		温控开关探头固定夹
81	33016001	back bracket for cavity	2		内胆后支架
82	33121002	heat preservation fibre	1		底盖保温纤维（下）