



Double oven:AMF90BK

Version:01

Date:2015-12-03

Product reference code:AMF90BK

# AMF90BK Exploded drawing

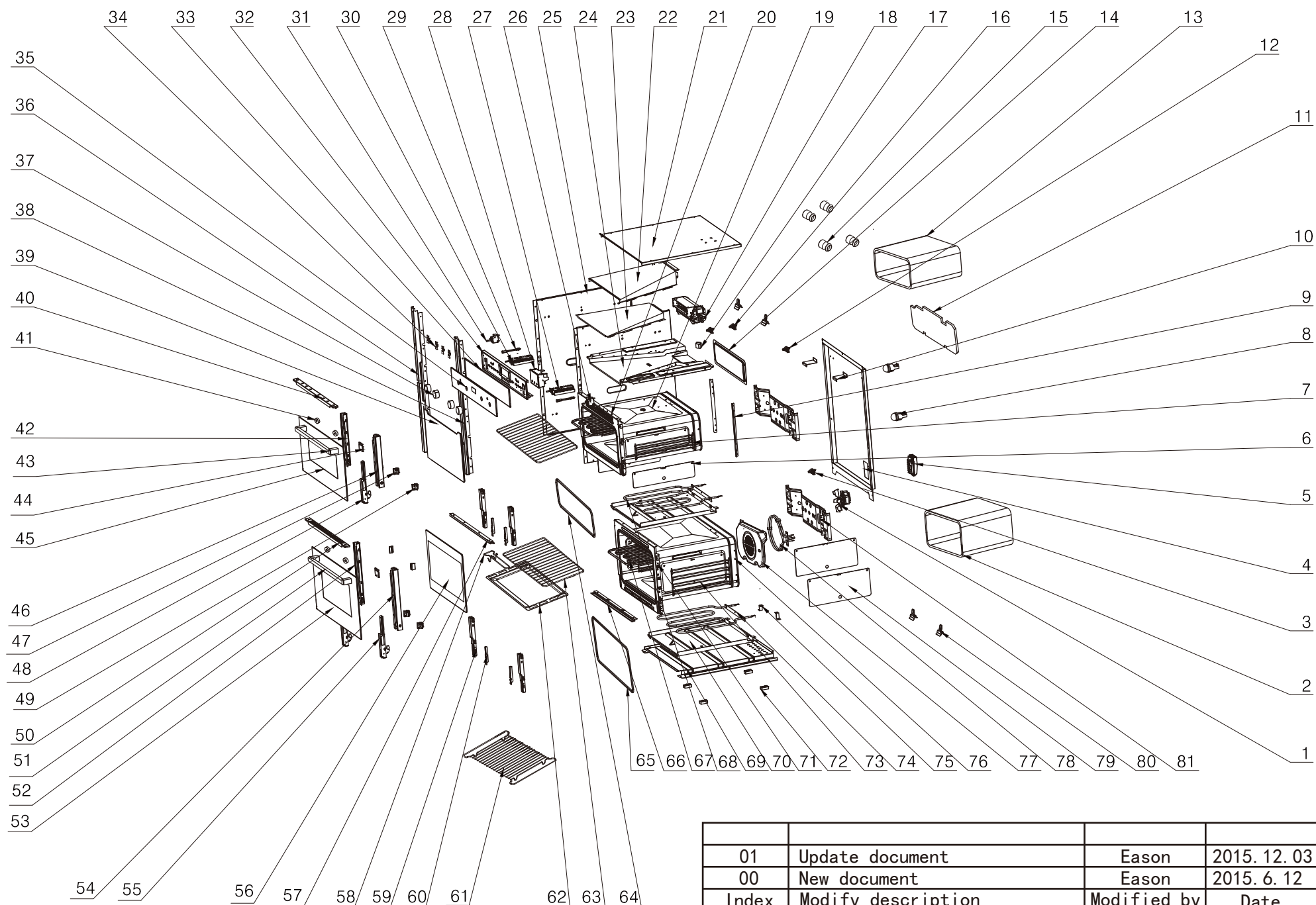

01	Update document	Eason	2015. 12. 03
00	New document	Eason	2015. 6. 12
Index	Modify description	Modified by	Date

# AMF90BK parts list

No.	part code	Part description	Qty	Remark	chinese description
1	33315002	grill fan assembly	1		循环风机组件-(划一型号): HY6020V240H
2	33120002	heat preservation fibre	1		内胆圈保温纤维-1(16KG)
3	33311013	overheat protector (290℃)	1	From June 2015 to stop using	
	36154001	Thermostat (110C°)	1	From June 2015 to start using	温控器 SF1-068
4	33030020	back cover board	1		外壳后盖板-AD-K25(B)-02
5	33305016	terminal box	1		接线盒-AD-K25(A)-22
6	33039015	side rack panel	2		导轨支架垫板-AD-K25(B)-06
7	33140011	side rack	2		左右导轨支架-AD-K25(B)-12
8	33302002	lamp assembly	2		灯头组件
9	33027012	connect board for top and bottom cavity	2		上下内胆连接板-AD-K25(A)-11
10	33027014	fixing panel for exhausting pipe base board	2		排烟道底板固定板-AD-K25(A)-13
11	33121002	heat preservation fibre	1		内胆底盖保温纤维
12	33311013	overheat protector (290℃)	1	From June 2015 to stop using	
	33308027	over heat protector100℃	1	From June 2015 to start using	过热保护器-100℃
13	33120002	heat preservation fibre	1		内胆圈保温纤维-1(16KG)
14	33001037	back catalytic line	1		背部易洁板-AD-K25(B)-07
15	33141002	guide rail bracket fixing axis	4		导轨支架固定轴-900*480烤箱
16	33310003	heat dissipation thermostat	2		散热温控器
17	33215013	exhausting pipe	1		排烟筒-AD-K25(B)-05
18	33313030	cooling fan assembly	1		散热风机组件(双排气)-AD-K25(A)-50
19	33058060	top cavity assembly	1		内胆组件(上)-AD-K25(B)-20-00
20	33018113	cavity panel	1		内胆面板(上)-AD-K25(B)-20-01
21	33031014	top cover plate	1		外壳上盖板-AD-K25(A)-01
22	33028004	exhausting pipe top cover board	1		排烟道上盖板-自洁烤箱专用
23	33026004	exhausting pipe middle cover board	1		排烟道中盖板-自洁烤箱专用
24	33027002	exhausting pipe base board	1		排烟道底板-自洁烤箱专用
25	33033016	side plate (left&right)	2		外壳左右侧板-AD-K25(B)-01
26	33311007	temperature adjuster	1		温控开关-900*480烤箱专用
27	33301034	function sw itch	1		档位开关
28	33300011	sensor touch timer ( 3 button)	1		三键触摸定时器-红色(触摸)
29	33312001	indicator light	2		指示灯
30	33301035	function sw itch	1		档位开关
31	33311018	temperature adjuster	1		温控开关-K25(A)-21
32	33018115	fixing panel for sw itch	1		开关面板固定板-AD-K25(A)-17
33	91034002	single adhesive tape	1		单面胶
34	33006001	connect board switch	4		开关面板连接板
35	33101463	control panel assembly	1		开关面板(4功能-5功能)-三键触摸-AD-K25(B)
36	33014088	left bracket for out cover plate	1		外壳左支架-AD-K25(B)-03
37	32244031	knob.21	4		21号旋钮
38	33014089	left bracket for out cover plate	1		外壳右支架-AD-K25(B)-04
39	33103023	inner glass(top door)	1		内玻璃-上(镀膜)-AD-K25(B)-10-02
40	33014087	door frame top bracket	1		门上支架(前面开孔)-AD-K25(A)-10-01
41	33214005	handle fixing assem	4		拉手固定套-PN-K14-60-09
42	33014080	door frame left bracket	1		门框左支架-AD-K25(B)-10-04
43	33190007	hanld H1	1		1号拉手
44	33006012	fixing board for handle	2		拉手固定板-PN-K13-20-07(黑色亮光喷塑后)
45	33102370	door panel	1		门面板-AD-K25(B)-10-01
46	33014079	door frame right bracket	1		门框右支架-AD-K25(B)-10-05
47	33014049	fixing panel for inner glass	2		内玻璃下固定块-PN-K15(A)-20-08
48	33180018	hinge 12	2		铰链组件-12号铰链
49	33014050	fixing panel for inner glass	2		内玻璃右下固定块-PN-K15(A)-20-09
50	33014043	top bracket for oven door	1		门上支架-PN-K15(A)-20-01
51	33190007	hanld H1	1		1号拉手
52	33014082	door frame left bracket	1		门框左支架-PN-K25(A)-10-03
53	33102066	door panel	1		门面板-418-老门配418的拉手
54	33014081	door frame right bracket	1		门框右支架-PN-K25(A)-10-04
55	33180016	hinge 16 assembly	2		铰链组件-16号铰链
56	33103031	inner glass	1		内玻璃-下(镀膜)-AD-K25(A)-20-01
57	33027015	cavity panel connector	1		内胆面板连接板(前)-AD-K25(A)-09
58	33172001	handle for rack	1		搁架抓手
59	33024006	side bracket for cavity(left&right)	4		内胆左右支架-AD-K25(A)-05
60	33005014	fixing board for hinge	4		铰链固定板-AD-K25(A)-06
61	33170003	Tray-shallow	1		烤盘架(浅)
62	33224003	baking tray	2		油脂收集盘(K1-08)-新工艺
63	33170001	grill rack	2		搁架
64	33803013	door seal assembly	1		门封条组件K25(B)
65	33803002	door seal assembly	1		门封条组件-K1(A)
66	33027016	bottom support for cavity panel	1		内胆面板下支撑-AD-K25(A)-12
67	33303006	top heating element	2		顶层电热管
68	33303039	bottom heating element	1		底层电热管-PN-K14-08
69	33029015	bottom cover plate	1		外壳底板-AD-K25(A)-03
70	33003002	fixing board for bottom heating element	2		底层电热管固定板(K1)
71	33018111	cavity panel	1		内胆面板(下)-AD-K25(A)-40-01
72	33237030	the support for bottom cover plate	4		底板支撑块-PN-K24-08
73	33140001	side rack	2		导轨支架
74	33303002	bottom heating element	1		底层电热管
75	33237031	bottom cover plate	2		外壳底板加强板-AD-K25(A)-36
76	33058002	cavity ring assem	1		内胆圈组件(K2)
77	33001002	the cover plate for back heating element	1		背部电热管挡板
78	33303004	back electric heat pipe	1	From November 2015 to stop using	
	33303027	rear heating element	1	From November 2015 to start using	背部电热管
79	33039001	side rack panel	2		导轨支架垫板
80	33035001	thermostat sw itch sensor fixer	4		温控开关探头固定夹
81	33016001	back bracket for cavity	2		内胆后支架