

## Box60/ 70/ 90

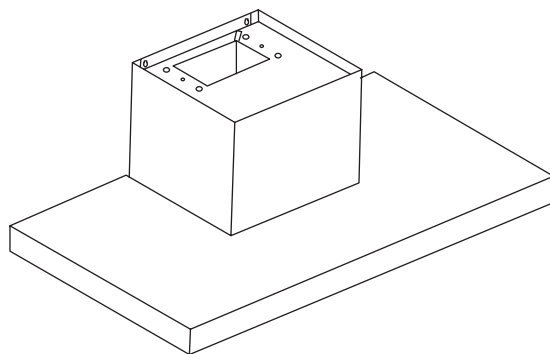

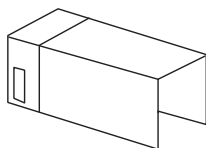

[01] x 1



[02] x 2



[03] x 1

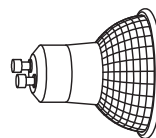

[04] x 2

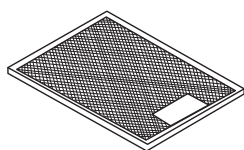

[05]  
60cm, 70cm x 2  
90cm x 3

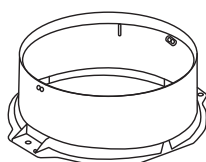

[06] x 1

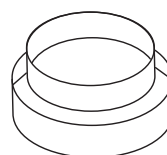

[07] x 1

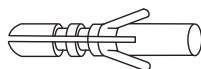

[08] x 6

1 : 1

[09] x 6  
(3.9 x 32mm)



[10] x 4  
(3.4 x 10mm)



# Box60/ 70/ 90



Cooker Hood

04

**Installation**

22

# Let's get started...



## Getting **started**...

05

Before you start  
Safety

06  
08

## In more **detail**...

12

Product functions  
Operation  
Care and maintenance  
Troubleshooting  
Recycling and disposal  
Technical and legal information  
CE Declaration of conformity

13  
13  
14  
17  
18  
18  
21

## Appendix

Installation  
Information for EU66

22  
30



# Getting Started...

**Before you start**

06

**Safety**

08

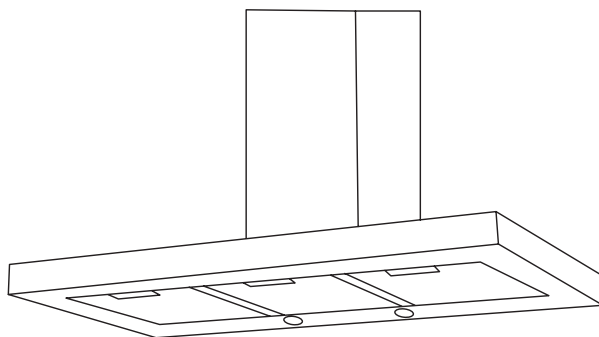

## Before you start

---

- ☒ To avoid the risks that are always present when you use an electrical appliance it is important that this appliance is installed correctly and that you read the safety instructions carefully to avoid misuse and hazards. Please keep this instruction booklet for future reference and pass it on to any future owners. After unpacking the appliance please check that it is not damaged. If in doubt, do not use the appliance but contact Customer Services on 0344 800 1128 (UK), 01 4475261 (Ireland).
- ☒ Check the package and make sure you have all of the parts listed.
- ☒ Decide on the appropriate location for your product.
- ☒ If this product contains glass please take care when fitting or handling to prevent personal injury or damage to the product.
- ☒ The specifications plate is available on this appliance. This plate displays all the necessary identification information for ordering replacement parts.
- ☒ If you sell the appliance, give it away, or leave it behind when you move house, make sure you also pass on this manual so that the new owner can become familiar with the appliance and its safety warnings.

## Tools required

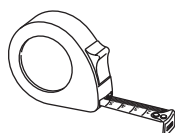
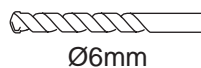
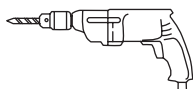
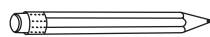

## Accessories not supplied

### Recirculation

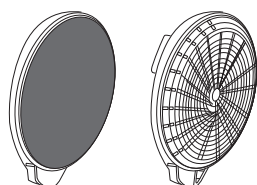

CARBFLT4 (UK & IE)

### Extraction

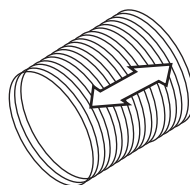

Ø125mm or Ø150mm  
VENT PACK 2 (UK & IE)



SELF ADHESIVE  
ALUMINIUM TAPE

## CARBON FILTER ORDERING HOTLINE

0344 800 1128 (UK) 01 4475261 (IE)

**These instructions are for your safety. Please read through them thoroughly prior to installation and retain them for future reference.**



- All installation work must be carried out by a competent person or qualified electrician.
- This appliance must be installed correctly by a suitably qualified person, strictly following the manufacturer's instructions.

- ✓ This appliance complies with all current European safety legislation, however, the Manufacturer must emphasise that this compliance does not prevent the surfaces of the appliance from heating up during use and remaining hot during its operation.
- ✓ Accessible parts may become hot during use. Young children should be kept away. Care should be taken to avoid touching the appliance
- ✓ The Manufacturer highly recommends that this appliance be kept out of the reach of babies and small children.
- ✓ This appliance can be used by children aged from 8 years and above and persons with reduced physical, sensory or mental capabilities or lack of experience and knowledge if they have been given supervision or instruction concerning use of the appliance in a safe way and understand the hazards involved. Children shall not play with the appliance. Cleaning and user maintenance shall not be made by children unless they are older than 8 and supervised.



- ✓ Keep the appliance and its cord out of reach of children less than 8 years.
- ✓ Means for disconnection must be incorporated in the fixed wiring in accordance with the wiring rules. An all-pole disconnection switch having a contact separation of at least 3 mm in all poles should be connected in fixed wiring.
- ✓ Regularly check the power plug and power cord for damage. If the supply cord is damaged, it must be replaced by the manufacturer, its service agent or similarly qualified persons in order to avoid a hazard.
- ✓ Do not allow the electric cables to touch the hot parts of the appliance.
- ✓ Make sure that the power cord is not caught under or in the appliance and avoid damage to the power cable.
- ✓ Do not install the appliance outdoors in a damp place or in an area which may be prone to water leaks such as under or near a sink unit. In the event of a water leak allow the machine to dry naturally.
- ✓ Do not use flammable sprays in close vicinity to the appliance.
- ✓ Please dispose of the packing material carefully.
- ✓ Do not use flammable sprays in close vicinity to the appliance.

- ✓ We also recommend that great care be taken during use and cleaning. Read the cleaning and maintenance sections for this appliance carefully.
- ✓ A steam cleaner is not to be used.
- ✓ The appliance is not intended to be operated by means of external timer or separated remote-control system.
- ✓ The appliance is for domestic use only.
- ✓ **Warning:** Consult local regulations regarding fumes outlets. Do not connect the hood to a fume, ventilation or hot air duct. Confirm that room ventilation is appropriate with the local authorities. Make sure the maximum air extraction flow rate for the appliances in the room does not exceed 4 Pa (0.04 mbar). The room must have adequate ventilation if an extractor hood is used simultaneously with appliances that run on gas or other fuels. The air must not be discharged into a flue that is used for exhausting fumes from appliances burning gas or other fuels. Regulations regarding air extraction must be complied with.
- ✓ **Warning:** Before connecting the hood: switch off the electricity supply and check that the supplied voltage and frequency coincide with that indicated on the appliance nameplate.

- ✓ **Warning:** The hood may stop working during an electrostatic discharge (e.g. lightning). This involves no risk of damage. Switch off the electricity supply to the hood and reconnect after one minute.
- ✓ To avoid the risk of fire, clean the metal filter regularly and closely watch and regulate pans containing hot oil.
- ✓ Do not use the hood if it shows signs of damage or imperfection. Contact customer services.
- ✓ Flambe cooking must not be carried out underneath this appliance.
- ✓ When installing the appliance, make sure that the following distances between the top of cooker or hob and the lowest part of the cooker hood must be observed:
  - > Gas hobs: 750mm.
  - > Electric hobs: 650mm.
- ✓ The Manufacturer declines all liability for personal or material damage as a result of misuse or incorrect installation of this appliance.

**Warning**

There is a risk of electric shock and fire if cleaning is not carried out in accordance with the instructions.

## In more detail...



<b>Product functions</b>	13
<b>Operation</b>	13
<b>Care and maintenance</b>	14
<b>Troubleshooting</b>	17
<b>Recycling and disposal</b>	18
<b>Technical and legal information</b>	18
<b>CE Declaration of conformity</b>	21

## Product functions

This appliance extracts the air of the kitchen to remove the odours and keep an optimum level of air quality inside the room, it also allows you to illuminate the cooking area.

## Operation



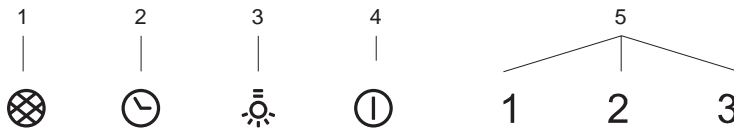

### Operation

- Switch on the appliance at the switched fused connection unit. The appliance is ready for use.

Touch control panel



This panel is located on the front part of the hood and includes:

-  Filter cleaning alert indicator/switch (ref. 1). Activated when you need to clean the aluminium grease filters and deactivated with a single press.
-  Control for setting the timer of the motor (ref. 2). The extractor will operate for 5 minutes at the current speed and 5 minutes at each of the lower speeds until coming to a complete stop.
-  Control for the light (ref. 3). Allows the light to be regulated by pressing and holding down.
-  On/off control of the motor (ref. 4).
  - 1 Extractor fan speed - control: speed 1
  - 2 Extractor fan speed - control: speed 2
  - 3 Extractor fan speed - control: speed 3

To obtain the best results from your cooker hood it is recommended that you leave it switched on for 15 minutes after you have finished cooking.

## Care and maintenance

**Warning:** always switch off the electricity supply before carrying out maintenance work on the hood. In the event of a fault, contact customer services.

### Bulb replacement

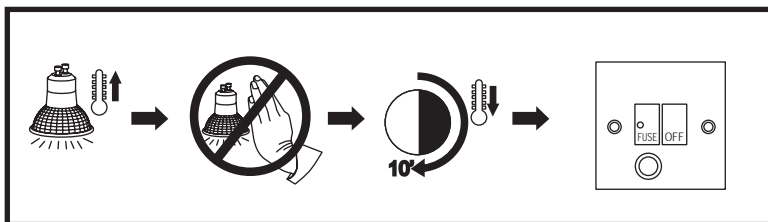

The Bulb may be hot, leave it 10 minutes before removing it.

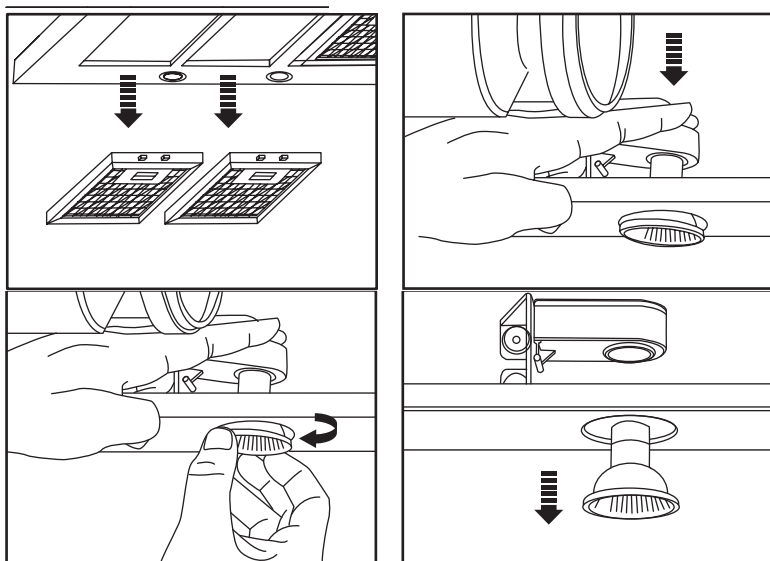

**Active charcoal filter replacement:**

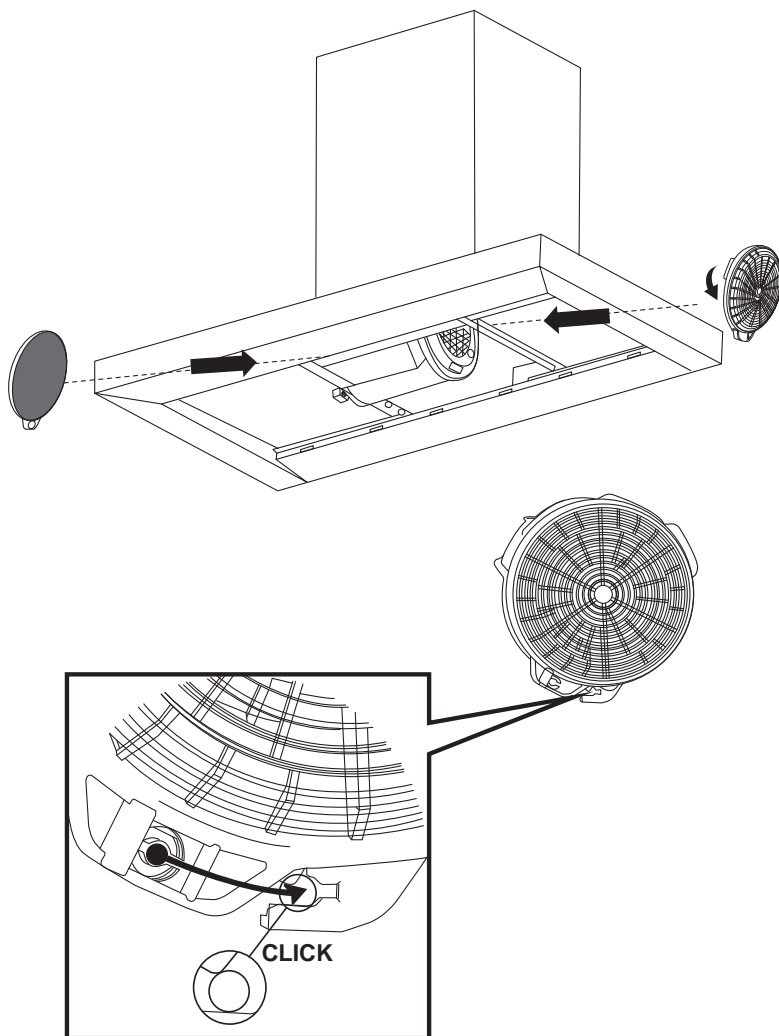

**In more detail...**

**2 X ACTIVE CHARCOAL FILTER (NOT SUPPLIED).  
MODEL NUMBER CARBFILT4 (UK & IE).**



### Warning

Always switch off the electricity supply before performing maintenance work. In the event of a fault, contact customer services.

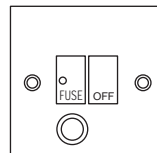

### Metal filter maintenance:

Use non-corrosive, liquid detergent or a stainless steel cleaner.

1 MONTH

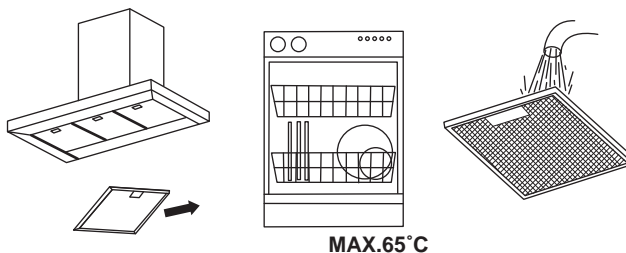

Aluminium filters: to avoid fires, clean thoroughly once a month or whenever the display pilot light indicates as such (if fitted). To do so, remove the filters, soak in hot water and mild detergent for an hour. If using a dishwasher, position the filters vertically to improve the cleaning process.



3 MONTHS

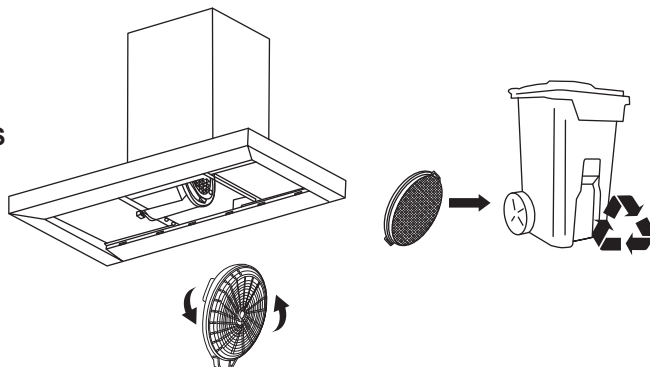

Active charcoal filters: replace every 3 months.

**Important:** increase the filter cleaning/replacement frequency if the hood is used for more than 2 hours a day. Always use the recommended filter.



## Troubleshooting

Fault	Cause	Solution
Excessive Vibration	The Appliance is not hung properly on the brackets.	Take down the appliance and check it is properly fixed.
	The fan blade is damaged.	Switch off the appliance. Repair to be carried out by qualified service personnel only.
	The fan motor is not fixed tightly.	
Light on, but motor does not work.	The fan blade is jammed.	
	The motor is damaged.	
Both light and motor do not work.	Light bulb blown.	Replace with a bulb with correct rating.
	Power connection loose.	Check power supply.
Suction performance reduced.	Speed may be too low.	Select a higher speed.
	Distance between the cooker hood and the hob is too great.	Readjust the distance to: Gas hobs: 750mm Electric hobs: 650mm
	Aluminium grease filter is dirty.	Clean filters. (see care and maintenance)
	Top vent might be obstructed. (CLVH60SS-C & CLVH60W-C, VHB60SS)	Clear any obstruction.
	Optional vent kit might be twisted.	Ensure that the vent kit is fitted to the manufacturers instructions.
Works normally but cooking smells linger.	Charcoal filter not fitted in recirculation mode or charcoal filter is full of grease.	Fit charcoal filter if recirculating or change the filter. (see care and maintenance)

## Recycling and disposal

### Environmental protection

Waste electrical products should not be disposed of with household waste. Please recycle where facilities exist. Check with your Local Authority or retailer for recycling advice.



The symbol on the product or its packaging indicates that this product cannot be treated as normal household waste. This product must be handed over to an electric and electronic equipment collection point for recycling.

On ensuring that this product is disposed of correctly, you will help to avoid possible negative consequences for the environment and public health, which could occur if this product is not handled correctly. To receive more detailed information about recycling this product, contact your local government, domestic waste disposal services or the outlet where the product was bought.

## Technical and legal information

### Technical and legal information

The Manufacturer declines all liability for damage caused to persons and objects due to incorrect or improper installation of the appliance.

Power supply	:	220-240V~ 50Hz
Power consumption – Fan	:	95W
Power consumption – Luminary	:	2 x 50W Max
Power consumption – Total	:	195W
Protection class	:	II
Light bulb	:	Max. 50W (GU-10)

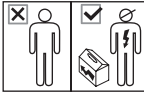

All installation work must be carried out by a competent person or qualified electrician. Before connecting the mains supply ensure that the mains voltage corresponds to the voltage on the rating plate inside the cooker hood.

**Warning: THIS APPLIANCE MUST NOT BE EARTHED.**

Mains Supply could be connected to the Mains Voltage by Direct Connection

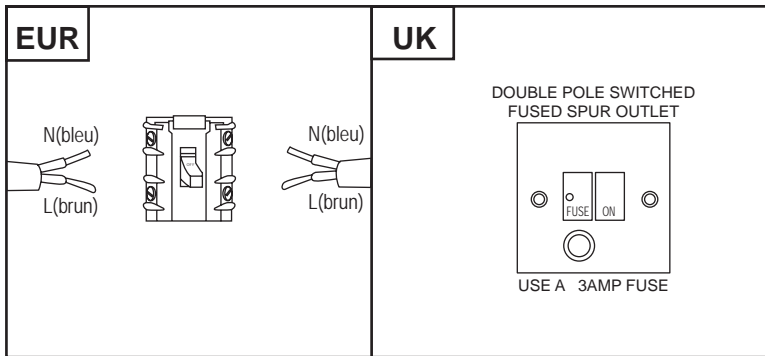

## Direct Connection

If the appliance is being connected directly to the mains an omnipolar circuit-breaker must be installed with a minimum opening of 3mm between contacts.

If the supply cord is damaged, it must be replaced by the manufacturer, its service agent or similarly qualified persons in order to avoid a hazard.

The installer must ensure that the correct electrical connection has been made and that it complies with wiring diagram.

The cable must not be bent or compressed.

The cable must be checked regularly and replaced by authorized technicians only.

In more detail...

### Electrical Requirements

Any permanent electrical installation must comply with the latest I.E.E. Regulations and local electricity company regulations. For your own safety a qualified electrician or contractor who is on the roll of the National Inspection Council for Electrical Installation Contracting (NICEIC) should undertake the electrical installation.

### Electrical Connection

Before connecting the mains supply ensure that the mains voltage corresponds to the voltage on the rating plate inside the cooker hood.

### **WARNING: THIS APPLIANCE MUST NOT BE EARTHED**

The appliance is supplied with a 2-core mains cable and must be connected to the electricity supply via a double pole switch having a 3mm minimum contact gap on each connector.

For UK only  
A Switched Fused Connection Unit to BS 1363 Part 4 is recommended.

**The fuse must be rated at 3 Amps.**

The wires in the mains lead are coloured in accordance with the following code:

**Brown = L - Live**

**Blue = N - Neutral**

The connection point must be placed in a position adjacent to the appliance so as to be readily accessible for an engineer in the event of a breakdown.

**Disconnect the appliance from the mains supply before carrying out any kind of maintenance or cleaning.**

## CE Declaration of conformity



MANUFACTURER : CATA

ADDRESS: C/Ter N°2, Torelló 08570 – Barcelona (Spain)

We hereby certify that the mentioned accessory complies with the essential requirements of the European Directives applicable, including their modifications and the corresponding transpositions from the national law.

MACHINE APPLICATION Box60, Box70, Box90

TYPE : Decorative Cooker Hood  
 EC DIRECTIVES APPLIED : Complies with the European Directives 2006/95/EC:  
 LVD and the 2004/108/EC: EMC

APPLIED HARMONIZED  
 STANDARDS:  
 Standard EN 60335-1 Safety of household and similar electrical appliances  
 Standard EN 60335 part 2-31, particular requirements for range hoods  
 Standard EN 55014 Limits and Methods of measurement of radio disturbance  
 Standard EN 61000-3-2 Electromagnetic compatibility limits for harmonic.  
 Standard EN 61000-4-5 Electromagnetic compatibility (EMC)

APPLIED INTERNATIONAL TECHNICAL  
 STANDARDS AND SPECIFICATIONS: ISO 9001.2008

PLACE : Torelló

David Sala  
 Technical Manager

This appliance respects laws of the suppression of radio-interference. The Manufacturer has a policy of continuous product improvement, it reserves the right to adapt and carry out any modification considered necessary without prior warning.

In more detail...

# Appendix...

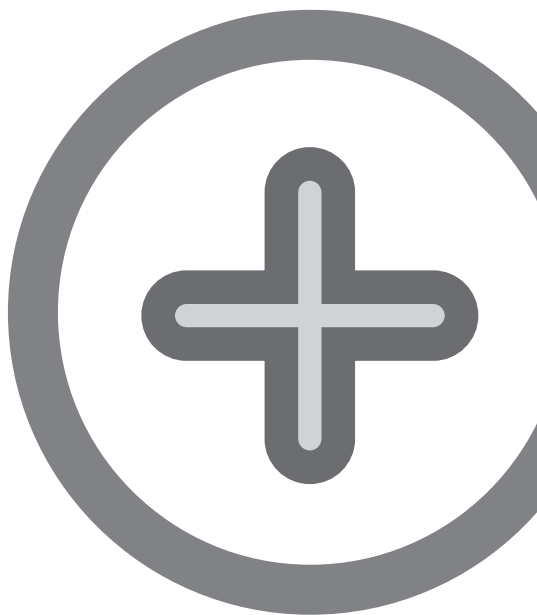

**Installation  
Information for EU66**

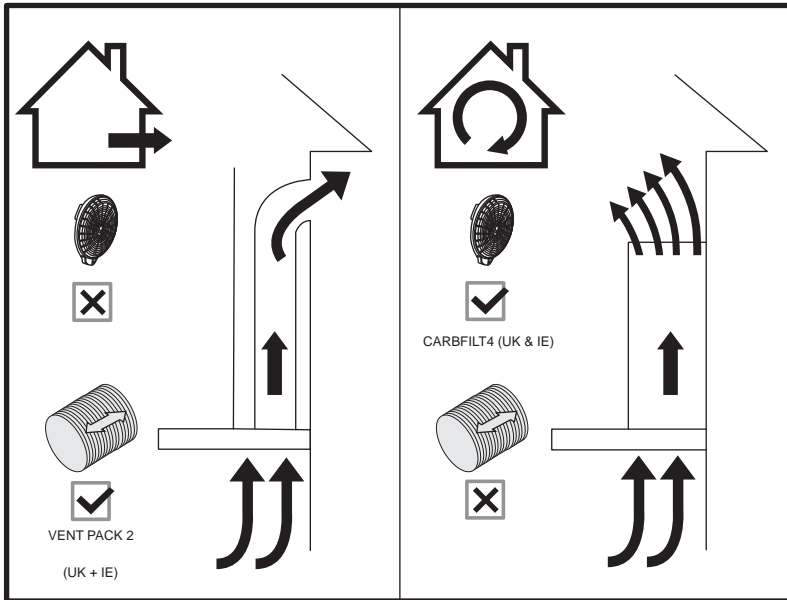

You can choose two type of installation:

- Extraction option
- Recirculation option

## 02

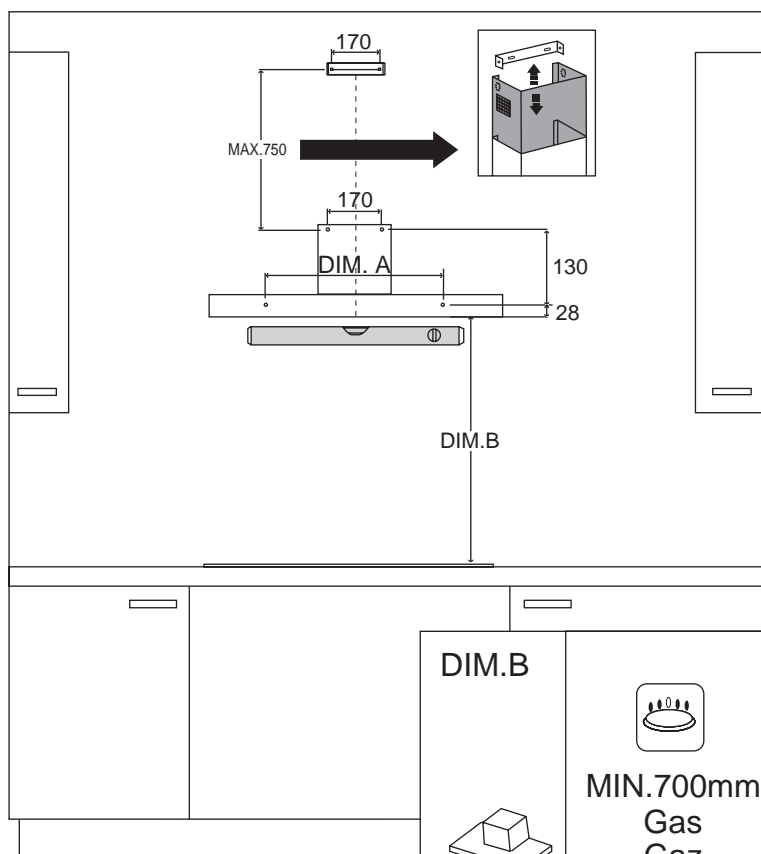
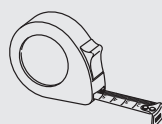
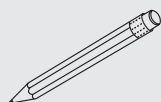

Model	DIM A
600mm	440
700mm	440
900mm	700

**DIM.B**

**MIN.700mm**  
**Gas**  
**Gaz**

**MIN 650mm**  
**Electric**  
**Electrique**

Mark on the wall the hole positions as shown in diagram.



**The Wall Plugs supplied are suitable for solid walls only. When fixing to any other type of wall use suitable alternative fixings.**



# 03

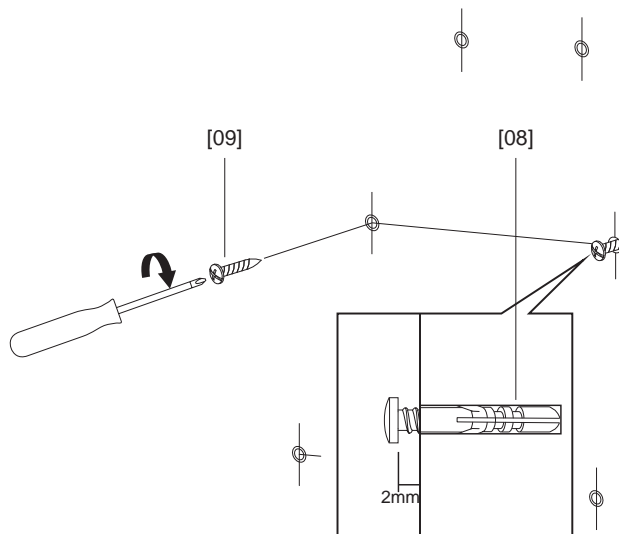

[08] x 6



[09] x 2

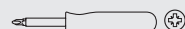
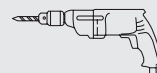

Drill the holes, insert the wall plugs in all 6 holes. Insert the screws in the middle 2 holes in fig.03.  
Maximum gap between top 2 holes and middle 2 holes can be no more than 750mm, dependant on ceiling height

# 04

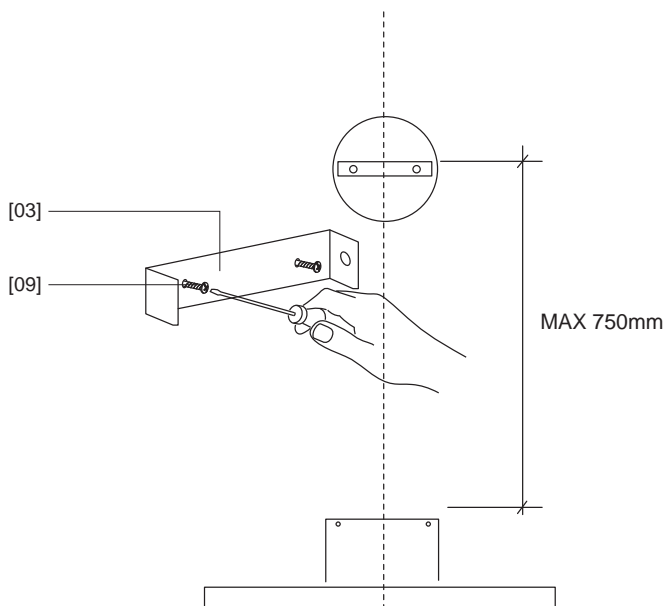

[03] x 1



[09] x 2



Fix the top bracket to the wall.

# 05

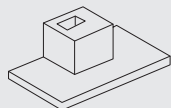

[01]

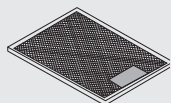

[05] x 3

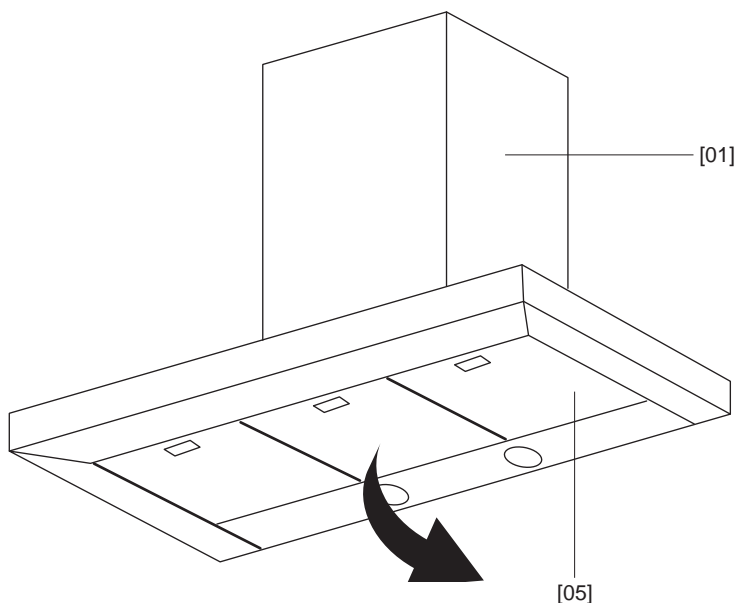

Remove the aluminium filters

# 06



[09] x 2

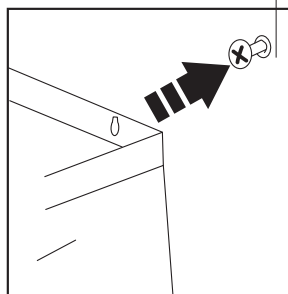

[09]

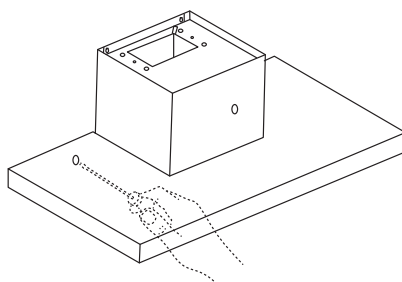

Position the hood over the top two screws then insert the bottom screws from inside the hood, tighten top 2 screws to secure.

07

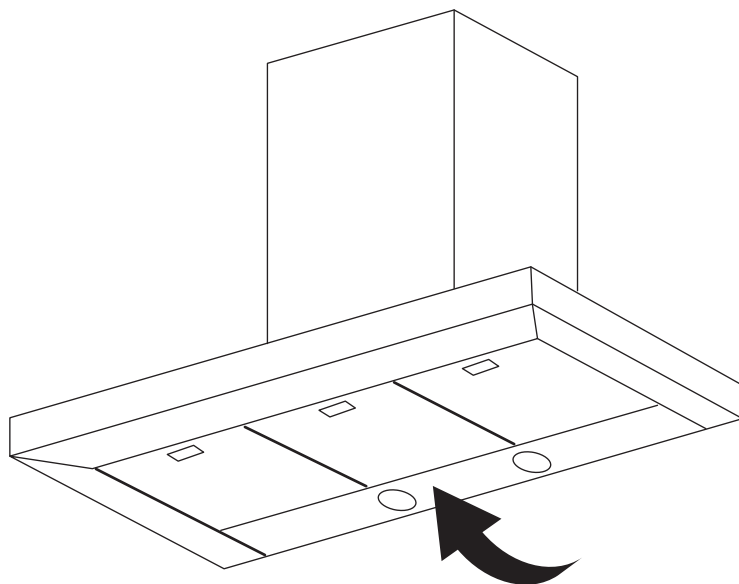

Replace the aluminium filters

08

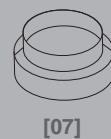
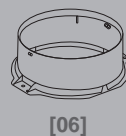
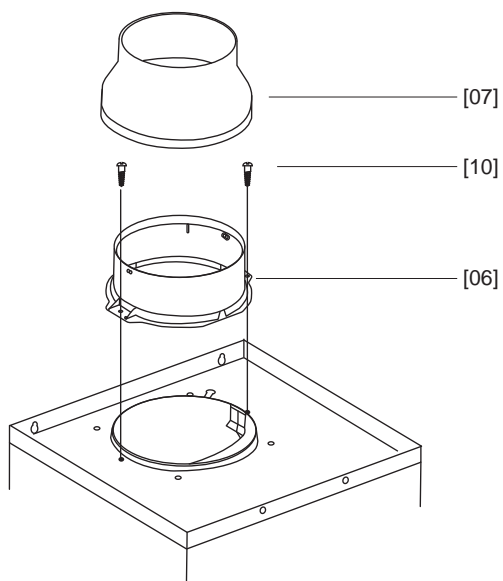

Fix the collar and the reducer if required.

# 09

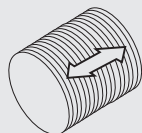

**Vent Pack 2**  
(UK + IE)  
x 1

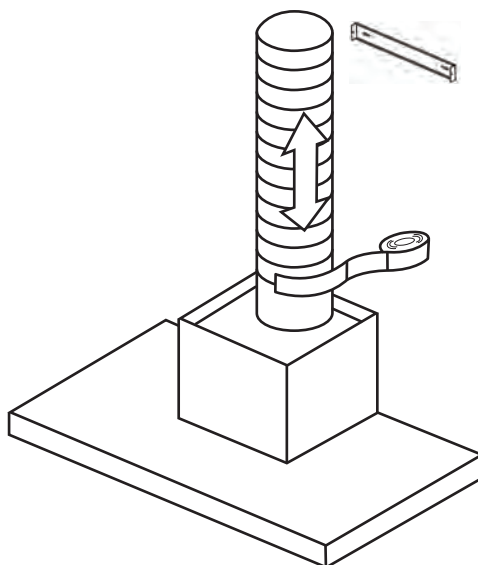
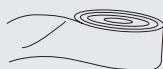

Fix the vent pack 2 using self adhesive aluminium tape.

# 10

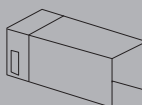

[02] x 2

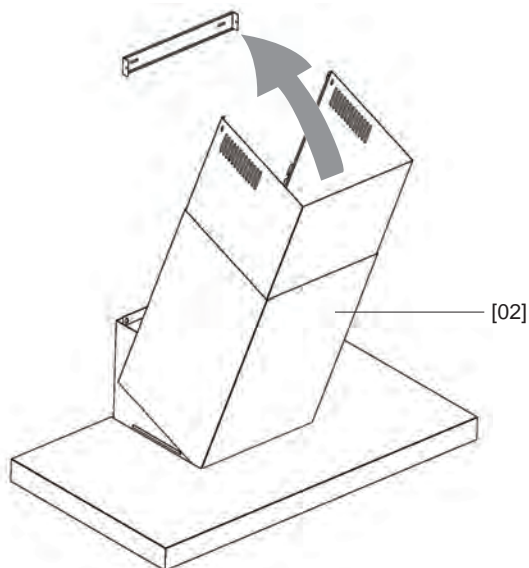

Position the chimney sections.

# 11

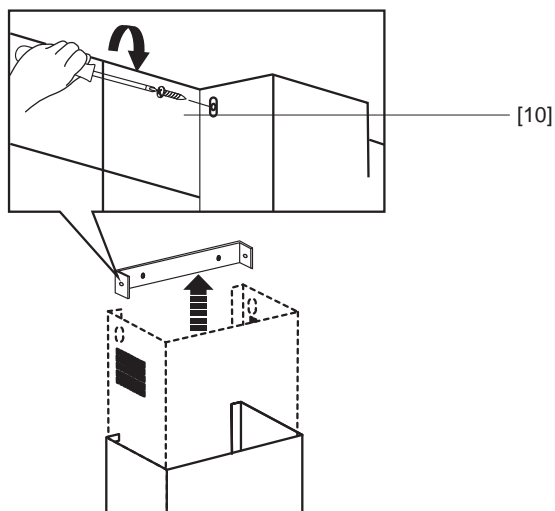

[10] x 2



Fit the chimney sections to the bracket. Connect top of the ducting tube to vent kit as per manufacturers instructions.

# 12

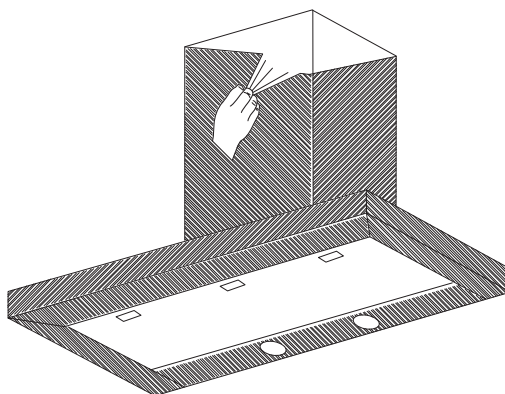

Remove the Protector film

For recirculating option refer to **Care and maintenance** section.

For electrical connection see **Technical and legal information** section.

**(A) Information of the cooker Hood**

	Symbol	Value	Unit
Model identification		BOX60, BOX70, BOX90	
Annual Energy Consumption	$AEC_{hood}$	116.9	kWh/a
Time increase factor	f	1.6	
Fluid Dynamic Efficiency	$FDE_{hood}$	9.8	
Energy Efficiency Index	$EEI_{hood}$	105.8	
Measured air flow rate at best efficiency point	$Q_{BEP}$	208.6	m <sup>3</sup> /h
Measured air pressure at best efficiency point	$P_{BEP}$	123	Pa
Maximum air flow	$Q_{max}$	338.7	m <sup>3</sup> /h
Measured electric power input at best efficiency point	$W_{BEP}$	72.9	W
Nominal power of the lighting system	$W_L$	100.0	W
Average illumination of the lighting system on the cooking surface	$E_{middle}$	743	lux
Measured power consumption in standby mode	$P_s$	0.4	W
Measured power consumption off mode	$P_o$	—	W
Sound power level	$L_{WA}$	Max. 62 / Min. 58	dB

The measurement and calculation method of the above table was done in accordance with commission regulation (EU) No 65/2014 & 66/2014.

**(B) The following shows how to reduce total environmental impact (e.g. energy use) of the cooking process.**

- (1) Install the cooker hood in a proper place where there is efficient ventilation.
- (2) Clean the cooker hood regularly so as not to block the airway.
- (3) Remember to switch off the cooker hood light after cooking.
- (4) Remember to switch off the cooker hood after cooking.

**(C) Information for dismantling.**

Do not dismantle the appliance in a way which is not shown in the user manual. The appliance could not be dismantled by user. At the end of life, the appliance should not be disposed of with household waste. Check with you Local Authority or retainer for recycling advice.





**Apelson Appliances UK Limited**  
**Unit 3 Normandy Landings**  
**Pope St**  
**Castleford**  
**WF6 2AG**

---