

COOKETM &LEWIS

Washer Dryer

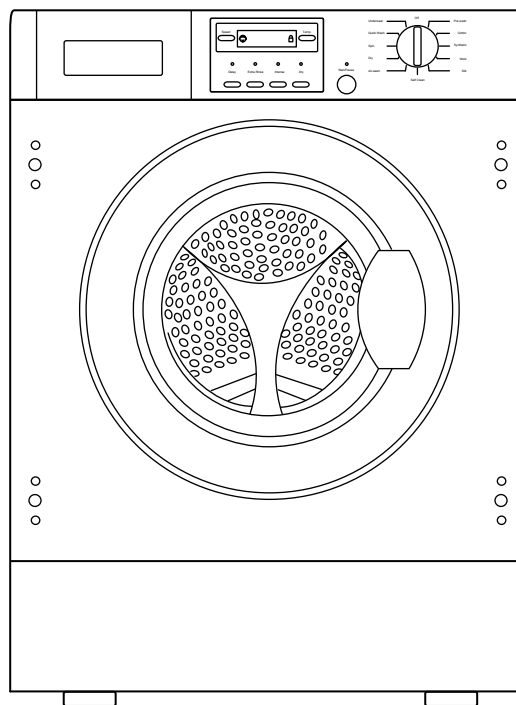

BWD60CL - Version: 01



Washer Dryer - Barcode: 5052931258536



WARNING: Read the instructions before using the appliance.

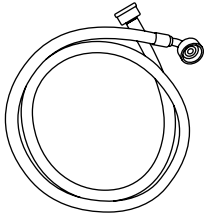

[01] x 1

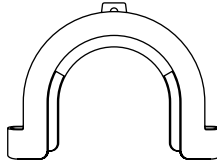

[02] x 1



[03] x 1

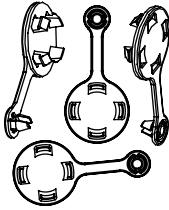

[04] x 4

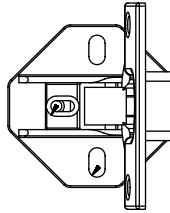

[05] x 2



[06] x 2

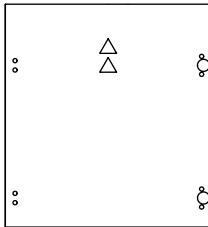

[07] x 1

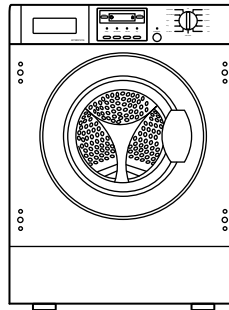

[08] x 1

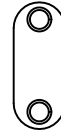

[09] x 2

1 : 1

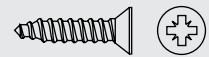

[10] x 8 (3 x 12mm)





[11] x 8 (5 x 12mm)

BWD60CL Washer Dryer

Let's get started...

These instructions are for your safety. Please read through them thoroughly before use and retain them for future reference.

	Getting started...	04
	Your product	04
	Safety	05
	In more detail...	10
	Operation	10
	Care and Maintenance	21
	Troubleshooting	24
	Technical and legal information	29
	Recycling and disposal	29
	Guarantee	30
	CE Declaration of conformity	32
	Appendix...	
	Installation	33

Your product

BWD60CL Washer Dryer

Your product

Unpacking your appliance

Remove all the packing materials to prevent unsteadiness, including the polystyrene base. Upon opening the package, water drops may be seen on the plastic bag and the porthole. This is normal phenomenon resulting from water tests in the factory.

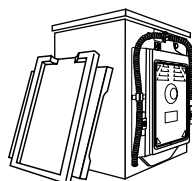

Description

This diagram may be slightly different from the layout of the washer dryer you have just purchased due to technical improvements.

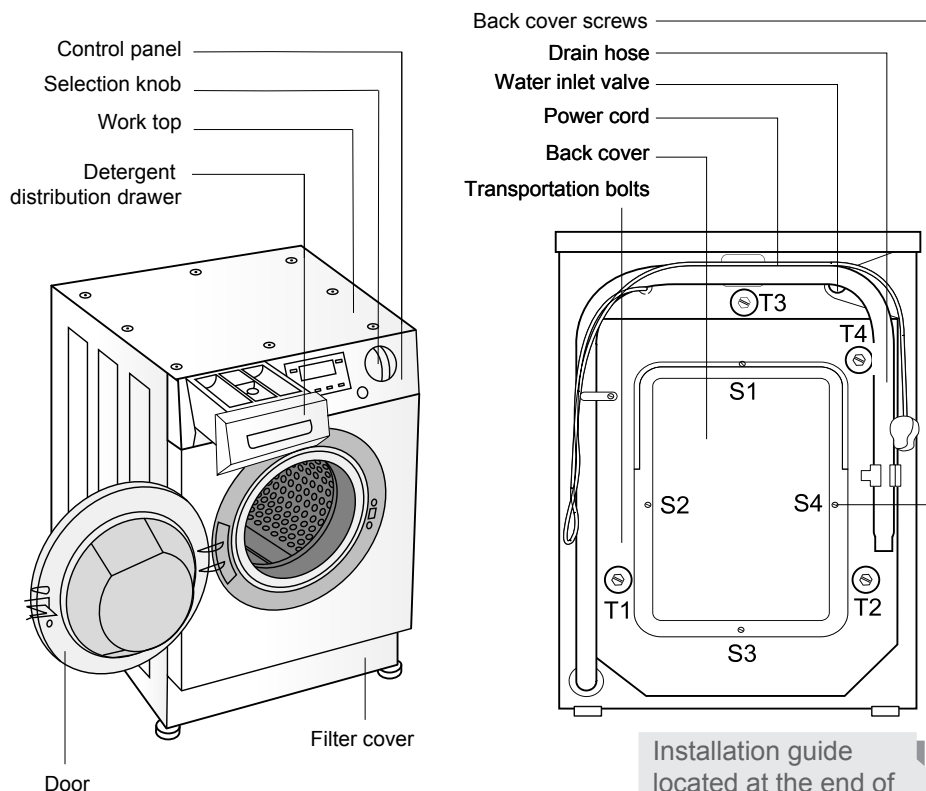

Installation guide
located at the end of
the guidebook

You will need

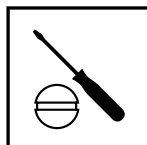
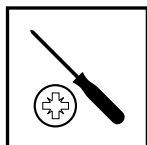

Safety



Warning

Your safety is of the utmost importance to us. Please make sure that you read this instruction booklet before attempting to install or use the appliance. If you are unsure of any of the information contained in this booklet, please contact Customer Services.

General safety

- Repairs to your appliance must only be carried out by one of their authorised service engineers. Any attempt by an inexperienced person to repair the appliance, could result in injury or damage to your washer dryer or invalidate the warranty.
- If you notice that the mains cable is damaged. ***The appliance must not be used.*** The same applies if you notice that the worktop, control panel, base area or any part of the cabinet is damaged. As this could allow access to the internal components of the machine.
- The appliance should be turned off and isolated from the mains supply, before either cleaning or maintenance work is attempted.

- The mains cable must not be used to pull the plug out of the electrical socket. Make sure the plug is accessible.
- The machine should not be sprayed with water.
- The glass of the porthole door may become hot during the higher temperature washing programmes and when using the drying programmes.
- The machine should be allowed to cool before carrying out an emergency drain or cleaning the drain filter.
- It is possible for small animals to chew either mains cables or water hoses, which could cause an electric shock hazard.

Installation

- The installation instructions contained within this user manual should be followed.
- Check that the hose joints and connections are firm and no water can leak. If joints are loose or there is leakage turn off the water supply and refit. Do not use the washer dryer until the hoses are properly fitted.
- It is obligatory for the completed installation to comply with all relevant building regulations and local water authority requirements.

Installation continued...

- ***Before the first use of the appliance, we advise that a 90°C wash programme is completed, using the 'self clean' function. No garments should be placed inside the machine; however a small amount of detergent must be used.***

During use

- It is recommended that the appliance is unplugged and the water supply is turned off after the machine is used.
- This appliance is only designed to wash & dry normal domestic wash loads. If you use your washer dryer in any other way or it is incorrectly used, then the manufacturer accepts no liability for any damage that might be caused and any guarantee will be void.
- No attempt should be made to alter or modify the specifications of this appliance.
- The detergents that you place in this appliance should be suitable for automatic washing machines. With regards to dosage levels, the detergent manufacturer's recommendations should be followed.
- You should not wash garments that have been in contact with flammable materials.
- Your washer dryer should not be used for dry cleaning.

- If you use either dyes or bleaching agents inside this machine, then you should consult with the manufacturer of these products to make sure they are suitable for use in your washer dryer. The manufacturer cannot be held responsible for any damage that may result.
- Do not open the detergent distribution drawer during the wash cycle.
- Do not install the washer dryer directly on to carpet.
- Do not dry unwashed garments in the washer dryer.
- Do not attempt to force the washer dryer door open. The door is fitted with a self lock device that will release shortly after the cycle is completed.
- Do not stop the washer dryer before the end of the drying cycle. If the drying cycle has to be interrupted quickly remove all clothes and spread them out to allow heat to dissipate.
- The supply cord cannot be replaced. If the cord is damaged the appliance should be scrapped.
- This appliance is not intended for use by persons (including children) with reduced physical, sensory or mental capabilities, or lack of experience and knowledge, unless they have been given supervision or instruction concerning use of the appliance by a person responsible for their safety.

During use

- ***If the supply cord is damaged, it must be replaced by the manufacturer, its service agent or similarly qualified persons in order to avoid a hazard.***
- ***WARNING: In the appliance enclosure or in the built-in structure, keep ventilation openings clear of obstruction.***

Child safety

- Your washer dryer should only be used by adults. You should not allow children in the area of the machine unsupervised. You should not let them touch the controls or play with the appliance.
- It could be possible for a child or pet to gain access to the washer dryer through the porthole door. Therefore please check the drum before using the appliance.
- Any packaging that is removed from the machine should be kept away from children.
- All detergents should be kept out of children's reach in a safe place.

Operation

BWD60CL Washer Dryer

Product specifications

- 11 wash programmes
- 1 drying programme
- 6kg wash load
- 3kg dry load
- 1200 rpm maximum spin speed
- LED display
- Delay start timer
- Digital countdown indicator
- Spin and temperature selection buttons
- Child lock
- Stainless steel drum
- Adjustable feet
- Error code failure system
- Overflow protection
- Foam protection
- Imbalance control system
- Self-clean function (drum cleaning)

Energy efficiency

Energy rating	B
Wash performance	A
Water extraction performance	B
Drying performance	B

Control panel

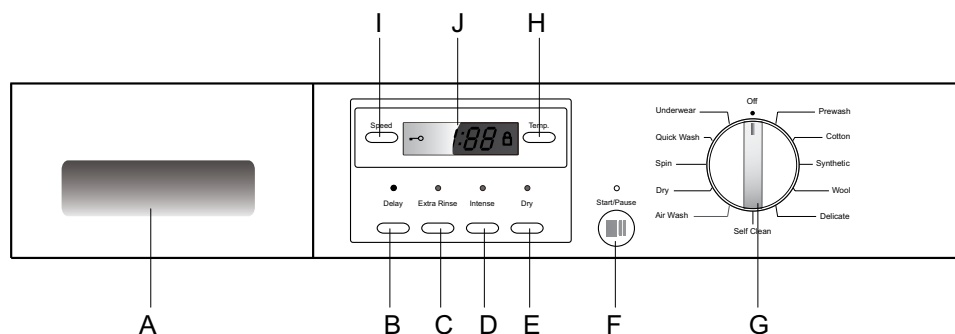

- A Detergent drawer
- B Delay button
- C Extra rinse button
- D Intense button
- E Dry button

- F Start/Pause button
- G Program knob
- H Wash temp button
- I Spin speed button
- J LED display



Note: Not all optional functions are available for every wash programme.

Detergent drawer

- The drawer contains three compartments:
 - 1: Prewash detergent;
This compartment should have detergent placed in it only if you are going to select a wash programme that has a prewash cycle as part of it.
 - 2: Main wash detergent;
This compartment should have detergent placed in it (you should also put a water softening agent in this section, if you use one).
The detergent will be added to the drum at the start of the main wash programme
 - 3: Fabric softener;
This compartment should be used for liquid conditioners (fabric softener, starch). They will be added to the wash load during the final rinse.

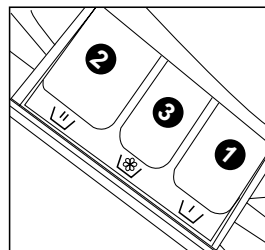

Delay button

- Touch this button lightly, the washer dryer will start operation after a period of time and the corresponding indicator will go on. The range is 0.5-24 hours; each touch of this button increases half an hour. After the button is set, press the Start/Pause button to start countdown of the set time.

Extra rinse button

- Press this button, the washer dryer will perform additional rinses. Press the button once to select one additional rinse. The display will show "P--1". Press the button repeatedly and the screen will display "P--2" or "P--3"; indicating two or three additional selected rinses. The "extra rinse light" is activated and flashes during the performance. "P--1/2/3" is displayed. The light turns off and the display disappears when the extra rinse ends



Note: Some programmes are not applicable to this function.

Intense button

- Touch this button lightly, the indicator light will be light on. You can increase the washing time, rinsing times in main wash stage of the selected program, which is suitable for dirty clothes.

Operation

BWD60CL Washer Dryer

Dry button

- Press the button to select, the dry indicator light will illuminate. The washer dryer perform drying function only.

Start/Pause button

- When the washer dryer is connected to the power socket and a program is selected, lightly touch this button to start operation. During a wash cycle, touch it lightly, operation will stop and the indicator light starts blinking. Touch it again to resume operation. To cancel a wash program during a wash cycle, touch his button, when the indicator light start blinking, turning the program knob to "off", the program will be cancelled.

Program knob

- By turning the knob clockwise/counter-clockwise, the required program can be selected. There are 11 programs available.



Note: Program off only use to turn off the washer dryer.

Wash temp button

- Touch this button lightly, the washing temperature will be displayed on the display screen. Select a temperature according to the type of laundry.

Spin speed button

Touch this button lightly to select the desired speed. When a speed is set, it will be displayed on the display screen.



Note: Different water temperatures and spinning speeds can be set for different laundries. Wash using the default settings if there is no special requirement.

LED display

- Information as remaining wash time and error messages will be shown here.



Note: After a wash program is started the display will go on and the remaining wash time decreases. As the water pressure and temperature may differ, the remaining time may be adjusted accordingly. When the laundry is not balanced during spinning, the time may be automatically prolonged.

Preparing the wash cycle

Preparing your garments for washing

- Your washing should be sorted out, according to the fabric type and the wash care symbol that is printed on the garment's wash care label (see separate section "a selection of wash care symbols").
- Your washing should also be sorted out according to the degree of soiling.
- Check all pockets on garments to make sure that they are empty.
- Remove any detachable metal items (badges, paperclips, safety pins etc).
- Zips should be closed, duvet covers and pillow cases should be buttoned up and any loose straps should be tied up. This will help to prevent other garments from getting damaged during the wash.
- Woollens and knitted coloured fabrics should be turned inside out before being washed in the appliance.
- Small delicate items (tights, baby socks, etc) should be placed in either a washing net or a zipped pillow case.
- Curtains should be handled with particular care. All plastic hooks or metal strips must be removed before being washed in the appliance.
- Coloured items and whites should be washed in separate wash cycles.
- New garments often contain an excess of dye, therefore it is advisable to wash them separately for their first wash.
- Garments should be unfolded and shook out before being placed inside the machine.

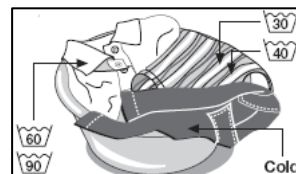
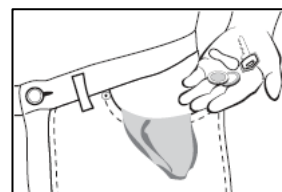
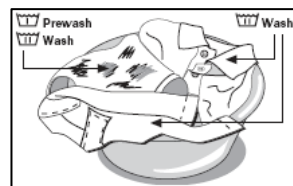

Operation

BWD60CL Washer Dryer

Program selection

Program modes

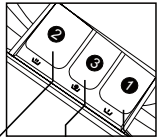
	Program	Temperature					<ol style="list-style-type: none"> 1. Detergent compartment for prewash mode. 2. Detergent compartment. 3. Compartment for softener and other additives. 	
		Maximum	Preset				Laundry type	Preset spin speed
1	Air Wash	--	--	<input checked="" type="checkbox"/>	<input type="checkbox"/>	<input checked="" type="checkbox"/>	Cotton fabrics	No spin
2	Dry	--	--	<input checked="" type="checkbox"/>	<input checked="" type="checkbox"/>	<input checked="" type="checkbox"/>	3kg maximum	No spin
3	Spin	--	--	<input checked="" type="checkbox"/>	<input checked="" type="checkbox"/>	<input checked="" type="checkbox"/>	None	1000rpm
4	Quick wash	-- to 30°C	0°C	<input checked="" type="checkbox"/>	<input type="checkbox"/>	<input type="checkbox"/>	Cotton or synthetic	800rpm
5	Underwear	-- to 90°C	60°C	<input checked="" type="checkbox"/>	<input type="checkbox"/>	<input type="checkbox"/>	Underwear	1000rpm
6	Prewash	-- to 90°C	40°C	<input checked="" type="checkbox"/>	<input type="checkbox"/>	<input checked="" type="checkbox"/>	Cotton fabrics	1000rpm
7	Cotton	-- to 90°C	40°C	<input checked="" type="checkbox"/>	<input type="checkbox"/>	<input checked="" type="checkbox"/>	Cotton fabrics	1000rpm
8	Synthetic	-- to 60°C	40°C	<input checked="" type="checkbox"/>	<input type="checkbox"/>	<input checked="" type="checkbox"/>	Fast colour synthetic	1000rpm
9	Wool	-- to 40°C	0°C	<input checked="" type="checkbox"/>	<input type="checkbox"/>	<input checked="" type="checkbox"/>	Woollen fabrics	600rpm
10	Delicate	-- to 40°C	0°C	<input checked="" type="checkbox"/>	<input type="checkbox"/>	<input checked="" type="checkbox"/>	Cotton or synthetic	600rpm
11	Self clean	-- to 90°C	90°C	<input checked="" type="checkbox"/>	<input checked="" type="checkbox"/>	<input checked="" type="checkbox"/>	None	1000rpm
Note: Program off only use to turn off the washer dryer. <input checked="" type="checkbox"/> Yes <input checked="" type="checkbox"/> No <input type="checkbox"/> Optional								

Consumption and technical data

Consumption table

Program	Max. load	Temperature	Washing time	Spin drying performance	Energy consumption	Water consumption
Air Wash	2kg	--	0:30	--	--	--
Dry	3kg	--	2:00	--	--	--
Spin	6kg	--	0:12	--	--	--
Quick Wash	3kg	--°C	0:15	--	--	--
Underwear	3kg	60°C	1:51	--	--	--
Prewash	6kg	40°C	2:04	--	--	--
Cotton	6kg	40°C	1:49	--	--	--
*) Cotton	6kg	60°C	3:00	53%	0.91kwh	57L
Synthetic	3kg	40°C	1:10	--	--	--
Wool	2kg	--°C	0:45	--	--	--
Delicate	1kg	--°C	0:45	--	--	--
Self Clean	--	90°C	1:00	--	--	--

The standard 60°C and 40°C cotton programmes are suitable to clean normally soiled cotton laundry and they are the most efficient programmes in terms of combined energy and water consumptions for washing that type of cotton laundry; The actual water temperature may differ from the declared cycle temperature.

Energy Label Program Settings:

1. Washing "Cotton+60°C+Intense+Max speed"
2. Drying: "Dry"

Washing methods



Warning

This Washer Dryer is for domestic use only. Do not use it for purposes other than that for which it was designed. Follow the instructions given on the label of each garment and wash only machine-washable garments. Do not dry garment that has been cleaned with industrial chemicals.

Power supply

- Connect the washer dryer to the power supply (220V to 240V~/50Hz).

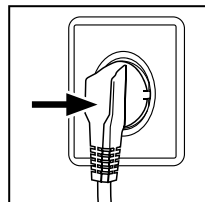

Water connection

- Connect the washer dryer to the water supply.



Note: Before use, check for any leaks in the joints between the tap and the inlet hose by turning on the tap.

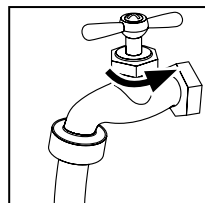

Preparing the laundry

- Sort out clothes according to fabric (cotton, synthetics, wool or silk) and to how dirty they are.
- Separate white clothes from coloured ones. Wash new garments first time by hand to check if they fade or run.
- Empty pockets (keys, coins, etc.) and remove the harder decorative objects (e.g. brooches).

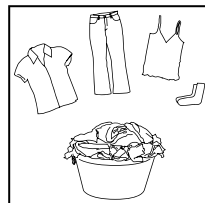

Attention!

Small parts (like buttons, etc.), or sharp (zips & buckles) items may cause damage to the machine.

Washing methods

- Garments without hems, underwear, finely woven textile such as fine curtains are to be put into wash bag (it is better not to wash them in a washer dryer).
- Close zippers and hooks, make sure the buttons are sewn on tightly and place small items such as socks, belts, bras, etc. in the wash bag.
- Unfold large pieces of fabric such as bed sheets, bedspreads, etc.
- Turn shirts inside out.

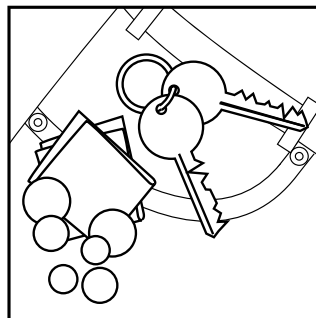

Selecting detergent

- The washing efficiency and the performance is determined by the quality of detergent used. Special non-foaming detergent produces good washing results. Use specific detergents for synthetic and woollen goods. Do not use dry cleaning agents such as trichloroethylene and similar products.



Note: Do not add more detergent than needed. Please follow the usage recommendation on the detergent package.

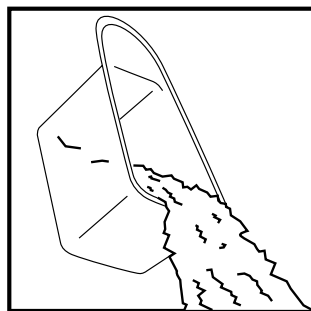

Adding detergent

- Slide out the detergent drawer and put the required detergent and softening agent into the corresponding compartments. Push back the drawer gently. (Refer to the instructions on the drawer).

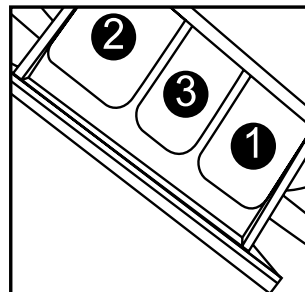

Washing methods



Caution:

- For prewash program, detergent should be added to both compartments 1 and 2. For other programs, do not add detergent to compartment 1.
- Use liquid detergent according to the instructions on its package. Do not use liquid detergent if the Prewash mode or "Delay" is selected.
- Do not overuse softener as it may damage artificial fibres.

Selecting program

- To get the best washing results, an appropriate washing program should be selected according to the laundry type. Please turn the program knob to select the correct program.

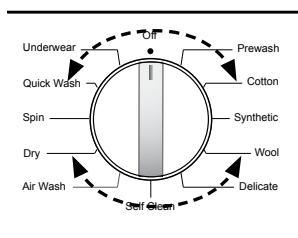

Selecting additional functions

- Select the required options. (Refer to the "Control panel" pages 08,09 and 10). Otherwise keep all the buttons deselected. If you wish to dry your laundry directly after the wash cycle is finished, please press the 'Dry' button.

Changing the spin speed

- Touch this button lightly to select the desired speed.
- The max spin speed is different according to each program.

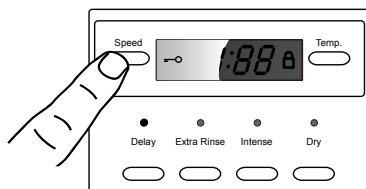

Changing the washing temperature

- Press and hold down the temperature button until the desired temperature is selected the symbol "--" for no water heating.

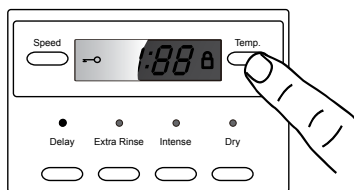

Washing methods

Start washing

- When the washer dryer is connected to the power socket and a program is selected, lightly touch this button to start operation. During a wash cycle, touch it lightly, the operation will pause and the indicator light start blinking. Touch it again to resume operation. To cancel a wash program during a wash cycle, turn the control to off.
- The washer dryer will stop operation automatically when a washing cycle ends. The "End" sign will appear on the display. Open the washer door and take out the laundry.

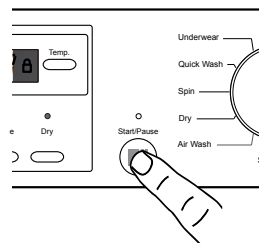

Note:

- The washer is locked if there is excessive water inside the appliance. Turn the control to spin to remove water. After removing the water, turn the control to off. Then start the new operation.
- To save energy, the appliance is off after a period of time if the operation is not confirmed. Turn the control to off for around 1 minute and start a new operation.

After washing

- Turn off the water supply and unplug the power cord. Open the washer door to prevent formation of moisture and odours. Leave the door open when not in use.

Drying method

Start drying

- Press the dry button. The moisture in the clothes is sensed automatically. Press the Start/Pause button to start the drying cycle. The appliance will switch off once the clothes are dry.

Tips for saving energy

- Collect clothes for one full wash load.
- Avoid overloading the washer dryer.
- Prewash only heavily soiled clothes.
- Reduce the amount of detergent or choose Express 15' or delicate wash programs for slightly soiled clothes.

Operation

BWD60CL Washer Dryer

Drying method

- Choose a proper washing temperature. Modern detergents can wash with very good result already in lower temperature than 60°C. Only use higher temperature than 60°C for heavily soiled laundry.
- Follow the dosage recommendation on the detergent package to avoid using too much detergent.

Care guide

Machine wash, COLD	Hand wash	Tumble dry, NO HEAT	Do not tumble dry	Iron, steam or dry, with LOW HEAT
Machine wash, WARM	Do not wash	Tumble dry, LOW HEAT	Line dry	Iron, steam or dry, with MEDIUM HEAT
Machine wash, HOT	Bleach as needed Any bleach like clorox®, may be safely used	Tumble dry, MEDIUM	Drip dry	Iron, steam or dry, with HIGH HEAT
Machine wash, COLD Permanent press		Tumble dry, HIGH	Dry flat	Do not iron with steam
Machine wash, WARM Permanent press	Non-chlorine bleach as needed Use only a colour-safe bleach, like clorox 2®	Tumble dry, permanent Press, NO HEAT	Don't dry clean	Do not iron
Machine wash, HOT Permanent press		Tumble dry, permanent Press, LOW HEAT	Dry on clothes hanger	Dry-clean may appear with additional letters and/or lines take this item to a professional drycleaner
Machine wash, COLD Gentle cycle	Do Not Bleach No bleach product should be used including detergents with bleach - or follow bleach package test procedures to test for bleach safety.	Tumble dry, permanent Press, MEDIUM	Tumble dry, medium heat	
Machine wash, WARM Gentle cycle		Tumble dry, gentle cycle, NO HEAT	Tumble dry, low heat	Do not dry-clean
Machine wash, HOT Gentle cycle		Tumble dry, gentle cycle, LOW HEAT	Don't tumble dry	Dry cleaning with any solvent
	Wool mark	Tumble dry, gentle cycle, MEDIUM		Dry cleaning with pericloride

Load weight reference

Bed sheet (single)	Cotton	Approximately 800g
Blanket	Wool	Approximately 3000g
Blended fabric clothes	/	Approximately 800g
Jackets	Cotton	Approximately 800g
Jeans	/	Approximately 800g
Overalls	Cotton	Approximately 950g
Ladies Pyjamas	/	Approximately 200g
Shirts	/	Approximately 300g
Socks	Blended fabrics	Approximately 50g
T-Shirts	Canon	Approximately 300g
Underwear	Blended fabrics	Approximately 70g

Please note

The final part of a drying cycle is a cooling cycle without heat to ensure that the dried items are left at a temperature that keeps them undamaged.

Care and maintenance

After washing.

- Turn off the water supply and pull out mains plug after each wash. Open the appliance door to prevent formation of moisture and odours. If the washer dryer is left idle for a long period, drain the water in the machine and replace the drain hose.

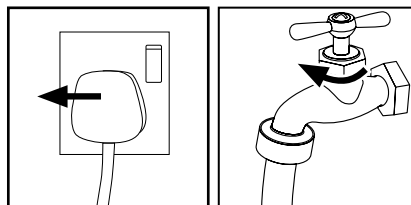

Cleaning the detergent drawer

- Pull out the drawer and press the blue catch in the conditioner compartment flush it clean under the cold tap and replace by aligning with the machine and pressing forwards.

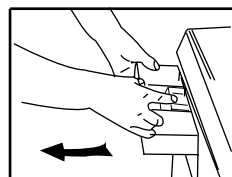

Care and maintenance

Cleaning the machine

- Unplug the machine during cleaning and maintenance. Use a soft cloth dampened with soap to clean the machine case and rubber components. Do not use organic chemicals or corrosive solvents.

Cleaning the filter

- Release the screw then pull out the bottom cover.
- Pull out the bail tube that is to the left of the drain pump filter. Place the end of the tube into an adequately sized bowl. Remove the bung from the end of the tube and drain the water. Reinstall the plug and push the bail tube back.
- Remove the filter by turning counter-clockwise.
- Flush the filter clean with running water.
- Replace the filter by turning clockwise and remount the cover.

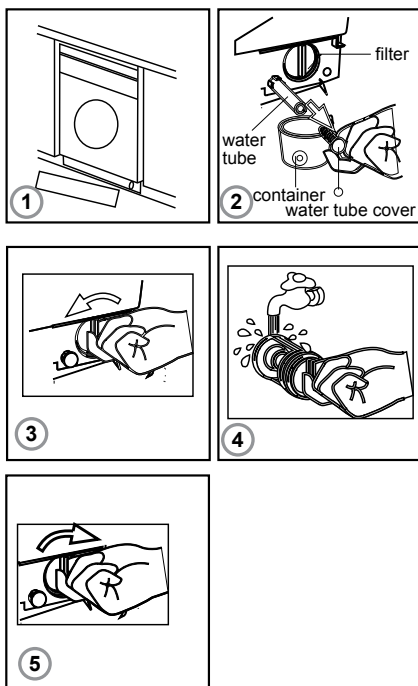

Caution!

- The filter must be in place, or it may lead to leakage.
- Place a container under the drain pump filter, to collect any excess water that may come out the drain pump when the filter is removed.

Water inlet valve and inlet valve filter

- To prevent blockage to the water supply by ingress of foreign substances, clean the water inlet valve and inlet valve filter regularly.

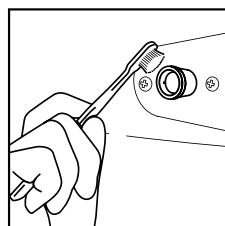

Care and maintenance

Moving the machine

If the machine is to be moved, replace the transportation bolts that removed before installation to prevent damage as shown below.

1. Remove the back cover.
2. Remove the blanking plugs.
3. Insert the plastic stabilisers and the transportation bolts. Tighten the bolts with a spanner.
4. Refit the back cover.

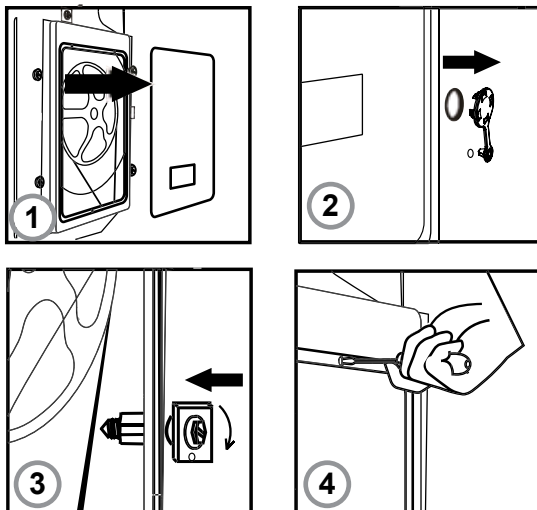

Long periods without operation

- If the washer dryer is left idle for a long period, pull out the electrical plug and turn off the water supply. Open the washer door to prevent formation of moisture and odours while not in use.

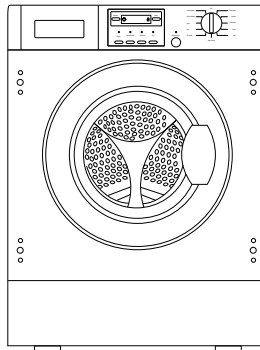

Special function codes

- Control panel lock function: Press the "Delay" and the "Extra Rinse" buttons simultaneously for 3 seconds (a face icon is shown) after starting a program. It can no longer be changed by operating buttons or knobs. To unlock press the "Delay" and "Extra Rinse" buttons again for 3 seconds.
- Power-off memory function: In case of abrupt power failure or the need to cut off the power during a program cycle, the present settings will be saved and the preset operation will resume when the power is on again.
- To cancel a program

Special function codes

Press the "Start/Pause" button, then switch off the power and the program is automatically cancelled. Turn the program selector again to choose another program.

Alarm sound can be cancelled if it is needed. Please follow the instruction as below: Switch on the washer dryer and turn the program knob to spin cycle, then press the "Intense" and "Dry" button, hold on for 3 seconds. The "BEEP OFF" will be displayed on the screen which indicates that alarm sound has been cancelled. To operate the above steps again so the alarm sound can be recovered and the display will show "BEEP ON".

Troubleshooting

The following circumstances do not constitute problems. Do not contact the Service Centre until the problem has been confirmed.

Fault	Cause	Solution
Washer dryer fails to operate.	Poor connection to the power supply.	Check connection to the power supply.
	Power failure.	Check the power supply.
	The washer door is not properly closed.	Close the washer door properly.
	Machine has not been switched on.	Make sure the machine is switched on.
Washer dryer cannot be filled with water.	The "Start/Pause" button is not pressed.	Press the "Start/Pause" button.
	Water tap is not turned on.	Turn on the water tap.
	Water pressure is less than 0,03 Mpa.	Check water pressure.
	The inlet hose is kinked.	Check the inlet hose.
	Water supply failure.	Ensure there is a water supply.
	The program knob is not properly set.	Set the program knob properly.
	The washer door is not properly closed.	Close the washer door properly.
	The inlet hose filter is blocked.	Unblock the inlet hose filter.

Troubleshooting

Fault	Cause	Solution
Machine is draining while being filled.	The height of the drain hose is below 80cm.	Install drain hose within 80-100cm of height.
	The drain hose is in water.	Make sure the drain hose is not in water.
Drainage failure.	Drain hose is blocked.	Unblock the drain hose.
	Drain hose end is higher than 100cm above the floor level.	Make sure the drain hose end is between 80-100cm above floor level.
	The filter is blocked.	Unblock the filter.
Strong vibration while spinning.	Not all transportation bolts have been removed.	Remove all transportation bolts.
	Washer dryer is located on an uneven surface or is not level.	Make sure the washer dryer is on an even surface and levelled.
	Machine load is over 6 kg.	Reduce amount of laundry in the drum.
Operation stops before completing wash cycle.	Water or electricity failure.	Check the power supply.
	The "Start/Pause" button is pressed.	Press the "Start/Pause" button.
Operation stop for a certain period of time.	Washer dryer gives an error message.	Check display codes.
Excessive foam in the drum, which is spilled to the distribution drawer.	The detergent is not a low-foaming type or for hand wash.	Check if your detergent is appropriate.
	Excessive use of detergent.	Reduce amount of detergent in the distribution drawer.
The indicated program duration changes during the cycle.	The program duration will be adjusted during the cycle due to external factors.	This is normal and doesn't affect the functionality.
Spinning fails.	The machine has been set drain time before spin.	Wait for a while before spin.
	Unbalance of the laundry.	Reposition the laundry or run a spinning program again.

Poor wash results

My garments are looking grey and there are limescale deposits present in the drum of my washer dryer.

- There is not enough detergent being added.
- The incorrect detergent is being used.
- Stains are not being pre-treated.
- The correct wash programme or wash temperature was not selected.

I have followed the advice given above, but my garments are still coming out with grey stains on them.

- The garments are soiled with oils, ointments or grease. Try using specialist stain treatments. Rewash the garments ensuring the correct wash temperature has been selected.
- Fabric conditioner has come into contact with the garments. This could be due to overfilling the fabric conditioner compartment. If this happens try to wash out these stains as quickly as you can and try to avoid getting conditioner on the garments in future.

After the final rinse, I can still see foam.

- Modern detergents can result in there still being foam in the final rinse, this does not mean that the washing is not being rinsed properly.

There is white residue on my garments when I remove them from the appliance.

- Modern detergents can contain insoluble contents, and white residue after a wash cycle is not necessarily a sign of the garments not being rinsed properly.
- You should shake out the garment or brush it off. In future possibly turn the garment inside out before it is washed. You may wish to move from a powder detergent and switch to a liquid detergent instead.

Removing stains

Garments that are covered in stains, grease or are heavily soiled may need to be pre-washed or soaked before being placed inside of the washer dryer.

- Soaking helps to remove protein-type stains, like blood, milk or grass.
- Pre-washing helps to loosen soil before the main wash.

Poor wash results

Stain removal rules

- Use warm water for soaking or pre-washing stained laundry. Hot water can set stains.
- Most stains are easier to remove when they are fresh.
- Before treating any stain try to establish; what kind of stain it is, how old the stain is, what the fabric type is and whether the fabric is colourfast (check the care label to find this out).
- Washing and drying can fix some stains.
- When bleach is recommended, use a mild fabric bleach that is safe for the fabric.
- If you need to use a stain remover, put the stained area face down on a paper towel or white cloth. Apply the stain remover to the back of the stain. This forces the stain off the fabric, instead of through it.

Stain removal guide

Stain	Removal method
Alcoholic beverages	The stain should be first washed with cold water, then wiped with glycerine and water and rinsed with water mixed with vinegar.
Shoe polish	The stain should be softly scratched without ruining the material, then rubbed with detergent and rinsed. In case it is not eliminated, rub with 1 unit of pure alcohol (96 degrees) mixed in 2 units of water and then washed with lukewarm water.
Tea and coffee	Stretch the stained area of material on the top of a container and pour water as hot as the material can endure on it. If the type of material is suitable, wash it with lye (Do not use lye on coloured clothes)..
Chocolate and cocoa	Leave your clothes in cold water and rub with soap or detergent, wash it in the highest temperature that the material type can endure. If there is still a stain of oil left, wipe with oxygenated water (in proportion of 3%).
Tomato paste	Scrape the dried pieces without ruining the material, then leave in cold water for about 30 minutes and wash by rubbing with detergent.
Meat broth or egg	Eliminate the dried stain residues and wipe with a sponge or soft cloth wetted in cold water. Rub with detergent and wash with diluted lye (Do not use lye on coloured clothes)..

Stain removal guide

Stain	Removal method
Grease and oil stains	First wipe the residues. Rub the stain with detergent and then wash with lukewarm soapy water.
Mustard	First apply glycerine to the stained area. Rub with detergent and then wash. If the stain still does not disappear, wipe with alcohol (on synthetic and coloured cloth, a mixture of 1 unit alcohol, 2 units water should be used).
Blood stain	Lay your clothes in cold water for 30 minutes. If the stain still does not disappear, lay in mixture of water and ammonia (3 table-spoons of ammonia in 4 litres of water) for 30 minutes.
Cream, ice cream and milk	Lay your clothes in cold water and rub the stained area with detergent. If the stain has still not disappeared, apply lye on the fabric of your clothes in proper proportion (Do not use lye on coloured clothes).
Mould	Mould stains should be cleaned as soon as possible. The stain should be washed with detergent, and if it does not disappear, it should be wiped with oxygenated water (in proportion of 3%).
Ink	Hold the stained area under cold water and wait until the inky water completely runs off. Then rub with water diluted with lemon juice and detergent. Wait 5 minutes and then wash.
Fruit	Stretch the stained area of your clothes on the top part of a container and pour cold water on it. Do not pour hot water on the stain. Wipe with cold water and apply glycerine. Wait for 1-2 hours and rinse after wiping with a few drops of white vinegar.
Grass stain	Rub the stained part with detergent. If the type of fabric is suitable for use of lye, wash it with lye. Rub your woollen clothes with alcohol (for coloured one, a mixture of 1 unit pure alcohol and 2 units of water).
Oil paint	The stain should be eliminated before it dries by applying thinner on it. Then it should be rubbed with detergent and washed.
Burnt stain	If your fabric is suitable for the use of lye (Do not use lye on coloured clothes), you can add lye into your washing water. For woollen fabrics, a cloth dampened in oxygenated water should be pressed on the stain and it should be ironed with a dry cloth on it. It should be washed after rinsing well.

Technical specifications

Model number	BWD60CL
Power source	220.240V~/50Hz
Max. working current (A)	10
Water pressure (MPa)	$0.03 \leq P \leq 1$
Nominal load (kg)	6
Spinning speed (r/min)	1200
Washing programs	11
Drying programs	1
Max power (W)	2000
Dimensions (H x D x W mm)	825 x 535 x 595
Net weight (kg)	64
Power consumption of the off-mode (W)	0.48
Power consumption of the left-on (W)	0.48
Dry heating (W)	1400
Dry load (kg)	3

Recycling and disposal

Environmental protection

Waste electrical products should not be disposed of with household waste. Please recycle where facilities exist. Check with your Local Authority or retailer for recycling advice.



The symbol on the product or its packaging indicates that this product cannot be treated as normal household waste. This product must be handed over to an electric and electronic equipment collection point for recycling.

On ensuring that this product is disposed of correctly, you will help to avoid possible negative consequences for the environment and public health, which could occur if this product is not handled correctly. To receive more detailed information about recycling this product, contact your local government, domestic waste disposal services or the outlet where the product was bought.



Warning

Before discarding an old appliance, switch off and disconnect it from the power supply. Cut off and render any plug useless. Cut the cable off directly behind the appliance to prevent misuse. This should be undertaken by a competent person. Disable the door lock to make sure that children cannot get stuck inside the appliance.

Guarantee

This appliance is covered by a full manufacturer's 2 year parts and 2 year labour guarantee and covers all parts and labour costs associated with the repair of the appliance in a domestic environment. We will repair any defect that arises due to faulty materials or workmanship and use genuine manufacturers parts.

All claims must be supported with the original receipt or other reasonable proof of purchase.

If, during the guarantee period, the appliance becomes irreparable as agreed by the engineer approved by GAA then we reserve the right, at our discretion, to exchange the defective product with a replacement appliance at GAA's sole cost. If the same product is no longer available an alternative will be offered with the same functions as the faulty item.

After an appliance has been repaired or replaced any remaining balance of the GAA guarantee will be valid and any further call outs during this prescribed period will be covered by GAA on the replacement appliance.

Should any person other than an authorized engineer modify or attempt to repair the appliance then the warranty will be invalid.

The guarantee applies to the UK mainland, Scotland, Ireland, ROI and France but is not transferable between EU countries.

This guarantee is non-transferable to any other person or product.
The guarantee is covered by UK law and is in addition to and does not diminish your legal rights.

Extended parts only warranty

As testimony to our commitment to you as a valued customer of Cooke & Lewis, we will offer you an additional 3 years parts warranty absolutely free.

If during the extended parts warranty period the appliance fails and it is considered uneconomical to repair our Customer Service Department will offer you the opportunity to purchase the same or equivalent model at a discounted price.

All parts supplied free of charge under the extended warranty must be fitted by our approved engineers and will be subject to a call out charge to fit the part.

Guarantee

Exclusions to the guarantee

This guarantee does NOT cover:

Appliances that have been damaged or neglected as a result of failure to store, assemble, install, use or care of the products in accordance with the manufacturer's instructions - GAA will not accept responsibility under this guarantee if a product is damaged or becomes defective due to, misuse, neglect, wilful or accidental damage or act of god.

Normal wear and tear.

Consumable items such as carbon filters and bulbs.

Claims arising from non-domestic use or commercial environment.

Any gas appliance not fitted by a gas safe qualified installer.

If no fault is found then GAA reserves the right to charge for the call out at the going rate.

In the course of the service work carried out it may be necessary to remove the built in appliance from its fitted position. If the appliance is glued, grouted or tiled in such a manner that it cannot be removed, it is the responsibility of the customer/installer to remove and reinstall the appliance to facilitate the repair.

This Guarantee does not affect your statutory rights.

The guarantee is offered by GAA Ltd, 1301-1303 Lu Plaza,
2 Wing Yip St, Kwun Tong, Kowloon, Hong Kong.

Customer Service

To arrange an in guarantee service call, please contact customer services on the following numbers.

UK & Northern Ireland

Phone: 0844 800 1128

Email: uksupport@apelson.co.uk

Web: www.myspareparts.co.uk

Republic of Ireland (Eire)

Phone: 014475261

CE Declaration of Conformity

BWD60CL Washer Dryer

CE Declaration of Conformity

**MANUFACTURER: CATA****ADDRESS: C/ Ter nº 2, Torelló 08570 - Barcelona (Spain)**

We hereby certify that the mentioned accessory complies with the essential requirements of the European Directives applicable, including their modifications and the corresponding transpositions from the national law.

MACHINE APPLICATION: BWD60CL**TYPE :** Washer Dryer**EC DIRECTIVES APPLIED:** Comply with the European Directives 2006/95/CE: LVD and the 2004/108/CE: EMC**APPLIED HARMONIZED STANDARDS:**

EN 60335-2-25/A2:2006

EN 60335-2-6/A2:2008

EN 60335-1/A13:2008

EN 62233:2008

APPLIED INTERNATIONAL TECHNICAL STANDARDS AND SPECIFICATIONS: ISO9001.2008**PLACE: Torelló**

David Sala
Technical Manager

This appliance respects laws of the suppression of radio-interference. The Manufacturer has a policy of continuous product improvement, it reserves the right to adapt and carry out any modification considered necessary without prior warning.

B&Q plc,
Chandlers Ford, Hants,
SO53 3LE United Kingdom
www.diy.com

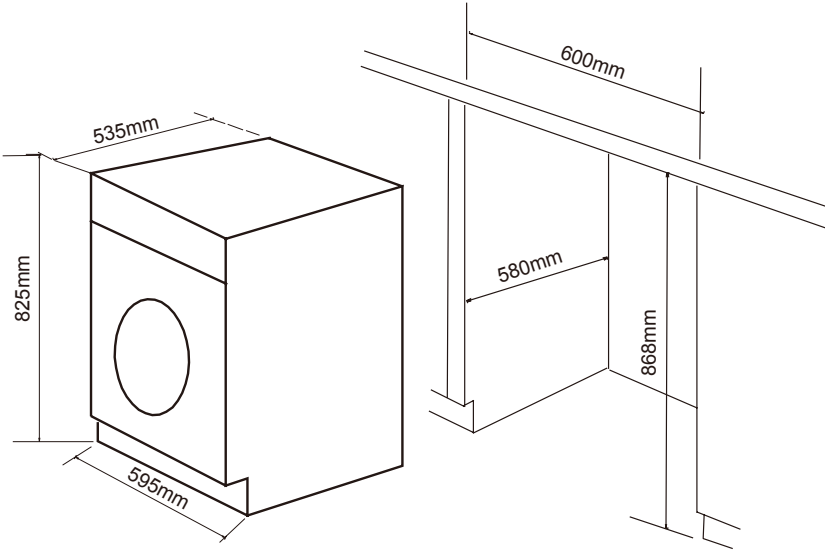

Appliance dimensions	Aperture dimensions
Height: 825mm	868mm
Width: 595mm	600mm
Depth: 535mm	580mm

02



WARNING

THIS INSTALLATION MUST BE COMPLETED BY A SUITABLY QUALIFIED PERSON. THE MANUFACTURER ONLY SANCTIONS THE INSTALLATION GIVEN IN THIS INSTRUCTION MANUAL. YOU SHOULD KEEP THE TRANSIT PACKAGING, IN CASE YOU NEED TO TRANSPORT THE MACHINE IN THE FUTURE.

Unpacking the machine and preparing for use.



Note: The bottom cover **MUST** be installed before your washer dryer is used for the first time, **AND** before removing the transit bolts.

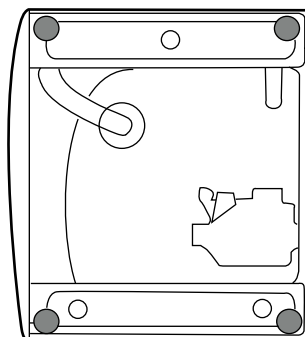

Lay down the washer dryer on its side and remove the four feet by unscrewing them.

03

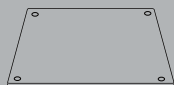

[03] x 1

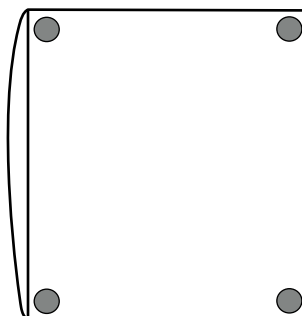

Place the bottom cover [3] over the bottom of the appliance and align the four screw holes with the four feet holes. You can then secure the feet back onto the appliance, thus securing the bottom cover in place.

Removing the transit bolts



Note: The transit bolts **MUST** be removed before your washer dryer is used for the first time.

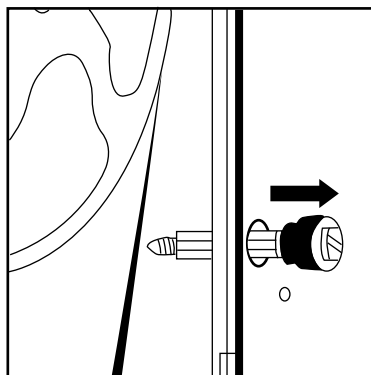

Remove the four transit bolts from the back of the appliance. The transit bolts stop the drum from rotating and reduce vibrations during transit.

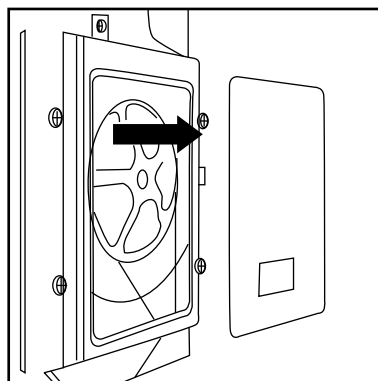

If required, you can remove the back cover of the appliance using a crosshead screwdriver to assist in removing the transit bolts.

06

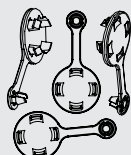

[04] x 4

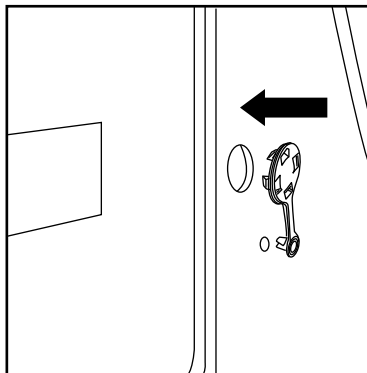

1. Insert the plastic caps (blanking plugs [4]) that are supplied, into the holes that you have removed the transit bolts from.
2. Keep the transportation bolts in a safe place for future use, should it be required.

07

Positioning and levelling the appliance

Place the washer dryer on a solid and level floor surface.

DO NOT PLACE THE WASHER DRYER ON A CARPET.

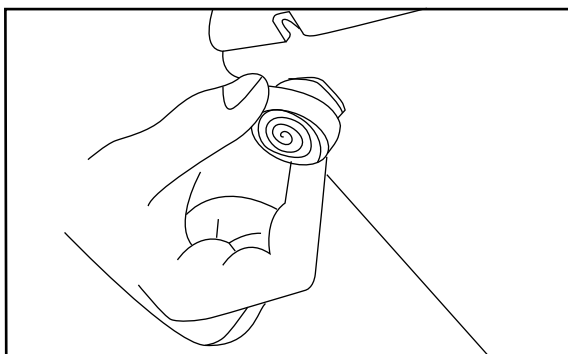

Loosen the adjustable feet that are positioned on the base of the appliance.

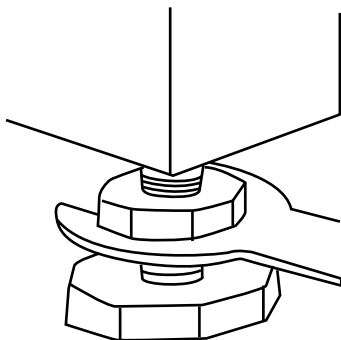

Slacken off the lock nut on each of the washer dryer feet using a spanner.

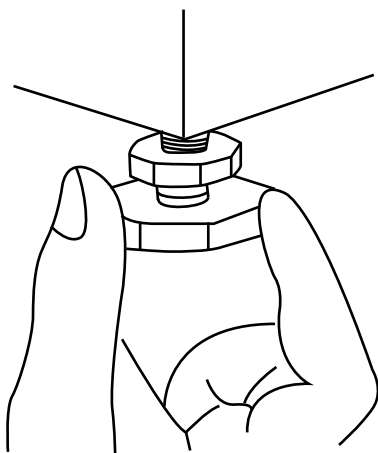

Adjust the feet to level off the washer dryer.

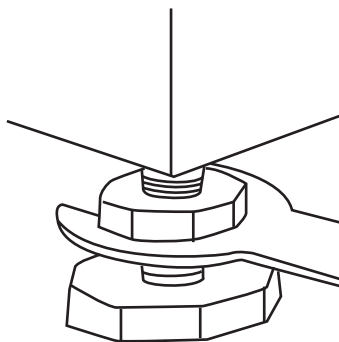

Once levelled correctly, you should tighten the lock nut back up on each of the washer dryer feet using a spanner.



Important

When the washer dryer is positioned in the location where it will be used. Make sure that all four feet are resting firmly on the floor, by pressing down on each corner and checking that the appliance stands still.

Connecting to the mains water supply



Important

The washer dryer should never be connected to the water mains using an existing inlet hose, ***YOU MUST*** utilise the inlet hose that is provided with the appliance.

Your appliance should only be connected to a cold water supply.

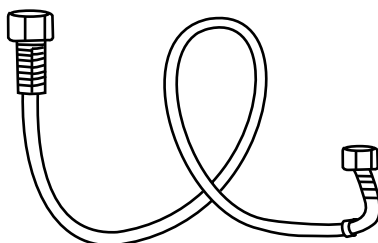

Take out the attached inlet hose [01].

12

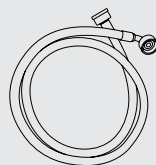

[01] x 1

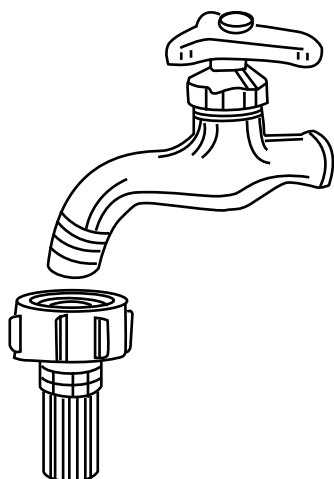

Attach the inlet hose [01] vertically to the spiral tap for the washer dryer.

13

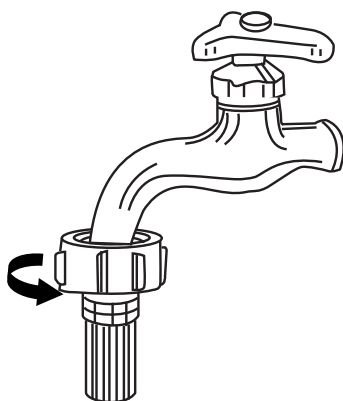

Screw the tap tightly in the direction of the screw thread of the inlet hose [01].

14

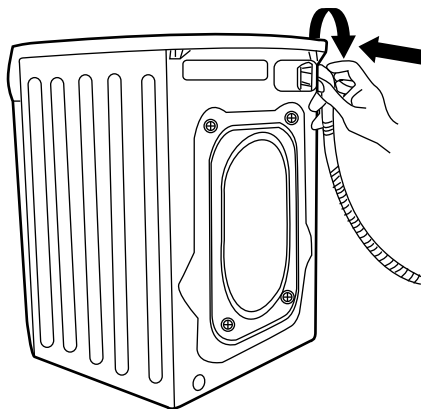

Connect the hose to the water inlet at the back of the washer dryer.



Important

When connecting the screw thread of the inlet hose and the inlet valve, prevent the screw thread from being secured incorrectly or it will wear or leak.

Do not over bend the inlet hose or this will cause damage.

15

Water outlet

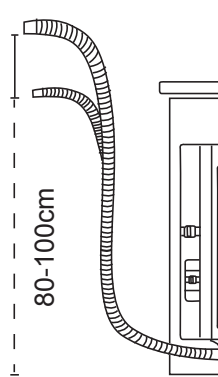
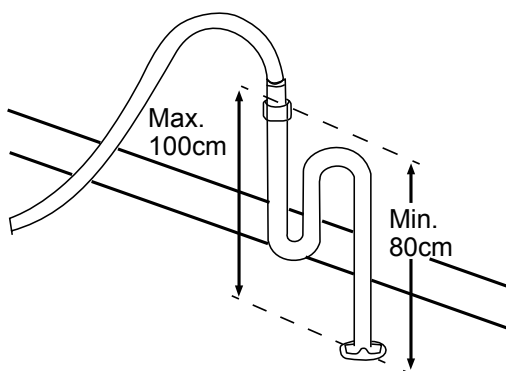

16

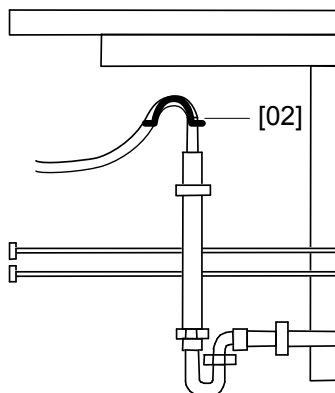
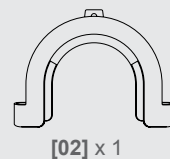

Secure the drain hose, so that it cannot move whilst the washer dryer is in use.

Place the end of the drain hose on your drain pipe. Push it a short way down into your drain pipe.



Caution

Do not insert the drain hose too deeply into the water pipe, as this may cause siphoning.

NEVER EXTEND THE DRAINAGE HOSE FROM ITS ORIGINAL LENGTH.

17

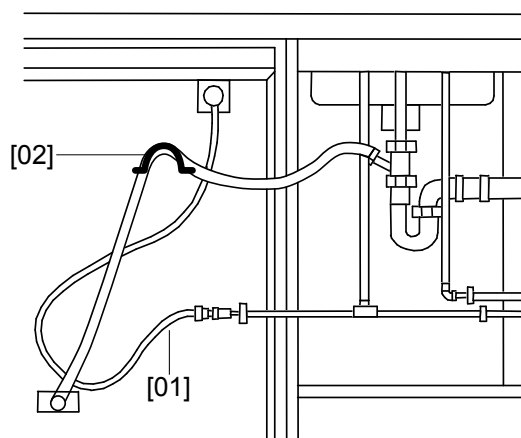

Alternatively, the drain hose can be connected directly to a sink waste. Ensure the U bend [02] is secured as high as possible to prevent water flowing from the sink back into the washing machine (fixing screw for the U-bend is not supplied).

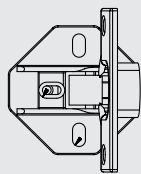

[05] x 2



[06] x 2



[07] x 1



[09] x 2



[10] x 8



[11] x 8

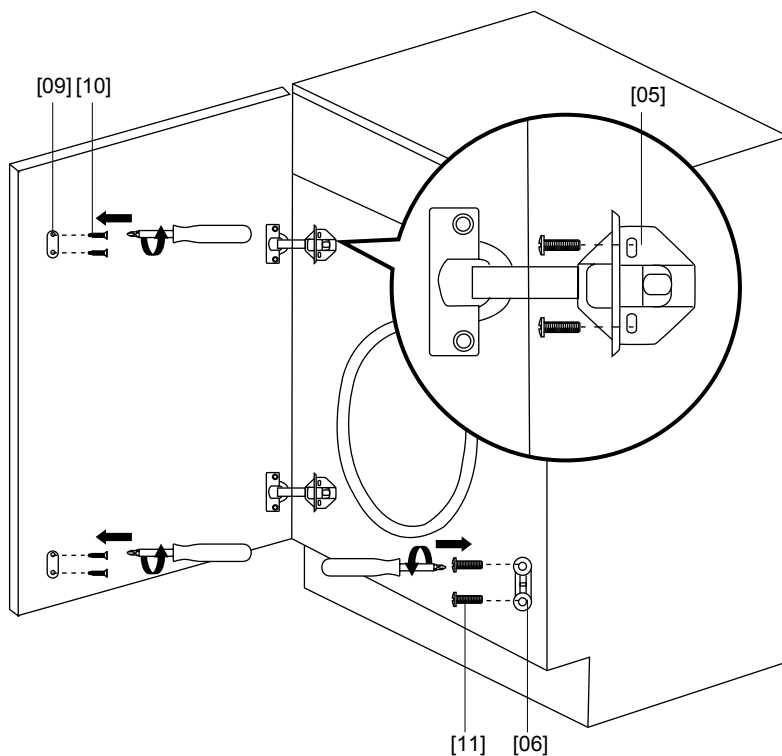

1. Please refer to the building in template for instructions on how to fit your integrated appliance and connect the furniture door to the product.
2. Mount the furniture door to the cabinet of the washer dryer, using the hinges supplied.
3. Fix the magnet assembly to the front of the washer dryer and the furniture door.

Connection to a power supply



Warning

As your appliance is a built in product, the electrical socket must still be accessible once the appliance is installed.

Consult the rating plate, located on the back of the appliance BEFORE making the electrical connections. Ensure that the voltage reaching the plug, is the same as that on the rating plate.

DO NOT REMOVE THE RATING PLATE AS THE INFORMATION ON IT IS IMPORTANT.

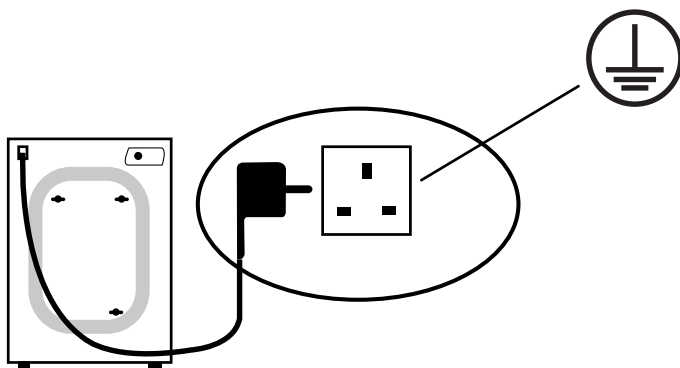

The moulded plug that is supplied with the appliance must be placed into an earthed and insulated socket.

Broken or damaged power leads must only be replaced by a suitably qualified person. A power lead of a similar type must be used in replacement.



Caution

We do not recommend that this appliance is connected to an extension lead.

Before first use maintenance wash

1. When your washer dryer has been correctly installed, we recommend that you perform a “self-clean” maintenance wash cycle.
2. This will check that all aspects of the installation are correct; it will also remove any deposits that may have been left on the drum by the manufacturing process.
3. Select the “Self Clean” wash programme.
4. A small quantity of detergent should be used during this maintenance wash.



B&Q plc,
Chandlers Ford, Hants,
SO53 3LE United Kingdom
www.diy.com
