

1										2									
A										A									
B										B									
C										C									
借（通）用件登记																			
描 图																			
描 校																			
旧底图总号																			
底图总号																			
标记处数										更改文件号									
签 名										日 期									
阶 段 标 记										比 例									
REV.										00									
数 量										重 量									
1																			
共 1 张										第 1 张									
1										2									

技术要求:

1. 印刷颜色为PANTONE BLACK C,彩色图片也按黑白印刷

2. 规格为A5

3. 如果供应商的排版需要加空白页,请加在最后。

图号

材料

105G双铜

广东美的集团股份有限公司美的洗涤电器制造有限公司

# Dishwasher

## Instruction Manual

DWIB60

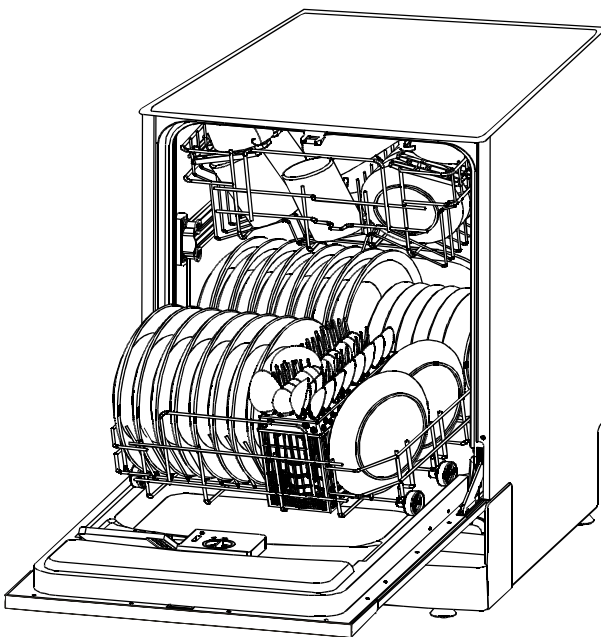

CNA TRADING APPLIANCES

Customer Service

In case of difficulty please call the Customer Service Helpline on our helpline number.

**0844 8001128**

When calling customer service, please ensure you have the model and serial number to hand.  
Please keep your receipt or invoice in a safe place as they will be required as proof of date of purchase.



IM DWIB60\_2010.07.21



## **Read this Manual**

Dear Customer,

- Please carefully read this manual before using the dishwasher, it will help you to use and maintain the dishwasher properly.
- Keep it to refer to it at a later date.
- Pass it on to any subsequent owner of the appliance.

This manual contains sections on Safety Instructions, Operating Instructions, Installation Instructions and Troubleshooting Tips, etc.



## **Before Calling for Service**

- To review the section on Troubleshooting Tips will help you to solve some common problems by yourself.
- If you can not solve the problems by yourself, please ask for the help of professional technicians.



## **NOTE:**

The manufacturer, following a policy of constant development and updating of the product, may make modifications without giving prior notice.

<b>1) Safety Information.....</b>	<b>1</b>
<b>2) Disposal.....</b>	<b>2</b>
<b>3) Operating Instructions.....</b>	<b>3</b>
Control Panel.....	3
Dishwasher Features.....	3
<b>4) Prior using for the first time.....</b>	<b>4</b>
A、Water Softener.....	4
B、Loading the Salt into the Softener.....	5
C、Fill the Rinse Aid Dispenser.....	5
D、Function of Detergent .....	7
<b>5) Loading the Dishwasher Basket.....</b>	<b>9</b>
Attention before or after loading the Dishwasher Baskets.....	9
Loading the upper Basket.....	9
Loading the Lower Basket.....	10
Cutlery Basket.....	11
<b>6) Starting a washing programme.....</b>	<b>13</b>
Wash Cycle Table.....	13
Turning on the Appliance.....	14
Change the Programme.....	14
At the End of the Wash Cycle.....	14
<b>7) Maintenance and cleaning.....</b>	<b>15</b>
Filtering System.....	15
Caring for the Dishwasher.....	16
<b>8) Installation instruction.....</b>	<b>17</b>
Please carefully read the installation instruction.....	18
Aesthetic panel's dimensions and installation.....	18
Tension adjustment of the door spring.....	20
Connection of drain hoses.....	20
Dishwasher installation steps.....	21
About Electricity Connecting.....	22
Water Connection.....	23
<b>9) Troubleshooting Tips.....</b>	<b>24</b>
Before calling for service.....	24
Error codes.....	25
Technical information.....	26
Warranty Description.....	27-29

# 1. IMPORTANT SAFETY INFORMATION

## READ ALL OF THE INSTRUCTIONS BEFORE USING

### WARNING!

When using your dishwasher, follow the precautions listed below:



### GROUNDING INSTRUCTIONS

- This appliance must be grounded. In the event of a malfunction or breakdown, grounding will reduce the risk of an electric shock by providing a path of least resistance of electric current. This appliance is equipped with a cord having an earthed plug.
- The plug must be plugged into an appropriate outlet that is installed in accordance with current legislation.

### WARNING!

- Improper connection of the earth can result in the risk of an electric shock.
- Check with a qualified electrician or service representative if you are in doubt whether the appliance is properly grounded. Do not modify the plug provided with the appliance; if it does not fit the outlet, have a suitable outlet installed by a qualified electrician.



### WARNING! PROPER USE

- Do not abuse, sit on, or stand on the door or dish rack of the dishwasher.
- Do not touch the heating element during or immediately after use.  
(This instruction is only applicable to machines with a visual heating element.)
- Do not operate your dishwasher unless all enclosure panels are properly in place. Open the door very carefully if the dishwasher is operating, there is a risk of water squirting out.
- Do not place any heavy objects on or stand on the door when it is open. The appliance could tip forward.
- When loading items to be washed:
  - 1) Locate sharp items so that they are not likely to damage the door seal;
  - 2) Warning: Knives and other utensils with sharp points must be loaded in the basket with their points down or placed in a horizontal position.
- When using your dishwasher, you should prevent plastic items from coming into contact with the heating element. (This instruction is only applicable to machines with a visual heating element.)
- Check that the detergent compartment is empty after completion of the wash cycle.
- Do not wash plastic items unless they are marked dishwasher safe or the equivalent. For plastic items not so marked, check the manufacturer's recommendations.
- Use only detergent and rinse additives designed for an automatic dishwasher.
- Never use soap, laundry detergent, or hand washing detergent in your dishwasher.
- Keep children away from detergent and rinse aid, keep children away from the open door of the dishwasher, there could still be some detergent left inside.
- This appliance is not intended for use by persons (including children) with reduced physical, sensory or mental capabilities, or lack of experience and knowledge, unless they have been given supervision or instruction concerning use of the appliance by a person responsible for their safety.
- Children should be supervised to ensure that they do not play with the appliance.
- Dishwasher detergents are strongly alkaline, they can be extremely dangerous if swallowed. Avoid contact with skin and eyes and keep children away from the dishwasher when the door is open.
- The door should not be left open, since this could increase the risk of tripping.
- If the supply cord is damaged, it must be replaced by the manufacturer or its service agent or a similarly qualified person in order to avoid a hazard.
- Remove the door to the washing compartment when removing an old dishwasher from service or discarding it.
- Please dispose of packing materials properly.
- Use the dishwasher only for its intended function.
- During installation, the power supply cord must not be excessively or dangerously bent or flattened. Do not tamper with controls.
- The appliance is to be connected to the water mains using new hose sets. Old hose sets should not be re-used.
- The maximum number of place settings to be washed is 12.
- The maximum permissible inlet water pressure is 1Mpa.
- The minimum permissible inlet water pressure is 0.04Mpa.

**READ AND FOLLOW THIS SAFETY INFORMATION CAREFULLY**  
**SAVE THESE INSTRUCTIONS**

## 2. Disposal

Dispose of the dishwasher packaging material correctly.  
All packaging materials can be recycled.  
Plastic parts are marked with the standard international abbreviations:

- PE — for polyethylene, e.g. sheet wrapping material
- PS — for polystyrene, e.g. padding material
- POM — polyoxymethylene, e.g. plastic clips
- PP — polypropylene, e.g. Salt filler
- ABS — Acrylonitrile Butadiene Styrene, e.g. Control Panel



### ⚠ WARNING!

- Packaging material could be dangerous for children!
- For disposal of packaging and the appliance please go to a recycling centre. Cut off the power supply cable and destroy the door lock mechanism to avoid the possibility of child entrapment.
- Cardboard packaging is manufactured from recycled paper and should be disposed in the waste paper collection for recycling.
- By ensuring this product is disposed of correctly, you will help prevent potential negative consequences for the environment and human health, which could otherwise be caused by inappropriate waste handling of this product.
- For more detailed information about recycling of this product, please contact your local council or your household waste disposal service.

DISPOSAL: Do not dispose of this product as unsorted municipal waste.

### 3. Operation Instruction

#### IMPORTANT!

To get the best performance from your dishwasher, read all operating instructions before using it for the first time.

#### Control Panel



**1** ON/OFF Button: To turn on/off the power supply.

**2** Power on light: Illuminates when the Power ON/OFF button is pressed down.

**3** Salt and Rinse Aid Warning Light: Comes on when the softener or dispenser needs to be refilled.

**4** Program indicator light: When you select the washing program, the corresponding light will display.

**5** Program button: Press the appropriate button to select the wash program required.

Strong  
 Economy  
 Rapid

Normal  
 Rinse

#### Dishwasher Features

Front View

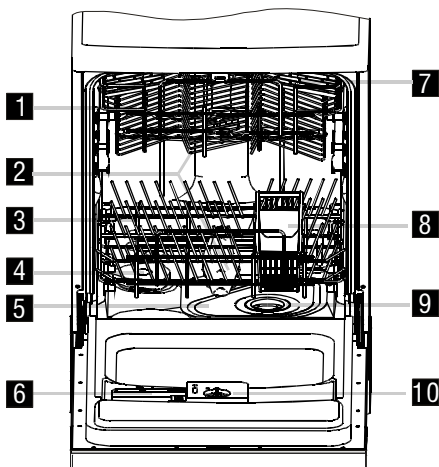

Rear View

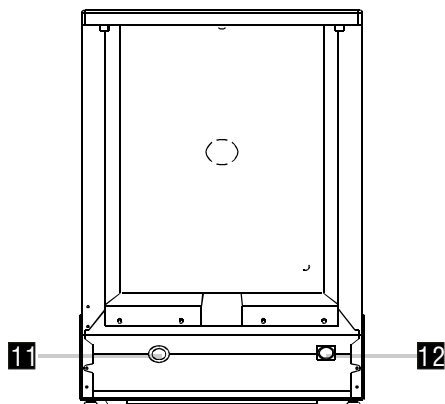

**1** Upper Basket

**2** Spray Arms

**3** Lower Basket

**4** Salt Container

**5** Main Filter

**6** Detergent Dispenser

**7** Cup Shelf

**8** Cutlery Basket

**9** Coarse Filter

**10** Rinse Aid Dispenser

**11** Drain pipe connector

**12** Inlet pipe connector

## 4. Prior using for the first time

Before using your dishwasher for the first time:

- A. Set the water softener
- B. Pour 1 / 2 litre of water inside the salt container and then fill with dishwasher salt
- C. Fill the rinse aid dispenser
- D. Fill with detergent

## A. Water Softener

The water softener must be set manually, using the water hardness dial.  
The water softener is designed to remove minerals and salts from the water, which would have a detrimental or adverse effect on the operation of the appliance. The higher the content of these minerals and salts, the harder your water is. The softener should be adjusted according to the hardness of the water in your area. Your local Water Authority can advise you on the hardness of the water in your area.

### Adjusting Salt Consumption

The dishwasher is designed to allow for adjustment in the amount of salt consumed based on the hardness of the water used. This is intended to optimise and customise the level of salt consumption.



Please follow the steps below for adjustment in salt consumption.

1. Unscrew the cap from the salt container.
2. There is a ring on the container with an arrow on it (see figure to the left), if necessary, rotate the ring in the anticlockwise direction from the "-" Setting toward the "+" sign, based on the hardness of the water being used.  
It is recommended that adjustments should be made in accordance with the following scheme:

WATER HARDNESS				Selector Position	Salt consumption	
°dH	°fH	°Clarke	mmol/l		(gram/cycle)	(cycles/1.2kgs)
0-8	0-14	0-10	0-1.4	/	0	/
8-22	14-39	10-28	1.4-3.9	-	20	60
22-45	39-80	28-56	3.9-8	Mid	40	25
45-60	80-107	56-75	8-11	+	60	16

Note:1

1°dH=1.25°Clarke=1.78°fH=0.178mmol/l

°DH: German degree

°fH: French degree

°Clarke: British degree

Note:2

"/"	No salt need added
"-"	Setting toward the "-" sign
"+"	Setting toward the "+" sign
"Mid"	Setting toward between the "-" sign and "+" sign

Contact your local water board for information on the hardness of your water supply.



**NOTE:** If your model does not have any water softener, you may skip this section.

#### WATER SOFTENER

The hardness of the water varies from place to place. If hard water is used in the dishwasher, deposits will form on the dishes and utensils.

The appliance is equipped with a special softener that uses a salt container specifically designed to eliminate lime and minerals from the water.

## B. Loading the Salt Into the Softener

Always use the salt intended for use with dishwasher.

The salt container is located beneath the lower basket and should be filled as explained in the following:

### Attention!

- Only use salt specifically designed for the use in dishwashers! Every other type of salt not specifically designed for the use in a dishwasher, especially table salt, will damage the water softener. In case of damage caused by the use of unsuitable salt the manufacturer does not give any warranty nor is liable for any damages caused.
- Only fill with salt just before starting one of the complete washing programs. This will prevent any grains of salt or salty water, which may have been spilled, remaining on the bottom of the machine for any period of time, which may cause corrosion.

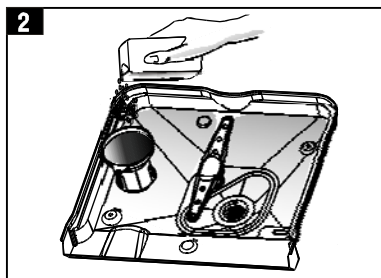
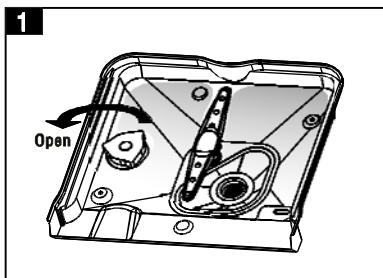

- A Remove the lower basket and then unscrew and remove the cap from the salt container. **1**
- B Before the first wash, fill 1lt. of water in the salt container of your machine.
- C Place the end of the funnel (supplied) into the hole and introduce about 1 kg of salt. It is normal for a small amount of water to come out of the salt container. **2**
- D After filling the container, screw the cap tightly back clockwise.
- E Usually, the salt warning light will stop being illuminated within 2–6 days after the salt container has been filled with salt.
- F Immediately after filling the salt into the salt container, a washing program should be started (**We suggest to use the soak or rapid program**). Otherwise the filter system, pump or other important parts of the machine may be damaged by salty water. This will not be covered by the manufacturer's guarantee.

### NOTE:

1. The salt container must only be refilled when the salt warning light in the control panel comes on. Depending on how well the salt dissolves, the salt warning light may still be on even though the salt container is filled.  
If there is no salt warning light in the control panel (for some models), you can estimate when to fill the salt into the softener by the cycles that the dishwasher has run.
2. If there are spills of the salt, a soak or a rapid program should be run to remove the excessive salt.

## C. Fill the Rinse Aid Dispenser

### Rinse Aid Dispenser

The rinse aid is released during the final rinse to prevent water from forming droplets on your dishes, which can leave spots and streaks. It also improves drying by allowing water to roll off the dishes. Your dishwasher is designed to use liquid rinse aids. The rinse aid dispenser is located inside the door next to the detergent dispenser. To fill the dispenser, open the cap and pour the rinse aid into the dispenser until the level indicator turns completely black. The volume of the rinse aid container is about 110ml.

### Function of Rinse Aid

Rinse aid is automatically added during the last rinse, ensuring thorough rinsing, and spot and streak free drying.

### Attention!

Only use branded rinse aid for dishwasher. Never fill the rinse aid dispenser with any other substances (e.g. Dishwasher cleaning agent, liquid detergent). This would damage the appliance.



## When to Refill the Rinse Aid Dispenser

If there is no rinse-aid warning light in the control panel, you can judge the amount of rinse-aid by the colour of the optical level indicator "C" located next to the cap. When the rinse-aid container is full, the whole indicator will be dark. As the rinse-aid diminishes, the size of the dark dot decreases. You should never let the rinse aid get below 1 / 4 full.

As the rinse aid diminishes, the size of the black dot on the rinse aid level indicator changes, as illustrated below.

- Full
- ◐ 3 / 4 full
- ◑ 1 / 2 full
- ◒ 1 / 4 full – Should refill to eliminate spotting
- Empty

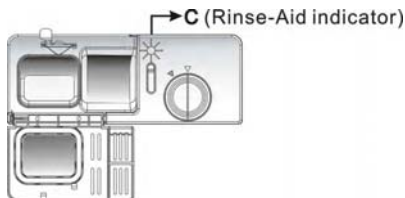

## RINSE AID DISPENSER

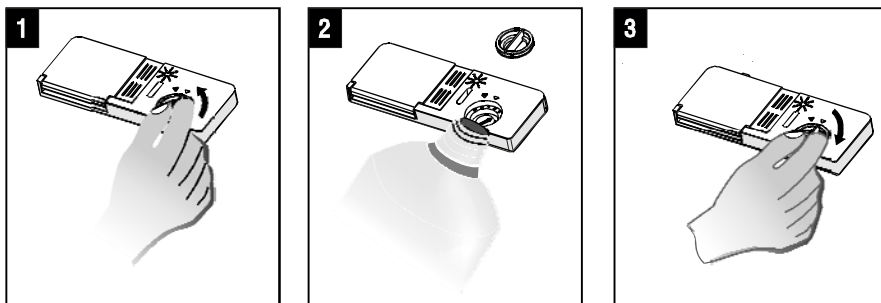

- 1** To open the dispenser, turn the cap to the "open" (left) arrow and lift it out.
- 2** Pour the rinse aid into the dispenser, being careful not to overfill.
- 3** Replace the cap by inserting it aligned with "open" arrow and turning it to the closed (right) arrow.

Be careful not to overfill the dispenser, because this could cause over sudsing. Wipe away any spills with a damp cloth. Don't forget to replace the cap before you close dishwasher door.

Attention!

Clean up any rinse aid spill during filling with an absorbent cloth to avoid excess foaming during the next wash.

## Adjusting Rinse Aid Dispenser

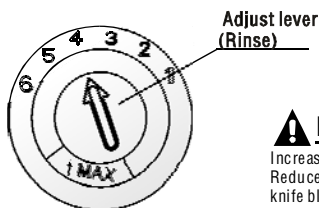

The rinse aid dispenser has six positions. Always start with the dispenser set on "4". If spots and poor drying are a problem, increase the amount of rinse aid dispensed by removing the dispenser lid and rotating the dial to "5". If the dishes still are not drying properly or are showing spots, adjust the dial to the next level until your dishes are spot-free. The recommended setting is "4".

### NOTE:

Increase the dose if there are drops of water or lime spots on the dishes after washing. Reduce it if there are sticky whitish stains on your dishes or a bluish film on glassware or knife blades.

## D. Function of Detergent

Detergents with its chemical ingredients are necessary to remove dirt and transport it out of the dishwasher. Most of the commercial quality detergents are suitable for this purpose.

### Concentrated Detergent

Based on their chemical composition, detergents can be split in two basic types:

- conventional, alkaline detergents with caustic components
- low alkaline concentrated detergents with natural enzymes

The use of “normal” washing programs in combination with concentrated detergents reduces pollution and is good for your dishes; these wash programs are specifically matched to the dirt-dissolving properties of the enzymes of the concentrated detergent. For this reason “normal” wash programs in which concentrated detergents are used can achieve the same results that can otherwise only be achieved using “intensive” programs.

### Detergent Tablets

Detergent tablets of different brands dissolve at different speeds. For this reason some detergent tablets cannot dissolve and develop their full cleaning power during short programs. Therefore please use long programs when using detergent tablets, to ensure the complete removal of detergent residuals.

### Detergent Dispenser

The dispenser must be refilled before the start of each wash cycle following the instructions provided in the wash cycle table. Your dishwasher uses less detergent and rinse aid than a conventional dishwasher. Generally, only one tablespoon of detergent is needed for a normal wash load. More heavily soiled items need more detergent. Always add the detergent just before starting the dishwasher, otherwise it could get damp and will not dissolve properly.

## Amount of Detergent to Use

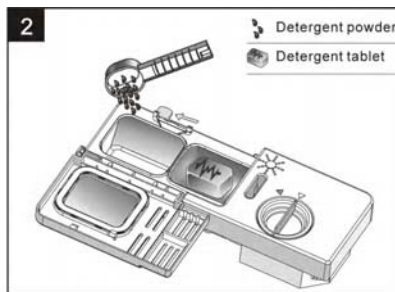
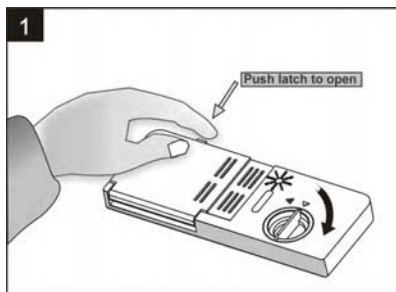

### ! NOTE:

- If the lid is closed: press release button. The lid will spring open.
- Always add the detergent just before starting each wash cycle.
- Only use branded detergent aid for dishwasher.

### ! WARNING!

Dishwasher detergent is corrosive! Take care to keep it out of reach of children.

## Proper Use of Detergent

Use only detergent specifically made for the use in dishwashers. Keep your detergent fresh and dry. Don't put powdered detergent into the dispenser until you're ready to wash dishes.

## Fill in detergent

Fill the detergent dispenser with detergent. The marking indicates the dosing levels, as illustrated on the right:

- A** The location of main wash cycle detergent, "MIN" means approximately 20g of detergent.
- B** The location of pre-wash cycle detergent, approximately 5g of detergent

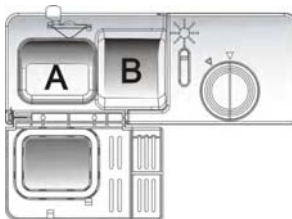

Please observe the manufacturers dosing and storage recommendations as stated on the detergent packaging.

Close the lid and press until it locks in place.

If the dishes are heavily soiled, place an additional detergent dose in the pre-wash detergent chamber. This detergent will take effect during the pre-wash phase.

### **NOTE:**

You will find information about the amount of detergent for the single programmes on the last page. Please be aware that according to the level of soiling and the specific hardness of water, differences are possible.

Please observe the manufacturer's recommendations on the detergent packaging.

## Detergents

There are 3 sorts of detergents

1. With phosphate and with chlorine
2. With phosphate and without chlorine
3. Without phosphate and without chlorine

Normally new pulverised detergent is without phosphate. Thus the water softener function of phosphate is not given. In this case we recommend to fill salt in the salt container even when the hardness of water is only 6° dH. If detergents without phosphate are used in the case of hard water often white spots appear on dishes and glasses. In this case please add more detergent to reach better results. Detergents without chlorine do only bleach a little. Strong and coloured spots will not be removed completely. In this case please choose a program with a higher temperature.

## Attention

Keep all detergents in a safe place out of children's reach.  
Always add the detergent in the dispenser just before starting the dishwasher.

## 5. Loading the Dishwasher Basket

For best performance of the dishwasher, follow these loading guidelines. Features and appearance of baskets and cutlery baskets may vary from your model.

### Attention before or after Loading the Dishwasher Baskets

Scrape off any large amounts of leftover food. Soften remnants of burnt food in pans.

Place objects in the dishwasher in following way:

1. Items such as cups, glasses, pots/pans, etc. should face downwards.
2. Curved items, or ones with recesses, should be loaded at a slant so that water can run off.
3. All utensils should be stacked securely so they do not tip over.
4. All utensils should be placed in the way that the spray arms can rotate freely during washing.

Very small items should not be washed in the dishwasher as they could easily fall out of the baskets.

### Removing the Dishes

To prevent water dripping from the upper basket into the lower basket, we recommend that you empty the lower basket first and then the upper basket.

### Loading the Upper Basket

The upper basket is designed to hold more delicate and lighter dishware such as glasses, coffee and tea cup and saucers, as well as plates, small bowls and shallow pans (as long as they are not too dirty).

Position the dishes and cookware so that they do not get moved by the spray of water.

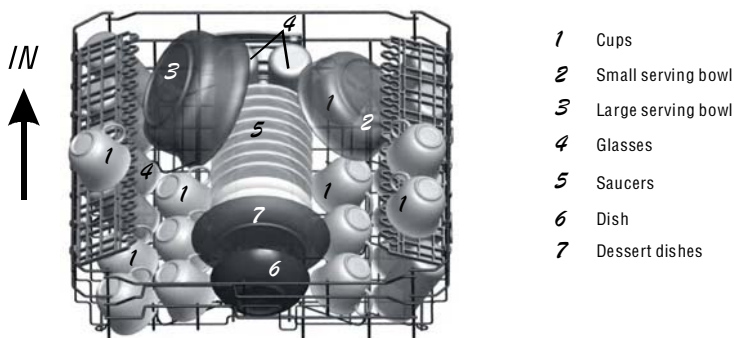

### Adjusting the Upper Basket

The height of the upper basket can be adjusted in order to create more space for large utensils both for the upper/lower basket. The height of the upper basket can be adjusted, by placing the wheels on a different rail height. Long items, serving cutlery, salad servers and knives should be placed on the shelf so that they do not obstruct the rotation of the spray arms. The shelf can be folded back or be removed when not required for use.

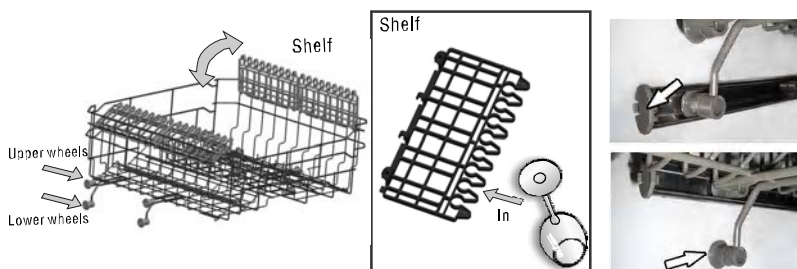

# Loading the Lower Basket

We recommend that you place large items which are most difficult to clean into the lower basket: pots, pans, lids, serving dishes and bowls, as shown in the figure below. It is preferable to place serving dishes and lids on the side of the racks in order to avoid blocking the rotation of the top spray arm.

Pots, serving bowls, etc. must always be placed top down.  
Deep pots should be slanted to allow water to flow out.  
The bottom basket features collapsible racks so that larger or more pots and pans can be loaded.

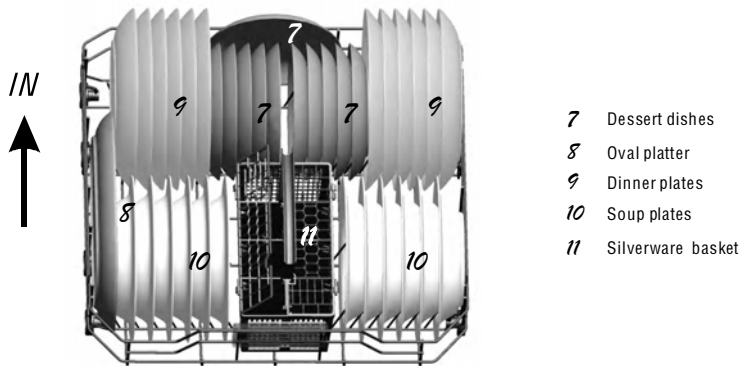

## Collapsible racks

For better stacking of pots and pans, the racks can be folded down as show in the picture to the right.

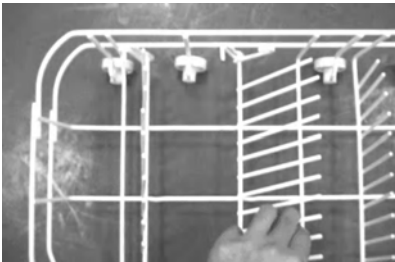

## Cutlery Basket

Cutlery should be placed in the cutlery basket with the handles at the bottom. If the rack has side baskets, the spoons should be loaded separately into the appropriate slots, especially long utensils should be placed in the horizontal position at the front of the upper basket as shown in the picture.

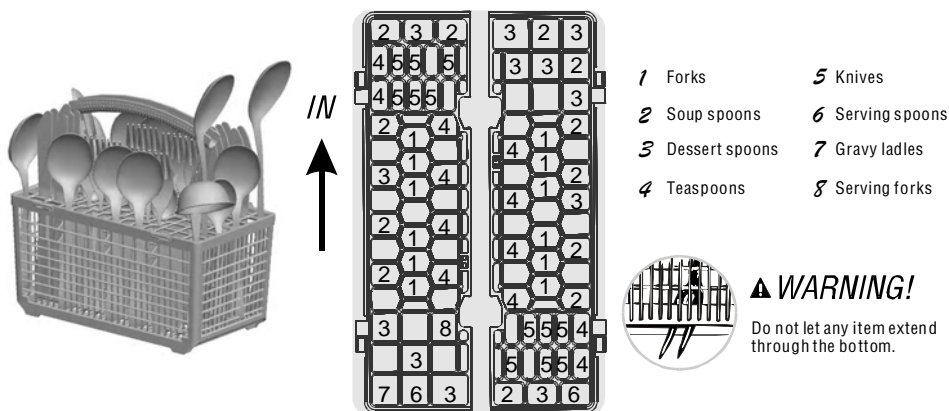

For washing in the dishwasher the following cutlery/dishes

### Are NOT suitable

Cutlery with wooden, bone china or mother-of-pearl handles  
Plastic items that are not heat resistant  
Older cutlery with glued parts that are not temperature resistant  
Bonded cutlery items or dishes  
Pewter or copper items  
Crystal glass  
Steel items subject to rusting  
Wooden platters  
Items made from synthetic fibres

#### NOTE:

Do not put in items that are dirty from cigarette ash, candle wax, lacquer or paint.  
If you buy new dishes please make sure that they are suitable for dishwashers.

#### NOTE:

Please do not overload your dishwasher. Do not use dishes that are not suitable for dishwashers. This is important for good results and for reasonable energy consumption.

### Loading cutlery and dishes

Before loading the dishes, you should:

Remove large left-overs  
Soften remnants of burnt food in pans by soaking them

#### When loading the dishes and cutlery, please note:

Dishes and cutlery must not impede the rotation of the spray arms  
Load hollow items such as cups, glasses, pans etc. with the opening downwards so that water cannot collect in the container or a deep base

- Dishes and items of cutlery must not lie inside one another, or cover each other
- To avoid damage to glasses, they must not touch
- Load large items which are most difficult to clean into the lower rack
- The upper rack is designed to hold more delicate and lighter dishware such as glasses, coffee and tea cups

## **Attention!**

Long bladed knives stored in an upright position are a potential hazard!

Long and/or sharp items of cutlery such as carving knives must be positioned horizontally in the upper basket.

Damage to glassware and other dishes

## **Possible causes:**





- Type of glass or manufacturing process. Chemical composition of detergent.
- Water temperature and duration of dishwasher programme.

## **Suggested remedy:**

- Use glassware or porcelain dishes that have been marked dishwasher-proof by the manufacturer
- Use a mild detergent that is described as kind to dishes. If necessary, seek further information from detergent manufacturers.
- Select a programme with a low temperature.
- To prevent damage, take glass and cutlery out of the dishwasher as soon as possible after the programme has ended.

## 6.Starting a washing programme

### WASH CYCLE TABLE

Program	Cycle	Cycle Selection Information	Description of Cycle	Detergent pre/main	Running time(min)	Energy (Kwh)	Water (l)
Intensive		For the heaviest soiled loads, such as pots, pans, casserole dishes and dishes that have been sitting with dried food on them for a while.	Pre-wash(50℃) Pre-wash Wash (65 ℃) Rinse Rinse Rinse (55 ℃) Drying	5/25 g.	130	1.55	22
Normal		For normally soiled loads, such as pots, plates, glasses and lightly soiled pans.	Pre-wash(50℃) Wash (50 ℃) Rinse Rinse (65 ℃) Drying	5/25 g.	155	1.30	16
Economy (IEC-EN 50242)		For normally soiled loads, such as pots, plates, glasses and lightly soiled pans. standard daily cycle.	Pre-Wash Pre-Wash Wash(50℃) Rinse(65℃) Drying	25 g.	150	1.05	16
Rinse		For dishes that need to be rinsed and dried only.	Wash(40℃) Rinse(70℃) Drying		80	1.00	8
Rapid		A shorter wash for lightly soiled loads that do not need drying.	Wash(40℃) Hot Rinse Hot Rinse	20 g.	30	0.40	12



## Turning on the Appliance

Starting a wash cycle...

- 1 Pull out the lower and upper basket, load the dishes and push them back. It is recommended that the lower basket is loaded first, then the upper one (see the section entitled "Loading the Dishwasher").
- 2 Pour in the detergent (see the section entitled "Salt, Detergent and Rinse Aid").
- 3 Insert the plug into the socket. The power supply is 220–240 V AC 50 HZ, the specification of the socket is 12 A 250V AC. Make sure that the water supply is turned on to full pressure.
- 4 Open the door, press the ON/OFF button, and the ON/OFF light will turn on.  
Press the 'prog.' button to select a desired "Wash cycle". (See the section entitled "Wash Cycle Table")
- 5 Ensure the door is properly closed.  
NOTE: A click could be heard when the door is closed perfectly.
- 6 When the washing is over, you can shut off the switch by pressing ON/OFF button.



## Change the Programme . . .

Premise: A cycle that is underway can only be modified if it has only been running for a short time. Otherwise, the detergent may already have been released, and the appliance may have already drained the wash water. If this is the case, the detergent dispenser must be refilled (see the section entitled "Loading the Detergent").

To cancel a cycle, open the dishwasher door then press and hold the 'prog.' button for more than 3 seconds. The cycle is then cancelled and a new cycle can be selected.

NOTE: If you open the door when washing, the machine will pause. When you close the door, the machine will re-start after 10 seconds.

The program lights show the state of the dishwasher:

- a) All program lights off --> stand by
- b) One of the program lights on --> pause
- c) One of the program lights blinking --> run

### **NOTE:**

If all the lights begin to glimmer, that indicates the machine is out of order, please turn off the main power and water supply before calling for service.

## Forget to Add a Dish?

A forgotten dish can be added at any time before the detergent cup opens.

- 1 Open the door a little to stop the wash cycle.
- 2 After the spray arms stop working, you can open the door completely.
- 3 Load the forgotten dishes.
- 4 Close the door, the dishwasher will start running again after 10 seconds.

### **⚠ WARNING!**

It is dangerous to open the door when washing, because the hot water may scald you. Take extra care to avoid this.

## At the End of the Wash Cycle

When the working cycle has finished, the buzzer of the dishwasher will sound for 8 seconds, then stop. Turn off the appliance using the ON/OFF button and open the door of the dishwasher.

Wait for a few minutes before unloading the dishwasher to avoid handling the dishes and utensils while they are still hot and more susceptible to breakage. They will also dry better.

■ **Open the door carefully.**

Hot dishes are sensitive to knocks. The dishes should therefore be allowed to cool down around 15 minutes before removing from the appliance.

Open the dishwasher's door, leave it ajar and wait a few minutes before removing the dishes. In this way they will be cooler and the drying will be improved.

■ **Unloading the dishwasher**

It is normal for the dishwasher to be wet inside.

Empty the lower basket first and then the upper one. This will avoid water dripping from the upper basket onto the dishes in the lower one.

## 7. Maintenance and Cleaning

### Filtering System

The filter prevents larger remnants of food or other objects from getting inside the pump.

The residues may block the filter, in this case they must be removed.

The filter system consists of a coarse filter, a flat (main filter) and a microfilter (fine filter).

**Main filter 1**

Food and soil particles trapped in this filter are pulverized by a special jet on the lower spray arm and washed down the drain.

**Coarse filter 2**

Larger items, such as pieces of bones or glass, that could clog the drain caught in the coarse filter. To remove an item caught in this filter, gently squeeze the taps on the top of this filter and lift it out.

**Fine filter 3**

This filter holds soil and food residues in the sump area and prevents it from being redeposited on the dishes during a cycle.

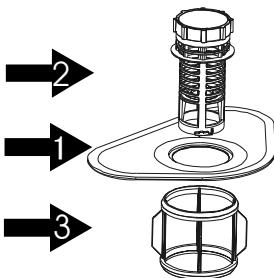

- Inspect the filters for blocking every time the dishwasher has been used.
- By unscrewing the coarse filter, you can remove the filter system. Remove any food remnants and clean the filters under running water.

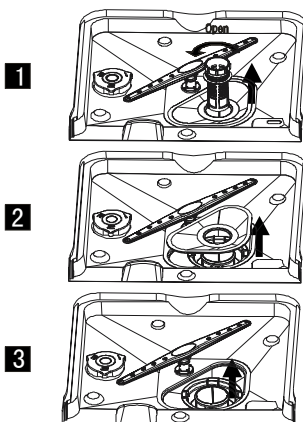

Step 1 : Turn the filter in anti-clockwise direction, then lift it up

Step 2 : lift the main filter up

Step 3 : lift the fine filter up

**NOTE:**

When following this procedure from step 1 to step 3, the filter system will be removed; when following it from step 3 to step 1, the filter system will be installed.

## Filter assembly

For best performance and results, the filter assembly must be cleaned. The filter efficiently removes food particles from the wash water, allowing it to be recycled during the cycle. For best performance and results, the filter must be cleaned regularly. For this reason, it is a good idea to remove the larger food particles trapped in the filter after each wash cycle by rinsing the semicircular filter and cup under running water. To remove the filter device, pull the cup handle in the upward direction. The entire filter assembly should be cleaned once a week.

To clean the coarse filter and the fine filter, use a cleaning brush. Then, reassemble the filter parts as previously shown and reinsert the entire assembly in the dishwasher, positioning in its seat and pressing downward.

The dishwasher must never be used without the filters. Improper replacement of the filter may reduce the performance level of the appliance and damage dishes and utensils.

### **▲ WARNING!**

- The dishwasher must never be used without the filters.
- Improper replacement of the filter may reduce the performance level of the appliance and damage dishes and utensils.

## Cleaning the Spray Arms

It is necessary to clean the spray arms regularly for hard water chemicals will clog the spray arm jets and bearings.

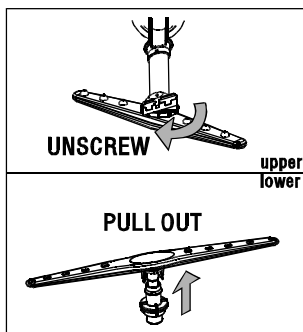

### Remove the upper spray arm

To remove the upper spray arm, screw off the nut clockwise then remove the arm.

### Remove the lower spray arm

To remove the lower spray arm, pull the spray arm upwards.

### Wash the arms

Wash the arms in soapy and warm water and use a soft brush to clean the jets. Replace them after rinsing them thoroughly.

## Caring for the Dishwasher

The control panel can be cleaned by using a lightly dampened cloth. After cleaning, make sure to dry it thoroughly.

For the exterior, use a good appliance polish wax.

Never use sharp objects, scouring pads or harsh cleaners on any part of the dishwasher.

## Cleaning the Door

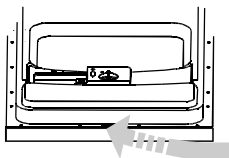

To clean the edge around the door, you should use only a soft warm, damp cloth. To avoid penetration of water into the door lock and electrical components, do not use a spray cleaner of any kind.

### **▲ WARNING!**

- Never use a spray cleaner to clean the door panel as it may damage the door lock and electrical components.
- Abrasive agents or some paper towels should not be used because of the risk of scratching or leaving spots on the stainless steel surface.

## How to Keep Your Dishwasher in Shape

### ■ *After Every Wash*

After every wash, leave the door slightly ajar so that moisture and odours are not trapped inside.

### ■ *Remove the Plug*

Before cleaning or performing maintenance, always remove the plug from the socket. Do not run risks.

### ■ *No Solvents or Abrasive Cleaning*

To clean the exterior and rubber parts of the dishwasher, do not use solvents or abrasive cleaning products. Rather, use only a cloth and warm soapy water.

To remove spots or stains from the surface of the interior, use a cloth dampened with water and a little vinegar, or a cleaning product made specifically for dishwashers.

### ■ *When not in Use for a Long Time*

When you go on holiday, it is recommend that you run a wash cycle with the dishwasher empty and then remove the plug from the socket, turn off the water supply and leave the door of the appliance slightly ajar. This will help the seals to last longer and prevent odours from forming within the appliance.

### ■ *Moving the Appliance*

If the appliance must be moved, try to keep it in the vertical position. If absolutely necessary, it can be positioned on its back.

### ■ *Seals*

One of the factors that cause odours to form in the dishwasher is food that remains trapped in the seals. Periodic cleaning with a damp sponge will prevent this from occurring.

## 8. Installation instruction

### **▲ Attention:**

The installation of the pipes and electrical equipments should be done by professionals.



### **Warning**

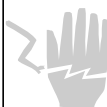

Electrical Shock Hazard  
Disconnect electrical power before installing dishwasher.

Failure to do so can result in death or electrical shock.

## ● Installation preparation

The installation position of dishwasher should be near the existing inlet and drain hoses and power cord.

One side of the cabinet sink should be chosen to facilitate the connection of drain hoses of the dishwasher.

【 Figure1 】

Cabinet dimensions  
Less than 5mm  
between the top  
of dishwasher and  
cabinet and the  
outer door aligned  
to cabinet.

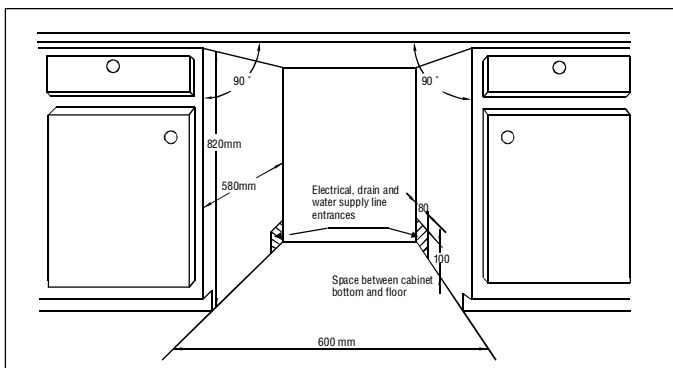

【 Figure2 】

Minimum space when  
the door is opened

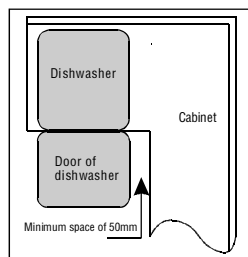

## ● Aesthetic panel's dimensions and installation

1 The decor door should be fitted in accordance with the measurements detailed in Figure 3.

【 Figure3 】

(Unit: mm)

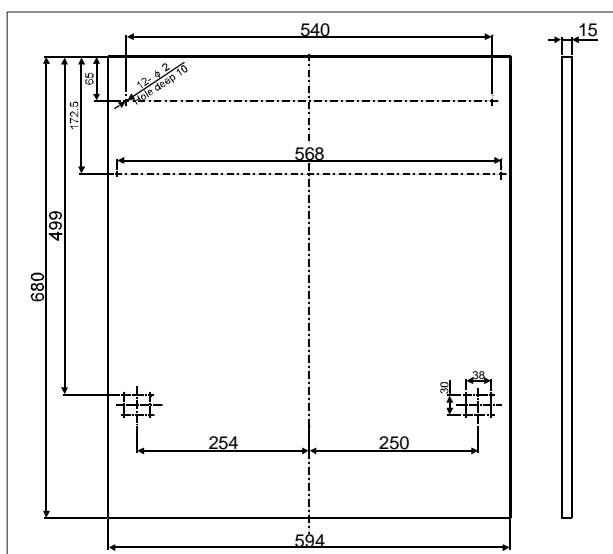

- 2** Install the two top hooks and the two lower hooks onto the decor door and put the top hooks into the slot of the outer door of dishwasher(see figure 4a). Lock the decor door onto the outer door of the dishwasher by sliding it downwards so that the upper and lower hooks engage. After positioning the panel , finally fix the panel onto the outer door using the screws and bolts provided.(see figure 4b) .

**【 Figure4a 】**

Installation of decor door panel

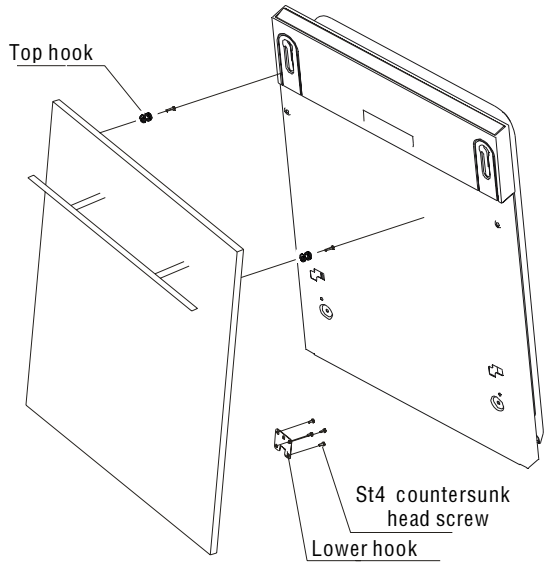

**【 Figure4b 】**

Installation of decor door panel

- 1.** Remove the 2 plastic covers from the dishwasher door
- 2.** Place screws in slots and tighten into decor door
- 3.** Replace plastic covers

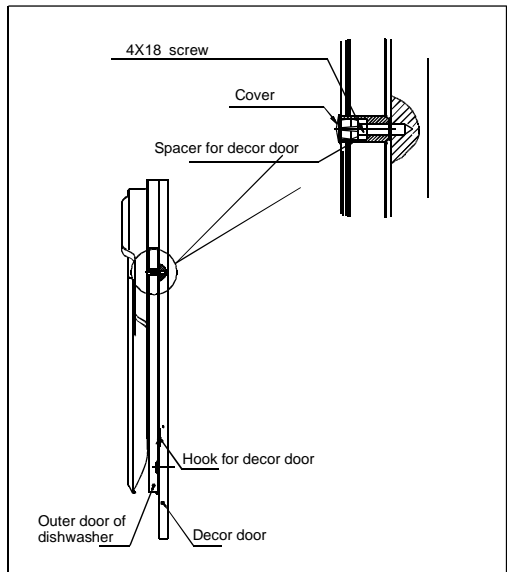

## ● Tension adjustment of the door spring

The door springs are set at the factory to the proper tension for the outer door only. When the decor door panel is installed, you will have to adjust the door spring tension. Rotate the adjusting screw to drive the adjustor to strain or relax the steel cable (see figure 5).

Adjust the door spring tension until the door remains balanced in the fully-opened position.

【 Figure5 】

Tension adjustment of the door spring

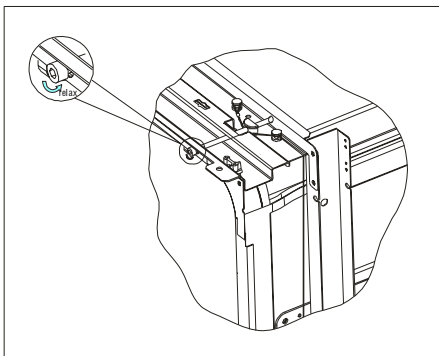

## ● Connection of drain hoses

Insert the drain hose into a drain pipe with a minimum diameter of 4cm, or let it run into the sink, making sure to avoid bending or crimping it. Use the special plastic support that comes with the appliance (figure 6). The top of the hose must be at a height between 40 and 100cm. The free end of the hose must not be immersed in water to avoid the back flow of it. ATTENTION: The special plastic hose support must be solidly fastened to the wall to prevent the drain hose from moving and allowing water to spill outside the drain.

【 Figure6 】

Drain pipe connection

Fix the drain hose hook to prevent movement

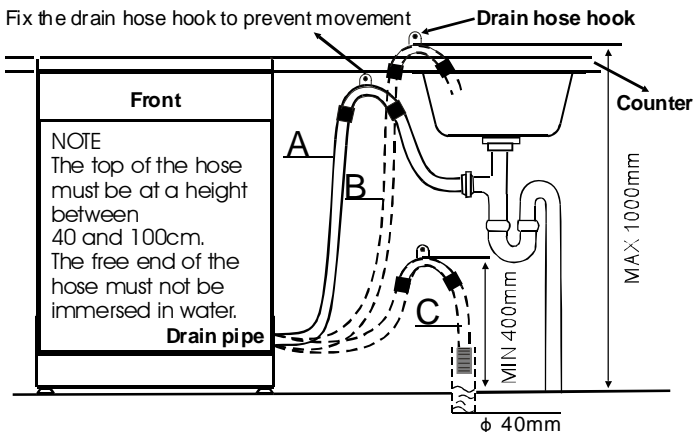

## ● Dishwasher installation steps

- 1 Install the furniture door to the outer door of the dishwasher using the brackets provided. Refer to the template for positioning of the brackets.
- 2 Adjust the tension of the door springs by using an Allen key turning in a clockwise motion to tighten the left and right door springs. Failure to do this could cause damage to your dishwasher (Illustration 2).
- 3 Connect the inlet hose to the cold water supply .
- 4 Connect the drain hose. Refer to diagram.(Figure 6)
- 5 Connect the power cord.
- 6 Affix the condensation strip under the work surface of cabinet. Please ensure the condensation strip is flush with edge of work surface.
- 7 Place the dishwasher into position.
- 8 Level the dishwasher. The rear feet can be adjusted from the front of the dishwasher by turning the screws on the left and right hand side of the cabinet (Illustration 5A). Tilt the machine forward slightly when making this adjustment, to take the weight off the foot mechanism whilst turning the screw. Do not use a powered screwdriver for this operation. To adjust the front feet, use a wrench and turn the front feet until the dishwasher is level (Illustration 5B).
- 9 The dishwasher must be secured in place. There are two ways to do this:  
A. Normal work surface—secure to the work surface by using two woodscrews ensuring the dishwasher weight is not being supported by the work surface (Illustration 6).  
B. Marble or granite work top—secure the bracket to the side panel of the dishwasher and secure the dishwasher to the furniture housing. Put the rubber cap over the screw (Illustration 7).

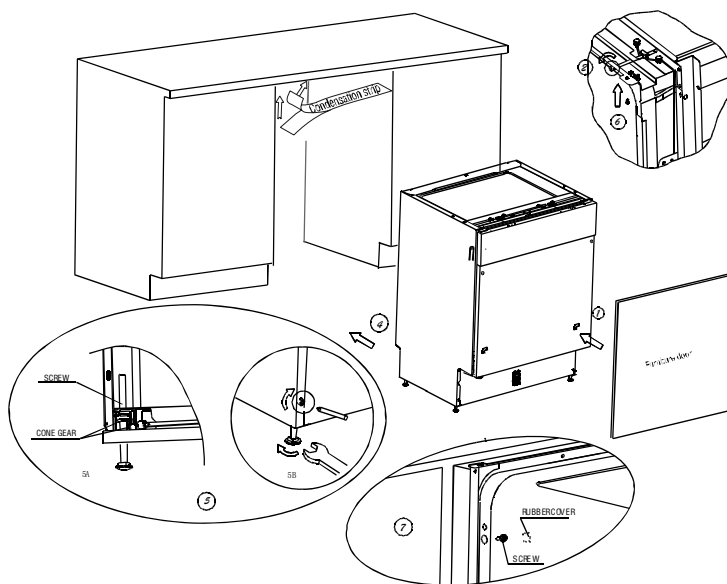

【 Figure 7 】



The dishwasher must be level for proper dish rack operation and wash performance.

- 1 Place level on door and rack track inside the tub as shown to check that the dishwasher is level.
- 2 Level the dishwasher by adjusting the four levelling feet individually.
- 3 When levelling the dishwasher, please pay attention not to let the dishwasher tip over.

**【 Figure 8 】**

Illustration of feet adjustment

NOTE:

The maximum adjustment height of the feet is 60 mm.

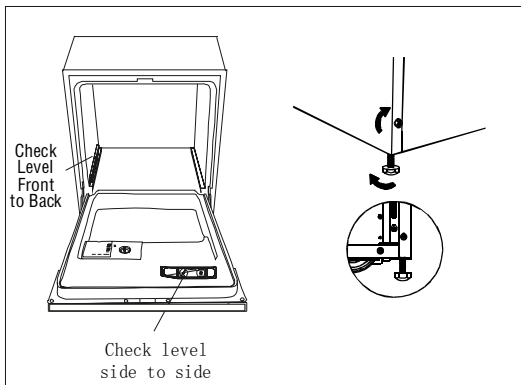

## About Electricity Connecting

### ⚠ WARNING!

For personal safety:

- DO NOT USE AN EXTENSION CORD OR AN ADAPTER PLUG WITH THIS APPLIANCE.
- DO NOT, UNDER ANY CIRCUMSTANCES, CUT OR REMOVE THE EARTH CONNECTION FROM THE POWER CORD.

### Electrical Requirements

Please look at the rating label to know the rating voltage and connect the dishwasher to the appropriate power supply. Use the required fuse 13 amp, time delay fuse or circuit breaker recommended and provide separate circuit serving only this appliance.

### Electrical Connection

#### ⚠ *Ensure proper earth connection exists before use*

Ensure the voltage and frequency of the power being corresponds to those on the rating plate. Only insert the plug into an electrical socket which is earthed properly. If the electrical socket to which the appliance must be connected is not appropriate for the plug, replace the socket, rather than using adaptors or the like as they could cause overheating and burns.



### GROUNDING INSTRUCTIONS

- This appliance must be earthed. In the event of a malfunction or breakdown, earthing will reduce the risk of electric shock by providing a path of least resistance for the electric current. This appliance is equipped with a cord having an equipment–earthing conductor and an earthing plug. The plug must be plugged into an appropriate outlet that is installed and earthed in accordance with all local standards and requirements.

#### ⚠ WARNING!

- Improper connection of the earth can result in the risk of an electric shock. Check with a qualified electrician or service representative if you are in doubt whether the appliance is properly earthed. Do not modify the plug provided with the appliance; if it is not correct for the outlet, have a proper outlet installed by a qualified electrician.

## **▲ WARNING!**

For models not fitted with a safety inlet hose, in order to prevent continual water pressure in the inlet hose, please turn off the water supply after each use.

## *Cold Water Connection*

---

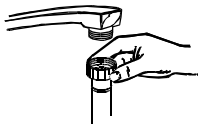

Connect the cold water supply hose to a threaded 3/4(inch) connector and make sure that it is fastened tightly in place.

If the water pipes are new or have not been used for an extended period of time, let the water run to make sure that the water is clear. This precaution is needed to avoid the risk of the water inlet becoming blocked and damaging the appliance.

## *Hot Water Connection*

---

The water supply to the appliance can also be connected to the household hot water line (such as, central system, heating system), as long as it does not exceed a temperature of 60 °C. In this case, the wash cycle time will be shortened by about 15 minutes and the wash efficiency slightly reduced.

The connection must be made to the hot water line following the same procedures as described in the section for the connection to the cold water line.

## Positioning the Appliance

Position the appliance in the desired location. The back should rest against the wall behind it, and the sides, along the adjacent cabinets or walls. The dishwasher is equipped with water supply and drain hoses that can be positioned either to the right or the left sides to facilitate proper installation.

## How to Drain Excess Water From Hoses

If the sink is 1000 higher from the floor, the excess water in hoses cannot be drained directly into the sink. It will be necessary to drain excess water from hoses into a bowl or suitable container that is held outside and lower than the sink.

## Water Outlet

Connect the water drain hose. The drain hose must be correctly fitted to avoid water leaks. Ensure that the water drain hose is not kinked or squashed.

## Extension Hose

If you need a drain hose extension, make sure to use a similar drain hose. It must be no longer than 4 metres; otherwise the cleaning effect of the dishwasher could be reduced.

## Syphon Connection

The waste connection must be at a height of between 40 cm (minimum) and 100 cm (maximum) from the bottom of the dish. The water drain hose should be fixed by a hose clip. The free end of the hose must not be immersed in water.

## Start of Dishwasher

The following things should be checked before starting the dishwasher.

- 1** The dishwasher is level and fixed properly
- 2** The inlet valve is open
- 3** There is no water leaking from any of the hose connections
- 4** The wires are tightly connected
- 5** The power is switched on
- 6** The inlet and drain hoses are secure
- 7** All packing materials and have been removed from the inside of the dishwasher

**▲ Attention:** After installation, please keep this manual for future reference.

## 9. Troubleshooting Tips

### Before Calling for Service

Please review the following before contacting the service agent.



#### Technical problems

<i>Problem</i>	<i>Possible Causes</i>	<i>What To Do</i>
<i>Dishwasher doesn't start</i>	Fuse blown, or the circuit breaker has tripped	Replace fuse or reset circuit breaker. Remove any other appliances sharing the same circuit with the dishwasher
	Power supply is not turned on	Make sure the dishwasher is turned on and the door is closed securely. Make sure the power cord is properly plugged into the wall socket.
	Error code: E1; Water pressure is low	Check that the water supply is connected properly and the water is turned on.
	Door of dishwasher not properly closed.	Make sure to close the door properly and latch it.
<i>Water not pumped from dishwasher</i>	Kink in drain hose	Check drain hose.
	Filter clogged	Check coarse the filter (see section titled "Cleaning The Filter")
	Kitchen sink clogged	Check the kitchen sink to make sure it is draining well. If the problem is the kitchen sink not draining, you may need a plumber rather than a serviceman for dishwashers.

#### General problems

<i>Suds in the tub</i>	Improper detergent	Use only the special dishwasher detergent to avoid suds. If this occurs, open the dishwasher and let suds evaporate. Add 5 litres of cold water to the tub. Close and latch the dishwasher, then Start the "soak" wash cycle to drain out the water. Repeat if necessary.
	Spilled rinse-aid	Always wipe up rinse-aid spills immediately.
<i>Stained tub interior</i>	Detergent with colourant was used	Make sure that the detergent is the one without colourant.
<i>White film on inside surface</i>	Hard water minerals	To clean the interior, use a damp sponge with dishwasher detergent and wear rubber gloves. Never use any other cleaner than dishwasher detergent for the risk of foaming or suds.
<i>There are rust stains on cutlery</i>	The affected items are not corrosion resistant.	
	A programme was not run after dishwasher salt was added. Traces of salt have gotten into the wash cycle.	Always run the quick wash programme without any crockery in the dishwasher and without selecting the Turbo function (if present), after adding dishwasher salt.
	The lid of the softener is loose	Check the lip. Ensure the fix is fine.

#### Noise

<i>Knocking noise in the wash cabinet</i>	A spray arm is knocking against an item in a basket	Interrupt the programme, and rearrange the items which are obstructing the spray arm.
<i>Rattling noise in the wash cabinet</i>	Items of crockery are loose in the wash cabinet	Interrupt the programme, and rearrange the items of crockery.
<i>Knocking noise in the water pipes</i>	This may be caused by on-site installation or the cross-section of the piping.	This has no influence on the dishwasher function. If in doubt, contact a suitably qualified plumber.



Unsatisfactory  
washing  
result

<i>Problem</i>	<i>Possible Causes</i>	<i>What To Do</i>
<i>The dishes are not clean</i>	The dishes were not loaded correctly.	See notes in "Loading the Dishwasher Baskets".
	The programme was not powerful enough.	Select a more intensive programme. See "Wash Cycle Table".
	Not enough detergent was dispensed.	Use more detergent, or change your detergent.
	Items are blocking the path of spray arms.	Rearrange the items so that the spray can rotate freely.
	The filter combination in the base of wash cabinet is not clean or is not correctly fitted. This may cause the spray arm jets to get blocked.	Clean and/or fit the filter combination correctly. Clean the spray arm jets. See "Cleaning the Spray Arms".
<i>Cloudiness on glassware</i>	Combination of soft water and too much detergent.	Use less detergent if you have soft water and select a shortest cycle to wash the glassware and to get them clean.
<i>Black or grey marks on dishes</i>	Aluminum utensils have rubbed against dishes.	Use a mild abrasive cleaner to eliminate those marks.
<i>Detergent left in dispenser cups</i>	Dishes block detergent cups.	Re-loading the dishes properly.

Unsatisfactory  
drying  
result

<i>The dishes are not drying</i>	Improper loading	Load the dishwasher as suggested in the directions.
	Too little rinse-aid	Increase the amount of rinse-aid/refill the rinse-aid dispenser.
	Dishes are removed too soon	Do not empty your dishwasher immediately after washing. Open the door slightly so that the steam can escape. Begin unloading the dishwasher only once the dishes are barely warm to the touch. Empty the lower basket first. This prevents water from dropping off the dishes in the upper basket.
	Wrong program has been selected	In short program the washing temperature is lower. This also lowers cleaning performance. Choose a program with a long washing time.
	Use of cutlery with a low-quality coating	Water drainage is more difficult with these items. Cutlery or dishes of this type are not suitable for washing in the dishwasher.

## ERROR CODES

<i>Codes</i>	<i>Meanings</i>	<i>Possible Causes</i>
<i>The intensive light pulses on and off</i>	Longer inlet time.	Faucets is not opened.
<i>The economy light pulses on and off</i>	Longer draining time.	The installation position of the drain pipe is too high.
<i>The intensive and economy lights pulse on and off</i>	Overfilled.	Too much inlet water.

### ⚠ WARNING!

- If overflow occurs, turn off the main water supply before calling a service.
- If there is water in the base pan because of an overflow or small leak, the water should be removed before restarting the dishwasher.

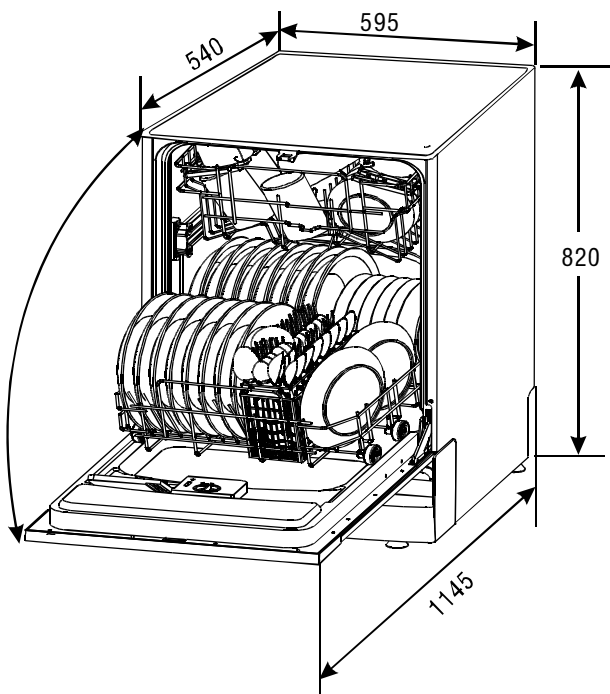

Height :	820mm(adjustable+60mm)
Width :	595mm
Depth :	540mm
Voltage connected load :	See rating label
Water pressure:	0.04-1.0MPa
Hot water connection :	Max 60 °C
Power supply:	See rating label
Capacity:	12 place settings