



Gas Hob

REF	Model
GH70GGWH	GH70GGWH
UBGH70GGWH	UBGH70GGWH
UBGHFF70W	UBGHFF70W

Version:00

Date:2014-11-06

Exploded drawing

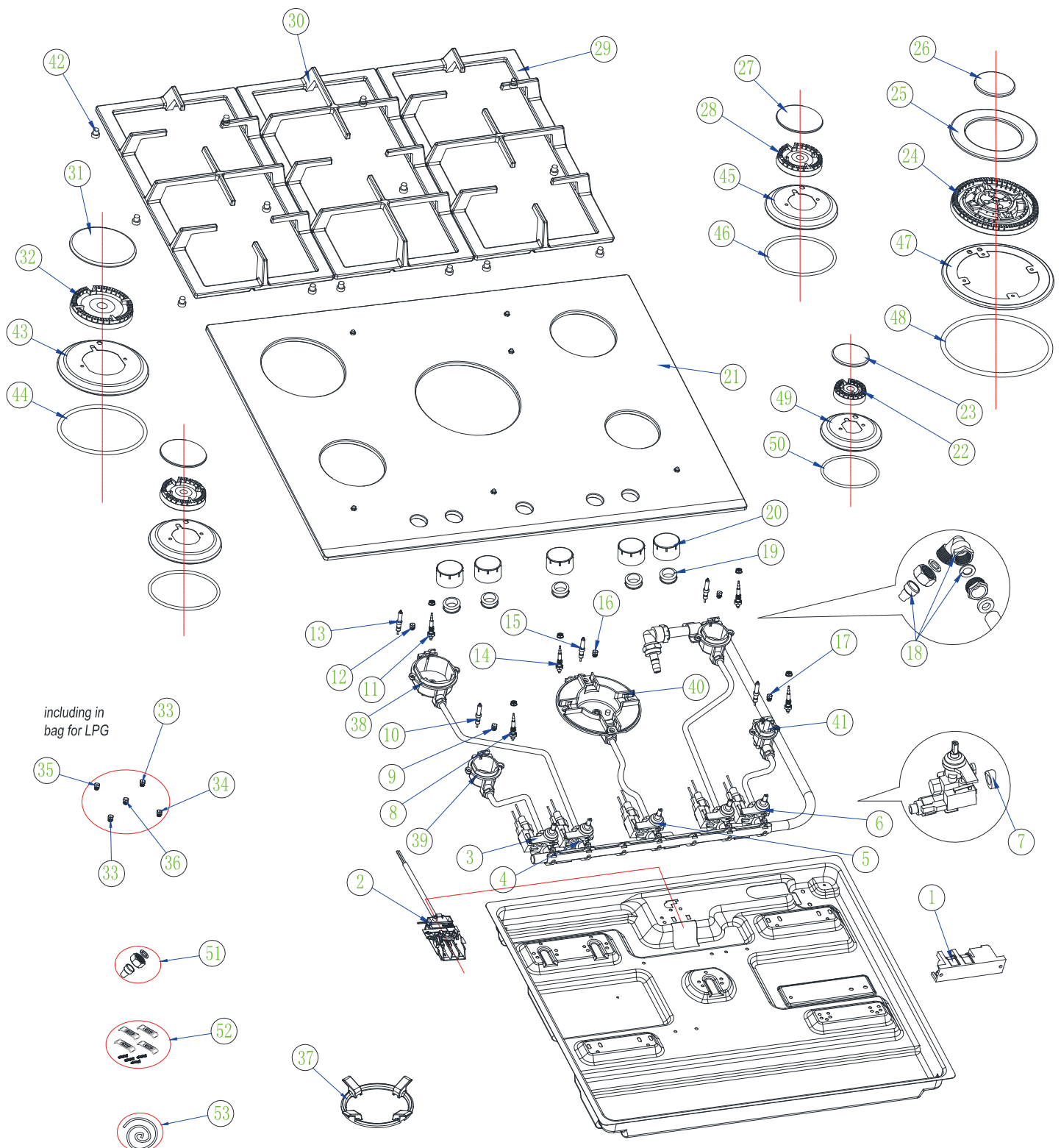

00	New document	Eason	2014. 11. 6
Index	Modify description	Modified by	Date

parts list

S/N	Ref	Description(en)	Qty	Material	Supplier
1	26200180	impulse ignition device-gas-hob-L 905 CI/A	1set	assembly	216***
2	26200175	electrical connector box-gas-hob-L 905 CI/A	1set	assembly	240001
3	26200105	valve 1# -gas-hob-L705 TI_INOX	2set	assembly	141001-**
4	26200030	valve 2# -gas-hob-L705 TI_INOX	1set	assembly	141002-**
5	26200035	valve 3# -gas-hob-L705 TI_INOX	1set	assembly	141003-**
6	26200090	valve 4# -gas-hob-L705 TI_INOX	1set	assembly	141004-**
7	60500065	sealing ring(valve)-gas-hob-604 FTI	5	silicon	
8	26200190	thermocouple(350)-gas-hob-L 905 CI/A	2		195161
9	69401790	injector/nozzle(NG,Semi-rapid)-gas-hob-L 905 CI/A	2	HPb59-1	130704-**
10	69405945	ignition pin(500)-gas-hob-GHFF70GG	2		200004-5
11	26200185	thermocouple(500)-gas-hob-L 905 CI/A	2		195282
12	69401805	injector/nozzle(NG,rapid)-gas-hob-L 905 CI/A	1	HPb59-1	131004-**
13	69401835	ignition pin(220)-gas-hob-L 604 FTI/T MX	1		200004-2
14	26200340	thermocouple(350,triple ring)-gas-hob-L 604 RH CI b	1		195161
15	69405865	ignition pin(300,triple ring)-gas-hob-GCI57	1		200003-2
16	69401800	injector/nozzle(NG,triple ring)-gas-hob-L 905 CI/A	1	HPb59-1	131205-**
17	69401795	injector/nozzle(NG,auxiliary)-gas-hob-L 905 CI/A	1	HPb59-1	130504-**
18	26200195	connector(elbow)-gas-hob-Gristal Gas 40 Tc	1set	assembly	
19	60500250	waterproof ring(knob)-gas-hob-GHDFF60AL	5	silicon	
20	60701740	knob-gas-hob-GHDFF70SS	5		
21	69409900	panel(70cm)-gas-hob-GH70GGWH	1	glass	
22	69401765	ø50 flame distributor-gas-hob-L 905 CI/A	1	AL	130502
23	69401745	ø50 burner cover-gas-hob-L 905 CI/A	1	cast iron	130503-**
24	69401755	ø120 flame distributor-gas-hob-L 905 CI/A	1	AL	131202
25	69400195	burn cover ring-gas-hob-L 603 FTI	1	cast iron	131203-**
26	69400200	burn cover center-gas-hob-L 603 FTI	1	cast iron	131204-**
27	69401740	ø70 burn cover-gas-hob-L 905 CI/A	2	cast iron	130703-**
28	69401760	ø70 flame distributor-gas-hob-L 905 CI/A	2	AL	130702
29	69405875	pan support 1# -gas-hob-GCI57	2	cast iron	15G705-E-1*
30	69405880	pan support 2# -gas-hob-GCI57	1	cast iron	15G705-E-2*
31	69401730	ø100 burn cover-gas-hob-L 905 CI/A	1	cast iron	131003-**
32	69401750	ø100 flame distributor-gas-hob-L 905 CI/A	1	AL	131002
33	69403090	injector/nozzle(LPG,Semi-rapid)-gas-hob-L 905 CI/A	2		
34	69403100	injector/nozzle(LPG,auxiliary)-gas-hob-L 905 CI/A	1		
35	69403105	injector/nozzle(LPG,rapid)-gas-hob-L 905 CI/A	1		
36	69403095	injector/nozzle(LPG,triple ring)-gas-hob-L 905 CI/A	1		
37	25103225	wok support (cristal,cast iron)	1	cast iron	
38	64500030	burner basement(rapid)-gas hob-L705TI	1		131001
39	64500025	burner basement(semi-rapid)-gas hob-L705TI	2		130701
40	64500055	burner basement(triple ring)-gas hob-L705TI	1		131201
41	64500035	burner basement(auxiliary)-gas hob-L705TI	1		130501
42	60500200	rubber washer of pan support-gas hob-L 705 CI/A	18		
43	69406000	ø100 water tray-gas hob-GCI57	1		16G915-E-3*
44	60500260	ø100 waterproof ring-gas hob-GCI57	1		230007-B
45	69406005	ø70 water tray-gas hob-GCI57	2		16G915-E-2*
46	60500265	ø70 waterproof ring-gas hob-GCI57	2		230006-B
47	69406010	ø120 water tray-gas hob-GCI57	1		16G915-E-4*
48	60500270	ø120 waterproof ring-gas hob-GCI57	1		230008-B
49	69406015	ø50 water tray-gas hob-GCI57	1		16G915-E-1*
50	60500275	ø50 waterproof ring-gas hob-GCI57	1		230005-B
51	25401105	accessory bag (connector pieces for LPG)-gas hob-6	1		
52	25401100	accessory bag (hook and screw)-gas hob-631CI	1		
53	25401115	accessory bag (waterproof strip)-gas hob-631CI	1		