



single oven:UBPY602SS

Version:01

Date:2016-03-03

Product reference code:UBPY602SS

# UBPY602SS Exploded drawing

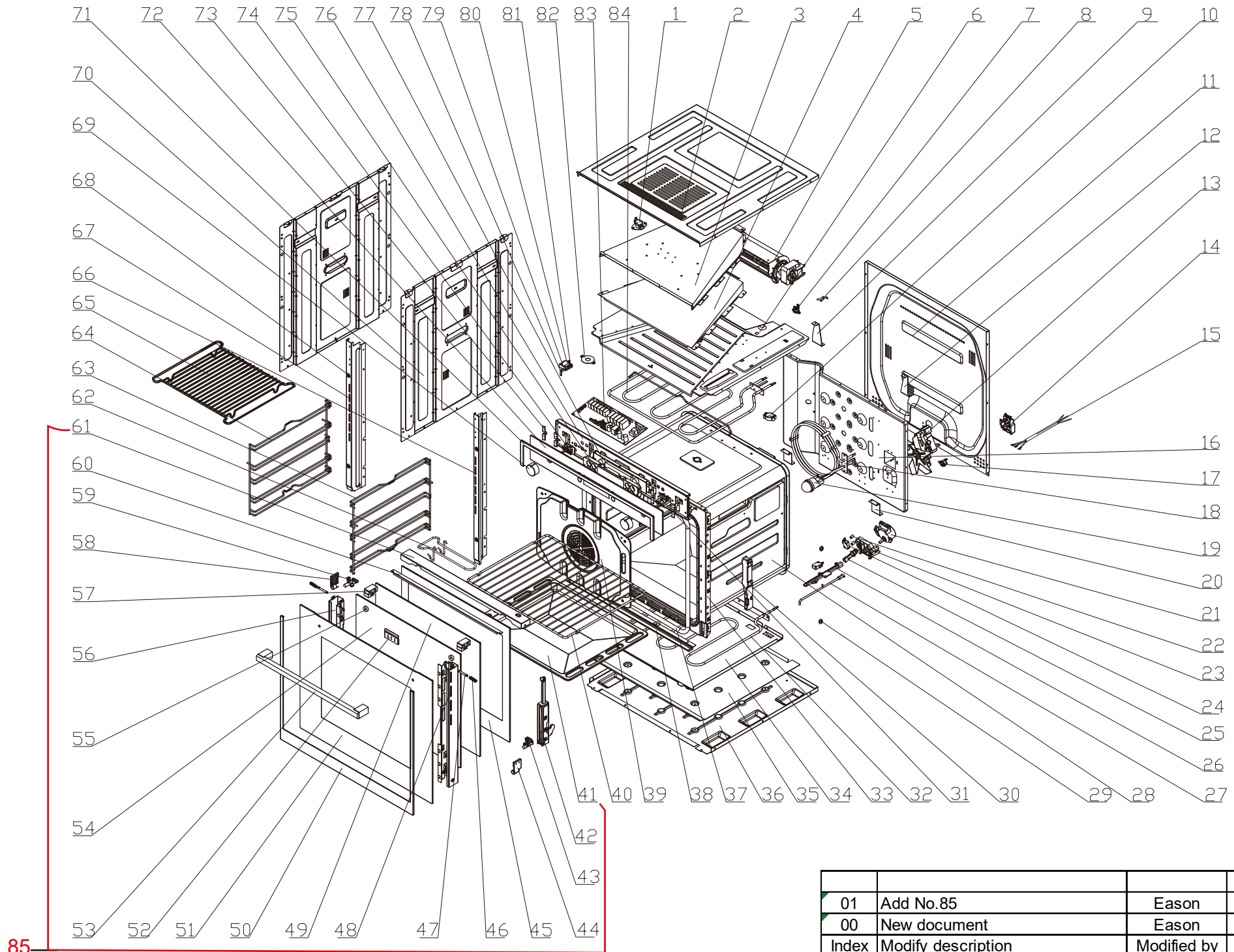

|       |                    |             |            |
|-------|--------------------|-------------|------------|
| 01    | Add No.85          | Eason       | 2016.03.03 |
| 00    | New document       | Eason       | 2015.09.09 |
| Index | Modify description | Modified by | Date       |

# UBPY602SS parts list

| No. | part code | part name                                      | Qty |
|-----|-----------|--|-----|
| 1   | 33308025  | Overheat protector                             | 1   |
| 2   | 33031018  | shell upper cover plate                        | 1   |
| 3   | 33028004  | Discharge flue upper cover plate               | 1   |
| 4   | 33026004  | Discharge flue middle cover plate              | 1   |
| 5   | 33313038  | Cooling fan assembly                           | 1   |
| 6   | 33027002  | Discharge flue baseboard                       | 1   |
| 7   | 33310001  | Cooling thermostat                             | 1   |
| 8   | 33323013  | Thermometer probe assembly                     | 1   |
| 9   | 33027024  | Discharge flue baseboard Support block (right) | 1   |
| 10  | 33215019  | Chimney  | 1   |
| 11  | 33030026  | shell rear cover plate                         | 1   |
| 12  | 33027023  | Discharge flue baseboard Support block (left)  | 1   |
| 13  | 33315008  | Circulating fan assembly                       | 1   |
| 14  | 33305009  | Junction box                                   | 1   |
| 15  | 33304077  | Power cord                                     | 1   |
| 16  | 33016002  | Cavity rear support                            | 1   |
| 17  | 33308001  | Overheat protector                             | 1   |
| 18  | 33303027  | Rear heating element                           | 1   |
| 19  | 33302002  | Lamp assembly                                  | 1   |
| 20  | 33027030  | Shell baseboard connect block                  | 2   |
| 21  | 33314004  | Door lock motor assembly                       | 1   |
| 22  | 33301021  | Door lock micro switch block                   | 2   |
| 23  | 33301012  | Door lock motor fixed                          | 1   |
| 24  | 33301013  | Door lock micro switch                         | 2   |
| 25  | 33301009  | Micro switch block                             | 1   |
| 26  | 33301011  | Latch hook block                               | 1   |
| 27  | 33301010  | Latch hook block                               | 1   |
| 28  | 33058102  | Rail bracket bottom fixed seat                 | 1   |
| 29  | 33141007  | hinge fixed board                              | 4   |
| 30  | 33005089  | Cavity panel                                   | 2   |
| 31  | 33316005  | Thermostat switch assembly                     | 1   |
| 32  | 33303002  | Bottom heating element                         | 1   |
| 33  | 33018195  | Cavity panel                                   | 1   |
| 34  | 33003005  | Bottom heating element fixed board             | 1   |
| 35  | 33003006  | Bottom insulation fibre heat shield            | 1   |
| 36  | 33029016  | Shell baseboard                                | 1   |
| 37  | 33803011  | Door sealing assembly                          | 1   |
| 38  | 33027032  | Cavity panel under bracing                     | 1   |
| 39  | 33001044  | Rear heating element baffle                    | 1   |
| 40  | 33170001  | shelf  | 2   |
| 41  | 33224005  | Tray   | 1   |
| 42  | 33180024  | Hinge assembly-17                              | 2   |
| 43  | 33014141  | Inner glass low right fixed block              | 1   |

|    |            |                                  |   |
|----|------------|----------------------------------|---|
| 44 | 33014139   | Active shaft right fixed block   | 1 |
| 45 | 33103050   | Inner glass                      | 1 |
| 46 | 33005073   | Up door bracket detent spring    | 2 |
| 47 | 33005072   | Up door bracket detent           | 2 |
| 48 | 33014150   | Door frame right bracket         | 1 |
| 49 | 33104054   | Middle glass                     | 1 |
| 50 | 33015277   | Door panel decorating plate      | 1 |
| 51 | 33102656   | Door panel                       | 1 |
| 52 | 33006012   | Handle fixed board               | 1 |
| 53 | 33190004   | Handle-4                         | 1 |
| 54 | 33104041   | Middle glass                     | 1 |
| 55 | 33214005   | Handle fixed assembly            | 2 |
| 56 | 33014149   | Door frame left bracket          | 1 |
| 57 | 33219020   | Middle glass upper fixed block   | 2 |
| 58 | 33014138   | Active shaft left fixed block    | 1 |
| 59 | 33014140   | Inner glass low left fixed block | 1 |
| 60 | 33014151   | Glass baffle                     | 1 |
| 61 | 33014148   | Upper door bracket               | 1 |
| 62 | 33172001   | Grasp                            | 1 |
| 63 | 33140023   | Right rail bracket               | 1 |
| 64 | 33140022   | Left rail bracket                | 1 |
| 65 | 33170003   | baking tray(shallow)             | 1 |
| 66 | 33014147   | shell right bracket              | 1 |
| 67 | 33014146   | shell left bracket               | 1 |
| 68 | 33239001   | Oven fix assembly                | 4 |
| 69 | 32245003   | Shell left and right side plate  | 2 |
| 70 | 33032016   | Metal knob                       | 2 |
| 71 | 34039003   | Control panel decorate           | 1 |
| 72 | 33101624   | Switch panel                     | 1 |
| 73 | 33006001   | Switch panel connect panel       | 4 |
| 74 | 33301048   | 11 function swithc assembly      | 1 |
| 75 | 33322008   | Screen fixed box                 | 1 |
| 76 | 33018197   | Switch panel fixed board         | 1 |
| 77 | 33321121   | Mechanical touch display board   | 1 |
| 78 | 33005006   | Door switch slider               | 1 |
| 79 | 33005005   | Door switch fixed board          | 1 |
| 80 | 33301020   | Door switch                      | 1 |
| 81 | 33319002   | Door switch spring               | 1 |
| 82 | 33215025   | Chimney baffle                   | 1 |
| 83 | 33321009   | Touch power board                | 1 |
| 84 | 33303098   | Top heating element              | 1 |
| 85 | 3313101281 | Complete Door Assembly           | 1 |