



Induction Hob

B&Q Code CLIFZ-60

| REF | Model |
|----------|-------------|
| 29398454 | HINDL60CL |
| 668931 | HINDL60CL-F |

Version:03

Date:2015-01-14

HINDL60CL Exploded drawing

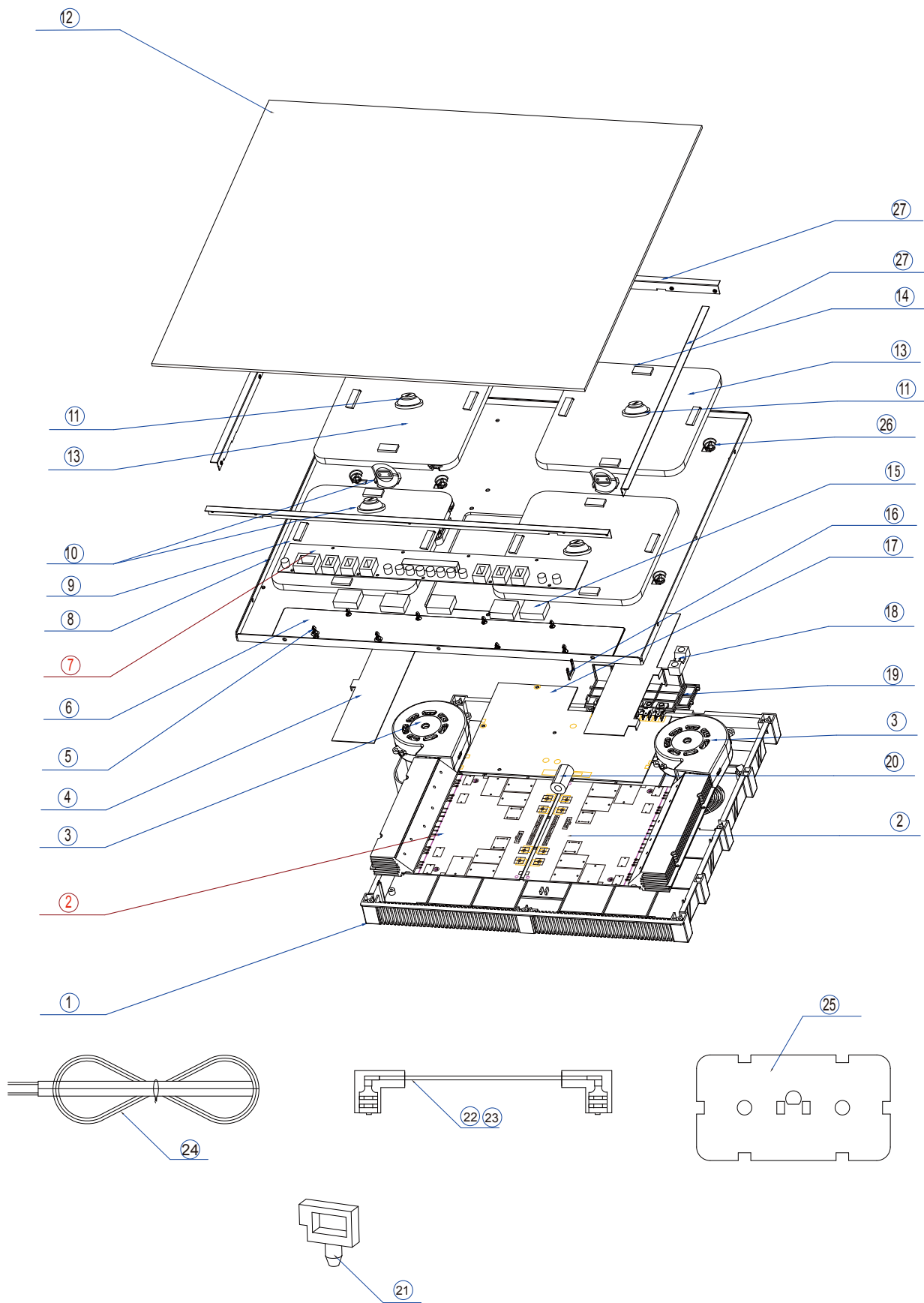

| | | | |
|-------|----------------------------|-------------|--------------|
| 02 | Revise No. 2/7 | Eason | 2014. 12. 26 |
| 01 | change the code of no17/24 | Paul | 2014. 01. 14 |
| 00 | New document | Paul | 2013. 11. 15 |
| Index | Modify description | Modified by | Date |

HINDL60CL parts list

| No. | Parts code | Parts names | QTY | Series No. |
|---------|---------------|-----------------------------|-----|------------------|
| 1 | 541300100003 | base cover | 1 | |
| 2 | 541500000048 | Main control board | 2 | before:14W24 use |
| | 541500000059 | Main control board | 2 | From:14W43 use |
| 3 | 541600100003 | Fan | 2 | |
| 4 | 541700300007 | windshield insulating flake | 2 | |
| 5 | 303207300211 | knighthead | 4 | |
| 6 | 541700300017 | isinglass flake A | 1 | |
| 7 | 541500100071 | display board | 1 | before:14W24 use |
| | 541500100081 | display board | 1 | From:14W43 use |
| 8 | 541400300027 | radiator board | 1 | |
| 9 | 542200000022 | Coil groupware (220) | 2 | |
| 10 | 541600200016 | Thermistor component | 2 | |
| 11 | 541600200020 | Thermistor component | 2 | |
| 12 / 27 | HINDL60CL-123 | glass assembly | 1 | 542000600568 |
| | | | 2 | 541400100008 |
| | | | 1 | 542300000059 |
| 13 | 542200000023 | Coil groupware (220) | 2 | |
| 14 | 541700200014 | silicone gasket | 16 | |
| 15 | 541700700002 | Supporting Foam | 5 | |
| 16 | 541400500001 | brace | 2 | |
| 17 | 541500200003 | Power board | 1 | |
| 18 | 541300600004 | Fixed board | 1 | |
| 19 | 541300600003 | power cord case cover | 1 | |
| 20 | 543000300002 | magnet ring | 5 | |
| 21 | 303207300212 | line clamp | 8 | |
| 22 | 541800000018 | cable | 2 | |
| 23 | 541800000019 | cable | 2 | |
| 24 | 541800000034 | Power cord | 1 | |
| 25 | 541700300023 | adiabatic foam | 2 | |
| 26 | 541400400011 | spring | 16 | |