

COOKETM
& LEWIS

CLIH60-C

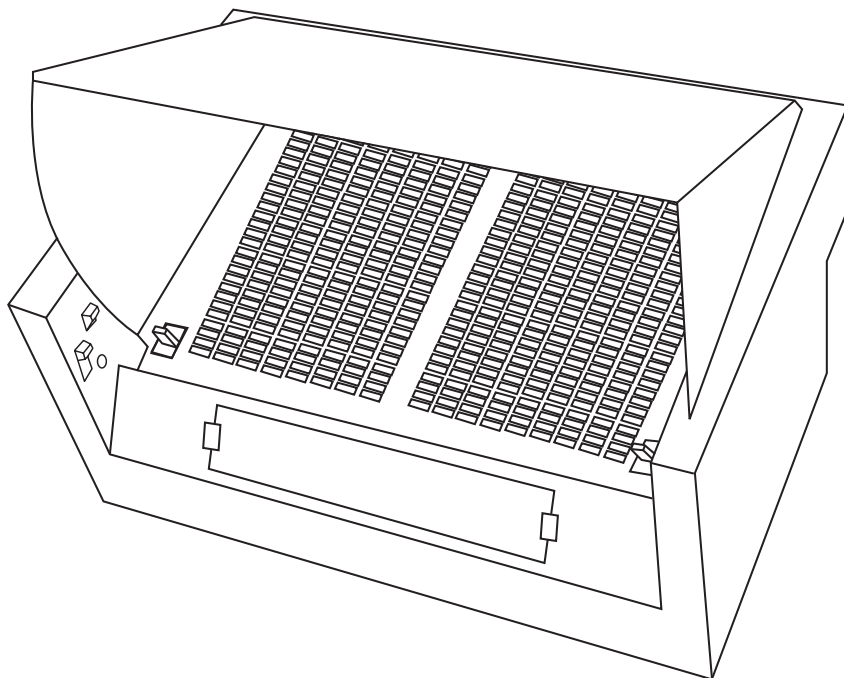

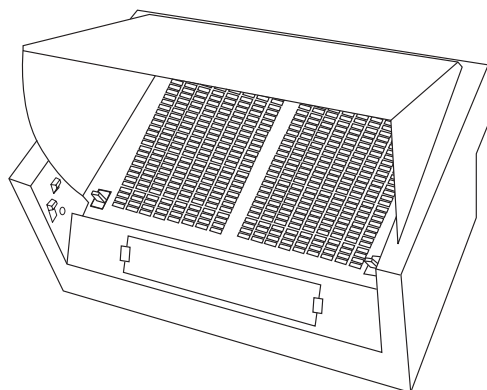

[01] x 1

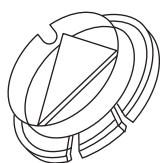

[02] x 1



[03] x 1



[05] x 1

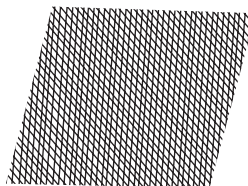

[04] x 1

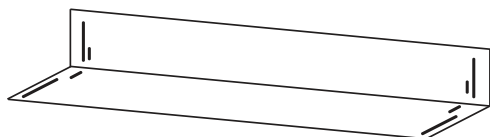

[06] x 1



x 2



x 2

Let's get started...



Getting **started**...

04

Before you start
Safety

05
07

In more **detail**...

11

Product functions 12
Operation 12
Care and maintenance 14
Troubleshooting 16
Recycling and disposal 17
Technical and legal information 17
Guarantee 20
CE Declaration of conformity 22



Appendix

Installation
ErP Information of the bulb provided
Information for EU66

23
33
34

Getting Started...



Before you start

05

Safety

07

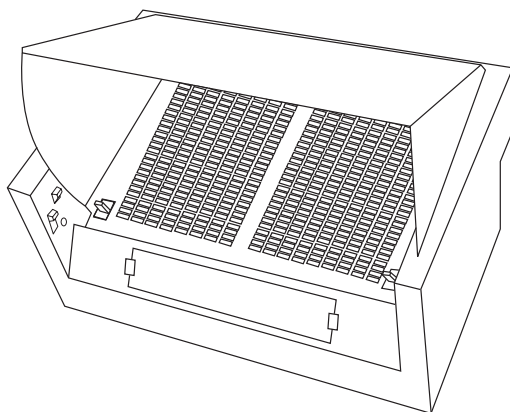

Before you start

- ☒ To avoid the risks that are always present when you use an electrical appliance it is important that this appliance is installed correctly and that you read the safety instructions carefully to avoid misuse and hazards. Please keep this instruction booklet for future reference and pass it on to any future owners. After unpacking the appliance please check that it is not damaged. If in doubt, do not use the appliance but contact Customer Services on 0344 800 1128 (UK), 01 4475261 (Ireland).
- ☒ Check the package and make sure you have all of the parts listed.
- ☒ Decide on the appropriate location for your product.
- ☒ If this product contains glass please take care when fitting or handling to prevent personal injury or damage to the product.
- ☒ The specifications plate is available on this appliance. This plate displays all the necessary identification information for ordering replacement parts.
- ☒ If you sell the appliance, give it away, or leave it behind when you move house, make sure you also pass on this manual so that the new owner can become familiar with the appliance and its safety warnings.

Tools required

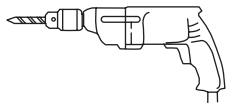

Ø6mm

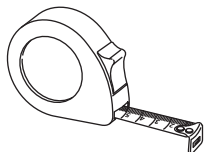

Accessories not supplied

Recirculation

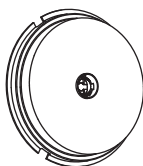

CARBFLT1 (UK & IE)



SELF ADHESIVE
ALUMINIUM TAPE

Extraction

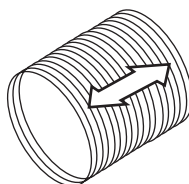

Ø125mm

VENT PACK 2 (UK & IE)



x 4

3.9 x 32 mm



x 8

Short Screw for cabinet & door



x 4

Wall Plug Ø6mm

CARBON FILTER ORDERING HOTLINE

0344 800 1128 (UK) 01 4475261 (IE)

These instructions are for your safety. Please read through them thoroughly prior to installation and retain them for future reference.



- All installation work must be carried out by a competent person or qualified electrician.
- This appliance must be installed correctly by a suitably qualified person, strictly following the manufacturer's instructions.

- ✓ This appliance complies with all current European safety legislation, however, the Manufacturer must emphasise that this compliance does not prevent the surfaces of the appliance from heating up during use and remaining hot during its operation.
- ✓ Accessible parts may become hot during use. Young children should be kept away. Care should be taken to avoid touching the appliance
- ✓ The Manufacturer highly recommends that this appliance be kept out of the reach of babies and small children.
- ✓ This appliance can be used by children aged from 8 years and above and persons with reduced physical, sensory or mental capabilities or lack of experience and knowledge if they have been given supervision or instruction concerning use of the appliance in a safe way and understand the hazards involved. Children shall not play with the appliance. Cleaning and user maintenance shall not be made by children unless they are older than 8 and supervised.

- ☑ Keep the appliance and its cord out of reach of children less than 8 years.
- ☑ Means for disconnection must be incorporated in the fixed wiring in accordance with the wiring rules. An all-pole disconnection switch having a contact separation of at least 3 mm in all poles should be connected in fixed wiring.
- ☑ Regularly check the power plug and power cord for damage. If the supply cord is damaged, it must be replaced by the manufacturer, its service agent or similarly qualified persons in order to avoid a hazard.
- ☑ Do not allow the electric cables to touch the hot parts of the appliance.
- ☑ Make sure that the power cord is not caught under or in the appliance and avoid damage to the power cable.
- ☑ Do not install the appliance outdoors in a damp place or in an area which may be prone to water leaks such as under or near a sink unit. In the event of a water leak allow the machine to dry naturally.
- ☑ Do not use flammable sprays in close vicinity to the appliance.
- ☑ Please dispose of the packing material carefully.
- ☑ Do not use flammable sprays in close vicinity to the appliance.

- ✓ We also recommend that great care be taken during use and cleaning. Read the cleaning and maintenance sections for this appliance carefully.
- ✓ A steam cleaner is not to be used.
- ✓ The appliance is not intended to be operated by means of external timer or separated remote-control system.
- ✓ The appliance is for domestic use only.
- ✓ **Warning:** Consult local regulations regarding fumes outlets. Do not connect the hood to a fume, ventilation or hot air duct. Confirm that room ventilation is appropriate with the local authorities. Make sure the maximum air extraction flow rate for the appliances in the room does not exceed 4 Pa (0.04 mbar). The room must have adequate ventilation if an extractor hood is used simultaneously with appliances that run on gas or other fuels. The air must not be discharged into a flue that is used for exhausting fumes from appliances burning gas or other fuels. Regulations regarding air extraction must be complied with.
- ✓ **Warning:** Before connecting the hood: switch off the electricity supply and check that the supplied voltage and frequency coincide with that indicated on the appliance nameplate.

- ✓ **Warning:** The hood may stop working during an electrostatic discharge (e.g. lightning). This involves no risk of damage. Switch off the electricity supply to the hood and reconnect after one minute.
- ✓ To avoid the risk of fire, clean the metal filter regularly and closely watch and regulate pans containing hot oil.
- ✓ Do not use the hood if it shows signs of damage or imperfection. Contact customer services.
- ✓ Flambe cooking must not be carried out underneath this appliance.
- ✓ When installing the appliance, make sure that the following distances between the top of cooker or hob and the lowest part of the cooker hood must be observed:
 - > Gas hobs: 750mm.
 - > Electric hobs: 650mm.
- ✓ The Manufacturer declines all liability for personal or material damage as a result of misuse or incorrect installation of this appliance.

**Warning**

There is a risk of electric shock and fire if cleaning is not carried out in accordance with the instructions.



In more detail...

Product functions	12
Operation	12
Care and maintenance	14
Troubleshooting	16
Recycling and disposal	17
Technical and legal information	17
Guarantee	20
CE Declaration of conformity	22

Product functions

This appliance extracts the air of the kitchen to remove the odours and keep an optimum level of air quality inside the room, it also allows you to illuminate the cooking area.

Operation

Operation





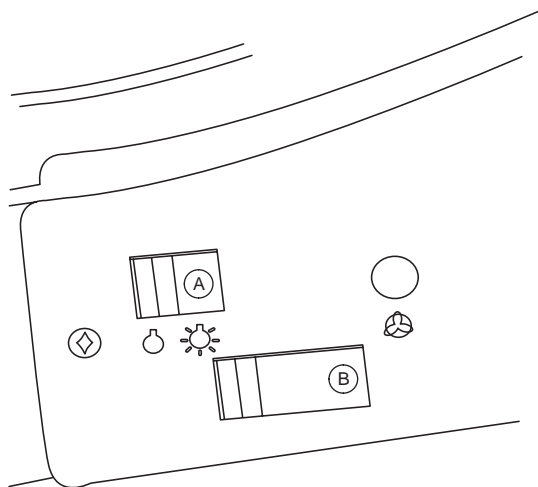

Using Your Cooker Hood.

The light and the fan motor will not operate if the outer cover is in the closed position.

Pull open the outer door and the control switches can be seen on the left side panel.

The upper slider switch (A) will turn the lamps on and off. The lower slider switch (B) will turn the extractor fan motor on and off. There are three motor speeds available.



-  Lighting OFF
-  Lighting ON
-  Extractor fan OFF
-  Extractor fan speed – button: speed 1
-  Extractor fan speed – button: speed 2
-  Extractor fan speed – button: speed 3
-  Extractor fan operating control pilot light

Position 1, should be selected when simmering or using only one pan.

Position 2, for normal cooking, up to four pans.

Position 3, when frying or cooking foods with strong odours.

If the outer door is closed without switching off the fan motor, or lamps, an override switch will turn the cooker hood OFF.

When the outer door is opened the cooker hood will resume working at its previous settings.

The cooker hood will not operate when the outer door is opened if the switches are in the OFF position.

To obtain the best results from your cooker hood it is recommended that you leave it switched on for 15 minutes after you have finished cooking.

In more detail...

Care and maintenance

Warning: always switch off the electricity supply before carrying out maintenance work on the hood. In the event of a fault, contact customer services.

Bulb replacement

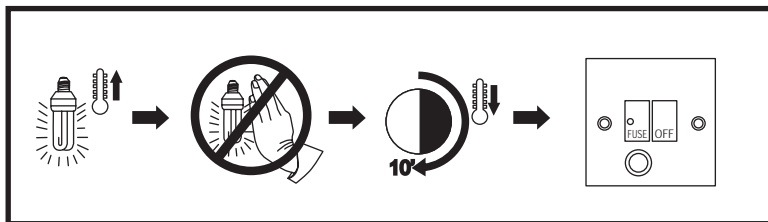

The Bulb may be hot, leave it 10 minutes before removing it.

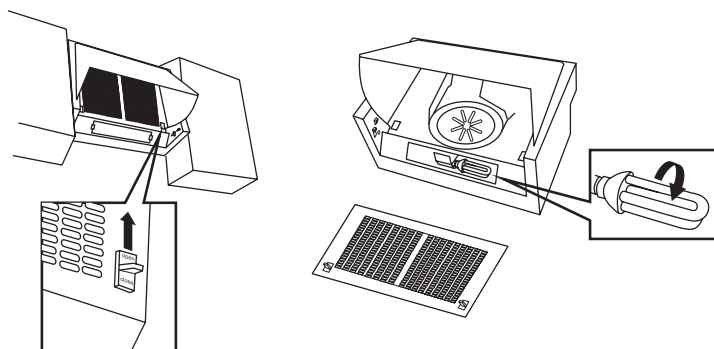

Push the clip and release the metal panel and the metal filter.
Turn the lamp to remove.



Warning

Always switch off the electricity supply before performing maintenance work. In the event of a fault, contact customer services.

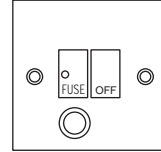

1 x ACTIVE CHARCOAL FILTER (NOT SUPPLIED).
MODEL NUMBER CARBFILT1 (UK & IE).

Metal filter maintenance:

Clean using non-corrosive, liquid detergent or a special stainless steel cleaner and avoid the use of abrasive cleaning products.

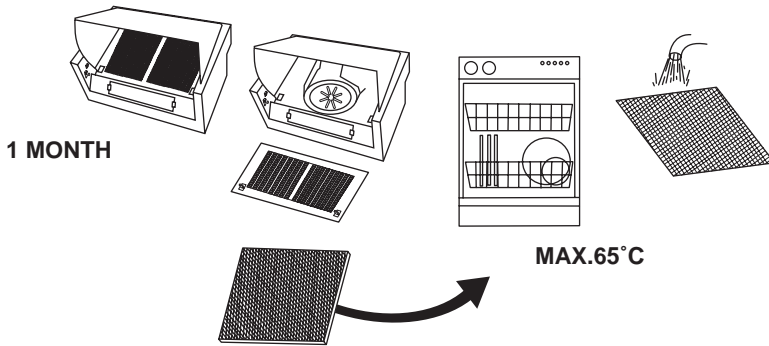

Aluminium filters: to avoid fires, clean thoroughly once a month or whenever the display pilot light (if fitted) indicates as such. To do so, remove the filters, soak in hot water and mild detergent for an hour. If using a dishwasher, position the filters vertically to improve the cleaning process.

Active charcoal filter replacement:

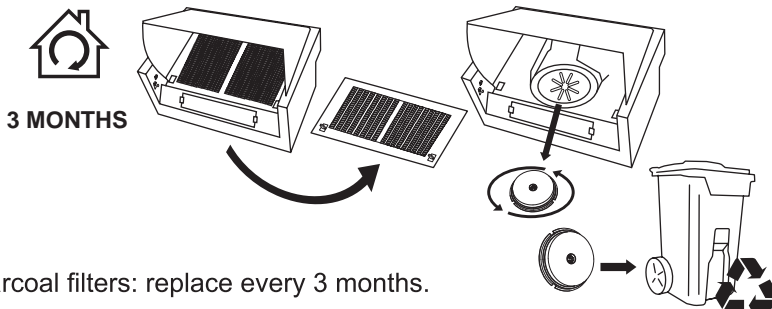

Active charcoal filters: replace every 3 months.

Important: increase the filter cleaning/replacement frequency if the hood is used for more than 2 hours a day. Always use the recommended filter.

In more detail...

Troubleshooting

Fault	Cause	Solution
Excessive Vibration	The Appliance is not hung properly on the brackets.	Take down the appliance and check it is properly fixed.
	The fan blade is damaged.	Switch off the appliance. Repair to be carried out by qualified service personnel only.
	The fan motor is not fixed tightly.	
Light on, but motor does not work.	The fan blade is jammed.	
	The motor is damaged.	
Both light and motor do not work.	Light bulb blown.	Replace with a bulb with correct rating.
	Power connection loose.	Check power supply.
Suction performance reduced.	Speed may be too low.	Select a higher speed.
	Distance between the cooker hood and the hob is too great.	Readjust the distance to: Gas cookers: 750mm Electric cookers: 650mm
	Aluminium grease filter is dirty.	Clean filters. (see care and maintenance)
	Top vent might be obstructed. (CLVH60SS-C & CLVH60W-C)	Clear any obstruction.
	Optional vent kit might be twisted.	Ensure that the vent kit is fitted to the manufacturers instructions.
Works normally but cooking smells linger.	Charcoal filter not fitted in recirculation mode or charcoal filter is full of grease.	Fit charcoal filter if recirculating or change the filter. (see care and maintenance)

Recycling and disposal

Environmental protection

Waste electrical products should not be disposed of with household waste. Please recycle where facilities exist. Check with your Local Authority or retailer for recycling advice.



The symbol on the product or its packaging indicates that this product cannot be treated as normal household waste. This product must be handed over to an electric and electronic equipment collection point for recycling.

On ensuring that this product is disposed of correctly, you will help to avoid possible negative consequences for the environment and public health, which could occur if this product is not handled correctly. To receive more detailed information about recycling this product, contact your local government, domestic waste disposal services or the outlet where the product was bought.

Technical and legal information

Technical and legal information

Power supply	: 220-240V~ 50Hz
Power consumption – Fan	: 1x125W
Power consumption – Luminary	: 1 x 9W Max
Power consumption – Total	: 134W
Protection class	: II
Light bulb	: Max. 9 W (E-14)

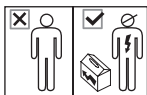

All installation work must be carried out by a competent person or qualified electrician.

Before connecting the mains supply ensure that the mains voltage corresponds to the voltage on the rating plate inside the cooker hood.

WARNING : THIS APPLIANCE MUST NOT BE EARTHED.

Mains Supply could be connected to the Mains Voltage by Direct Connection

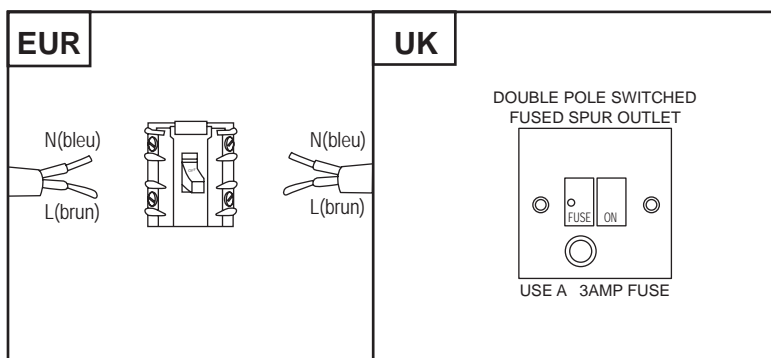

Direct Connection

If the appliance is being connected directly to the mains an omnipolar circuit-breaker must be installed with a minimum opening of 3mm between contacts.

If the supply cord is damaged, it must be replaced by the manufacturer, its service agent or similarly qualified persons in order to avoid a hazard

The installer must ensure that the correct electrical connection has been made and that it complies with wiring diagram.

The cable must not be bent or compressed.

The cable must be checked regularly and replaced by authorized technicians only.

Electrical Requirements

Any permanent electrical installation must comply with the latest I.E.E. Regulations and local electricity company regulations. For your own safety a qualified electrician or contractor who is on the roll of the National Inspection Council for Electrical Installation Contracting (NICEIC) should undertake the electrical installation.

Electrical Connection

Before connecting the mains supply ensure that the mains voltage corresponds to the voltage on the rating plate inside the cooker hood.

WARNING: THIS APPLIANCE MUST NOT BE EARTHED

The appliance is supplied with a 2-core mains cable and must be connected to the electricity supply via a double pole switch having a 3mm minimum contact gap on each connector.

For UK only
A Switched Fused Connection Unit to BS 1363 Part 4 is recommended.

The fuse must be rated at 3 Amps.

The wires in the mains lead are coloured in accordance with the following code:

Brown = L - Live

Blue = N - Neutral

The connection point must be placed in a position adjacent to the appliance so as to be readily accessible for an engineer in the event of a breakdown.

Disconnect the appliance from the mains supply before carrying out any kind of maintenance or cleaning.

In more detail...

Manufacturer's Guarantee

This appliance is covered by a full manufacturer's 24 month parts and labour guarantee and covers all parts and labour costs associated with the repair of the appliance in a domestic environment. We will repair any defect that arises due to faulty materials or workmanship and use genuine manufacturers parts.

All claims must be supported with the original receipt or other reasonable proof of purchase.

If, during the guarantee period, the appliance becomes irreparable as agreed by the engineer approved by GAA then we reserve the right, at our discretion, to exchange the defective product with a replacement appliance at GAA's sole cost. If the same product is no longer available an alternative will be offered with the same functions as the faulty item.

After an appliance has been repaired or replaced any remaining balance of the GAA guarantee will be valid and any further call outs during this prescribed period will be covered by GAA on the replacement appliance.

Should any person other than an authorized engineer modify or attempt to repair the appliance then the warranty will be invalid.

The guarantee applies to the UK mainland, Scotland, Ireland, ROI and France but is not transferrable between EU countries.

This guarantee is non-transferrable to any other person or product. The guarantee is covered by UK law and is in addition to and does not diminish your legal rights.

Exclusions to the guarantee

This guarantee does NOT cover:

Appliances that have been damaged or neglected as a result of failure to store, assemble, install, use or care of the products in accordance with the manufacturer's instructions - GAA will not accept responsibility under this guarantee if a product is damaged or becomes defective due to, misuse, neglect, wilful or accidental damage or act of god.

Normal wear and tear.

Consumable items such as carbon filters and bulbs.

Exclusions to the guarantee (continued)

Claims arising from non-domestic use or commercial environment.

Any gas appliance not fitted by a gas safe qualified installer.

If no fault is found then GAA reserves the right to charge for the call out at the going rate of £55.00 plus VAT.

In the course of the service work carried out it may be necessary to remove the built in appliance from its fitted position. If the appliance is glued, grouted or tiled in such a manner that it cannot be removed, it is the responsibility of the customer/installer to remove and reinstall the appliance to facilitate the repair.

This Guarantee does not affect your statutory rights.

The guarantee is offered by GAA Ltd, 1301-1303 Lu Plaza,
2 Wing Yip St, Kwun Tong, Kowloon, Hong Kong.

Customer Service

To arrange an in guarantee service call, please contact customer services on the following numbers.

UK & Northern Ireland

Phone: 0344 800 1128*

Email: uksupport@apelson.co.uk

Web: www.spareszone.co.uk

Republic of Ireland (Eire)

Phone: 014475261

Email: uksupport@apelson.co.uk

*** Local call rates apply**

CE Declaration of conformity

In more detail...



MANUFACTURER: CATA

ADDRESS: C/ Ter n° 2, Torell— 08570 - Barcelona (Spain)

We hereby certify that the mentioned accessory complies with the essential requirements of the European Directives applicable, including their modifications and the corresponding transpositions from the national law.

MACHINE APPLICATION: CLIH60-C

TYPE: Integrated Cooker Hood

EC DIRECTIVES APPLIED: Comply with the European Directives 2006/95/EC: LVD and the 2004/108/EC: EMC

APPLIED HARMONIZED STANDARDS:

Standard EN 60335-1 Safety of household and similar electrical appliances
Standard EN 60335 part 2-31, particular requirements for range hoods
Standard EN 55014 Limits and methods of measurement of radio disturbance
Standard EN 61000-3-2 Electromagnetic compatibility limits for harmonic.
Standard EN 61000-4-5 Electromagnetic compatibility (EMC)

APPLIED INTERNATIONAL TECHNICAL

STANDARDS AND SPECIFICATIONS: ISO9001.2008

PLACE: Torell—

David Sala
Technical Manager

This appliance respects laws of the suppression of radio-interference. The Manufacturer has a policy of continuous product improvement, it reserves the right to adapt and carry out any modification considered necessary without prior warning.

B&Q plc
Chandlers Ford, Hants
SO53 3LE United Kingdom
www.diy.com



Appendix...

**Installation
ErP Information of the bulb provided
Information for EU66**

Appendix...

01

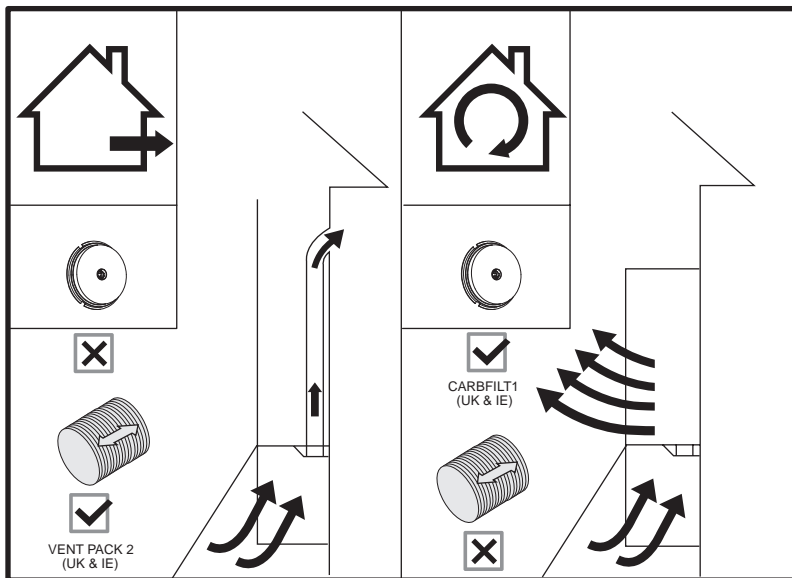

You can choose two type of installation:

- Extraction option
- Recirculation option.

Installation for Recirculation.

If it is not possible to exhaust through an outside wall the cooker hood can be fitted with a carbon filter (optional extra) to remove any odours and the air is then re-circulated.

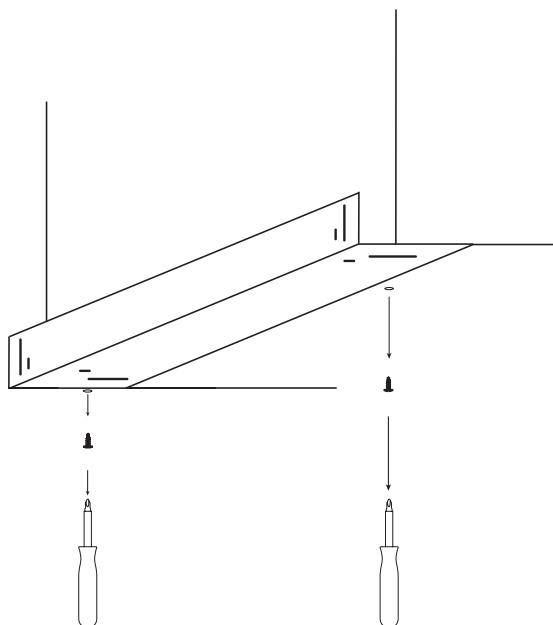

02



Unscrew the bracket from the hood.

(Do not dispose of screws and washers as you will require them later)

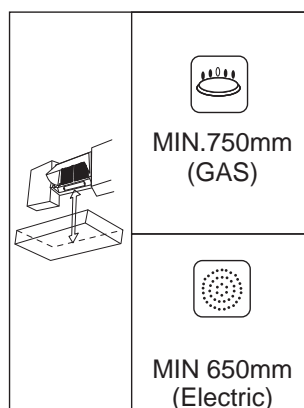
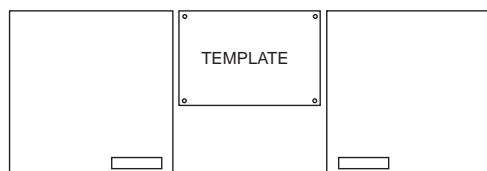

03



[5] x 1

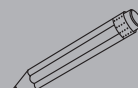

Mounting the Integrated Hood on the Wall.

Position the template [05] between the 2 kitchen cabinets making sure you align the top of the template with the top of the units.

Mark the 4 holes with a pencil

04

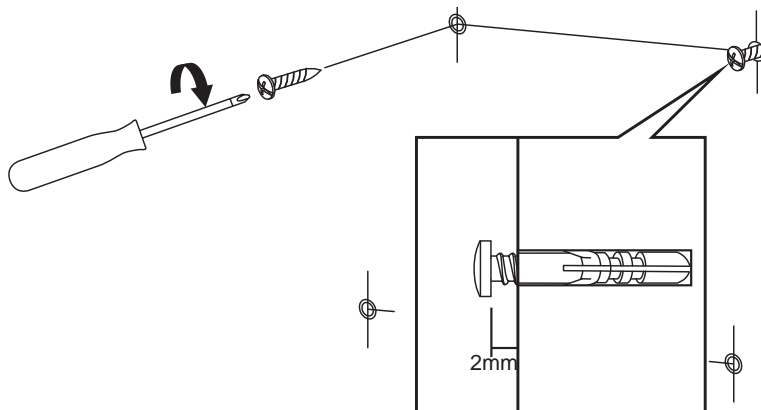
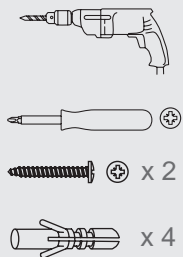

Drill the 4 marked holes, insert wall plugs and fix 2 top screws, leaving the screw head protruding 2mm.



Ensure wall plugs (not supplied) used are suitable for wall type.

05

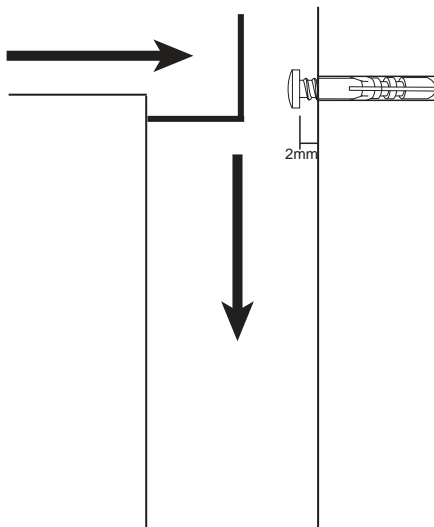

Position hood over 2 wall screws, and use keyhole slots on adjustment bracket to support the weight.

06

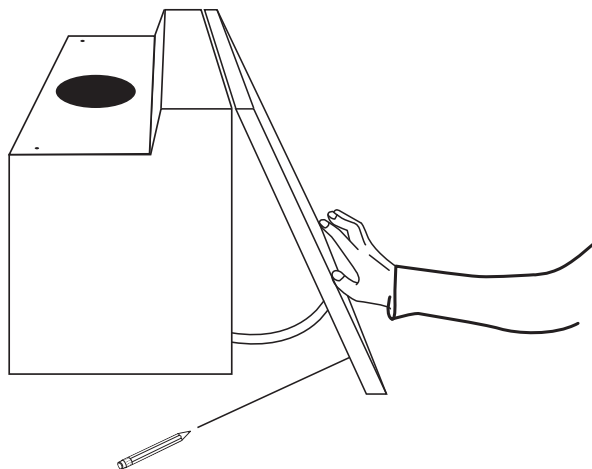
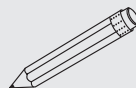

Position furniture door on the unit and use a pencil to mark a line

07

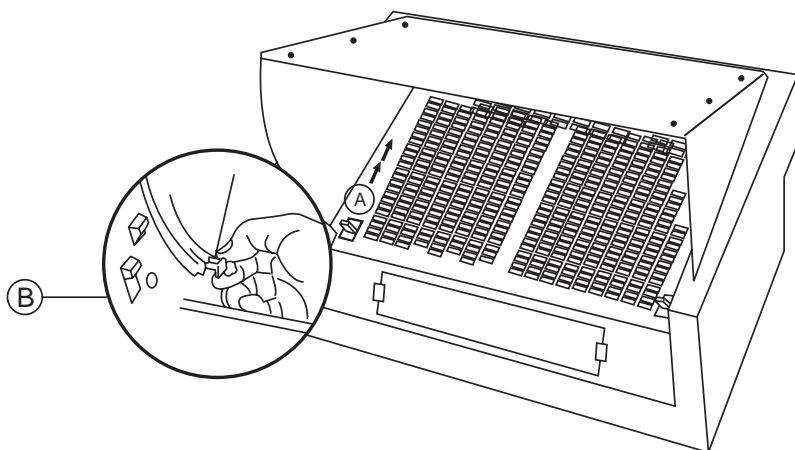

Open the front panel and push the two catches (A) upwards and remove the grille and grease filter.

Pull the locking pin B, on both sides of the front panel, until they stop, and pull the front panel forward until it is released from its guide rails and separated from the hood.

Note: It is important that if the locking pins are not pulled out until they stop, and the outer door is forced into the slide guides, the pins could be damaged or broken

08

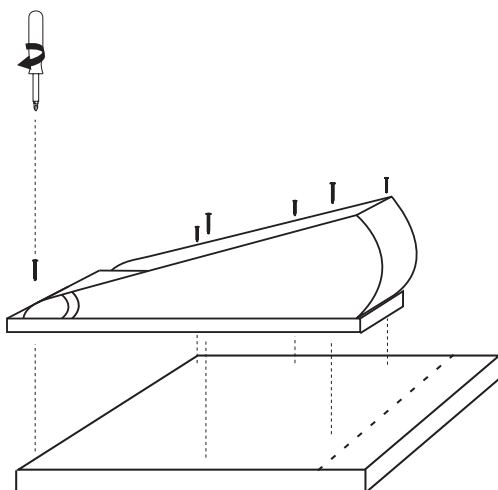

Reverse furniture door face down and line up furniture door to pencil mark
Mark 6 holes with a pencil
Screw into place

09

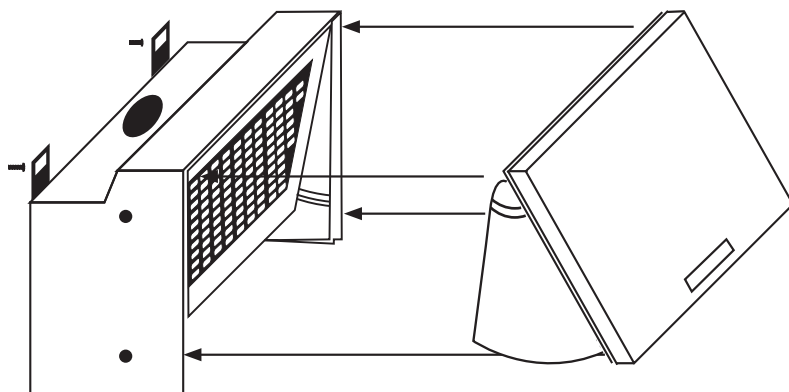

Remounting the hood front panel.

Remount the hood front panel onto the hood with decor panel now attached.

10

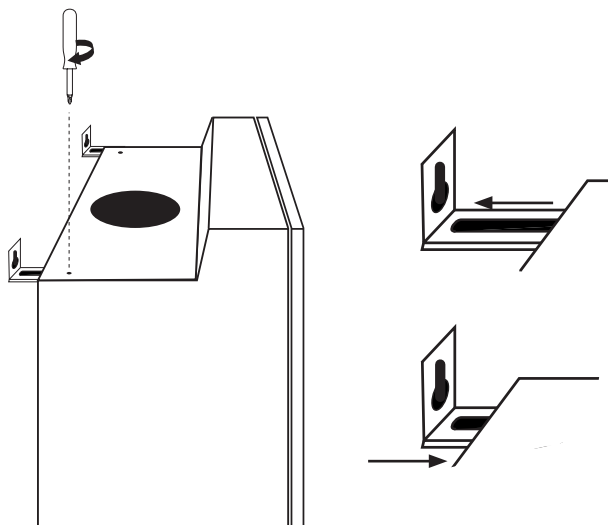

Positioning the hood using the adjustable brackets.

Use the 2 adjustment screws on the top on the hood to adjust the hood - front to back - to line up the hood flush with your cabinet doors. Tighten the 2 screws in desired position.

A

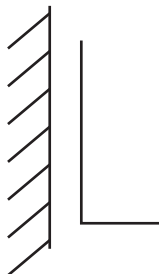
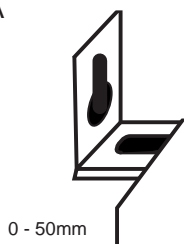

B

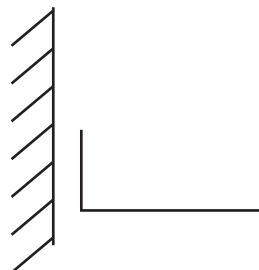
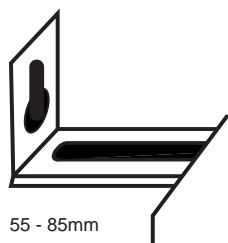

11

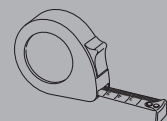

[06] x 1

Take the hood off the wall and measure from back of hood to end of adjustable bracket.

A. If the space at the back of the hood is between 0 - 50mm, put the largest section of the bracket fixed to the wall.

B. If the space at the back of the hood is greater than 50mm to a maximum of 85mm, put the smaller section of the bracket to the wall.

12

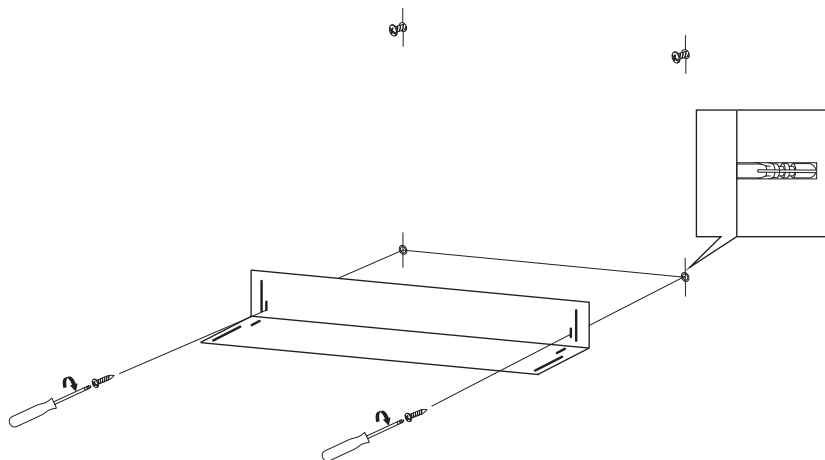

Fix the bracket to the wall.

13

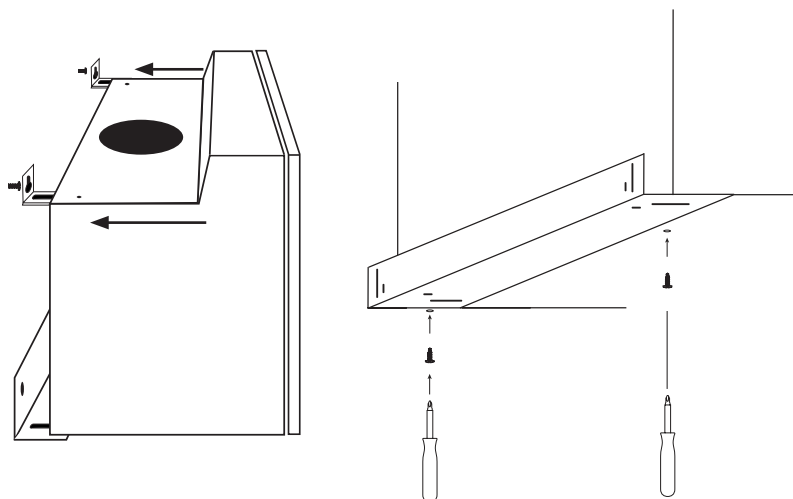

Remount the hood using the 2 wall screws and then fix the bottom 2 screws and washers (supplied) through the bottom of the bracket into the hood.

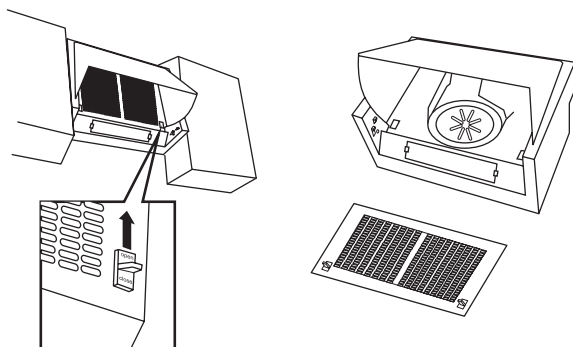
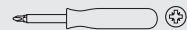

Fig 1

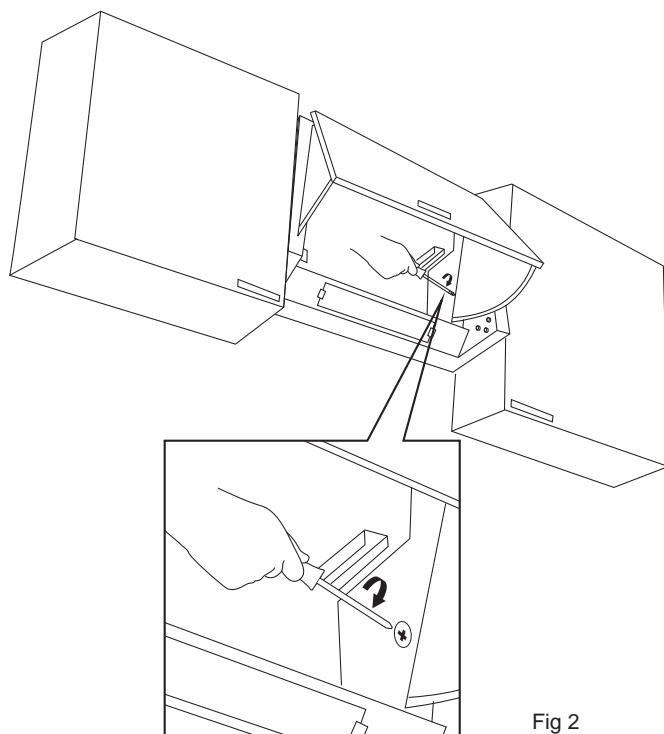

Fig 2

Remove the grill (Fig 1)

Fix the cabinet screws on the side. Make sure the screw length is compatible with the kitchen cabinet thickness (Fig 2)

15



[02] x 1

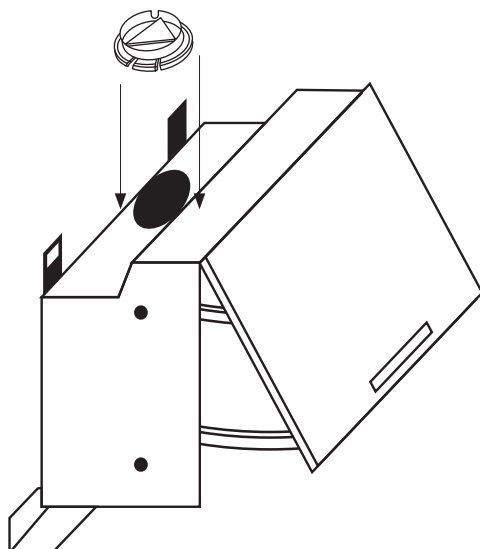

16

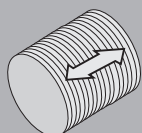

Vent Pack 2
x 1

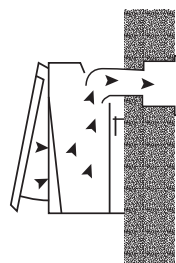
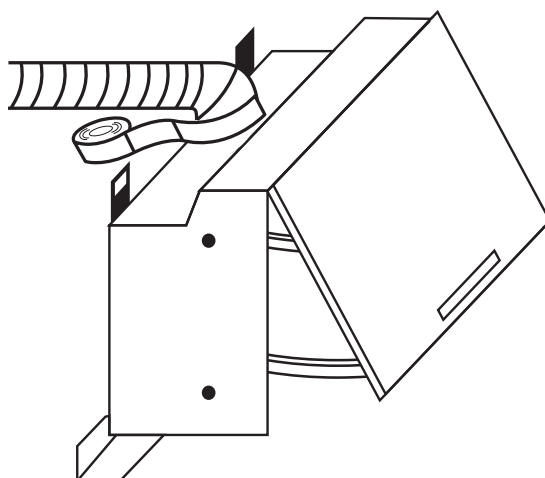
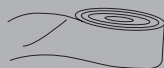

To fit the extraction pipe insert the vent collar, (this can be found inside the cooker hood when it is unpacked), into the aperture on the top of the cooker hood and secure the pipe to the collar.



GB

IE

Appendix...

ErP Information of the bulb provided

RUS

Приложение...

Данные об эффективной мощности излучения приведены на лампе

FR

Annexe...

Informations ErP de l'ampoule fournie

ES

Anexo...

Información ErP de la bombilla incluida

PL

Załącznik...

Informacja ErP dotycząca dołączonej żarówki

TR

Ek bölüm...

Ürünle birlikte verilen ampulün ErP bilgileri

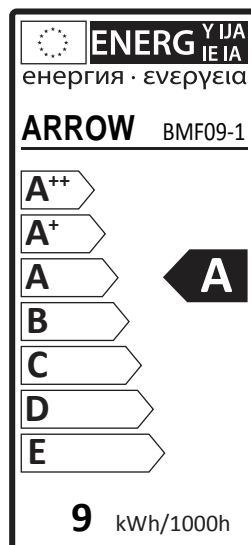
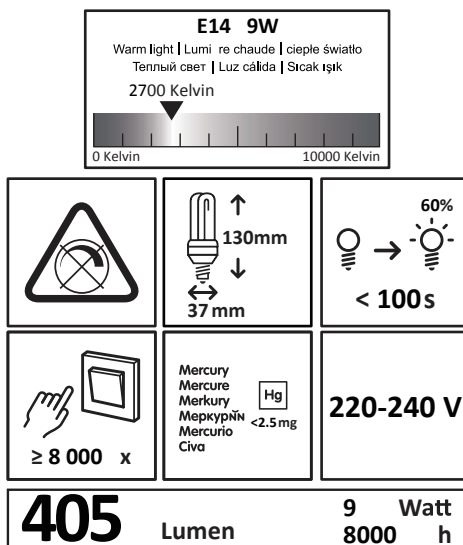

220-240V ~ 50/60Hz

**(A) Information of the cooker Hood (www.diy.com)**

	Symbol	Value	Unit
Model identification		CLIH60-C	
Annual Energy Consumption	AEC_{hood}	70.3	kWh/a
Time increase factor	f	1.7	
Fluid Dynamic Efficiency	FDE_{hood}	8.2	
Energy Efficiency Index	EEl_{hood}	91.9	
Measured air flow rate at best efficiency point	Q_{BEP}	163.2	m ³ /h
Measured air pressure at best efficiency point	P_{BEP}	184	Pa
Maximum air flow	Q_{max}	238.4	m ³ /h
Measured electric power input at best efficiency point	W_{BEP}	102.3	W
Nominal power of the lighting system	W_L	9.0	W
Average illumination of the lighting system on the cooking surface	E_{middle}	109	lux
Measured power consumption in standby mode	P_s	—	W
Measured power consumption off mode	P_o	0	W
Sound power level	L_{WA}	Max. 65 / Min. 63	dB

The measurement and calculation method of the above table was done in accordance with commission regulation (EU) No 65/2014 & 66/2014.

(B) The following shows how to reduce total environmental impact (e.g. energy use) of the cooking process.

- (1) Install the cooker hood in a proper place where there is efficient ventilation.
- (2) Clean the cooker hood regularly so as not to block the airway.
- (3) Remember to switch off the cooker hood light after cooking.
- (4) Remember to switch off the cooker hood after cooking.

(C) Information for dismantling.

Do not dismantle the appliance in a way which is not shown in the user manual. The appliance could not be dismantled by user. At the end of life, the appliance should not be disposed of with household waste. Check with you Local Authority or retainer for recycling advice.



B&Q plc
Chandlers Ford, Hants
SO53 3LE United Kingdom
www.diy.com
