



Built-under Refrigerator:BU60RFA

Version:02

Date:2016-08-22

Product reference code:BU60RFA

BU60RFA Exploded drawing

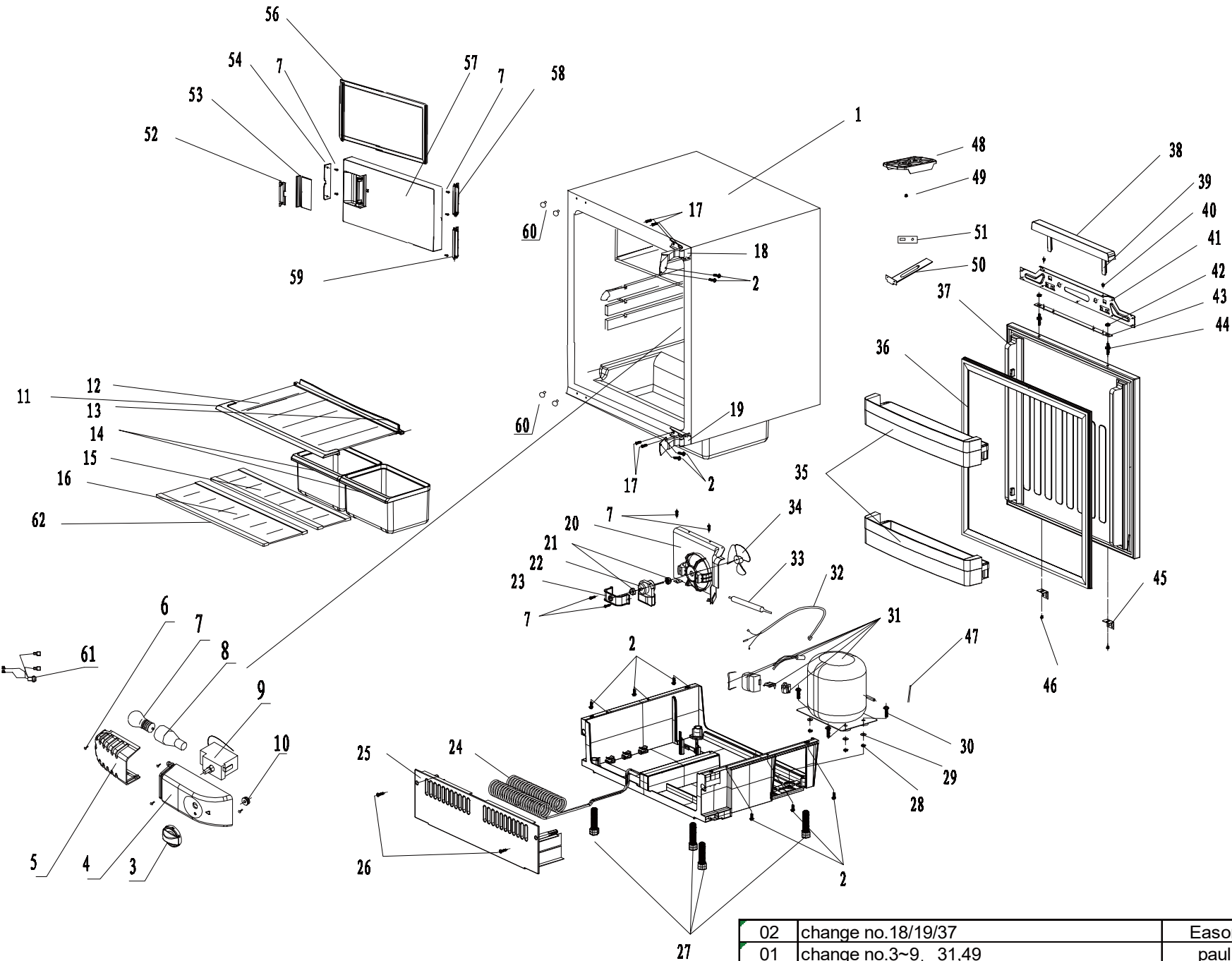

02	change no.18/19/37	Eason	2016.08.22
01	change no.3~9, 31,49	paul	2013.04.10
00	New document	paul	2012.09.21
Index	Modify description	Modified by	Date

BU60RFA parts list

No.	Item Code 物料代码	Material Name 物料名称	Quantity 单台	Remark
1	2.00.TQ020046-0	Foamed Cabinet 箱体	1	
2	1.13.T05013-104	Flange Screw法兰面螺栓	4	
3	1.06.TQ0310-113	Thermostat knob 温控旋钮	1	
4	1.06.TQ4611-113	Thermostat box 温控盒	1	
5	1.06.TQ4771-113	Lamp shade 灯罩	1	
6	1.12.B39160-AB7	Self Tapping Screw 自攻螺钉	4	
7	1.30.1X110X-000	Light bulb 灯泡	1	
8	1.30.2X1105-000	Lamp holder 灯座	1	
9	1.32.2324D1-2TQ	Thermostat 温控器	1	
10	1.06.TQ5570-113	Fixing base 固定座	1	
11	1.06.TQ1971-101	Shelf front liner 层架前衬条	1	
12	1.42.13TQ39-101	Shelf Glass 玻璃层架	1	
13	1.06.TQ1970-101	Shelf back liner 层架后衬条	1	
14	1.06.TQ2371-101	Crisper 果菜箱	1	
15	1.42.35TQ39-101	Crisper Cover A 果菜箱盖板A	1	
16	1.42.36TQ39-101	Crisper Cover B 果菜箱盖板B	1	
17	1.12.F50150-AB4	Countersunk screw 沉头螺丝	4	
18	25105240	Top hinge	1	old(In May 2015 to stop using)
	1.11.01101TQ-02	Top hinge 上铰链		new
19	25105245	bottom hinge	1	old(In May 2015 to stop using)
	1.11.03101TQ-02	Bottom hinge 下铰链		new
20	1.06.TQ9J70-101	Fan cover 风机罩	1	
21	1.38.04PF027-01	Fan motor rubber fixing pad 风机橡胶固定块	2	
22	1.33.DTQ431-100	Fan motor 风扇电机	1	
23	1.11.61TQ027-01	Wind rack 风机固定支架	1	
24	2.20.A0TQ00-101	Condenser 冷凝器部件	1	
25	1.06.TQ9K71-101	Plenth 前护罩	1	
26	1.12.B48250-AB4	Self Tapping Screw 自攻螺钉	2	
27	1.06.TQ2121-101	Adjustable feet可调底脚	4	
28	1.14.Z06000-006	Nut 螺母	0	
29	1.14.A06000-00F	Washer 垫片	4	
30	1.13.G60280-104	Flange Screw法兰面螺栓	4	
31	1.10.11095E-0XX	Compressor 压缩机组件	1	
32	1.28.DD2024-101	Power Cord 电源电缆	1	
32	1.28.DD2024-101	Power Cord 电源电缆	1	
33	1.46.0400TQ-014	Dry filter 干燥过滤器	1	
34	1.06.TQ7511-027	Wind leaf 风叶	1	
35	1.06.TQ0674-101	Door balcony 搁架	2	
36	1.39.201102-101	Door seal 门封条组件	1	
37	25105280	Foamed Door	1	old(In May 2015 to stop using)
	2.01.R0TQ02-101	Foamed Door 门体	1	new(For with the new hinge)
38	1.06.TQ9L70-101	Decorates Cover A 饰罩A	1	
39	1.06.TQ9L71-101	Decorates Cover B 饰罩B	2	
40	1.12.A05080-BF5	Flange Screw法兰面螺栓	2	
41	2.24.0915802-03	Junction panel 连接横板	1	
42	1.14.E06000-00F	Nut 螺母	2	
43	2.24.0915802-02	Adjustment board 调节横板	1	
44	1.13.Z60035-105	Adjuster bolt 调节螺栓	2	
45	1.11.75101TQ-01	Fixed block 下固定块	2	
46	1.13.G60080-104	Flange Screw法兰面螺栓	2	
47	2.20.B2TQ00-000	Charging pipe 注液管	1	
48	1.06.TQ0472-041	Egg tray 蛋格	1	
49	1.12.F39120-BT4	Self Tapping Screw 自攻螺钉	18	
50	1.11.82105TQ-05	Connecting pin 连接销	1	
51	1.11.76101TQ-01	Connecting bracket 连接件	1	
52	1.06.TQ9172-158	Small door catch星级室门弹片	1	
53	1.06.TQ8470-158	handle 拉手	1	
54	1.06.TQ0572-158	Door catch 门止挡	1	
55	1.12.B39160-AB7	Self Tapping Screw 自攻螺钉	5	
56	1.39.201302-135	Icebox door seal 星级室门封	1	
57	2.01.X0TQ02-135	Icebox door星级室门体	1	
58	1.06.TQ9H70-158	Hinge axis A 铰链轴A	1	
59	1.06.TQ9H71-158	Hinge axis B 铰链轴B	1	
60	1.06.TQ2620-142	Screw hole plug 螺钉孔塞	8	
61	1.36.DTQ201-110	Thermostat wire 温控导线	1	
62	1.06.TQ1973-101	Crisper cover liner 果菜箱盖板衬条	4	

BU60RFA Wiring diagram

