

Double Oven:DI0V108CL

Version:01

Date:2016-12-13

Product reference code:29398348

DIOV108CL Exploded drawing

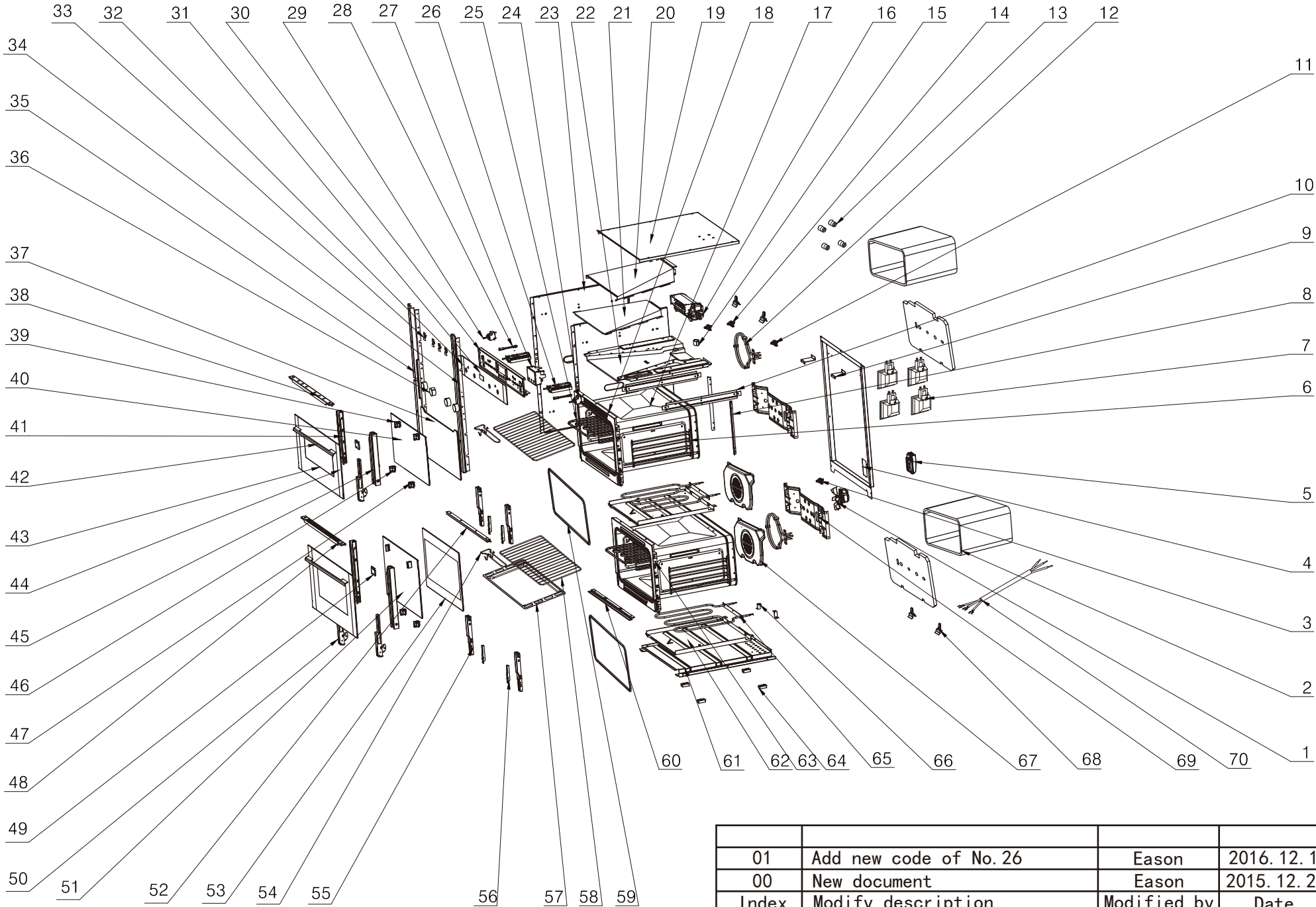

DIOV108CL parts list

No.	part code	Part description	Qty	Remark	chinese description
1	33315002	grill fan assembly	2		循环风机组件-(划一型号): HY6020V240H
2	33120002	heat preservation fibre	1		内胆圈保温纤维-1(16KG)
3	33308001	overheat protector(85℃)	1	From June 2015 to start using	过热保护器-85℃
	33311013	overheat protector (290℃)		From June 2015 to stop using	
4	33030019	back cover board	1		外壳后盖板-AD-K25(A)-04
5	33305016	terminal box	1		接线盒-AD-K25(A)-22
6	33140001	side rack panel	4		导轨支架
7	33317001	lamp	4		方灯组件
8	33027012	connect board for top and bottom cavity	2		上下内胆连接板-AD-K25(A)-11
9	33027014	fixing panel for exhausting pipe base board	2		排烟道底板固定板-AD-K25(A)-13
10	33318024	right telescopic rack	1		三节抽拉式导轨组件-右
	33318023	left telescopic rack	1		三节抽拉式导轨组件-左
11	36154001	Thermostat(110℃)	1	From June 2015 to start using	温控器 SF1-068
	33311013	overheat protector (290℃)		From June 2015 to stop using	
12	33303027	back element	2	From November 2015 to start using	背部电热管
	33303004	back electric heat pipe		From November 2015 to stop using	
13	33141002	guide rail bracket fixing axis	4		导轨支架固定轴-900*480烤箱
14	33310003	heat dissipation thermostat	2		散热温控器
15	33215012	exhausting pipe	1		排烟筒-AD-K25(A)-16
16	33313030	cooling fan assembly	1		散热风机组件(双排气)-AD-K25(A)-50
17	33058072	top cavity assembly	2		内胆圈组件(K2)-配双方灯
18	33018177	cavity panel	1		内胆面板(上)-AD-K25(A)-30-01
19	33031014	top cover plate	1		外壳上盖板-AD-K25(A)-01
20	33028004	exhausting pipe top cover board	1		排烟道上盖板-自洁烤箱专用
21	33026004	exhausting pipe middle cover board	1		排烟道中盖板-自洁烤箱专用
22	33027002	exhausting pipe base board	1		排烟道底板-自洁烤箱专用
23	33033015	side plate (left&right)	2		外壳左右侧板-AD-K25(A)-02
24	33311018	temperature adjuster	1		温控开关-K25(A)-21
25	33303006	top element	2		顶层电热管
26	33301037	function switch(old)	2	please note Wiring diagram	档位开关
	33301002	function switch(new)		please note Wiring diagram	
27	33300063	sensor touch timer (3 button)	1		三键触摸定时器(白色LED数显)
28	33312001	indicator light	2		指示灯
29	33311001	temperature adjuster	1		温控开关
30	33018115	fixing panel for switch	1		开关面板固定板-AD-K25(A)-17
31	33101365	control panel assembly	1		开关面板(8功能-8功能)镀膜-AD-K25(A)-18A
32	33007165	decorate board switch	2	Please buy combination	开关面板装饰板-英国CATA
33	33006001	connect board switch	4		开关面板连接板
34	33014102	left bracket for out cover plate	1		外壳左支架-AD-K25(A)-07
35	33014101	right bracket for out cover plate	1		外壳右支架-AD-K25 (A)-08
36	32244049	knob.42	4		42号旋钮-圆形带螺纹
37	33103043	inner glass(top door)	1		内玻璃-AD-K25 (A)-10-02
38	33014105	door frame top bracket	1		门上支架(前面开孔)-AD-K25(A)-10-01
39	33014142	fixing block for inner glass	2		内玻璃固定块-AD-K26(SFH)-60-05
40	33104052	middle glass	1		中间玻璃(上层)AD-K25(A)-10-07 (镀膜)
42	33190043	handle #25	2		25号拉手
41	33014104	door frame right bracket	2		门框右支架-PN-K25(A)-10-04
43	33102207	door panel	2		门面板-418-老门配418的拉手-镀膜
44	33015004	decorate board for door panel	2	Please buy combination	门面板装饰板84E、85E、87E
45	33014103	door frame left bracket	2		门框左支架-PN-K25(A)-10-03
49	33006012	fixing board for handle	2		拉手固定板-PN-K13-20-07
46	33014049	left bottom fixing block for inner glass	2		内玻璃左下固定块-PN-K15(A)-20-08
47	33014050	right top fixing block for inner glass	2		内玻璃右下固定块-PN-K15(A)-20-09
48	33014110	top bracket for oven door	1		门上支架-PN-K15(A)-20-01
50	33180009	hinge 3 assembly	4		铰链组件(三号铰链)
51	33104023	middle glass	1		中间玻璃-PN-K15(A)-20-05镀膜
52	33027011	cavity panel connector	1		内胆面板连接板(前)-AD-K25(A)-09
53	33103044	inner glass	1		内玻璃-下-AD-K25 (A)-20-01B
54	33172001	hanld 25	1		搁架抓手
55	33024006	handle for rack	4		内胆左右支架-AD-K25(A)-05
56	33005014	fixing board for hinge	4		铰链固定板-AD-K25(A)-06
57	33224005	Tray-shallow	1		油脂收集盘(K1-08)-新工艺
58	33170001	grill rack	2		搁架
59	33803002	door seal assembly	2		门封条组件(K1(A)-02)
60	33027018	bottom support for cavity panel	1		内胆面板下支撑-PN-K25-24
61	33029015	bottom cover plate	1		外壳底板-AD-K25(A)-03
62	33003002	fixing board for bottom heating element	2		底层电热管固定板(K1)
63	33018176	bottom cover plate	1		内胆面板(下)-AD-K25(A)-40-01
64	33237030	the support for bottom cover plate	4		底板支撑块-PN-K24-08
65	33303002	bottom heating element	2		底层电热管
66	33237031	bottom cover plate	2		外壳底板加强板-AD-K25(A)-36
67	33001003	the cover plate for back heating element	2		背部电热管挡板-无旋转电机
68	33035001	thermostat switch sensor fixer	4		温控开关探头固定夹
69	33016001	back bracket for cavity	2		内胆后支架
70	32307016	Power-cord	1		无头电源线

for function switch(old)33301037

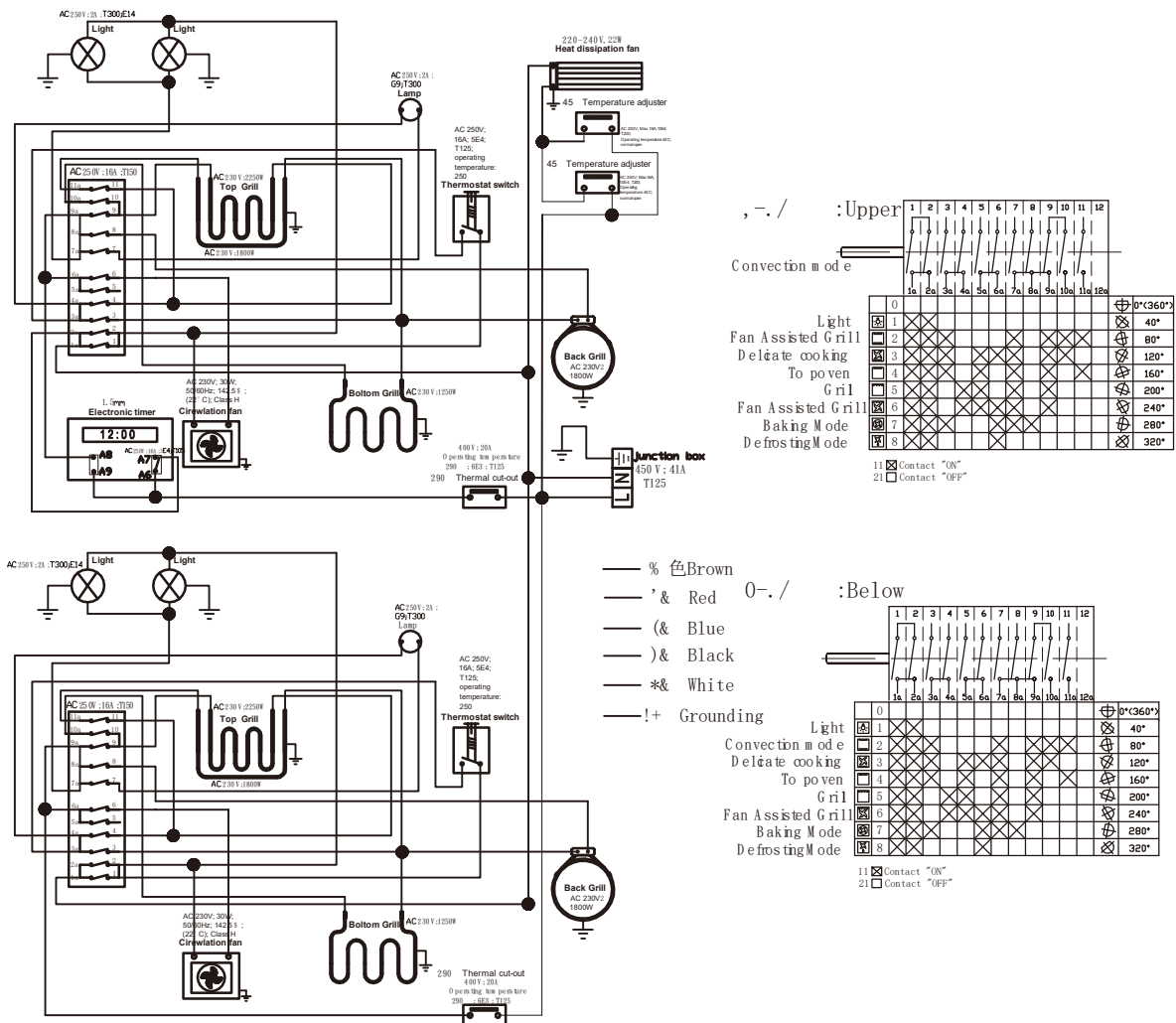

for function switch(new)33301002

