



Double Oven:AMF90BK2

Version:01

Date:2016-03-03

Product reference code:AMF90BK2

AMF90BK2 Exploded drawing

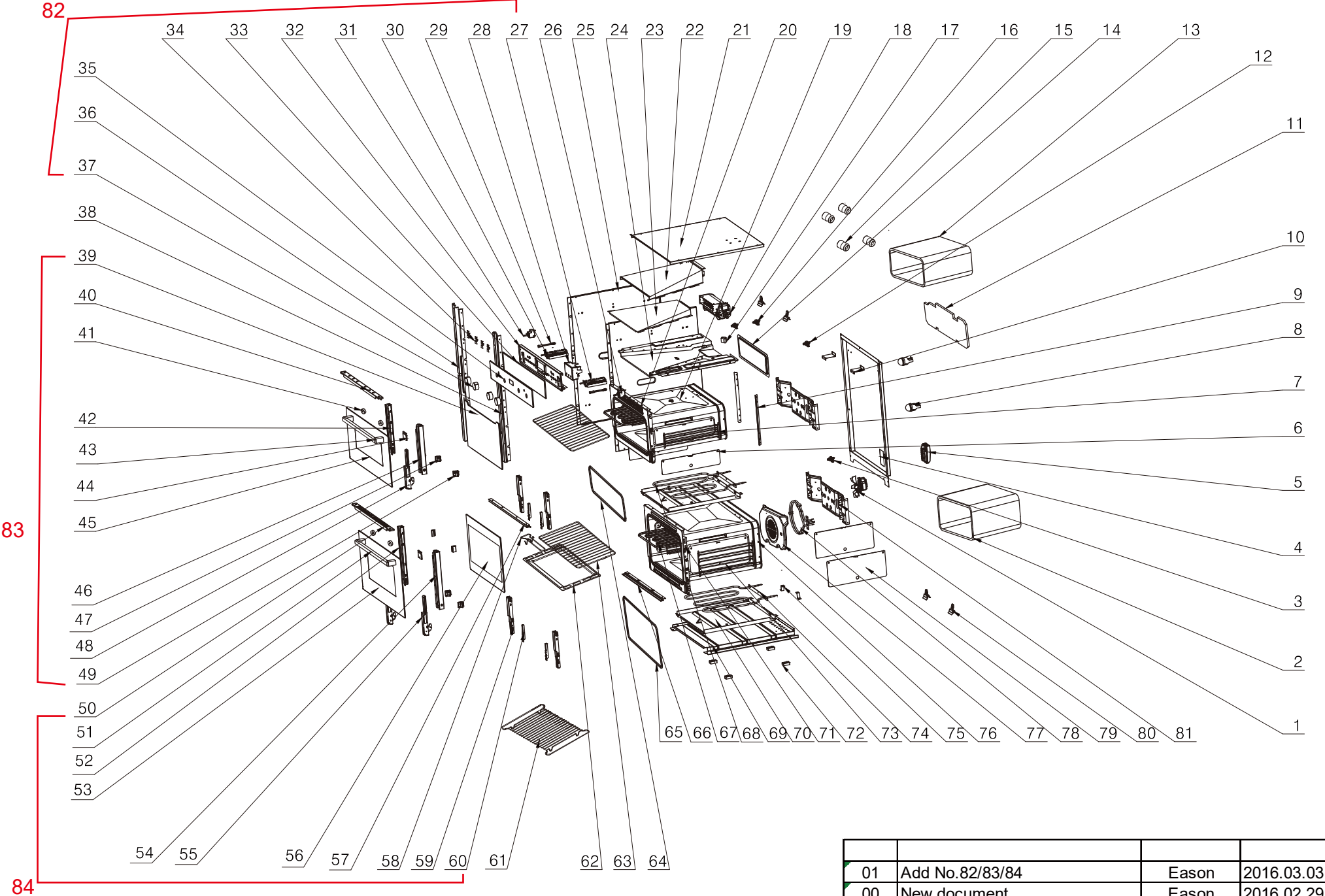

| | | | |
|-------|--------------------|-------------|------------|
| | | | |
| 01 | Add No.82/83/84 | Eason | 2016.03.03 |
| 00 | New document | Eason | 2016.02.29 |
| Index | Modify description | Modified by | Date |

AMF90BK2 parts list

| No. | part code | Part description | Qty | Remark | chinese description |
|-----|------------|---|-----|------------------------|------------------------------|
| 1 | 33315002 | grill fan assembly | 1 | | 循环风机组件-(划一型号): HY6020V240H |
| 2 | 33120002 | heat preservation fibre | 1 | | 内胆圈保温纤维-1(16KG) |
| 3 | 36154001 | Thermostat | 1 | | 温控器 SF1-068 |
| 4 | 33030020 | back cover board | 1 | | 外壳后盖板-AD-K25(B)-02 |
| 5 | 33305016 | terminal box | 1 | | 接线盒-AD-K25(A)-22 |
| 6 | 33039015 | side rack panel | 2 | | 导轨支架垫板-AD-K25(B)-06 |
| 7 | 33140011 | side rack | 2 | | 左右导轨支架-AD-K25(B)-12 |
| 8 | 33302002 | lamp | 2 | | 灯头组件 |
| 9 | 33027012 | connect board for top and bottom cavity | 2 | | 上下内胆连接板-AD-K25(A)-11 |
| 10 | 33027014 | fixing panel for exhausting pipe base board | 2 | | 排烟道底板固定板-AD-K25(A)-13 |
| 11 | 33121002 | heat preservation fibre | 1 | | 内胆底盖保温纤维 |
| 12 | 33308027 | over heat protector100℃ | 1 | | 过热保护器-100℃ |
| 13 | 33120002 | heat preservation fibre | 1 | | 内胆圈保温纤维-1(16KG) |
| 14 | 33001037 | back catalytic line | 1 | | 背部易洁板-AD-K25(B)-07 |
| 15 | 33141002 | guide rail bracket fixing axis | 4 | | 导轨支架固定轴-900*480烤箱 |
| 16 | 33310003 | heat dissipation thermostat | 2 | | 散热温控器 |
| 17 | 33215013 | exhausting pipe | 1 | | 排烟筒-AD-K25(B)-05 |
| 18 | 33313030 | cooling fan assembly | 1 | | 散热风机组件(双排气)-AD-K25(A)-50 |
| 19 | 33058060 | top cavity assembly | 1 | | 内胆组件(上)-AD-K25(B)-20-00 |
| 20 | 33018113 | cavity panel | 1 | | 内胆面板(上)-AD-K25(B)-20-01 |
| 21 | 33031014 | top cover plate | 1 | | 外壳上盖板-AD-K25(A)-01 |
| 22 | 33028004 | exhausting pipe top cover board | 1 | | 排烟道上盖板-自洁烤箱专用 |
| 23 | 33026004 | exhausting pipe middle cover board | 1 | | 排烟道中盖板-自洁烤箱专用 |
| 24 | 33027002 | exhausting pipe base board | 1 | | 排烟道底板-自洁烤箱专用 |
| 25 | 33033016 | side plate (left&right) | 2 | | 外壳左右侧板-AD-K25(B)-01 |
| 26 | 33311007 | temperature adjuster | 1 | | 温控开关-900*480烤箱专用 |
| 27 | 33301034 | function sw itch | 1 | | 档位开关 |
| 28 | 33300011 | sensor touch timer (3 button) | 1 | | 三键触摸定时器-红色(触摸) |
| 29 | 33312001 | indicator light | 2 | | 指示灯 |
| 30 | 33301035 | function sw itch | 1 | | 档位开关 |
| 31 | 33311018 | temperature adjuster | 1 | | 温控开关-K25(A)-21 |
| 32 | 33018115 | fixing panel for sw itch | 1 | | 开关面板固定板-AD-K25(A)-17 |
| 33 | 91034002 | single adhesive tape | 1 | | 单面胶 |
| 34 | 33006001 | connect board sw itch | 4 | Please buy combination | 开关面板连接板 |
| 35 | 33101463 | control panel assembly | 1 | | 开关面板(4功能-5功能)-三键触摸-AD-K25(B) |
| 36 | 33014088 | left bracket for out cover plate | 1 | | 外壳左支架-AD-K25(B)-03 |
| 37 | 32244031 | knob.21 | 4 | | 21号旋钮 |
| 38 | 33014089 | left bracket for out cover plate | 1 | | 外壳右支架-AD-K25(B)-04 |
| 39 | 33103023 | inner glass(top door) | 1 | | 内玻璃-上(镀膜)-AD-K25(B)-10-02 |
| 40 | 33014087 | door frame top bracket | 1 | | 门上支架(前面开孔)-AD-K25(A)-10-01 |
| 41 | 33214005 | handle fixing assem | 4 | | 拉手固定套-PN-K14-60-09 |
| 43 | 33190007 | hanld H1 | 1 | Please buy combination | 1号拉手 |
| 42 | 33014080 | door frame left bracket | 1 | | 门框左支架-AD-K25(B)-10-04 |
| 44 | 33006012 | fixing board for handle | 2 | | 拉手固定板-PN-K13-20-07(黑色亮光喷漆后) |
| 45 | 33102370 | door panel | 1 | | 门面板-AD-K25(B)-10-01 |
| 46 | 33014079 | door frame right bracket | 1 | | 门框右支架-AD-K25(B)-10-05 |
| 47 | 33014049 | fixing panel for inner glass | 2 | | 内玻璃左下固定块-PN-K15(A)-20-08 |
| 48 | 33180018 | hinge 12 | 2 | | 铰链组件-12号铰链 |
| 49 | 33014050 | fixing panel for inner glass | 2 | | 内玻璃右下固定块-PN-K15(A)-20-09 |
| 50 | 33014043 | top bracket for oven door | 1 | | 门上支架-PN-K15(A)-20-01 |
| 51 | 33190007 | hanld H1 | 1 | | 1号拉手 |
| 52 | 33014082 | door frame left bracket | 1 | Please buy combination | 门框左支架-PN-K25(A)-10-03 |
| 53 | 33102066 | door panel | 1 | | 门面板-418-老门配418的拉手 |
| 54 | 33014081 | door frame right bracket | 1 | | 门框右支架-PN-K25(A)-10-04 |
| 55 | 33180016 | hinge 16 assembly | 2 | | 铰链组件-16号铰链 |
| 56 | 33103031 | inner glass | 1 | | 内玻璃-下(镀膜)-AD-K25(A)-20-01 |
| 57 | 33027015 | cavity panel connector | 1 | | 内胆面板连接板(前)-AD-K25(A)-09 |
| 58 | 33172001 | handle for rack | 1 | | 搁架抓手 |
| 59 | 33024006 | side bracket for cavity(left&right) | 4 | | 内胆左右支架-AD-K25(A)-05 |
| 60 | 33005014 | Hinge Retainer | 4 | | 铰链固定板-AD-K25(A)-06 |
| 61 | 33170003 | Tray-shallow | 1 | | 烤盘架(浅) |
| 62 | 33224003 | baking tray | 2 | | 油脂收集盘(K1-08)-新工艺 |
| 63 | 33170001 | grill rack | 2 | | 搁架 |
| 64 | 33803013 | door seal assembly | 1 | | 门封条组件K25(B) |
| 65 | 33803002 | door seal assembly | 1 | | 门封条组件-K1(A) |
| 66 | 33027016 | bottom support for cavity panel | 1 | | 内胆面板下支撑-AD-K25(A)-12 |
| 67 | 33303006 | top heating element | 2 | | 顶层电热管 |
| 68 | 33303039 | bottom heating element | 1 | | 底层电热管-PN-K14-08 |
| 69 | 33029015 | bottom cover plate | 1 | | 外壳底板-AD-K25(A)-03 |
| 70 | 33003002 | fixing board for bottom heating element | 2 | | 底层电热管固定板(K1) |
| 71 | 33018111 | cavity panel | 1 | | 内胆面板(下)-AD-K25(A)-40-01 |
| 72 | 33237030 | the support for bottom cover plate | 4 | | 底板支撑块-PN-K24-08 |
| 73 | 33140001 | side rack | 2 | | 导轨支架 |
| 74 | 33303002 | bottom heating element | 1 | | 底层电热管 |
| 75 | 33237031 | bottom cover plate | 2 | | 外壳底板加强板-AD-K25(A)-36 |
| 76 | 33058002 | cavity ring assem | 1 | | 内胆圈组件(K2) |
| 77 | 33001002 | the cover plate for back heating element | 1 | | 背部电热管挡板 |
| 78 | 33303027 | rear heeting element | 1 | | 背部电热管 |
| 79 | 33039001 | side rack panel | 2 | | 导轨支架垫板 |
| 80 | 33035001 | thermostat sw itch sensor fixer | 4 | | 温控开关探头固定夹 |
| 81 | 33016001 | back bracket for cavity | 2 | | 内胆后支架 |
| 82 | 33240534 | Control Panel Assembly | 1 | | 控制面板组件 |
| 83 | 3313101042 | Upper Door Assembly | 1 | | 上门组件 |
| 84 | 3313101044 | Lower Door Assembly | 1 | | 下门组件 |