

myappliances

User Manual

60cm Visor Hood

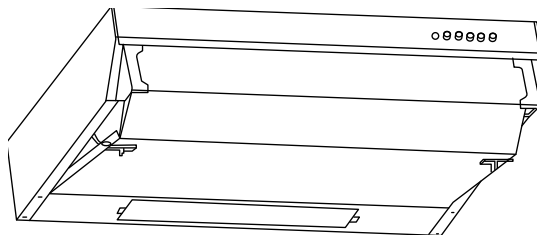



[01] x 1

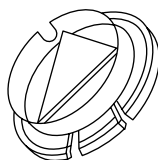

[02] x 1



[03] x 1

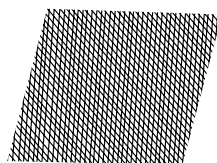

[04]
x 1



[05] x 1



[6] x 2
(3x 12mm)

Let's get started...



Getting started...

05

Before you start
Safety

06
08



In more detail...

10

Product functions
Operation
Care and maintenance
Troubleshooting
Recycling and disposal
Technical and legal information
Guarantee

11
11
12
14
15
15
18



Appendix

Installation

21



Getting Started...

Before you start

06

Safety

08

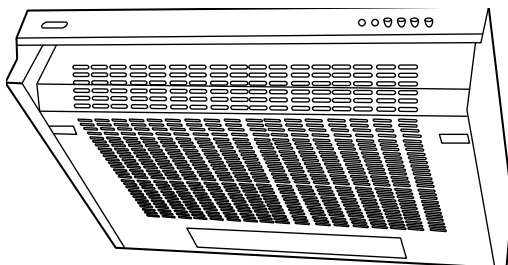

Before you start

- ☒ To avoid the risks that are always present when you use an electrical appliance it is important that this cooker hood is installed correctly and that you read the safety instructions carefully to avoid misuse and hazards. Please keep this instruction booklet for future reference and pass it on to any future owners. After unpacking the cooker hood please check that it is not damaged. If in doubt, do not use the appliance but contact Customer Services on 0344 800 1128 (UK), 1 800 535542 (Ireland).
- ☒ Check the package and make sure you have all of the parts listed.
- ☒ Decide on the appropriate location for your product.
- ☒ This product contains glass. Care must be taken when fitting or handling to prevent personal injury or damage to the product.
- ☒ The specifications plate is available on this appliance. This plate displays all the necessary identification information for ordering replacement parts.
- ☒ If you sell the appliance, give it away, or leave it behind when you move house, make sure you also pass on this manual so that the new owner can become familiar with the appliance and its safety warnings.

Tools required

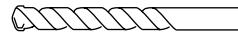
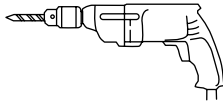

Ø6mm

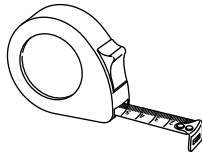

Accessories not supplied

Recirculation

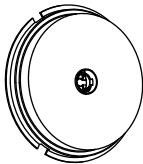

CARBFILT1 (UK & IE)
OR CARBFILT1CL (FR)



SELF ADHESIVE
ALUMINIUM TAPE

Extraction

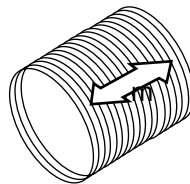

Ø120m
VENT PACK 2 (UK & IE)



x4

3.9 x 32 mm



x4

Short Screw for cabinet

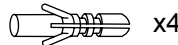

x4

Wall Plug Ø6mm

CARBON FILTER ORDERING HOTLINE

0344 800 1128 (UK) 1 800 535542 (IE)

These instructions are for your safety. Please read through them thoroughly prior to installation and retain them for future reference.



- All installation work must be carried out by a competent person or qualified electrician.
- This appliance must be installed correctly by a suitably qualified person, strictly following the manufacturer's instructions.

- ☒ This appliance complies with all current European safety legislation, however, the Manufacturer must emphasise that this compliance does not prevent the surfaces of the appliance from heating up during use and remaining hot during its operation.
- ☒ Accessible parts may become hot during use. Young children should be kept away. Care should be taken to avoid touching the appliance (e.g hob, cooker).
- ☒ Therefore, the Manufacturer highly recommends that this appliance be kept out of the reach of babies and small children.
- ☒ Children should be supervised to ensure that they do not play with the appliance.
- ☒ This appliance is not intended for use by persons (including children) with reduced physical sensory, or mental capabilities, or by those who lack experience and knowledge, unless they have been given supervision and instruction concerning the use of the appliance by a person responsible for their safety.
- ☒ Means for disconnection must be incorporated in the fixed wiring in accordance with the wiring rules. An all-pole disconnection switch having a contact separation of at least 3 mm in all poles should be connected in fixed wiring.
- ☒ Do not allow the electric cables to touch the hot parts of the appliance.
- ☒ Make sure that the power cord is not caught under or in the appliance and avoid damage to the power cable.
- ☒ Do not remove the plug in the presence of flammable gas.
- ☒ Do not install the appliance outdoors in a damp place or in an area which may be prone to water leaks such as under or near a sink unit. In the event of a water leak allow the machine to dry naturally.
- ☒ Please dispose of the packing material carefully.
- ☒ Do not use flammable sprays in close vicinity to the appliance.

- ☒ We also recommend that great care be taken during use and cleaning. Read the cleaning and maintenance sections for this appliance carefully.
- ☒ A steam cleaner is not to be used.
- ☒ The appliance is not intended to be operated by means of external timer or separated remote-control system.
- ☒ The appliance is for domestic use only.
- ☒ Warning: consult local regulations regarding fumes outlets.
Do not connect the hood to a fume, ventilation or hot air duct.
Confirm that room ventilation is appropriate with the local authorities.
Make sure the maximum air extraction flow rate for the appliances in the room does not exceed 4 Pa (0.04 mbar).
The room must have adequate ventilation if an extractor hood is used simultaneously with appliances that run on gas or other fuels.
The air must not be discharged into a flue that is used for exhausting fumes from appliances burning gas or other fuels.
Regulations regarding air extraction must be complied with.
- ☒ Warning: before connecting the hood: switch off the electricity supply and check that the supplied voltage and frequency coincide with that indicated on the appliance nameplate.
- ☒ Warning: the hood may stop working during an electrostatic discharge (e.g. lightning). This involves no risk of damage. Switch off the electricity supply to the hood and reconnect after one minute.
- ☒ To avoid the risk of fire, clean the metal filter regularly and closely watch and regulate pans containing hot oil.
- ☒ Do not use the hood if it shows signs of damage or imperfection. Contact customer services.
- ☒ Flambe cooking must not be carried out underneath this appliance.
- ☒ When installing the appliance, make sure that the following distances between the top of cooker or hob and the lowest part of the cooker hood must be observed:
 - > Gas hoods: 750mm
 - > Electric hoods: 650mm
- ☒ The Manufacturer declines all liability for personal or material damage as a result of misuse or incorrect installation of this appliance.

WARNING: There is a fire risk if cleaning is not carried out in accordance with the instructions

In more detail...



Product functions	11
Operation	11
Care and maintenance	12
Troubleshooting	14
Recycling and disposal	15
Technical and legal information	15
Guarantee	18

Product functions

This appliance extracts the air of the kitchen to remove the odours and keep an optimum level of the air quality inside the room, it also allows you to illuminate the cooking area.

Operation

Operation

- Switch on the appliance at the switched fused connection unit. The appliance is ready for operation functions.

Five-button panel

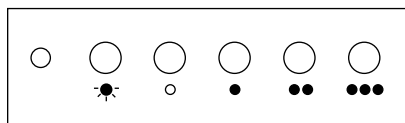

- Extractor fan operating indicator pilot light.
- Lighting on and off.
- Extractor fan off.
- Extractor fan speed - button: speed 1
- Extractor fan speed - button: speed 2
- Extractor fan speed - button: speed 3

To obtain the best results from your cooker hood it is recommended that you leave it switched on for 15 minutes after you have finished cooking.

Care and maintenance

Warning: always switch off the electricity supply before carrying out maintenance work on the hood. In the event of a fault, contact customer services.

Bulb replacement

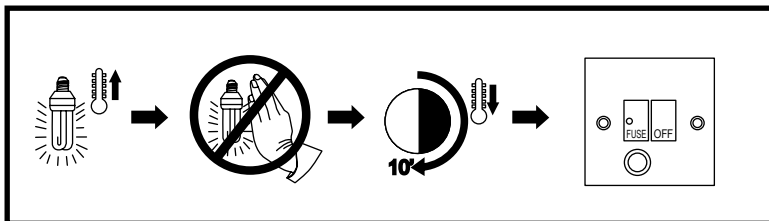

The Bulb may be hot, leave it 10 minutes before removing..

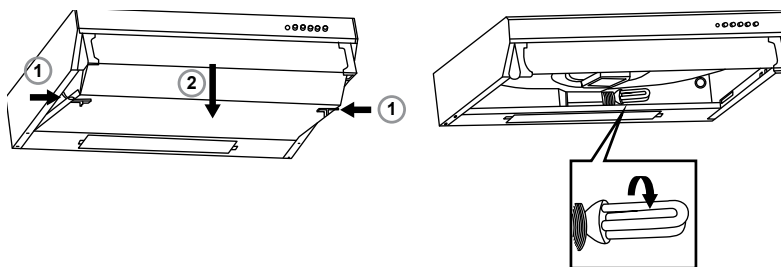

Push the clips (1) inwards and release the metal filter & cover (2).
Unscrew bulb, remove and screw in new bulb.

Active charcoal filter replacement :

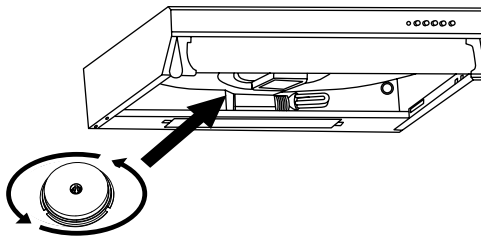

1 x active charcoal filter (not supplied).
Model number_CARBFILT1 (UK & EI)

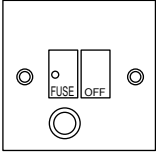
**Warning**

Always switch off the electricity supply before performing maintenance work. In the event of a fault, contact customer services.

Metal filter maintenance:

Use non-corrosive, liquid detergent and avoid the use of abrasive cleaning products.

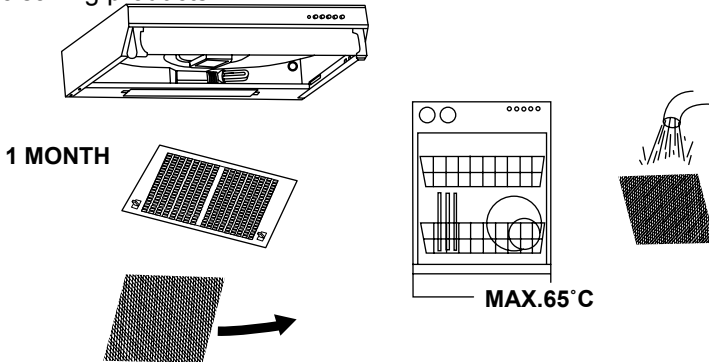

Aluminium filters: to avoid fires, clean thoroughly once a month or whenever the display pilot light (if fitted) indicates as such. To do so, remove the filters, soak in hot water and mild detergent for an hour. If using a dishwasher, position the filters vertically to improve the cleaning process.

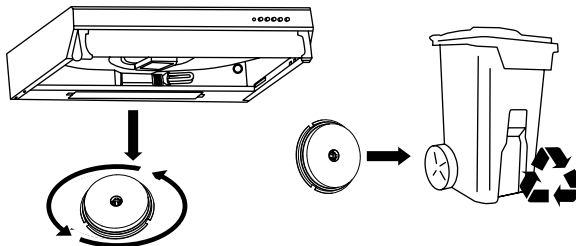
**3 MONTHS**

Active charcoal filters: replace every 3 months.

Important: increase the filter cleaning/replacement frequency if the hood is used for more than 2 hours a day. Always use the recommended filter.

Troubleshooting

Fault	Cause	Solution
Excessive Vibration	The Appliance is not hung properly on the brackets.	Take down the appliance and check it is properly fixed.
	The fan blade is damaged.	Switch off the appliance.
	The fan motor is not fixed tightly.	Repair to be carried out by qualified service personnel only.
Light on, but motor does not work.	The fan blade is jammed.	
	The motor is damaged.	
Both light and motor do not work.	Light bulb blown.	Replace with a bulb with correct rating.
	Power connection loose.	Check power supply.
Suction performance reduced.	Speed may be too low.	Select a higher speed.
	Distance between the cooker hood and the hob is too great.	Readjust the distance to: Gas cookers: 750mm Electric cookers: 650mm
	Aluminium grease filter is dirty.	Clean filters. (see care and maintenance)
	Top vent might be obstructed. (CLVH60SS-C & CLVH60W-C)	Clear any obstruction.
	Optional vent kit might be twisted.	Ensure that the vent kit is fitted to the manufacturers instructions.
Works normally but cooking smells linger.	Charcoal filter not fitted in recirculation mode or charcoal filter is full of grease.	Fit charcoal filter if recirculating or change the filter. (see care and maintenance)

Recycling and disposal

Environmental protection

Waste electrical products should not be disposed of with household waste. Please recycle where facilities exist. Check with your Local Authority or retailer for recycling advice.



The symbol on the product or its packaging indicates that this product cannot be treated as normal household waste. This product must be handed over to an electric and electronic equipment collection point for recycling.

On ensuring that this product is disposed of correctly, you will help to avoid possible negative consequences for the environment and public health, which could occur if this product is not handled correctly. To receive more detailed information about recycling this product, contact your local government, domestic waste disposal services or the outlet where the product was bought.

Technical and legal information

The Manufacturer declines all liability for damage caused to persons and objects due to incorrect or improper installation of the appliance.

Power supply	:	220-240V~ 50Hz
Power consumption – Fan	:	125 W
Power consumption – Luminary	:	1 x 40W Max
Power consumption – Total	:	165 W
Protection class	:	II
Light bulb	:	Max. 40W

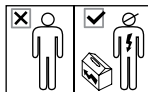

All installation work must be carried out by a competent person or qualified electrician. Before connecting the mains supply ensure that the mains voltage corresponds to the voltage on the rating plate inside the cooker hood.

WARNING : THIS APPLIANCE MUST NOT BE EARTHED.

Mains Supply could be connected to the Mains Voltage by Direct Connection

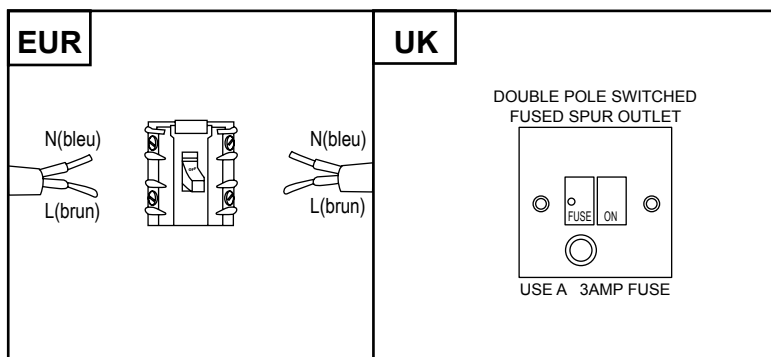

Direct Connection

If the appliance is being connected directly to the mains an omnipolar circuit-breaker must be installed with a minimum opening of 3mm between contacts.

If the supply cord is damaged, it must be replaced by the manufacturer, its service agent or similarly qualified persons in order to avoid a hazard.

The installer must ensure that the correct electrical connection has been made and that it complies with wiring diagram.

The cable must not be bent or compressed.

The cable must be checked regularly and replaced by authorized technicians only.

Electrical Requirements

Any permanent electrical installation must comply with the latest I.E.E. Regulations and local electricity company regulations. For your own safety a qualified electrician or contractor who is on the roll of the National Inspection Council for Electrical Installation Contracting (NICEIC) should undertake the electrical installation.

Electrical Connection.

Before connecting the mains supply ensure that the mains voltage corresponds to the voltage on the rating plate inside the cooker hood.

WARNING: THIS APPLIANCE MUST NOT BE EARTHED.

The cooker hood is supplied with a 2-core mains cable and must be connected to the electricity supply via a double pole switch having a 3mm minimum contact gap on each connector.

For UK only

A Switched Fused Connection Unit to BS 1363 Part 4 is a recommended.

The fuse must be rated at 3 Amps.

The wires in the mains lead are coloured in accordance with the following code:

Brown = L - Live

Blue = N - Neutral

The connection point must be placed in a position adjacent to the appliance so as to be readily accessible for an engineer in the event of a breakdown.

Disconnect the cooker hood from the mains supply before carrying out any kind of maintenance or cleaning.

Customer Service

To arrange an in guarantee service call, please contact customer services on the following numbers.

UK and N.Ireland – myappliances Customer Care Centre
T: 0344 8001128 E: enquiries@myappliances.co.uk
www.myspareparts.co.uk

Republic of Ireland (ROI) – myappliances Customer Care Centre
T: 1-800 535542 E: enquiries@myappliances.co.uk

In more detail...

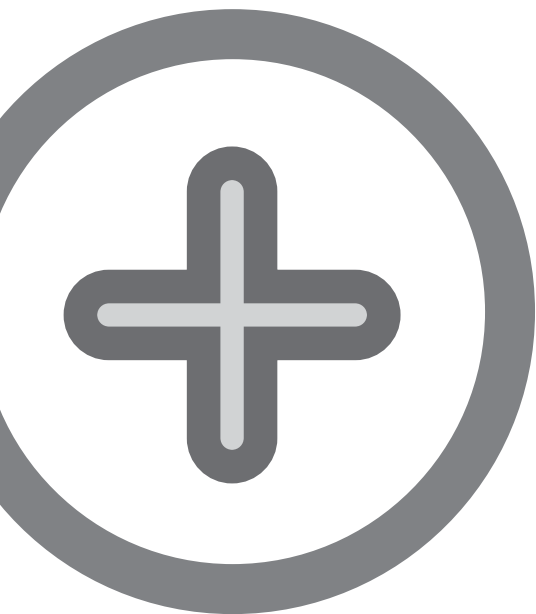

Appendix...

Installation

01

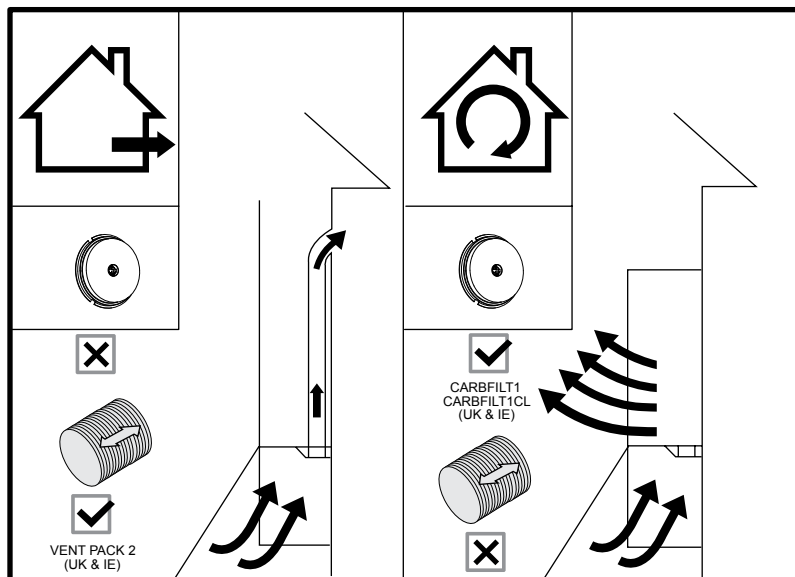

You can choose two types of installation:

- Extraction option
- Recirculation option

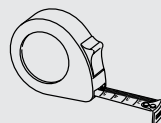
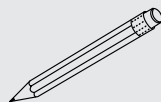
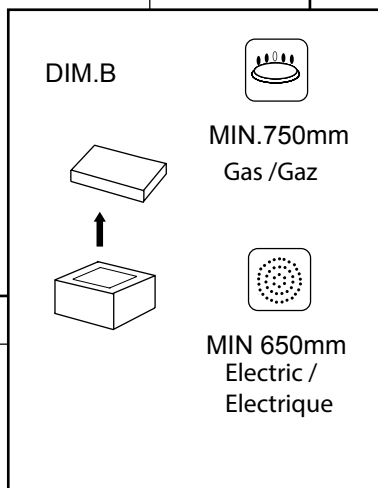
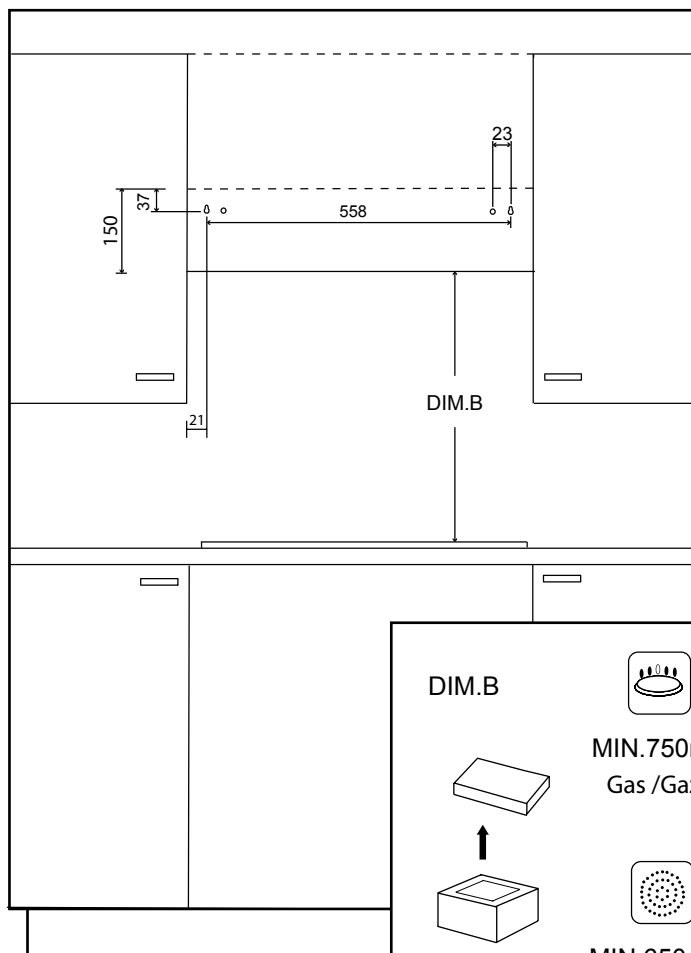

Mark on the kitchen wall the holes to fix the cooker hood.



Ensure wall plugs (not supplied) used are suitable for wall type.

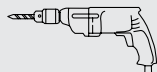

[05] x 1



x2



x4

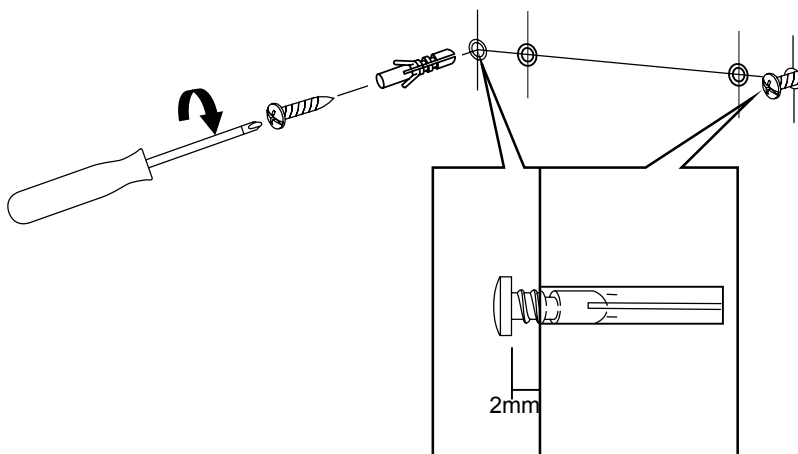

MOUNTING OF THE HOOD TO THE WALL (without cupboard above)

In this situation the hood should only be used for recirculation purposes only

Drill 4 holes corresponding to the diagram on page 23

Insert wall plugs.

Insert correct length screw leaving the head protruding 2mm

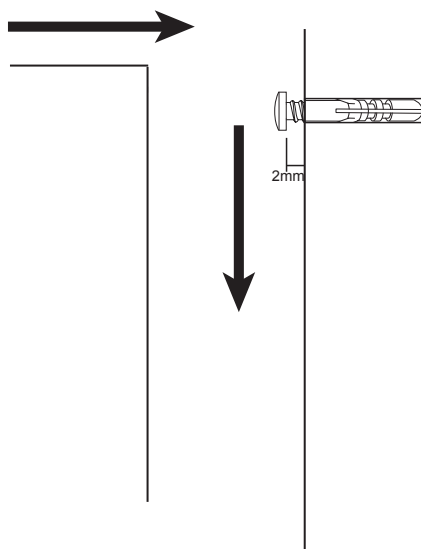

Position hood over 2 wall screws, and use keyhole slots on adjustment bracket to support the weight.

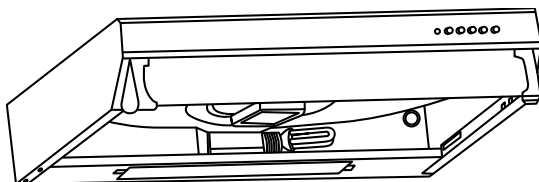
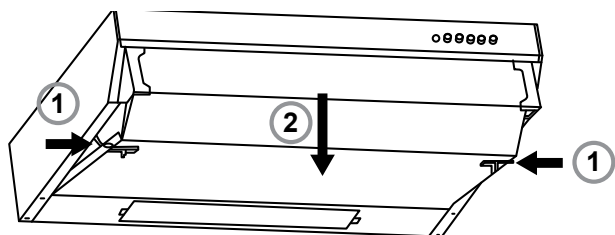

Remove the grill

Push the clips (1) inwards and release the metal filter & cover (2).

06



x2

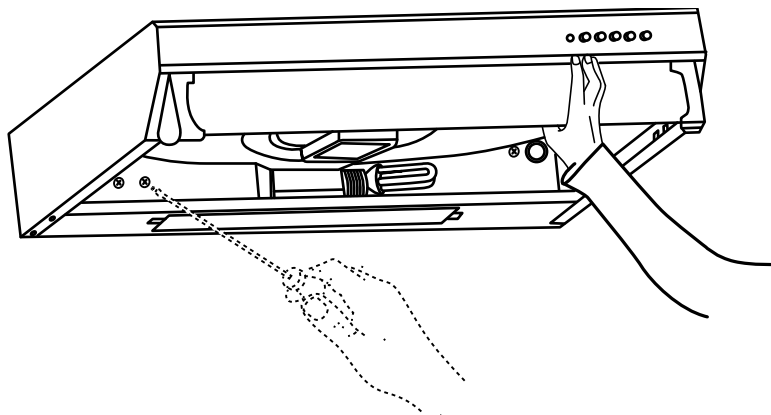

Whilst holding the hood, and tighten inside screws

07

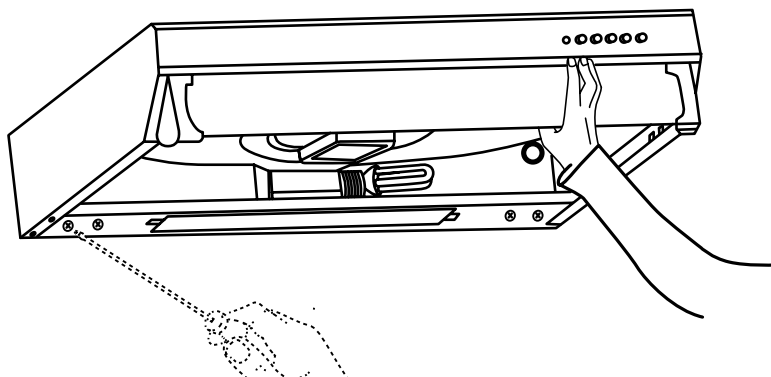

Tighten outer screws

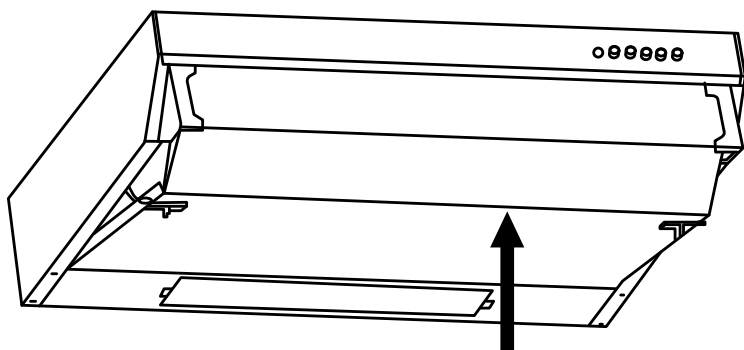

Clip the grill back in place



[02]



x4

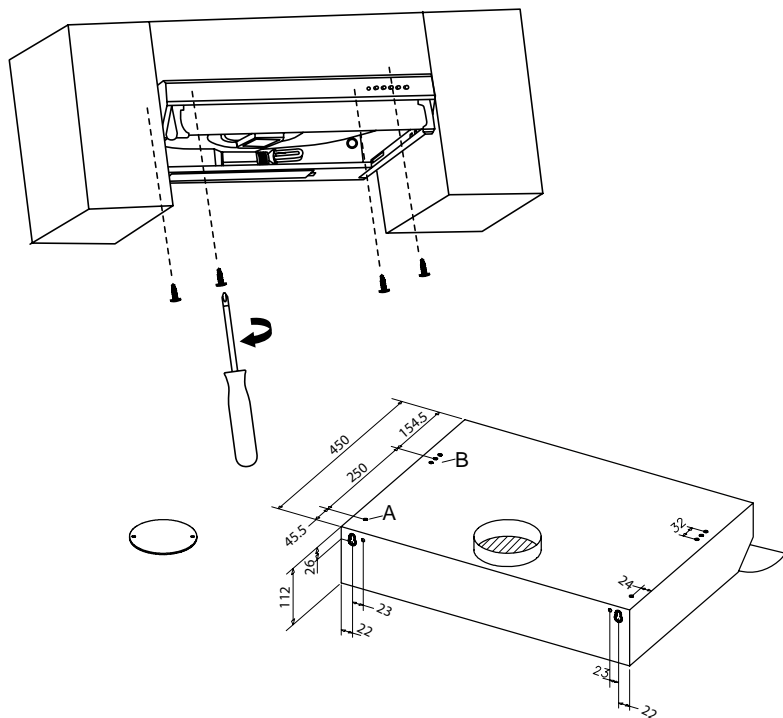

MOUNTING THE HOOD UNDERNEATH A CUPBOARD

Both extraction and recirculation options can be used

EXTRACTION

Cut a hole in the cupboard base to suit the position of the exhaust vent in the visor hood and size to suit the vent kit being used.

Connect collar [02] this is used to connect to vent kit.

Using 4 suitable length screws attach the cooker hood to the underside of the cupboard using the 2 hole position (A) and 2 hole position (B).

Connect vent kit as per manufacturers instructions

Important: The exhaust air must not be expelled through a smoke or waste gas chimney, which is in use, or through a shaft used for ventilating rooms or into the cavity of a wall.

RECIRCULATION

Connect blanking plate (05) and secure it by 2 screws (6)

Using 4 suitable length screws attach the visor hood to the underside of the cupboard using the 2 hole position (A) and 2 hole position (B).

Ensure correct recirculation filters are fitted, please refer to **Care and maintenance** section

Important: If the room contains a fuel burning appliance, such as a gas, or oil fired, central heating boiler, which is not of the 'Balanced Flue' type, you should make sure that there is adequate air inlet into the room at all times so that fumes from the boiler are not drawn back into the room by the Cooker Hood.

For electrical connection see **Technical and legal information** section.



MYAPPLIANCES
Unit 3 Normandy Landings,
3 Pope Street
NORMANTON
West Yorkshire
WF6 2AG
