



single oven:UBMFTZ60SS

Version:01

Date:2015-03-04

Product reference code:UBMFTZ60SS

# UBMFTZ60SS Exploded drawing

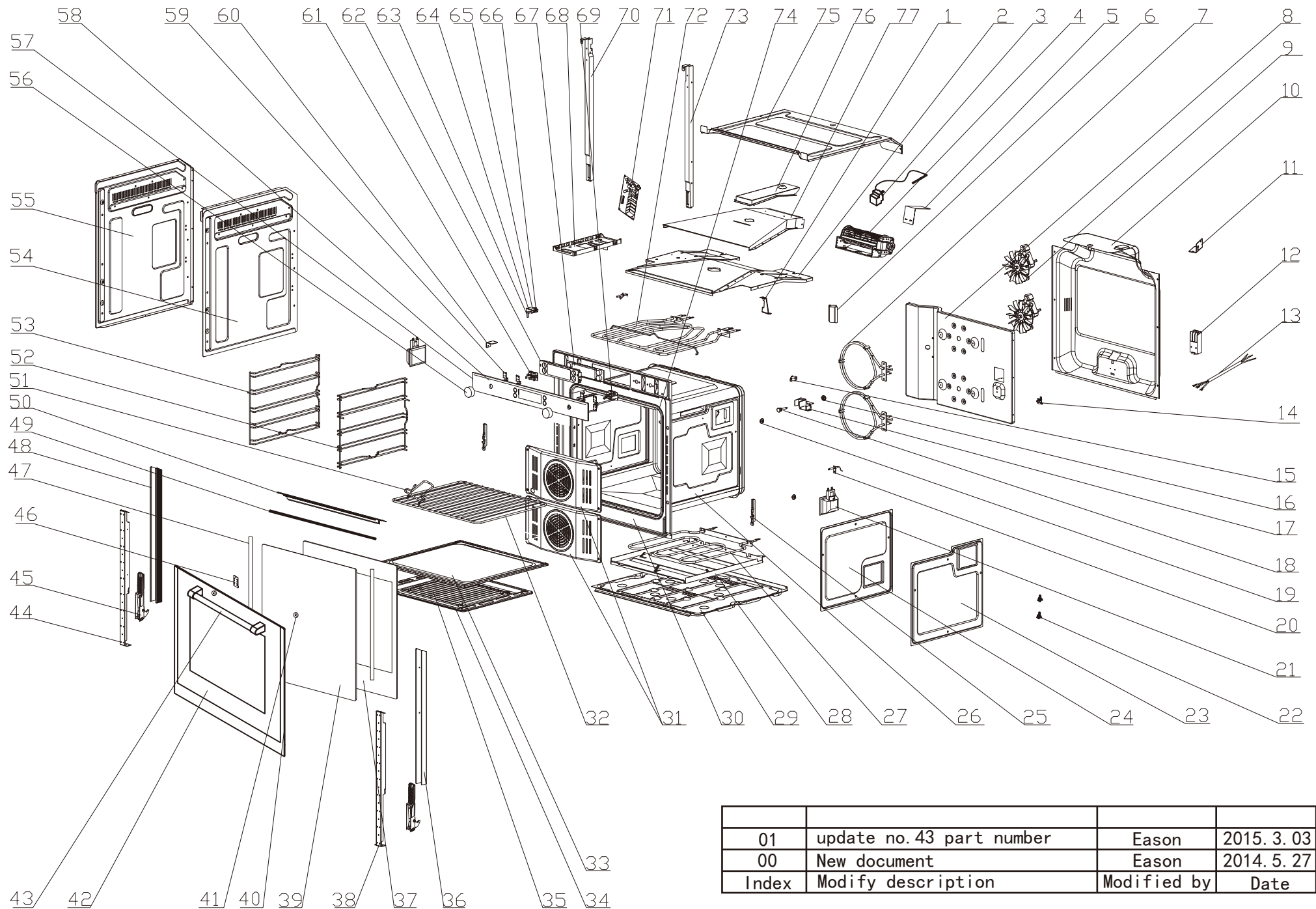

|       |                          |             |             |
|-------|--------------------------|-------------|-------------|
|       |                          |             |             |
| 01    | update no.43 part number | Eason       | 2015. 3. 03 |
| 00    | New document             | Eason       | 2014. 5. 27 |
| Index | Modify description       | Modified by | Date        |

# UBMFTZ60SS parts list

| NO. | Part code | Part description                            | Quantity |
|-----|-----------|---|----------|
| 1   | 33027008  | the block for exhausting pipe base board    | 1        |
| 2   | 33027005  | exhausting pipe base board                  | 1        |
| 3   | 33311013  | temperature protector (290 degree)          | 1        |
| 4   | 33313019  | cooling fan assembly                        | 1        |
| 5   | 91127002  | insulation paper for cooling fan            | 1        |
| 6   | 33215007  | exhausting pipe                             | 1        |
| 7   | 33303040  | rear heating element                        | 2        |
| 8   | 33016002  | back support for cavity                     | 1        |
| 9   | 33315016  | circulating fan assembly                    | 2        |
| 10  | 33030012  | back cover plate                            | 1        |
| 11  | 33004010  | temperature protector holder                | 1        |
| 12  | 33305008  | terminal box                                | 1        |
| 13  | 32307016  | cable without plug                          | 1        |
| 14  | 34152001  | thermostat 140°                             | 2        |
| 15  | 33301022  | microwave switch for divider                | 1        |
| 16  | 33301024  | the nut for S.S pin on divider              | 1        |
| 17  | 33004008  | the fixing bracket for the divider sensor   | 1        |
| 18  | 33301023  | the S.S pin on divider for sensor           | 1        |
| 19  | 33141005  | fixing base for side rack panel             | 4        |
| 20  | 33323001  | temperature sensor assembly                 | 2        |
| 21  | 33317001  | square lamp assembly                        | 2        |
| 22  | 33035001  | thermostat switch sensor fixer              | 2        |
| 23  | 33039005  | removeable side panel (right)               | 1        |
| 24  | 33039004  | removeable side panel (left)                | 1        |
| 25  | 33005004  | fixing panel for hinge                      | 2        |
| 26  | 33058059  | cavity assembly                             | 1        |
| 27  | 33303039  | bottom heating element                      | 1        |
| 28  | 33003002  | the fixing panel for bottom heating element | 1        |
| 29  | 33029009  | bottom plate                                | 1        |
| 30  | 33018093  | Inner bladder panel                         | 1        |
| 31  | 33001022  | the cover plate for rear heating elment     | 1        |
| 32  | 33170001  | grill rack                                  | 2        |
| 33  | 33316003  | Divider                                     | 1        |
| 34  | 33224003  | baking tray                                 | 1        |
| 35  | 33170003  | the grill rack for baking tray              | 1        |
| 36  | 33014014  | left fixing panel for oven door glass       | 1        |
| 37  | 33103013  | inner glass                                 | 1        |
| 38  | 33014010  | the fixing panel for left hinge             | 1        |
| 39  | 33104010  | middle glass                                | 1        |
| 40  | 33015227  | s.s trim for door panel                     | 2        |
| 41  | 33214005  | the fixing part for handle                  | 2        |
| 42  | 33102321  | glass door panel                            | 1        |
| 43  | 33190004  | handle no.H4                                | 1        |
| 44  | 33014019  | the fixing panel for right hinge            | 1        |
| 45  | 33180008  | hinge assembly                              | 2        |
| 46  | 33014063  | middle glass stop block                     | 1        |
| 47  | 33219004  | embedding strip for glass                   | 1        |
| 48  | 33014015  | right bracket for glass                     | 1        |
| 49  | 33219003  | top bracket washer                          | 1        |
| 50  | 33014020  | top bracket for oven door                   | 1        |
| 51  | 33172001  | the handle for grill rack                   | 1        |
| 52  | 33140008  | right side rack                             | 1        |
| 53  | 33140007  | left side rack                              | 1        |
| 54  | 33032002  | right side panel                            | 1        |
| 55  | 33033002  | left side panel                             | 1        |
| 56  | 32244031  | Knob K21                                    | 2        |
| 57  | 33007111  | s.s trim for control panel                  | 2        |
| 58  | 33101248  | glass control panel                         | 1        |
| 59  | 33006006  | the connect panel for control panel         | 4        |
| 60  | 33004009  | fixing panel for door switch bracket        | 1        |
| 61  | 33316006  | 4 steps function control switch assembly    | 1        |
| 62  | 33322006  | fixing box for display board                | 1        |
| 63  | 33005006  | slide block for door stwich                 | 1        |
| 64  | 33005005  | fixing panel for door switch                | 1        |
| 65  | 33301020  | door switch                                 | 1        |
| 66  | 33319002  | the spring for door switch                  | 1        |
| 67  | 33321021  | display board                               | 1        |
| 68  | 33322007  | The fixing bracket for PCB                  | 1        |
| 69  | 33316005  | temperature control switch assembly         | 1        |
| 70  | 33024004  | lateral bracket (left)                      | 1        |
| 71  | 33321020  | PCB   | 1        |
| 72  | 33303041  | top heating element                         | 1        |
| 73  | 33025004  | lateral bracket (right)                     | 1        |
| 74  | 33803002  | door seal assembly                          | 1        |
| 75  | 33031009  | top cover board                             | 1        |
| 76  | 33026007  | exhausting pipe guard board                 | 1        |
| 77  | 33028007  | exhausting pipe cover board                 | 1        |