

Oven:OVF6JP

Version:01

Date:2014-08-19

Product reference code: OVF6JPB

OVF6JP Exploded drawing

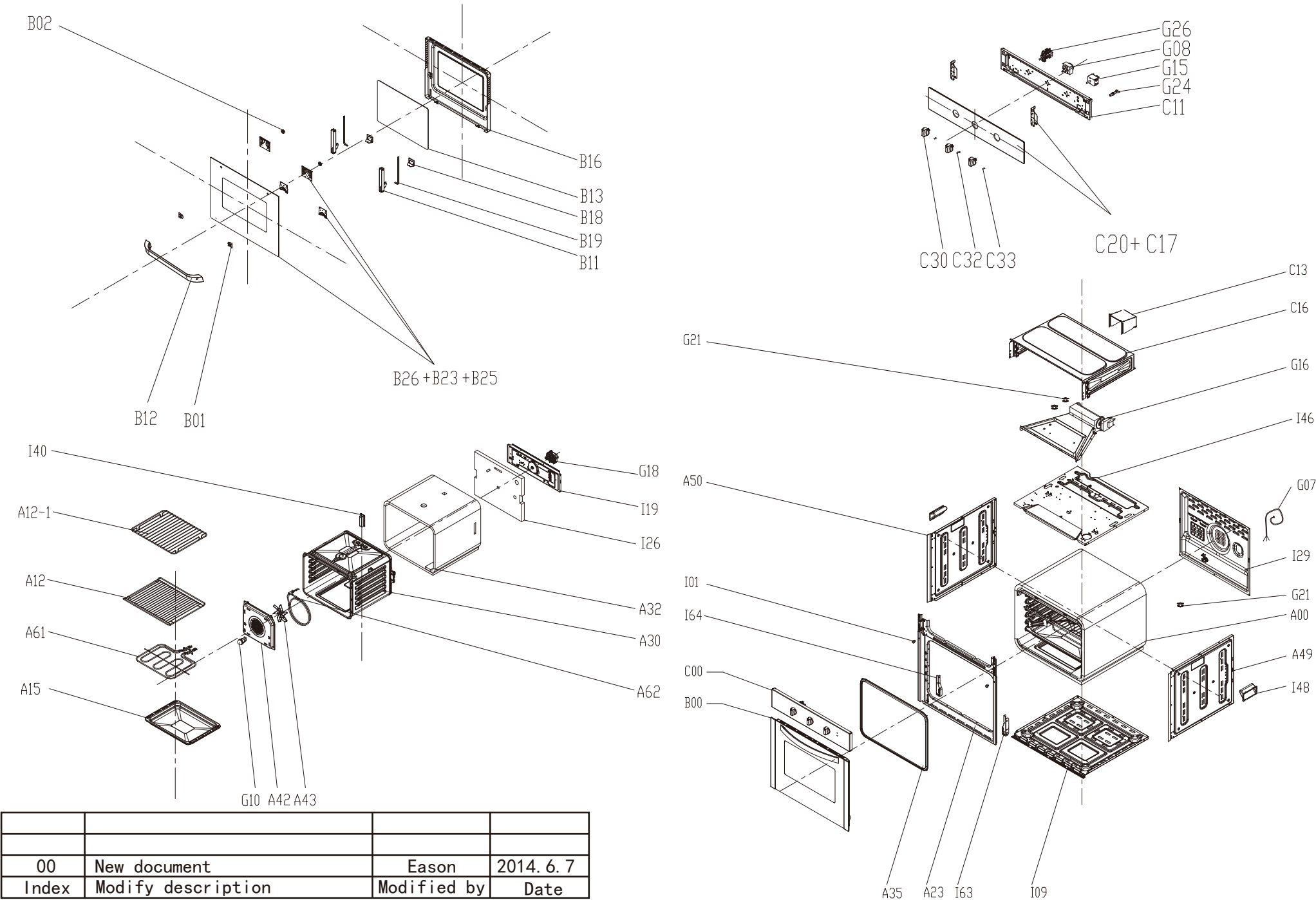

00	New document	Eason	2014. 6. 7
Index	Modify description	Modified by	Date

OVF6JP parts list

NO.	Part code	Part description	quantity
A00	\	cavity ass'y	1
A23	261500616702	front plate	1
A35	262101400124	cavity sealing ring	1
A49	261561500800	encloser(Right)	1
A50	261561400800	encloser(Left)	1
B00	\	door ass'y	1
C00	\	control panel ass'y	1
C13	261561900400	control panel back cover	1
C16	261561800600	control panel cover	1
G07	261201002601	power cord	1
G16	291201300005	cooling fan motor	1
G21	261201301360	thermostat 70℃	1
G21	261201301240	thermostat 90℃	1
I01	291599900023	fastener assembly	1
I09	261561700400	Following encloser	1
I29	261561600400	back cover	1
I46	261561201602	top cover	1
I48	261331200200	handle box	2
I63	261504501200	hinge fixed frame (Right)	1
I64	261504501100	hinge fixed frame (Left)	1
A00	\	cavity ass'y	1
A12	261511712201	bake rack	1
A12-1	261568901401	bake tray rack	1
A15	261504406700	bake tray (deep)	1
A30	261500129800	cavity	1
A32	262100600066	Cavity insulation	1
A42	261562000401	convection motor cover	1
A43	261508200600	convection fan blade	1
A61	261201701083	metal heating element*(top)	1
A62	261201702190	turbo heating element	1
G10	261257700038	lamp	1
G18	261204100130	convection motor	1
I19	261564600300	insulation cover	1
I26	262100600063	back insulation	1
I40	261564400600	exhaust pipe	1
B00	293600105954	door ass'y	1
B01	262101400088	door handle cushion	2
B02	291300600021	handle support	2
B11	291502100015	door hinge ass'y	2
B12	291502200056	door handle	1
B13	262155000038	door inner glass	1
B16	261500204301	door frame ass'y	1
B18	261563702101	door strengthen bracket	2
B19	262155500014	Door sealing ring	2
B23	291599900021	door frame bracket	2
B25	291599900020	door frame bracket(Left)	2
B26	291800800417	door outer glass	1
C00	293600105955	control panel ass'y	1
C11	261561001701	control panel holder	1
C17	261563800900	control panel bracket	2
C20	291800800418	control panel glass	1
C30	291301000069	knob	3
C32	291503600001	knob sharpnel	1
C33	251560002259	knob sharpnel	2
G08	261201800312	timer	1
G15	261257000041	energy controller	1
G24	291202300001	indicator	1
G26	261205200660	switch on-off	1

OVF6JP Wiring diagram

