



Microwave:UBPB20W

Version:00

Date:2016-05-27

Product reference code:UBPB20W

UBPB20W Exploded drawing

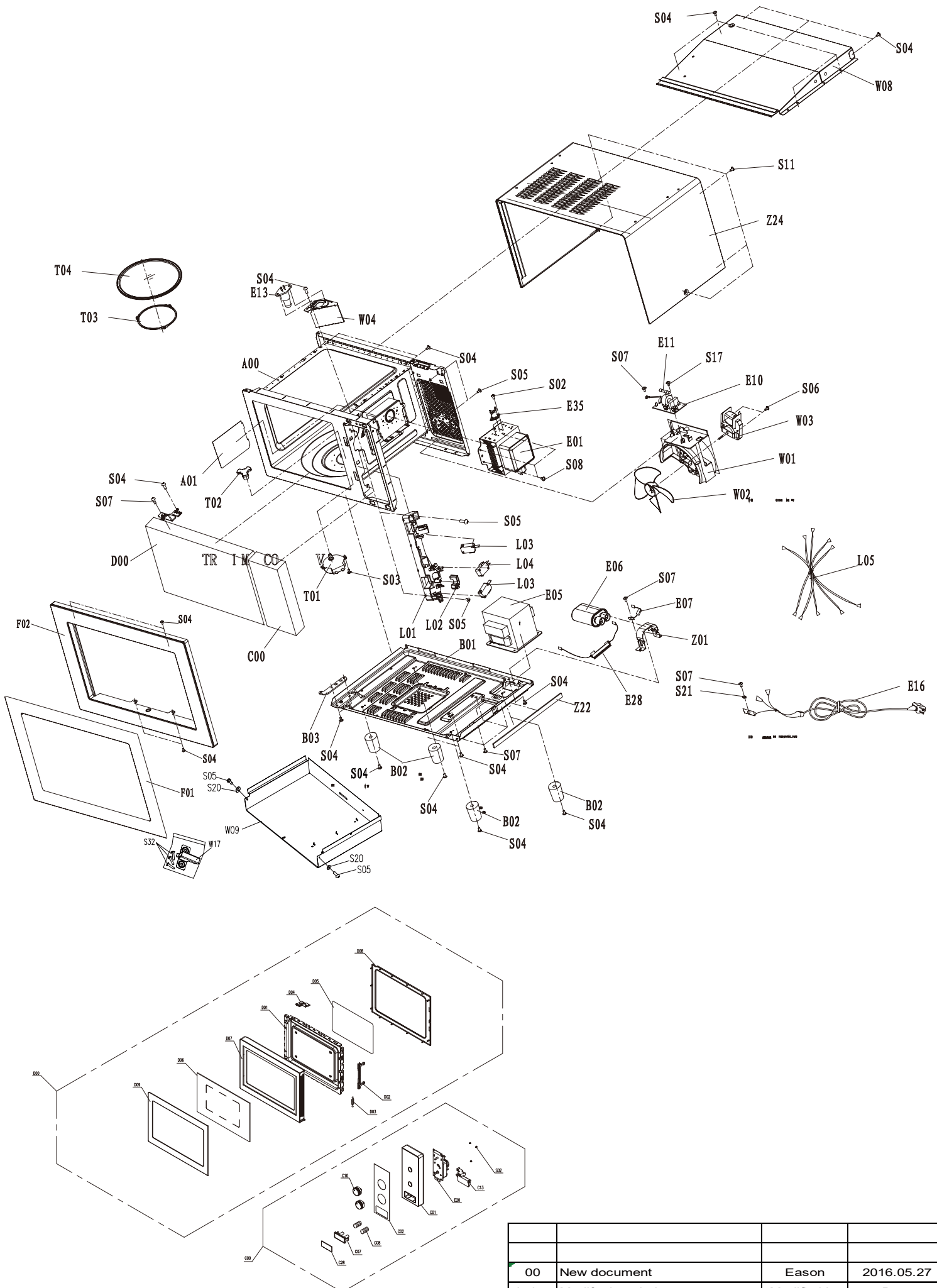

00	New document	Eason	2016.05.27
Index	Modify description	Modified by	Date

UBPB20W parts list

No.	Ref No.	Midea Part No.	Part Name	中文描述	Qty
L03	261201600080	17470000002301	MICROSWITCH INTERLOCK	微动开关 LF-10-	2
L05	251202800507	17470000001188	MAIN WIRE HARNESS	线束 MM823A-P00	1
L04	261201600070	17470000002303	MICROSWITCH MONITOR	微动开关 LF-10-	1
L01	261301301700	121700000003411	LATCH BOARD	桌面炉 联锁支架	1
L02	261301101000	121700000007318	INTERLOCK LEVER	桌面炉 联锁杠杆	1
E13+W04	263602100989	174700000000757	ASS'Y LAMP	微波炉 灯泡组件	1
W04/C43	261503202100	122700000000175	LAMP COVER	桌面炉 金属导风	1
E13	263600500006	174700000000636	LAMP	一体化灯 T25 24	1
E06	251200701308	174700000000694	H.V.CAPACITOR	高压电容 CH85 1	1
E28	251203301549	174700000001559	H.V.FUSE	保险管 GERF- II	1
E07	251200900861	174700000001006	H.V.DIODE	高压二极管 CL01	1
B01	261501411505	122700000005102	BASE PLATE	嵌入式 底板 B20	1
Z01	261501500300	122700000006211	H.V.C HOLDER	桌面炉 电容器夹	1
B02	251302000013	121700000000179	FOOT	桌面炉 炉脚 F23	4
B03	261502501000	122700000006126	HINGE *LOWER	嵌入式 铰链 下	1
C00	25107195	17270000A78153	ASS'Y C/PANEL	微波炉 控制盒组件 B20L Q5机	1
C13	261306100301	12170000010328	DOOR OPEN LEVER	桌面炉 翻板 C23	1
C10	263602101271	121700000003495	TIMER KNOB	嵌入式 旋钮组件	2
C01	261300210690	121700000002807	CONTROL PANEL	嵌入式 控制面板	1
C08	252010100001	129700000000400	BUTTON SPRING	桌面炉 按键弹簧	1
C07	60703170	121700000007285	DOOR OPEN BUTTON	桌面炉 开门按键 E25L VN ABS	1
C28	261516909201	122700000000739	DOOR OPEN BUTTON DECO.	嵌入式 按键壳	1
W09	261503206900	122700000000240	WIND GUIDE COVER *LOWER	桌面炉 金属导风	1
W01	251300803269	121700000004299	FAN GUIDE	桌面炉 风扇支架	1
W02	251300900016	121700000000206	FAN	桌面炉 扇叶 C23	1
W03	251200600161	11002017000075	FAN MOTOR	罩极电机 RoHS Y	1
D00	25107200	12270000A86190	ASS'Y DOOR	微波炉 炉门组件 B20L Q5机械	1
D02	261300501100	121700000003861	LATCH	桌面炉 门钩 C23	1
D05	262200400028	121700000009488	DOOR FILM	桌面炉 门贴 A17	1
D07	261300154600	121700000006126	DOOR PANEL	嵌入式 门面 B17	1
D08	256300600039	121700000009592	DOOR GASKET	桌面炉 门封 A17	1
D04	261502401100	122700000006123	ASS'Y HINGE *UPPER	嵌入式 铰链 上	1
D01	261500203301	1227000000003813	ASS'Y DOOR FRAME	嵌入式 门体组件	1
D03	252010000379	129700000000392	LATCH SPRING	嵌入式 门钩弹簧	1
F02	261314203600	121700000006714	TRIM PANEL	嵌入式 塑胶外框	1
S13	251302003319	121700000000171	BOLT	嵌入式 炉脚 B17	1
T02	252200100008	121700000000424	COUPLER	桌面炉 塑料驱动	1
Z22	252200700003	126700000000424	导风罩海绵条	桌面炉 防震条 A	1
T03	262200200023	121700000004334	ASS'Y RING ROTATING	桌面炉 转环组件	1
W08	251503202217	122700000000145	WIND GUIDE COVER *UPPER	桌面炉 金属导风	1
A01	252100100016	125700000001036	SPLASH COVER	桌面炉 防溅板 G	1
Z24	261502632200	122700000005630	OUTER CASE	嵌入式 外罩 通用	1
F03	261314300300	121700000007372	SCREW COVER	嵌入式 螺钉盖 B	1
E16	256201000414	174700000000096	POWER CORD	电源线 BS31B-11	1
E05	251200200298	174700000003624	H.V.TRANSFORMER	高压变压器 MD-8	1
E01	251200100068	174700000000809	MAGNETRON	磁控管 2M219J 9	1
T01	251200300001	11002014000037	TURNTABLE MOTOR	同步电机 RoHS T	1
E35	261201301200	174700000001493	THERMOSTAT 160/95℃ *V	突跳式温控器 KS	1
E20	251201800124	174700000000657	TIMER	定时开关 VFD35M	1
W17	261514200200	122700000003554	MOUNTING PLATE	嵌入式 安装板 B	1
T04	252100500496	125700000001019	GLASS TRAY	桌面炉 玻璃转盘	1
E10+E11	263601600014	171700000002979	ASS'Y NOISE FILTER	微波炉 滤波板组	1
D06	262100404338	125700000000224	DOOR SCREEN	美的版门窗丝印	1

UBPB20W Wiring diagram