



Oven:65DME40135

Version:00

Date:2014-11-01

Product reference code: 65DME40135

65DME40135 Exploded Drawing

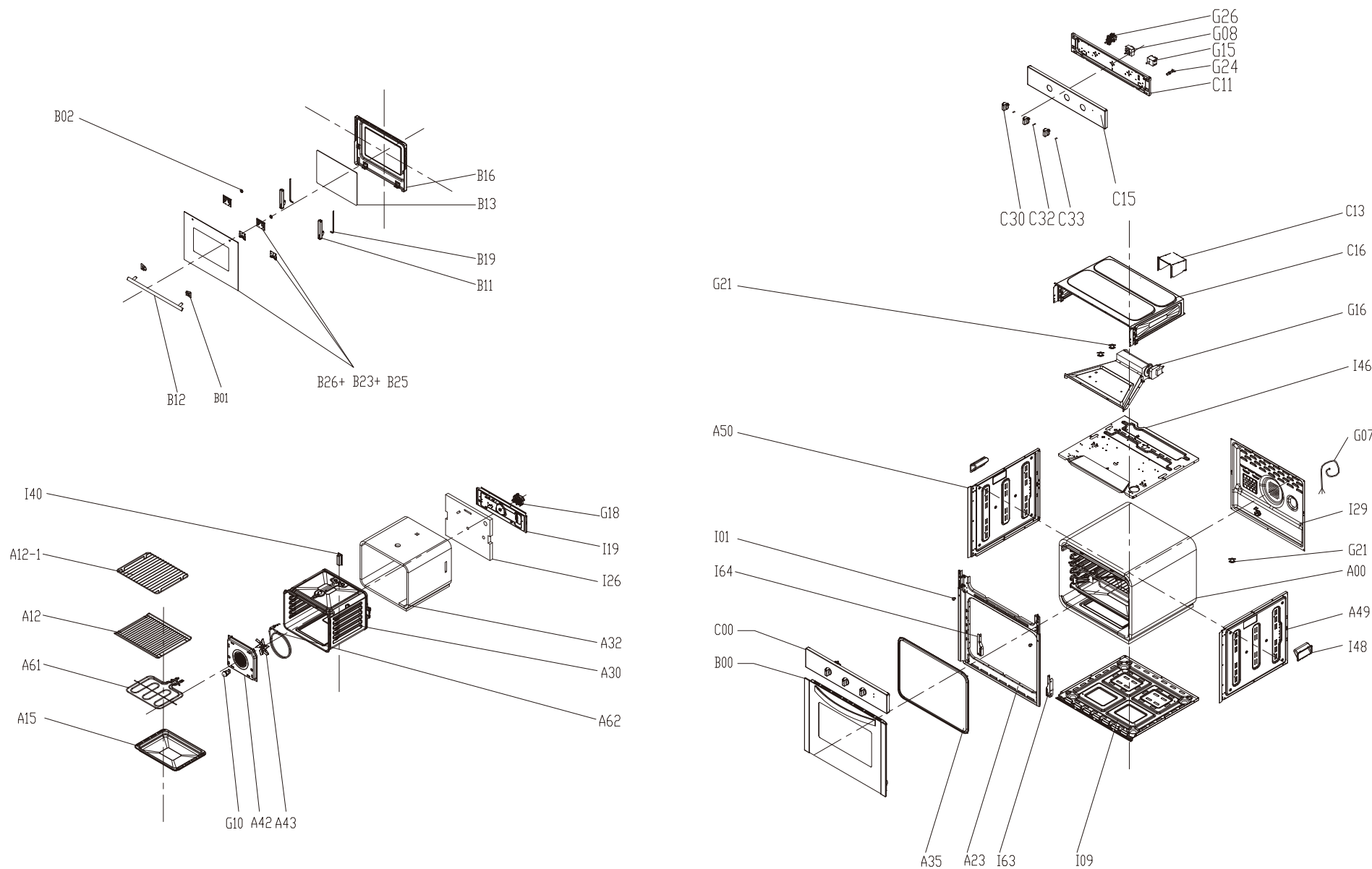

| | | | |
|-------|--------------------|-------------|--------------|
| | | | |
| 00 | New document | Eason | 2014. 11. 01 |
| Index | Modify description | Modified by | Date |

65DME40135 parts list

Oven

| No. | Part Code | Part name English | Qty |
|-------|--------------|-----------------------------|-----|
| A23 | 261500616702 | front plate | 1 |
| A35 | 262101400124 | cavity sealing ring | 1 |
| A49 | 261561500800 | encloser(Right) | 1 |
| A50 | 261561400800 | encloser(Left) | 1 |
| C13 | 261561900400 | control panel back cover | 1 |
| C16 | 261561800600 | control panel cover | 1 |
| G07 | 261201002601 | power cord | 1 |
| G16 | 291201300005 | cooling fan motor | 1 |
| G21 | 261201301360 | thermostat 70℃ | 1 |
| G21 | 261201301240 | thermostat 90℃ | 1 |
| I01 | 291599900023 | fastener assembly | 1 |
| I09 | 261561700400 | Following encloser | 1 |
| I29 | 261561600400 | back cover | 1 |
| I46 | 261561201602 | top cover | 1 |
| I48 | 261331200200 | handle box | 2 |
| I63 | 261504501200 | hinge fixed frame (Right) | 1 |
| I64 | 261504501100 | hinge fixed frame (Left) | |
| | | | |
| A00 | \ | cavity ass'y | |
| A12 | 291501300035 | bake rack | 1 |
| A12-1 | 261568901401 | bake tray rack | 1 |
| A15 | 261504406700 | bake tray (deep) | 1 |
| A30 | 291504600253 | cavity | 1 |
| A32 | 262100600066 | Cavity insulation | 1 |
| A42 | 261562000401 | convection motor cover | 1 |
| A43 | 261508200600 | convection fan blade | 1 |
| A61 | 291200800031 | metal heating element*(top) | 1 |
| A62 | 261201702190 | turbo heating element | 1 |
| G10 | 261257700038 | lamp | 1 |
| G18 | 261204100130 | convection motor | 1 |
| I19 | 261564600300 | insulation cover | 1 |
| I26 | 262100600063 | back insulation | 1 |
| I40 | 261564400600 | exhaust pipe | 1 |
| | | | |
| B00 | 291506100136 | door ass'y | 1 |
| B01 | 262100800105 | door handle cushion | 2 |
| B02 | 291300600021 | handle support | 2 |
| B11 | 291502100015 | door hinge ass'y | 2 |
| B12 | 261509400902 | door handle | 1 |
| B13 | 262155000038 | door inner glass | 1 |
| B16 | 291502300035 | door frame ass'y | 1 |
| B19 | 262155500014 | Door sealing ring | 2 |
| B23 | 291599900021 | door frame bracket | 2 |
| B25 | 291599900020 | door frame bracket(Left) | 2 |
| B26 | 292100500210 | door outer glass | 1 |
| | | | |
| C00 | 291506100217 | control panel ass'y | 1 |
| C11 | 261561001701 | control panel holder | 1 |
| C15 | 261518908902 | control panel decoration | 1 |
| C30 | 291306000011 | knob | 3 |
| C32 | 291503600001 | knob sharpnel | 1 |
| C33 | 251560002259 | knob sharpnel | 2 |
| G08 | 261201800312 | timer | 1 |
| G15 | 261257000041 | energy controller | 1 |
| G24 | 291202300001 | indicator | 1 |
| G26 | 261205200660 | switch on-off | 1 |