

110cm Stainless Steel Cooker Hood

Model Number CHIM110SSPF

Parts Manual

Exploded Drawing

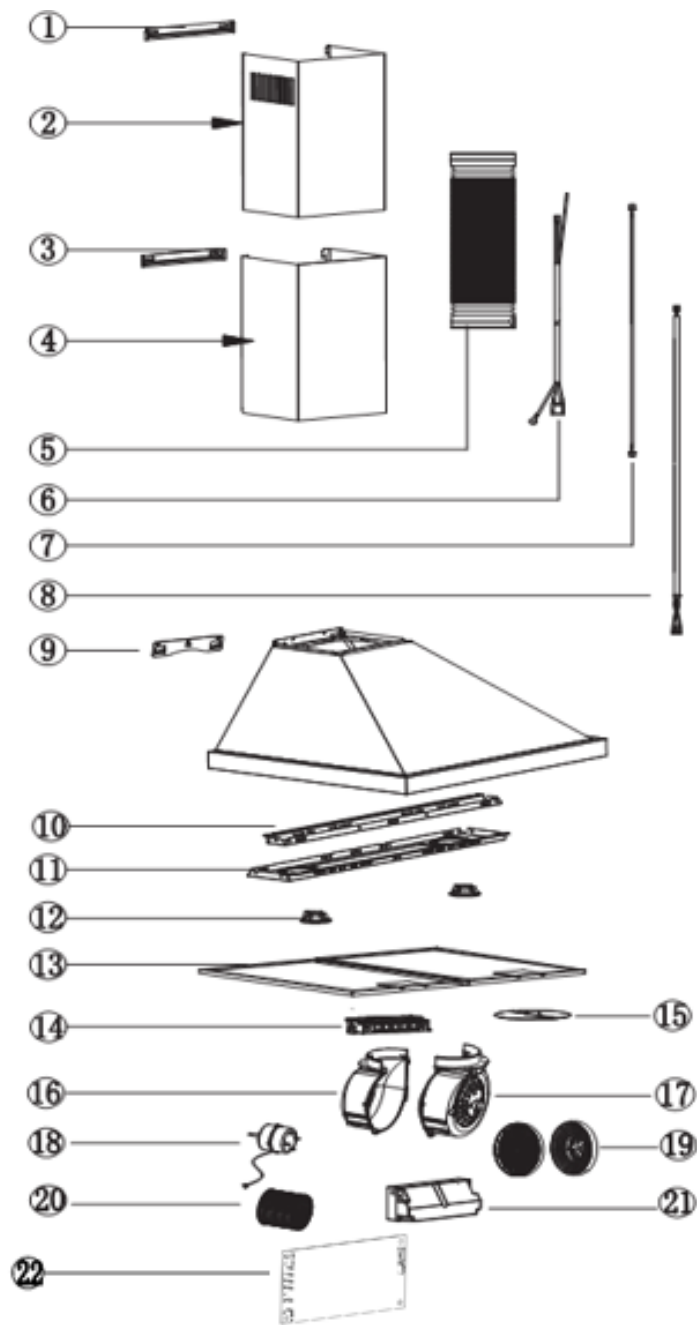

| | | | |
|-------|--------------------|-------------|------|
| 02 | | | |
| 01 | | | |
| 00 | | | |
| Index | Modify description | Modified by | Date |

Parts List

| S/N | Ref. | Description | QTY | REMARK |
|-----|------------------|-----------------------------|-----|----------|
| 1 | B23-TD08-006-PX | TD INNER CHIMNEY BRACKET | 1 | |
| 2 | B20-TD08-008-PX | TD INNER CHIMNEY-S/S | 1 | |
| 3 | B23-TD08-005-PX | TD OUTER CHIMNEY BRACKET | 1 | |
| 4 | B20-TD08-007-PX | TD OUTER CHIMNEY-S/S | 1 | |
| 5 | B36-TT03-018-XG | Φ150 SMOKE TUBE | 1 | Optional |
| 6 | B67-TY04-005-XB | WIRE ONLY, WITHOUT PLUG | 1 | |
| 7 | B67-TY03-055-XX | SWITCH WIRE | 1 | |
| | B67-TY03-285-XX | SWITCH WIRE | 1 | |
| 8 | B67-TY03-022-XX | LIGHT WIRE | 1 | |
| 9 | B23-TG18-027-PX | WALL BRACKET | 1 | |
| 10 | B20-TD07-061-PX | FRONT DECORATIVE PLATE -S/S | 1 | |
| 11 | B20-TD07-063-PX | REAR LAMPSHADE -S/S | 1 | |
| 12 | B62-TY01-016-XX | LED LAMP | 1 | |
| 13 | B35-TD07-067-XX | 5 LAYERS ALUMINIUM FILTER | 3 | |
| 14 | B60-TY05-005-XX | M02 PUSH BUTTON | 1 | |
| 15 | B30-TG18-015-JB | Φ150 VALVE | 1 | |
| 16 | B30-TI01-029-JB | HOUSING L -LEFT PART | 1 | |
| 17 | B30-TI01-028-JB | HOUSING L -RIGHT PART | 1 | |
| 18 | B61-TY02-002-XX | HOUSING L MOTOR | 1 | |
| 19 | B15-TF08-097-JB | CHARCOAL FILTER | 2 | Optional |
| 20 | B30-TT03-012-JB | FAN | 1 | |
| 21 | B30-TD08-020-JB | ELECTRIC CONTROL BOX | 1 | |
| | B30-TD08-021-JB | ELECTRIC CONTROL BOX | 1 | |
| 22 | B63-TY12-281-XX3 | PCB | 1 | |