



Freezer:BUFZ60UB

Version:00

Date:2015-04-07

Product reference code:

BUFZ60UB Exploded drawing

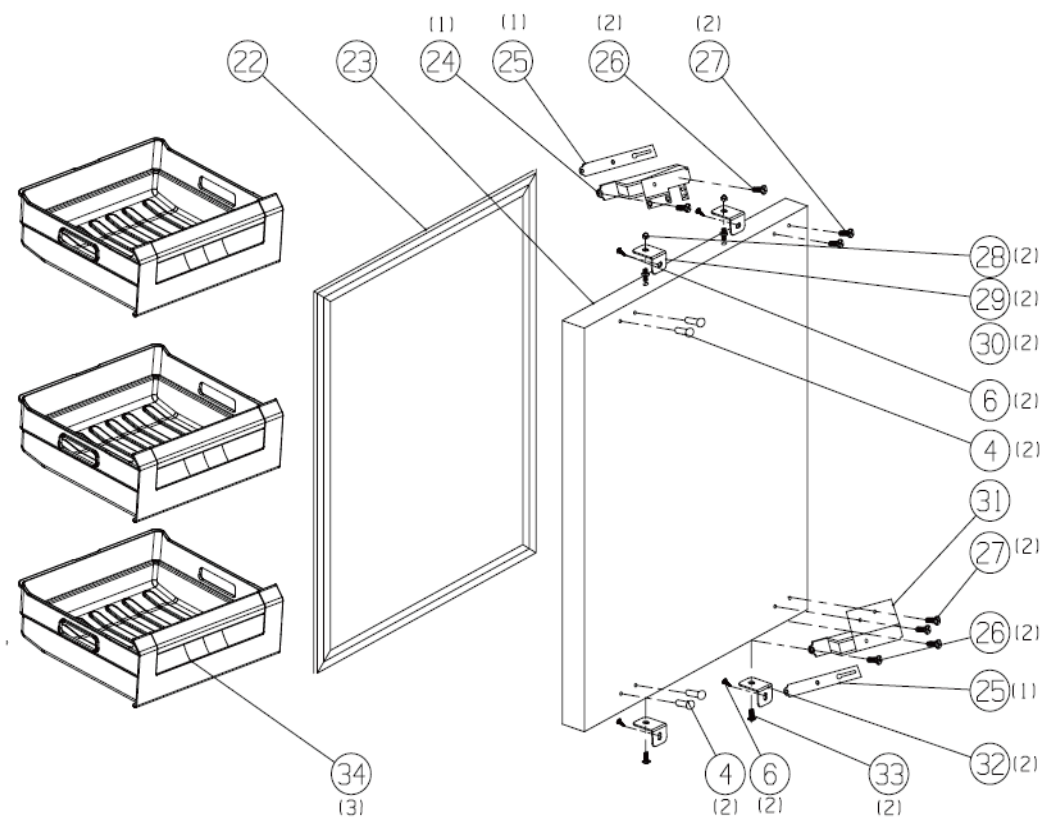
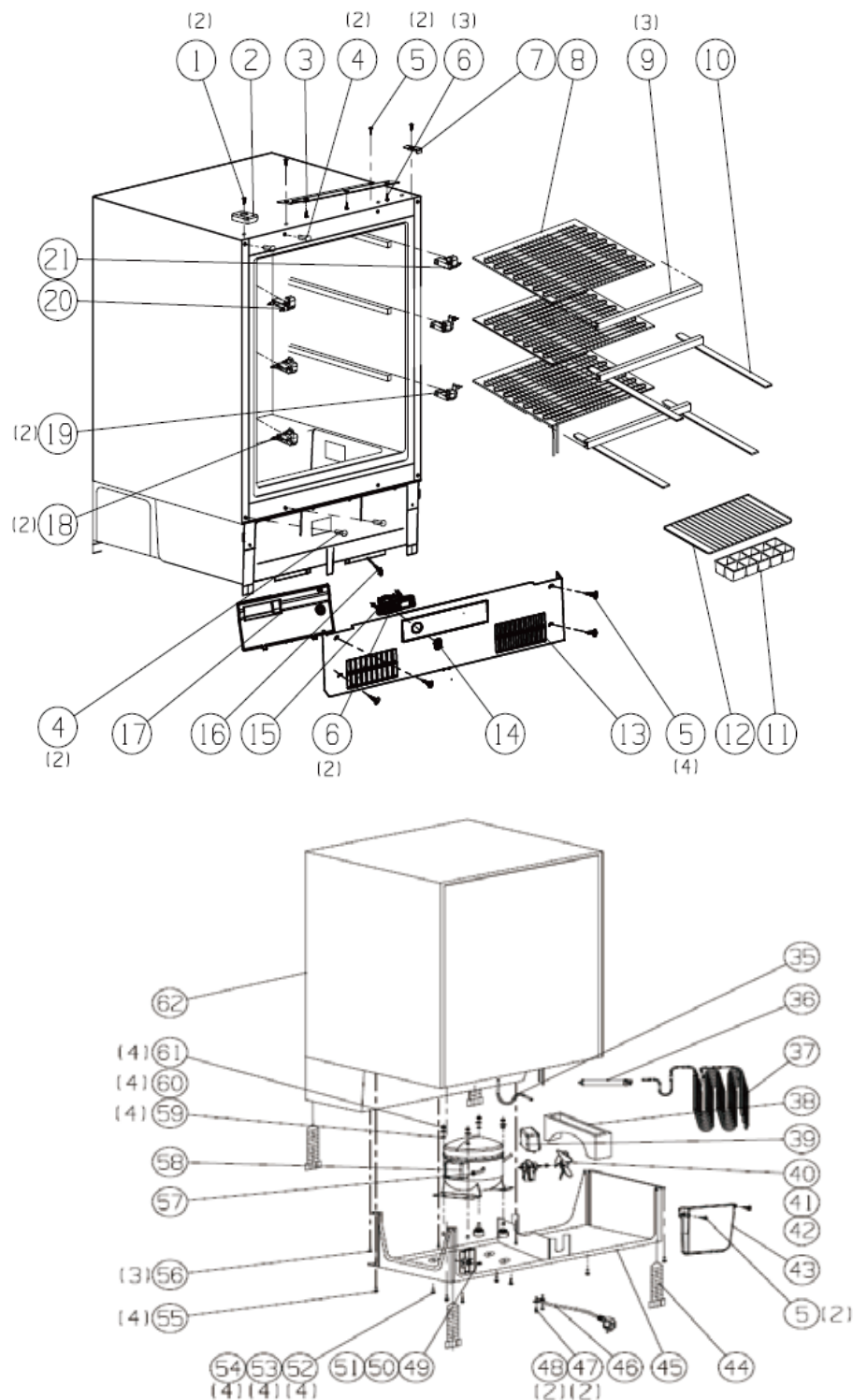

00	New document	Eason	2016. 04. 07
Index	Modify description	Modified by	Date

BUFZ60UB parts list

No	Part No	Part name	pcs	Chinese Name	Remark	
1	1099083	Self-tapping screw ST2.9×9.5	2	自攻螺钉 ST2.9×9.5	GB/T 846-85	
2	1113495	Corner cover	1	角盖	B05210172	Left
3	1113464	Fixed board	1	固定板	B04110086	
4	1096985	Screw hole cover	8	螺钉孔盖	B05210043	
5	1099042	Self-tapping screw ST4.2×13	9	自攻螺钉ST4.2×13	GB/T 845-85	
6	1391632	Self-tapping screw ST4.2X13	9	自攻螺钉ST4.2×13	GB/T 845-85	
7	1113494	Corner cover	1	角盖	B05210172	Right
8	1115123	Freezer evaporator part	1	冷冻蒸发器部件	B01260036	
9	1052512	Evaporator decorative bar	3	蒸发器装饰条	B05100015	
10	1052525	Drawer pad	4	抽屉垫板	B03170004	
11	1051965	Ice tray	1	制冰盒	B05080003	
12	1113487	Shelf part	1	层架部件	B04200077	
13	1559791	Control panel-drawing	1	控制面板-图	B01517031	
14	1051745	Knob	1	旋钮	B05191026	
15	1562713	Thermostat	1	温控器	B03241025	
16	1558811	Inner electric connecting wire components	1	电器内连接线组件	W	
17	1519480	control board box cover	1	控制板盒盖	B05081214	
18	1054604	Evaporator left stop	2	蒸发器左限位块	B05200008	F2、F3
19	1052501	Evaporator right stop	2	蒸发器右限位块	B05200008	F2、F3
20	1054602	Evaporator left stop	1	蒸发器左限位块	B05200002	F1
21	1052492	Evaporator right stop	1	蒸发器右限位块	B05200002	F1
22	1054916	Gasket part	1	门封	B01140001	
23	1066964	Freezer door	1	冷冻门	B01130206	
24	1391478	Upper hinge parts	1	上铰链部件	B01081047	
25	1403515	Lower hinge pad	2	下铰链垫片	B05131012	
26	1111468	Flange screw M5×20	4	法兰面螺钉M5X20	B07040003	
27	1111123	Flange screw M5×12	4	法兰面螺钉M5X12	B07040003	
28	1115438	Screw nut M5	2	螺母M5	GB/T 802-88	
29	1113509	connecting block	2	连接板	B04110087	Up
30	1104579	Adjustable bolt	2	调节螺栓M5X20	BC140/HC(E). 00-	
31	1391479	Lower hinge parts	1	下铰链部件	B01081047	
32	1113493	connecting block	2	连接板	B04110087	Down
33	1111123	Flange screw M5×12	2	法兰面螺钉M5X12	B07040003	
34	1053533	freezer middle drawer	3	冷冻中抽屉	B05040040	
35	1120224	connecting tube	1	连接管	B02080040	
36	1121069	Dry filter	1	干燥过滤器	B02050008	
37	1063208	Bottom condenser	1	底冷凝器	B02040019	
38	1052048	Evaporating dish	1	蒸发皿	B05080016	
39	1065006	Motor cover	1	电机盖	B05110124	
40	1070335	Wind blade	1	风叶	B05100048	
41	1111138	Blade fixed ring	1	风叶固定环	B04180010	
42	1451768	refrigerator fan motor	1	冰箱风机	B03080006	
43	1113466	Baffle	1	挡板	B05100111	
44	1113477	Adjustable screw bolt	4	可调底脚部件	B05230017	
45	1051213	Compressor supporting board	1	压缩机支撑板	B05100001	
46	1612779	Power board part	1	电源线部件	B03121018	
47	1099069	Screw M5×12	2	螺钉M5×12	GB/T 818-2000	
48	1099096	Screw nut M5	2	螺母M5	GB/T 6170-86	
49	1112560	Special self-tapping screw	1	专用自攻螺钉ST4.2x13	T00-22	
50	1432701	Junction box cover	1	接线盒盖	B05080038	
51	1432699	Junction box	1	接线盒	B05080037	
52	1099104	Screw bolt M6×30	4	螺栓M6×30	GB/T 5783 2000	
53	1358616	Steel sleeve	4	钢套	B04280004	
54	1111696	Vibration pad	4	减振垫	B09010030	
55	1099098	special flange self-tapping screw M5×16	4	专用法兰面螺钉M5×16	B07040003	
56	1099043	Self-tapping screw ST4.2X16	3	自攻螺钉ST4.2x16	GB/T 845-85	
57	1051105	Process Tube	1	封尾管	B02070001	
58	1562456	Compressor part	1	冰箱压缩机部件	PZ55H1X	
59	1099122	Flat washer 6	4	垫圈6	GB/T 93-87	
60	1099120	Flat washer 6	4	垫圈6	GB/T 96.1 2002	
61	1099071	Screw M6	4	螺母M6	GB/T 6175 2000	
62	1558520	Case	1	发泡箱	B01021621	

BUFZ60UB Wiring diagram

