

REF	REF
EC60T2	EC60T2
EC60T2H	EC60T2

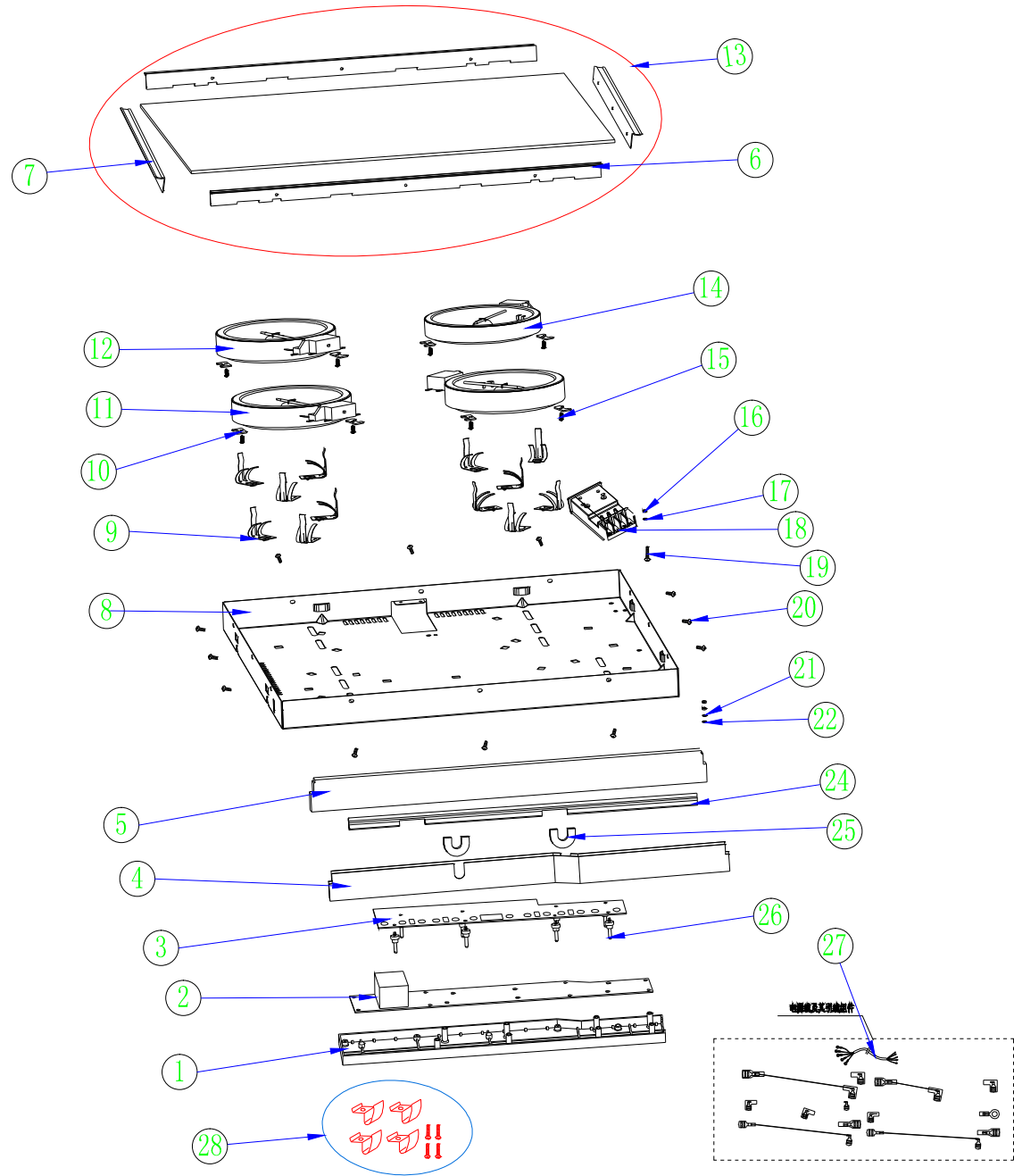

05	add install kit(NO.28)	PAUL	2012.11.03	05
04	change the sign of NO.6 7 and 13	Paul	2012.9.15	04
03	add model EC60T2H, modify Midea internal code of number 9 , 10	Bon.Liu	2010.7.21	03
02	modify drawing in order to be suitable for new rules	Bon.Liu	2010.4.3	02
01	add Midea internal code	Bon.Liu	2010.3.30	01
00	New Document	Bon.Liu	2009.04.21	00
Index	Modify Description	Modified by:	Date	Mod:

REF:EC60T2_EC60T2H Ceramic hob:EC60T2					
S/N	Ref	Description(en)	QTY	Material	Midea internal code (only for reference)
1	25103245	Inverter Base-cooker-EC60T2	1		303207300291
2	63900080	main control board assembly(PCB)-cooker-EC60T2	1		303203101404
3	69405960	display board assembly-cooker-EC60T2	1		303203101407
4	64700515	Heat insulation bracket-cooker-EC60T2	1	SGCC T0.8mm	303207800093
5	64700535	Heat insulation cotton-cooker-EC60T2	1		303202804194
6	69403175	Merge to 25102615(NO.13)	2	SGCC T1mm	303207400067
7	69403180	Merge to 25102615(NO.13)	2	SGCC T1mm	303207400066
8	25103250	base cover-cooker-EC60T2	1		303207800140
9	25102610	Spring gasket-cooker-EC60T2	12	T0.6mm	541400200002
10	62901405	Fixer for burner-cooker-EC60T2	12	SGCC T1.5mm	541400400002
11	69403185	single loop hob-cooker-EC60T2	1	EGO	303203501014
12	69403190	single loop hob-cooker-EC60T2	2	EGO	303203501013
13	25102615	Ceramic glass+brackets-cooker-EC60T2	1		303208001083
14	69403195	single loop hob-cooker-EC60T2	1	EGO	303203501014
15	62700385	Screw-cooker-EC60T2	12		301500101197
16	63500080	Nut-cooker-EC60T2	3	SUS302 M4	303207805016
17	25103255	Flat gasket-cooker-EC60T2	8		301500101192
18	69405965	junction port holder-cooker-EC60T2	1		303207300167
19	62700315	Screw-cooker-EC60T2	1	1018A M4*35-PFHD	301500101200
20	62700320	Screw-cooker-EC60T2	25	SUS410 ST4*8-PFHD	301500100955
21	25102625	Spring gasket-cooker-EC60T2	1		301500101083
22	25102630	Gasket-cooker-EC60T2	1	20#Steel 4-D	301500300042
24	60500205	Silicone seal strip-cooker-EC60T2	1	Silicone rubber	303207900050
25	60500210	Silicone sheath-cooker-EC60T2	2		303207900038
26	69403205	Support pole-cooker-EC60T2	6	PA66	303207300006
27	69405970	Power cord and link wire-cooker-EC60T2	1		303203601193
28	25400145	accessory bag(Bracket+screw)-ceramic hob-EC60T2	1		541410500001

cata ELECTRODOMESTICOS S.L.		Name:	Date:	Material:	Model:
		Drawed:	Bon Liu	2009.04.21	Weight:
		Checked:		Colour:	N°Pieces
		Page:		Destiny:	Reference:
Scale: -/-		Denomination: EC60T2_EC60T2H-04-break down drawing-ceramic hob-EC60T2			