



Gas Hob

REF	Model
GHFF70GG	GHFF70GG
UBGHFF70GG	UBGHFF70GG

Hob glass.

69405950 before June 2012

69410280 after June 2012

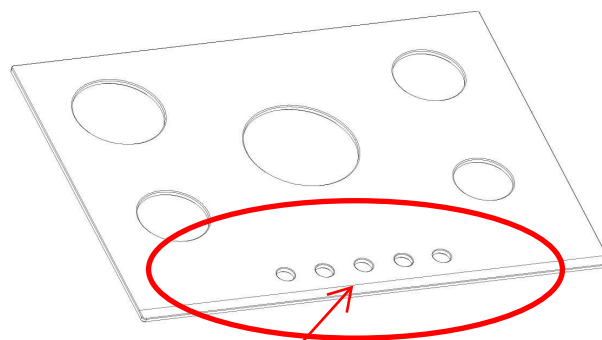
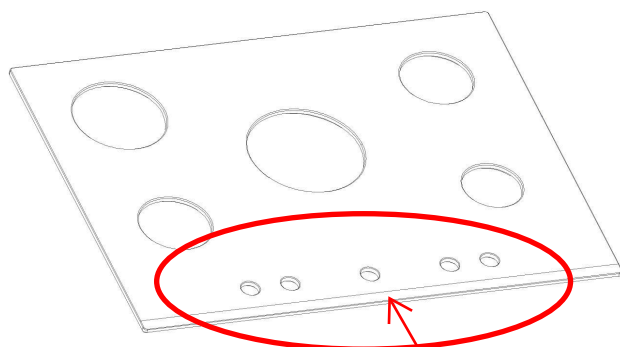

Note the position of the controls

Version:01

Date:2015-06-03

Exploded drawing

To ID the correct hob glass
see notes and images on the
first page.

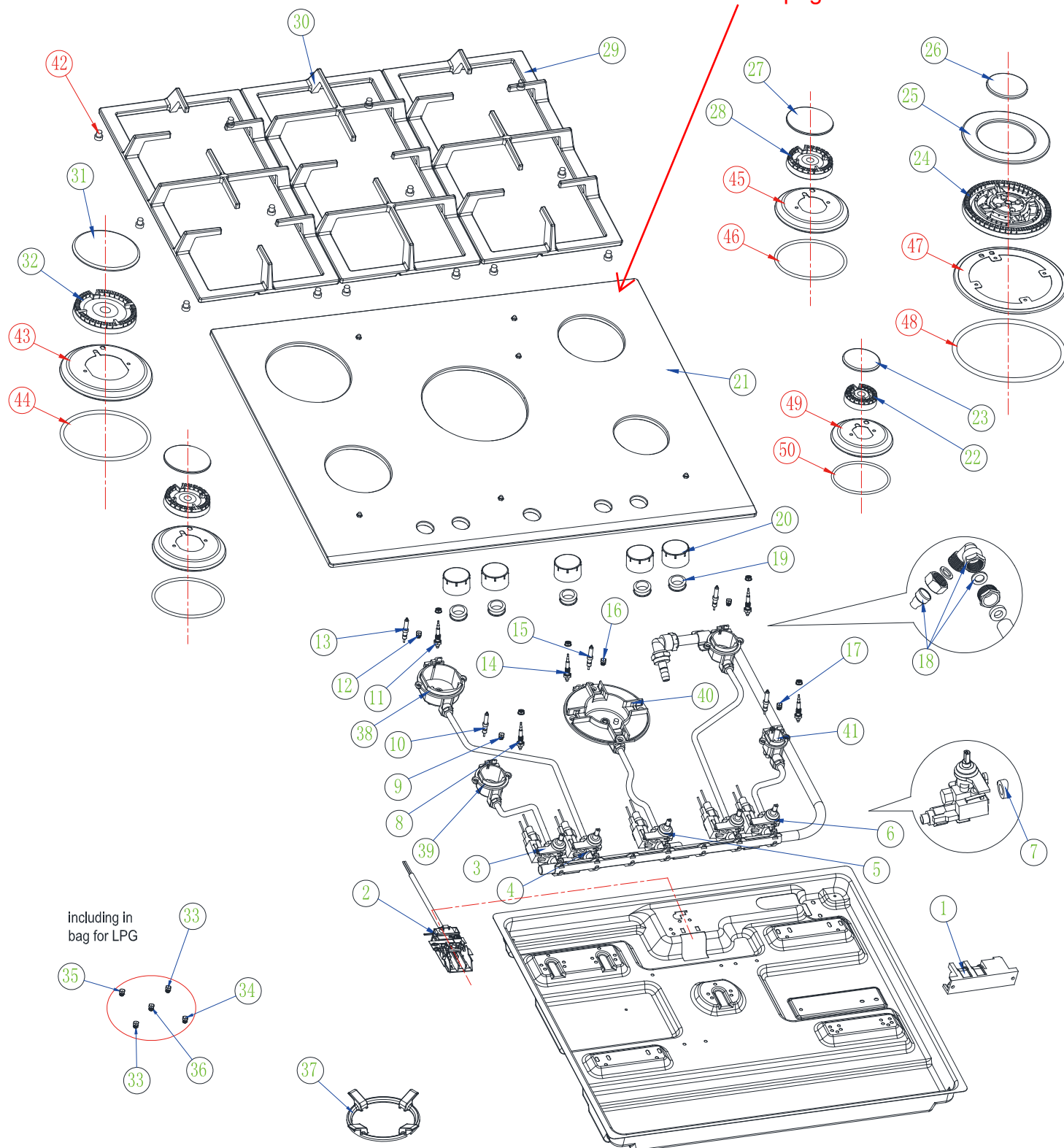

	01 New document	Eason	2015. 6. 3
Modify description		Modified by	Date

GHFF70GG_UBGHFF70GG

parts list

S/N	Ref	Description(en)	Qty	Factory code	Remark
1	26200180	impulse ignition device-gas-hob-L 905 CI/A	1set	216220	
2	26200175	electrical connector box-gas-hob-L 905 CI/A	1set	240001	
3	26200105	valve 1# -gas-hob-L705 TI_INOX	2set	141102	
4	26200030	valve 2# -gas-hob-L705 TI_INOX	1set	141103	
5	26200035	valve 3# -gas-hob-L705 TI_INOX	1set	141104	
6	26200090	valve 4# -gas-hob-L705 TI_INOX	1set	141101	
7	60500065	sealing ring(valve)-gas-hob-604 FTI	5	silicon	
8	26200190	thermocouple(350)-gas-hob-L 905 CI/A	2	195282	
9	69401790	injector/nozzle(NG,Semi-rapid)-gas-hob-L 905 CI/A	2	130701-4	
10	69405945	ignition pin(500)-gas-hob-GHFF70GG	2	201370	
11	26200185	thermocouple(500)-gas-hob-L 905 CI/A	2		
12	69401805	injector/nozzle(NG,rapid)-gas-hob-L 905 CI/A	1	131001-4	
13	69401835	ignition pin(220)-gas-hob-L 604 FTI/T MX	1	201570	
14	26200340	thermocouple(350,triple ring)-gas-hob-L 604 RH CI black	1	195161	
15	69405865	ignition pin(300,triple ring)-gas-hob-GCI57	1	202360	
16	69401800	injector/nozzle(NG,triple ring)-gas-hob-L 905 CI/A	1	131201-4	
17	69401795	injector/nozzle(NG,auxiliary)-gas-hob-L 905 CI/A	1	130501-4	
18	26200195	connector(elbow)-gas-hob-Gristal Gas 40 Tc	1set	assembly	
19	60500250	waterproof ring(knob)-gas-hob-GHDF60AL	5	232001	
20	60701740	knob-gas-hob-GHDF70SS	5		
21	69405950	panel-gas-hob-GHFF70GG(CATA logo)	1	glass	For GHFF70GG,But to stop using in June 2012
	69410280	panel-gas-hob-GHFF70GG(CATA logo)			For GHFF70GG,Started in June 2012.
	69410890	panel-gas-hob-UBGHFF70GG(no logo)			For UBGHFF70GG
22	69401765	Ø50 flame distributor-gas-hob-L 905 CI/A	1	130501-2	
23	69401745	Ø50 burn cover-gas-hob-L 905 CI/A	1	130501-3	
24	69401755	Ø120 flame distributor-gas-hob-L 905 CI/A	1	131201-2	
25	69400195	burn cover ring-gas-hob-L 603 FTI	1	131201-3	
26	69400200	burn cover center-gas-hob-L 603 FTI	1	131201-4	
27	69401740	Ø70 burn cover-gas-hob-L 905 CI/A	2	130701-3	
28	69401760	Ø70 flame distributor-gas-hob-L 905 CI/A	2	130701-2	
29	69405875	pan support 1# -gas-hob-GCI57	2	15G705-E1	
30	69405880	pan support 2# -gas-hob-GCI57	1	15G705-E2	
31	69401730	Ø100 burn cover-gas-hob-L 905 CI/A	1	131001-3	
32	69401750	Ø100 flame distributor-gas-hob-L 905 CI/A	1	131001-2	
33	69403090	injector/nozzle(LPG,Semi-rapid)-gas-hob-L 905 CI/A	2		
34	69403100	injector/nozzle(LPG,auxiliary)-gas-hob-L 905 CI/A	1		
35	69403105	injector/nozzle(LPG,rapid)-gas-hob-L 905 CI/A	1		
36	69403095	injector/nozzle(LPG,triple ring)-gas-hob-L 905 CI/A	1		
37	69402740	work support-gas-hob-L 604 FTI Mexico	1	cast iron	
38	64500030	burner basement(rapid)-gas hob-L705TI	1	2131001-1	
39	64500025	burner basement(semi-rapid)-gas hob-L705TI	2	130701-1	
40	64500055	burner basement(triple ring)-gas hob-L705TI	1	131201-1	
41	64500035	burner basement(auxiliary)-gas hob-L705TI	1	130501-1	
42	60500200	rubber washer of pan support-gas hob-L 705 CI/A	18		
43	69406000	Ø100 water tray-gas hob-GCI57	1	16100B	
44	60500260	Ø100 waterproof ring-gas hob-GCI57	1	23100B	
45	69406005	Ø70 water tray-gas hob-GCI57	2	16070B	
46	60500265	Ø70 waterproof ring-gas hob-GCI57	2	23070B	
47	69406010	Ø120 water tray-gas hob-GCI57	1	16120B	
48	60500270	Ø120 waterproof ring-gas hob-GCI57	1	23120B	
49	69406015	Ø50 water tray-gas hob-GCI57	1	16050B	
50	60500275	Ø50 waterproof ring-gas hob-GCI57	1	23050B	