

# Instruction for use

## WASHING MACHINE

### WMH60



- Please read this manual carefully before use
- Keep this manual in a safe place

#### Table of Contents

##### Before Use

Matters Needing Attention ..... 1-3

Installation ..... 4-5

Control Panel..... 6

Operational Functions ..... 7-8

##### During Use

Guide to Operational Program Selection ..... 9

Washing Methods ..... 10-11

Hints for Saving Energy ..... 11

Washing Instructions ..... 12

Other Functions ..... 12

##### Maintenance

Maintenance ..... 13-14

Trouble shooting ..... 15

Electric Circuit Diagram ..... 16

Specifications ..... Back cover

# Matters Needing Attention

## ● Safety

1. A separate earthed socket is required for the power supply. The socket should be reachable by the power cable of the machine.

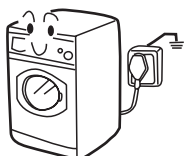

2. Hold the plug and not the electric cable when unplugging the power supply.



3. Fuses in the power circuit should be rated for 13A.

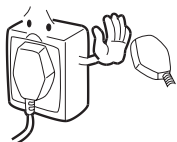

4. Do not touch or use the washing machine bare-footed or when the hands or feet are wet.



5. Do not use flammable detergent or dry cleaning agent; do not use flammable spray in close vicinity to the washing machine; do not remove or insert the plug in the presence of flammable gas.



6. The door of the washing machine will become hot during the heating process. Avoid contact with the door during the heating process. For safety, keep children away from the washing machine.



7. Keep children away from the packing materials after unpacked.

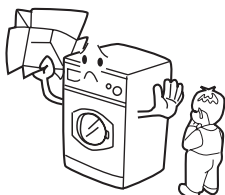

8. For safe installation of drain hose, use the drainage holder to prevent the drain hose from moving and allowing water to spill outside the drain



## Matters Needing Attention

9. The washing machine should not be installed outdoors or in a damp place. In the event of water leakage or splashes allow the machine to dry naturally.



10. Do not place the washing machine directly on a carpet, or close to a wall or furniture.

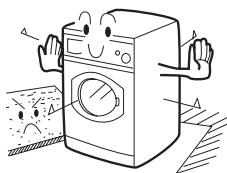

11. Keep away from heat sources and direct sunlight to prevent plastic and rubber components from aging.



12. During installation, ensure that the electric cable is not trapped by the washing machine and avoid damage to the electric cable.

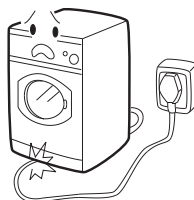

### During Use

1. Before use, check the joints of the filling hose, the tap and the drainage hose for possible problems from water pressure fluctuations. If joints are loose or there is leakage, turn off the tap and repair. Do not use the washing machine until the hoses are properly fixed.



2. To select a program, simply turn the knob clockwise or counterclockwise.



## Matters Needing Attention

3. Do not place heavy, heating source or wet articles on the top of the washing machine.



4. Do not hot wash foam rubber or sponge-like materials.



5. Before washing, do up zippers, buttons and clothes straps and put small articles, such as socks, laces or bras, into a washing bag or a pillow.

Steel wires in bras will pop out during washing; never wash bras containing steel wires.



6. Do not open the detergent distribution drawer during the wash cycle.



7. The door is fitted with a self-lock device and will not open until 2~3 minutes after the washing machine stops. Do not force the door open. Do not open the door if water level can reach the porthole.



8. After each wash program, turn off the tap to prevent leakage; and unplug the washing machine and wipe clean the lower part of the porthole.

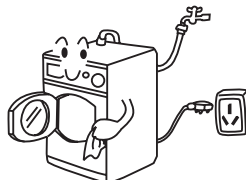

9. Keep the door slightly open when the washing machine is not in use to prevent formation of odors; do not cover the washing machine with plastic cover so that inside dampness cannot be kept in.

10. For appliances with type Y attachment, the instructions shall contain the substance of the following. If the supply cord is damaged, it must be replaced by the manufacturer, its service agent or similarly qualified persons in order to avoid a hazard.

11. The installation instructions shall state that the appliance is to be connected to the water mains using new hose-sets and that the old should not be used. For washing machines with ventilation openings in the base, that a carpet must not obstruct the openings.



# Installation

- Remove all the packing materials to prevent vibration during use. Upon opening of the package, water drops may be seen on the plastic bag and the porthole. This is normal phenomenon resulting from water test in the factory.

- The washing machine requires the following space:

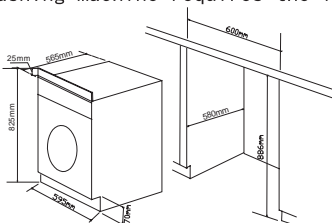

Fig. 1

- Dismantle the packing bolts as shown in Fig. 2. The packing bolts are designed for clamping anti-vibration components inside of the washing machine during the transportation process. Before use:

1. Remove the back plate;
2. Remove the three packing bolts on the back plate and take out the rubber hose;
3. Replace the back plate;
4. Fill the holes left by the packing bolts with plastic plugs.

(Attention: The packing bolts and rubber hose should be kept in a safe place for later use)

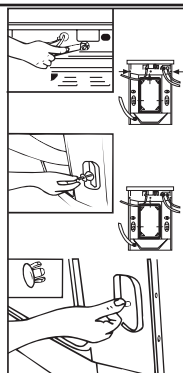

Fig. 2

- Adjusting the washing machine  
With an assistant replace the adjustable feet on the appliance with the four long feet supplied not forgetting to fit a locking nut to each of the four feet. The feet are then to be adjusted to ensure the appliance is level and at the correct height (remember to include the height of the decor strip supplied). as shown in Fig. 3

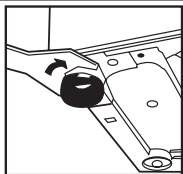

Fig. 3

- A decor strip is to be screwed into position on the fore and top edge of the washing machine if necessary, as shown in Fig. 4

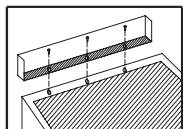

Fig. 4

# Installation

## Fix the door and the magnet assembly

Mount the door with hinges and fix the magnet assembly by screwing with screws to the front of the washing machine and the door, as shown in Fig.1

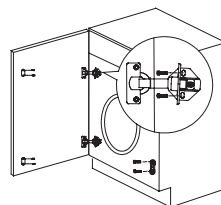

Fig. 1

## Joining the Inlet Hose to the Washing Machine

1. Connect the nut on the inlet hose to the connector on the water valve.
2. Tighten the nut to secure the hose

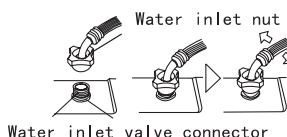

Fig. 2

## Drainage Hose

- The height of the drainage outlet must be 80-100 cm. To prevent the drainage hose from dropping off, fix it to the drainage hose clip at the back of the washing machine.
- Use the drainage holder to keep the end of the drainage hose retained and prevent the outflow of water. It is recommended that the length of the drainage hose not be increased; if an increased length hose is required, please consult a serviceman. The additional hose should be no more than 250cm (overextended hoses could lead to siphonage). Note: The drainage hose should not be submerged in water and should be securely fixed and leak-free.

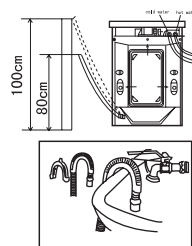

Fig. 3

## Connecting to the Power Supply

Before connecting to the power supply, check:

- The socket is adequate for the maximum power of the washing machine (For safety, fuses in the power circuit should be rated for no less than 13A).
- The voltage should meet the requirement.
- The power outlet should be capable of accepting the washing machine plug. The washing machine must be earthed before use.

# Control panel

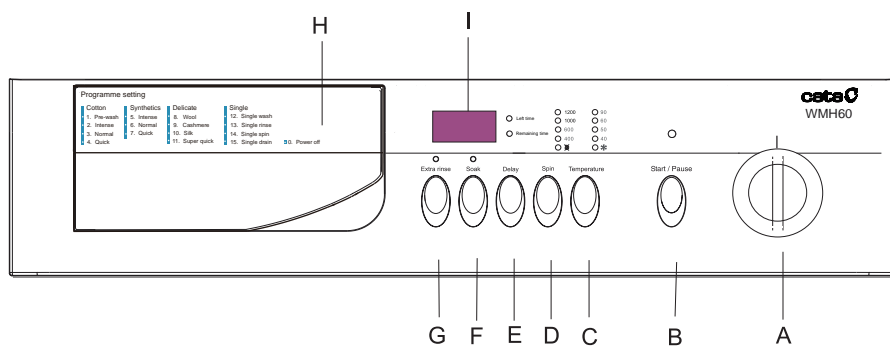

# Operational Functions

## A Wash programming knob

By turning the knob clockwise/counterclockwise, the required program can be selected.  
(Refer to Guide to Operational Program Selection).

Caution: The program knob is at the same time a power button; turn the knob past "0", the power is on.

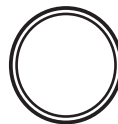

## B Start / Pause button

When the washing machine is plugged and a program is selected, lightly touch this button to start operation. During a wash cycle, touch it lightly, the display will begin blinking and operation will stop. Touch it again to resume operation.

## C Washing temperature knob

Touch this button lightly to select the required temperature (when a temperature is selected, the corresponding indicator will go on).

## D Spinning speed setting button

Touch this button lightly to select the desired speed. There are speed indicators over this button.

Note: Please refer to Guide to Operational Program Selection and Washing Instructions for the required washing temperature and spinning speed for different laundry. If you have no specific requirements, please use default settings.

## E Delay button

Touch this button lightly, the washing machine will start operation after a period of time and the corresponding indicator will go on. The range is 1-19 hours; each touch of this button increases an hour. After the button is set, press the Start / Pause button to start countdown of the delayed time on the display until the start of washing operation at the preset time. Then the washing time left will be displayed.

## F Anti-crease soaking button

Touch this button lightly, the overhead indicator will go on. When the washing machine is at the last rinsing operation, it will not drain but to start a soaking cycle. If you want to spin the laundry, press this button again, the indicator will go off and operation will resume.

Note: Select this function when "Synthetics" or "Delicates" (programs 5-10) is selected.



### G Extra rinse button

Touch this button lightly, the indicator will go on. An additional rinse operation will be activated.

Note: Select this function when "Cotton", "Synthetics", "Wool", "Cashmere" or "Silk" (programs 1-10) is selected.

### H Detergent distribution drawer – Swing-type (see the figure)

Instructions are printed on the handle of the drawer. Open the drawer, three compartments can be seen:

Compartment 1: Pre-wash detergent

Compartment 2: Normal – Quick wash detergent

Compartment 3: Softener, conditioning agent, perfume, etc.

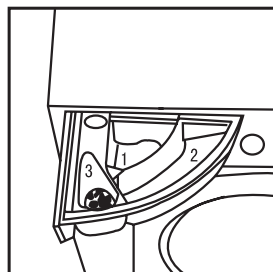

### I Display

After the washing machine is connected to the power supply, the display will go on. The shown time is decreasing during operation of the machine.

# Guide to Operational Program Selection

Mode Selection (Program Knob Position)			Recommended Laundry	Temperature	Default Setting	Default Program Time	Detergent			Remarks
							1	2	3	
Cotton	1	Prewash	Heavy-soil laundry	* ,40℃、 50℃、60℃、 90℃	1200rpm 60℃	2:59	★	★	○	
	2	Intense	Medium-soil	* ,40℃、 50℃、60℃、 90℃	1200rpm 60℃	2:49	×	★	○	
	3	Normal	White cotton fabrics	* ,40℃、 50℃、60℃	1200rpm 60℃	1:49	×	★	○	
	4	Quick	Fast colors and slight-soil cotton fabrics	* ,40℃	1200rpm 40℃	1:31	×	★	○	
Synthetics	5	Intense	Fast colors and heavy-soil laundry	* ,40℃、 50℃、60℃	1000rpm 60℃	1:31	×	★	○	
	6	Normal	Fast colors and medium-soil laundry	* ,40℃、 50℃	1000rpm 50℃	1:16	×	★	○	
	7	Quick	Fast colors and slight-soil laundry	* ,40℃	1000rpm 40℃	1:01	×	★	○	
Delicates	8	Wool	Wool fabrics	* ,40℃	600rpm 40℃	0:50	×	★	○	Max spin speed 600
	9	Cashmere	Cashmere fabrics	* ,40℃	400rpm 40℃	0:50	×	★	○	Max spin speed 400
	10	Silk	Silk fabrics	* ,40℃	400rpm 40℃	0:50	×	★	○	Max spin speed 400
	11	Super quick	Slight-soil cotton, linen and synthetic fabrics	* 40℃	1000rpm 40℃	0:29	×	★	×	
Single	12	Single wash	Cotton, linen and synthetic fabrics	* ,40℃、 50℃、60℃	40℃ ☒	0:45	×	★	×	Separate fast-color and fading laundries
	13	Single rinse		*	1000rpm *	0:26	×	×	○	
	14	Single spin		*	1200rpm *	0:10	×	×	×	
	15	Single drain		*	☒ *	0:03	×	×	×	
	0	Power off	Disconnect the power							

Note: ○ indicates that softener can be added if needed; ★ indicates that detergent must be added; X indicates that detergent must not be added. \* indicates cold water

1) The wash temperature indicates the maximum temperature.

2) The above wash cycle times are intended as a guide only. The actually used time may vary due to different water pressure, initial water temperature, etc.

# Washing Methods

## 1. Loading

Open the door, put in the laundry piece by piece. Close the door tightly.

Notes:

1) When first using the washing machine, let it run unloaded for one program to prevent the laundry from being tainted by oil or dirty water from the washing machine.

2) Do not overload the washing machine.



### Load Reference

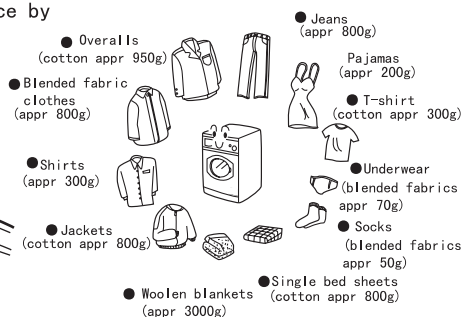

## 2. Adding detergent

Slide out the detergent drawer and put the required detergent, softening agent into the corresponding boxes. Push back the drawer gently.

(Refer to the instructions on the drawer)

Caution:

- 1) Do not add liquid detergent to compartments 1 and 2.
- 2) For pre-washing program, detergent should be added to both compartments 1 and 2. For other programs, do not add detergent to compartment 1.
- 3) Do not overuse softener; otherwise, it will damage the artificial fibers. Refer to the instructions during use.

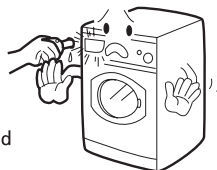

## 3. Selecting washing

To get the best washing effect, an appropriate washing program should be selected according to the laundry type. There are instructions on the handle of the detergent distribution drawer. Please turn the program knob to select the right program.

# Washing Methods

## 4. Setting washing temperature

Please set the temperature knob at the “\*” position if heating is not needed; otherwise, select an appropriate temperature as required (refer to the “Guide to Operational Program Selection” section for maximum washing temperatures).

## 5. Selecting functional

Select a functional button if necessary (refer to the “Operational Instructions” section).

## 6. Washing

Press the Start / Pause button, the washing machine will operate according to the pre-set programs.

## 7. Finish

The washing machine will stop operation automatically when a washing cycle ends. The “End” sign will appear. Open the door and take out the laundry. Then turn off the tap and unplug the power cable.

## Hints for saving energy

### ● During operation

1. Collect clothes for one full wash load.
2. Do not overload the washing machine.
3. Pre-wash heavily soiled clothes.
4. Reduce the amount of detergent or choose standard or delicate wash programs for slightly soiled clothes.
5. Choose a proper washing temperature. Only exceed 60°C for heavily soiled clothes.
6. Do not use more detergent than required.
7. Softening agent makes clothes feel softer and easier to iron.

### ● Other

To add fabric conditioner will not only make the clothes feel soft but also get rid of static condensation to facilitate ironing.

# Washing Instructions

1. Turn the program knob past "0" to switch on the washing machine.
2. If washing operation under the default settings is desired, just press the Start / Pause button after an appropriate program is set.
3. If the default settings are to be changed, refer the following steps:

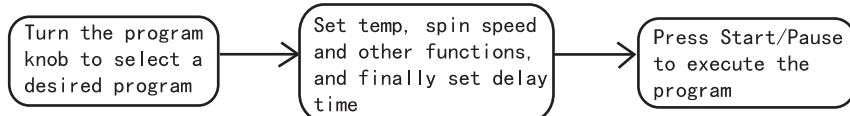

## Other Functions

### Special Functions

1. Control panel lock function: To prevent children from accidentally changing the settings. Press "Anti-crease Soaking" and "Delay" at the same time, this function will work and the "LOCK" sign and the remaining program time will appear alternatively. When this function is on, all other buttons are locked. Press the two buttons again to unlock.
2. Power-off memory function: This machine has power-off memory function. In case of abrupt power failure or the power must be cut off during a program cycle, the present settings will be saved and the preset operation will resume when the power is on again.

Err1: Door is not properly shut.

Correction: Shut the door properly.

Err2: Drainage error, water not emptied within 4 min.

Correction: Clean the filter and check the drain hose for blockage. If error still exists, please contact the maintenance personnel.

Err3: Temperature sensor short circuit or open circuit.

Correction: contact the maintenance personnel.

Err4: Water fails to meet the specified level within 8 minutes.

Correction: Check the tap and the water pressure; if error still exists, please contact the maintenance personnel.

Err5: Water exceeds protective level.

Correction: Contact the maintenance personnel.

Err7: motor error.

Correction: Contact the maintenance personnel.

End: End of a wash cycle.

1:25: Status information: Remaining program time.

19:25: Status information: Preset time for delayed operation.

## Maintenance

1. Turn off the water tap and pull out electricity plug after each wash. Open the porthole to prevent formation of moisture and odors. If the washing machine is left idle for a long period, drain the water in the machine and replace the drainage hose.



2. Unplug the machine during cleaning and maintenance. Use a soft cloth dampened with soap liquid to clean the machine case and rubber components. Do not use organic chemicals or corrosive solvents.

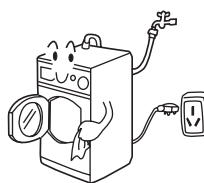

3. Clean the detergent distribution drawer regularly.

Swing out the drawer, flush it clean with water and then replace it.

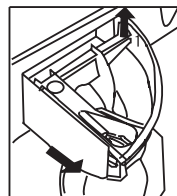

4. Clean the filter (once a month)

- 1) Pull out the bottom cover;
- 2) Remove the filter by turning counterclockwise;
- 3) Flush clean with running water;
- 4) Replace the filter by turning clockwise and remount the cover.

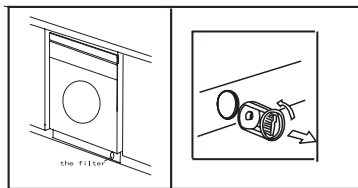

# Maintenance

5. To prevent blockage to the water supply by ingress of foreign substances, clean the water inlet and inlet filter regularly.

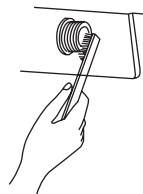

6. If the machine is to be moved to a distant place, replace the vibration absorbing locks (packing screws, rubber gaskets) removed before installation to prevent damage as shown below.

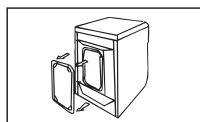

Remove the back cover and take out the three rubber plugs.

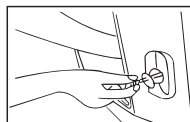

Insert the channel steel vibration locks and the

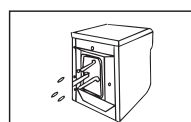

Insert the rubber bolt gaskets.

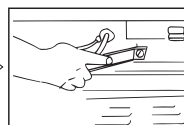

Tighten the bolts with a spanner .

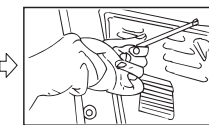

Replace the back cover.

7. If the washing machine is left idle for a long period, pull out the electrical plug and turn off the water tap. Open the door to prevent formation of moisture and odors. Let the door open while not used.

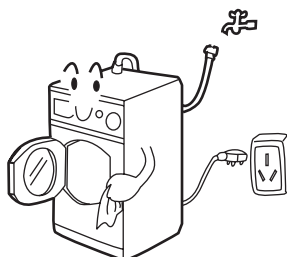

# Troubleshooting

The following circumstances do not constitute problems. Do not contact the maintenance service until the problem has been confirmed.

Problem	Possible cause
The washing machine fails to operate	<ul style="list-style-type: none"> <li>● Poor connection to power supply</li> <li>● Power failure</li> <li>● Door is not properly closed</li> <li>● Machine has not been switched on</li> </ul>
Washing machine cannot be filled with water	<ul style="list-style-type: none"> <li>● Water tap is not turned on</li> <li>● Water pressure is less than 0.03MPa</li> <li>● The inlet hose is kinked</li> <li>● Water supply failure</li> <li>● The program dial is not properly set.</li> <li>● The door is not properly closed</li> <li>● The inlet hose filter is blocked</li> </ul>
The machine is draining while is being filled	<ul style="list-style-type: none"> <li>● The height of the drainage hose is below 80cm (it should be within 80-100cm)</li> <li>● The drainage hose end is in water</li> </ul>
Drainage failure	<ul style="list-style-type: none"> <li>● Drainage hose is blocked</li> <li>● Drainage hose end is over 100cm above the floor level</li> <li>● The filter is blocked</li> </ul>
Strong vibration during spin drying	<ul style="list-style-type: none"> <li>● Not all packing bolts have been removed</li> <li>● Washing machine is located on an uneven surface or is not level</li> <li>● Machine load is over 6kg.</li> </ul>
Operation stops before completion of a wash cycle	<ul style="list-style-type: none"> <li>● Water or electricity failure</li> <li>● Washing machine is in soaking cycle</li> </ul>
Operation stops for a period of time	<ul style="list-style-type: none"> <li>● Washing machine is in anti-crease soaking cycle</li> <li>● Washing machine gives an error message.</li> </ul>
Excessive foam in the drum, which is spilled to the distribution drawer	<ul style="list-style-type: none"> <li>● The detergent is not a low-foaming type or for manual wash</li> <li>● Excessive use of detergent</li> </ul>



# Electric Circuit Diagram

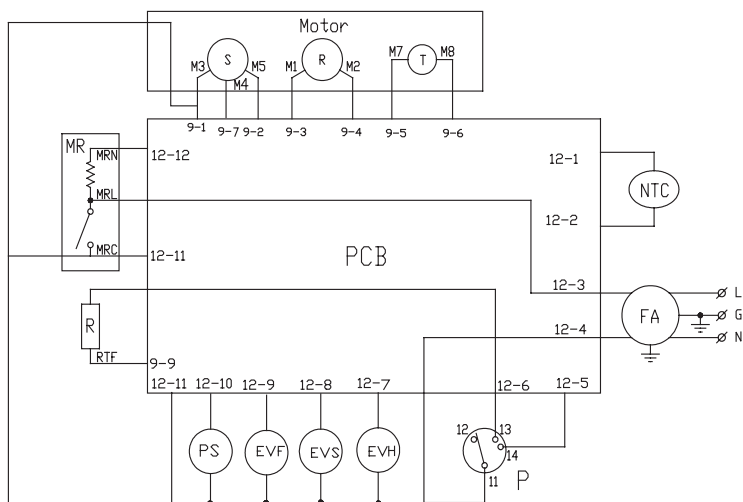

Motor – Motor

PCB – Printed Circuit Board

MR – Door Lock

R – Heating Element

PS – Drainage Pump

EVF, EVS, EVH – Water Inlet Magnetic Valve

P – Pressure Switch

FA – Interference Suppressor

NTC – Temperature Sensor



The symbol  on the product or on its packaging indicates that this product may not be treated as household waste. Instead it shall be handed over to the applicable collection point for the recycling of electrical and electronic equipment. By ensuring this product is disposed of correctly, you will help prevent potential negative consequences for the environment and human health, which could otherwise be caused by inappropriate waste handling of this product. For more detailed information about recycling of this product, please contact your local city office, your household waste disposal service or the shop where you purchased the product.

# Specifications

Item \ Model	WMH60
Power supply	220-240V/ (50Hz)
Max working current (A)	10
Water pressure (MPa)	$0.03 \leq P \leq 1$
Washing power (W)	200
Spinning power (W)	550
Rated load (Kg)	6
Spinning speed (R/Min)	1200
Washing programs	15
Power (Max)	1950
Dimension (H×D×W mm)	825X565X595
Weight (Kg)	72

## CNA TRADING APPLIANCES

### Customer Service

In case of difficulty please call the Customer Service Helpline on our helpline number.

**0844 8001128**

When calling customer service, please ensure you have the model and serial number to hand.  
Please keep your receipt or invoice in a safe place as they will be required as proof of date of purchase.

