



Double Oven:AMFTC72SS

Version:01

Date:2017-05-28

Product reference code: AMFTC72SS

AMFTC72SS Exploded drawing

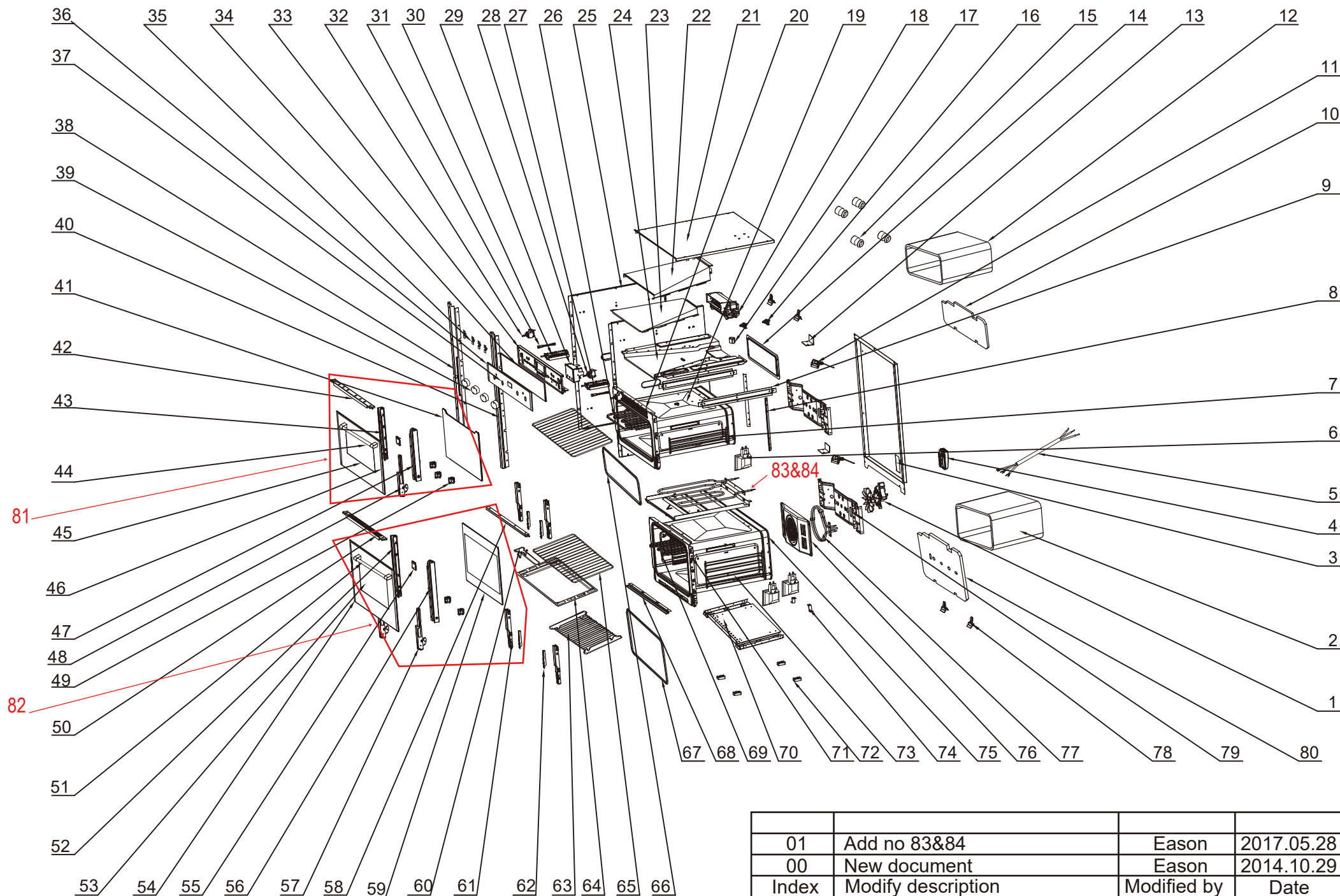

01	Add no 83&84	Eason	2017.05.28
00	New document	Eason	2014.10.29
Index	Modify description	Modified by	Date

AMFTC72SS parts list

NO.	Part code	Part description	QTY
1	33315002	grill fan assembly	1
2	33120002	heat preservation fibre	1
3	33030021	back cover board	1
4	33005016	terminal box	1
5	32307016	power cord--European style	1
6	33317001	Square lamp assembly	3
7	33140011	side rack	2
8	33027012	connect board for top and bottom cavity	2
9	33027014	fixing panel for exhausting pipe base board	2
10	33121002	heat preservation fibre	1
11	33311013	overheat protector(From June 2015 to stop using)	2
	36154001	Top Thermostat 110C° (From June 2015 to start using)	1
	33308027	Bottom over heat protector100℃ (From June 2015 to start using)	1
12	33120002	heat preservation fibre	1
13	33004010	fixing bracket for overheat protector	2
14	33001037	back catalytic line	1
15	33141002	guide rail bracket fixing axis	4
16	33310003	heat dissipation thermostat	2
17	33215013	exhausting pipe	1
18	33313020	cooling fan assembly	1
19	33058091	top cavity assembly	1
20	33018113	cavity panel	1
21	33031014	top cover plate	1
22	33028004	exhausting pipe top cover board	1
23	33026004	exhausting pipe middle cover board	1
24	33027002	exhausting pipe base board	1
25	33033017	side plate (left&right)	2
26	33303006	top heating element	1
27	33301037	function switch	1
28	33311018	temperature adjuster	1
29	33300016	sensor touch timer (3 button)	1
30	33301034	function switch	1
31	33312001	indicator light	2
32	33311008	temperature adjuster	1
33	33018148	fixing panel for switch	1
34	90134002	single adhesive tape	1
35	33006001	connect board switch	4
36	34039003	the S.S trim for control panel	1
37	33101364	control panel assembly	1
38	33014092	right bracket for out cover plate	1
39	32244031	knob.21	4
40	33014093	left bracket for out cover plate	1
41	33103045	inner glass(top door)	1
42	33014087	door frame top bracket	1
43	33014080	door frame left bracket	1
44	33190001	hanld H1	1
45	33102520	door panel	1
46	33015297	S.S trim for door panel	1
47	33014079	door frame right bracket	1
48	33180020	hing 14 assembly	2
49	33014049	fixing panel for inner glass	2
	33014050	fixing panel for inner glass	2
	33014142	fixing panel for inner glass	1
50	33014043	top bracket for oven door	1
51	33190001	hanld H1	1
52	33014084	door frame left bracket	1
53	33102521	door panel	1
54	33015296	S.S trim for door panel	1
55	33006012	fixing board for handle	2
56	33014083	door frame right bracket	1
57	33180021	hinge 15 assembly	2
58	33027015	cavity panel connector	1
59	33103046	inner glass	1
60	33172001	handle for rack	1
61	33024006	side bracket for cavity(left&right)	2
62	33005014	fixing board for hinge	4
63	33170003	grill rack for baking tray	1
64	33224003	baking tray	1
65	33170001	grill rack	2
66	33803013	door seal assembly	1
67	33803014	door seal assembly	1
68	33027016	bottom support for cavity panel	2
69	33303006	top heating element	1
70	33029015	bottom cover plate	1
71	33018149	cavity panel	1
72	33237030	the support for bottom cover plate	4
73	36038003	side rack	2
74	33006063	the bottom support for cavity	2
75	33058092	cavity assembly	1
76	33001022	the cover plate for back heating element	1
77	33303040	rear heating element	1
78	33035001	thermostat switch sensor fixer	10
79	33016001	back bracket for cavity	2
80	33121002	heat preservation fibre	1
81	AMFTC72SXUDR	complete upper door assembly	1
82	AMFTC72SXLDR	complete lower door assembly	1
83	33303039	Top Oven bottom heating element	1
84	33303002	Bottom Oven bottom heating element	1

