

COOKETM &LEWIS

Washing Machine

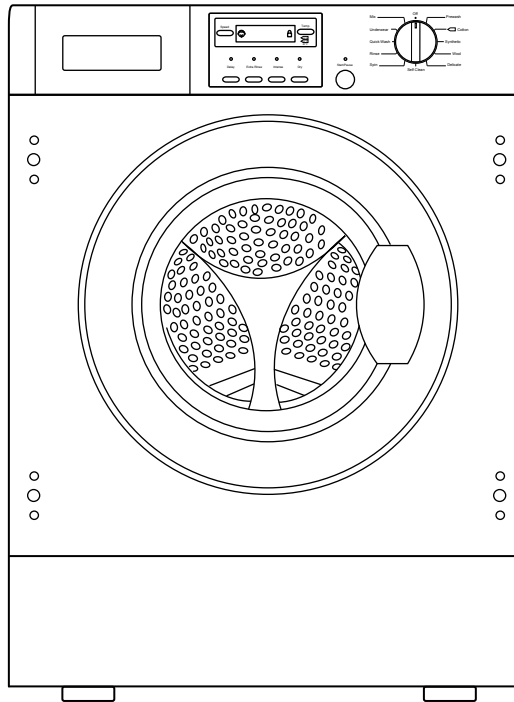

BWM60CL - Version: 01



Washing Machine - Barcode: 5052931258543



WARNING: Read the instructions before using the appliance.

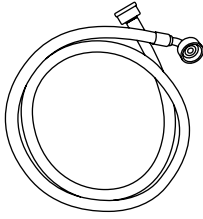

[01] x 1

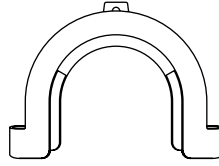

[02] x 1



[03] x 1

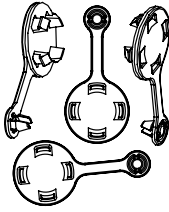

[04] x 4

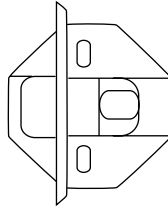

[05] x 2

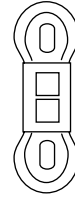

[06] x 2



[07] x 2

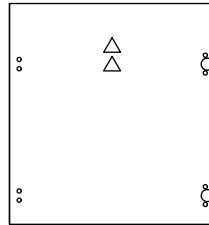

[08] x 1

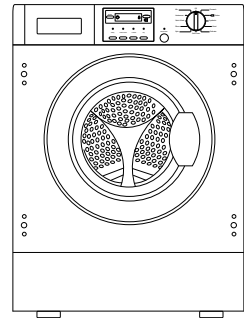

[09] x 1

1 : 1



[10] x 8 (3 x 12mm)

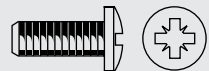



[11] x 8 (5 x 12mm)

BWM60CL Washing Machine

Let's get started...

These instructions are for your safety. Please read through them thoroughly before use and retain them for future reference.

	Getting started...	04
	Your product	04
	Safety	05
	In more detail...	09
	Operation	09
	Care and Maintenance	22
	Troubleshooting	27
	Technical and legal information	34
	Recycling and disposal	34
	Guarantee	35
	CE Declaration of Conformity	37
	Appendix...	
	Installation	38

Your product

BWM60CL Washing Machine

Your product

Unpacking your appliance

Remove all the packing materials to prevent unsteadiness, including the polystyrene base. Upon opening the package, water drops may be seen on the plastic bag and the porthole. This is normal phenomenon resulting from water tests in the factory.

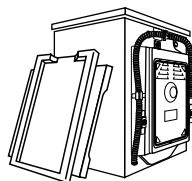

Description

This diagram may be slightly different from the layout of the washer dryer you have just purchased due to technical improvements.

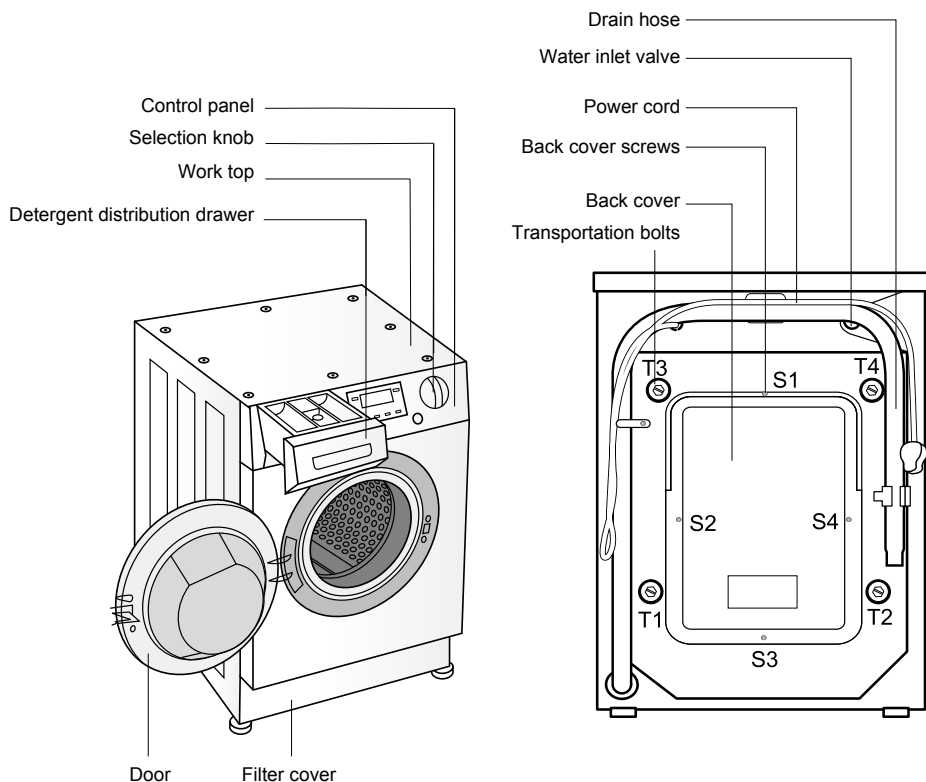

You will need

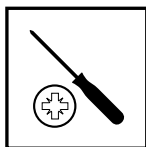
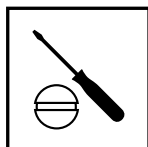

Installation guide
located at the end of
the guidebook

Safety



Warning

Your safety is of the utmost importance to us. Please make sure that you read this instruction booklet before attempting to install or use the appliance. If you are unsure of any of the information contained in this booklet, please contact Customer Services.

General safety

- ✓ Repairs to your appliance must only be carried out by one of their authorised service engineers. Any attempt by an inexperienced person to repair the appliance, could result in injury or damage to your washing machine or invalidate the warranty.
- ✓ If you notice that the mains cable is damaged. ***The appliance must not be used.*** The same applies if you notice that the worktop, control panel, base area or any part of the cabinet is damaged. As this could allow access to the internal components of the machine.
- ✓ The appliance should be turned off and isolated from the mains supply, before either cleaning or maintenance work is attempted.
- ✓ The mains cable must not be used to pull the plug out of the electrical socket.
- ✓ The machine should not be sprayed with water.

- ✓ The glass of the porthole door may become hot during the higher temperature wash programmes.
- ✓ The machine should be allowed to cool before carrying out an emergency drain or cleaning the drain filter.
- ✓ It is possible for small animals to chew either mains cables or water hoses, which could cause an electric shock hazard.

Installation

- ✓ The installation instructions contained within this user manual should be followed.
- ✓ **It is obligatory for the completed installation to comply with all relevant building regulations and local water authority requirements.**
- ✓ ***Before the first use of the appliance, we advise that a 90°C wash programme is completed, using the 'self clean' function. No garments should be placed inside the machine; however a small amount of detergent must be used.***

During use

- ☑ It is recommended that the appliance is unplugged and the water supply is turned off after the machine is used.
- ☑ This appliance is only designed to wash normal domestic washloads.

If you use your washing machine in any other way or it is incorrectly used, then the manufacturer accepts no liability for any damage that might be caused and any guarantee will be void.
- ☑ No attempt should be made to alter or modify the specifications of this appliance.
- ☑ The detergents that you place in this appliance should be suitable for automatic washing machines. With regards to dosage levels, the detergent manufacturer's recommendations should be followed.
- ☑ You should not wash garments that have been in contact with flammable materials.
- ☑ Your washing machine should not be used for dry cleaning.
- ☑ If you use either dyes or bleaching agents inside this machine, then you should consult with the manufacturer of these products to make sure they are suitable for use in your washing machine. The manufacturer cannot be held responsible for any damage that may result.

Safety

- ☒ If the supply cord is damaged, it must be replaced by the manufacturer, its service agent or similarly qualified persons in order to avoid a hazard
- ☒ This appliance is not intended for use by persons (including children) with reduced physical, sensory or mental capabilities, or lack of experience and knowledge, unless they have been given supervision or instruction concerning use of the appliance by a person responsible for their safety.

Child safety

- ☒ Your washing machine should only be used by adults. You should not allow children in the area of the machine unsupervised. You should not let them touch the controls or play with the appliance.
- ☒ It could be possible for a child or pet to gain access to the washing machine through the porthole door. Therefore please check the drum before using the appliance.
- ☒ Any packaging that is removed from the machine should be kept away from children.
- ☒ All detergents should be kept out of children's reach in a safe place.

Product specifications

- 11 wash programmes
- 6kg wash load
- 1200 rpm maximum spin speed
- LED display
- Delay start timer
- Digital countdown indicator
- Spin and temperature selection buttons
- Child lock
- Stainless steel drum
- Adjustable feet
- Error code failure system
- Overflow protection
- Foam protection
- Imbalance control system
- Self-clean function (drum cleaning)

Energy efficiency

Energy rating	A++
Wash performance	A
Water extraction performance	B

Operation

BWM60CL Washing Machine

Control panel

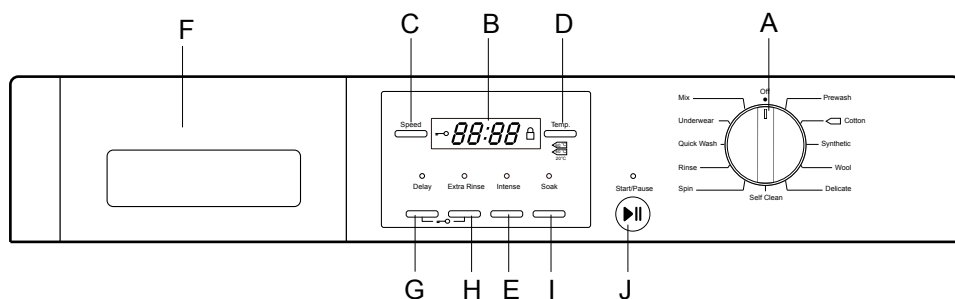

- | | | | |
|---|-------------------------------|---|--------------------|
| A | Wash programme selection knob | F | Detergent drawer |
| B | LED display | G | Delay wash button |
| C | Spin speed selection button | H | Extra rinse button |
| D | Temperature selection button | I | Rinse hold button |
| E | Intense wash selection button | J | Start/Pause button |



Note: Buttons E, G, H, I & J have LED neon lights above them to indicate if they are activated.



Note: Not all optional functions are available for every wash programme.

Wash programme selection knob

- Turning the control knob anti-clockwise or clockwise allows you to turn on the appliance and then select the wash programme of your choice.

Start/Pause button

- Once a wash programme has been selected, this button should be pressed to start the wash cycle. It can also be used to pause a wash cycle that is in progress.

LED display

- The LED display will show how much time a wash cycle has left until it completes. If the delay start button has been pressed, then the LED display will show the remaining time until the wash cycle will complete.
- The display will also show temperature setting value, spin speed value, child lock state, door lock state, wash progress, and alarm messages.

Temperature selection button

- Press this button to select the temperature that you require for a particular wash programme. This will be displayed in the LED display. ("--" (cold), 15°C, 20°C, 30°C, 40°C, 50°C, 60°C, 90°C).

Spin speed selection button

- Press this button to select the spin speed that you require for a particular wash programme. This will be displayed in the LED display.

Delay wash button

- Press this button to delay the wash programme for a maximum of 24 hours. Each press will increase the delay time by 30 minutes. This will be displayed in the LED display.

Rinse hold button

- Press this button to select the rinse hold wash programme option.
- When the wash cycle reaches the final rinse, instead of draining the water, it will suspend the clothing in cold water. This option allows you to drain and spin the wash load at a later time, and will help to prevent the clothes from creasing. Press start to resume the cycle.

Extra rinse option button

- Pressing this button will mean the appliance will perform an additional rinse at the end of the wash cycle.
- Press once for one additional rinse - "P-1" will show in the display. Press twice for two additional rinses - "P-2" will show in the display. Press three times for three additional rinses - "P-3" will show in the display.

Intense wash button

- Press this button to select the "intense" wash programme option.
- The appliance will then increase the washing time of the main wash.

Detergent drawer

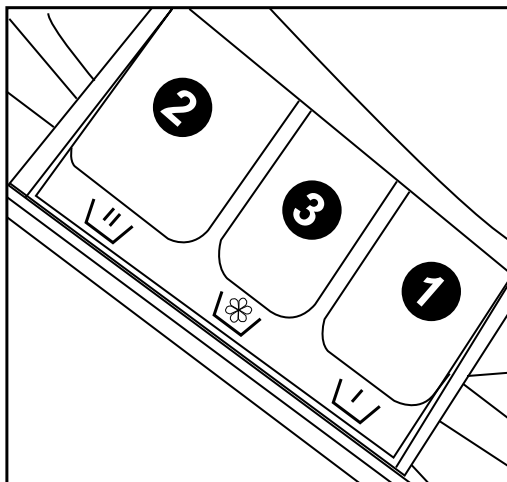

1) Prewash section

This compartment should have detergent placed in it only if you are going to select a wash programme that has a prewash cycle as part of it.

2) Main wash section

This compartment should have detergent placed in it (you should also put a water softening agent in this section, if you use one). The detergent will be added to the drum at the start of the main wash programme.

3) Conditioner section

This compartment should be used for liquid conditioners (fabric softener, starch). They will be added to the wash load during the final rinse.



Note: Liquid detergent should not be placed in sections 1 or 2 of the detergent drawer.

Preparing the wash cycle

Preparing your garments for washing

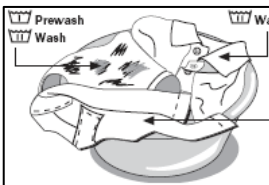
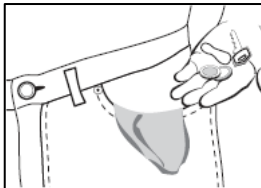
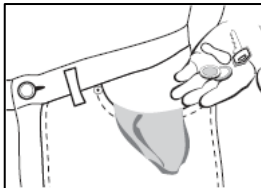
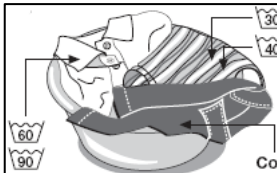
- Your washing should be sorted out, according to the fabric type and the wash care symbol that is printed on the garment's wash care label (see separate section "a selection of wash care symbols").
- 
- Your washing should also be sorted out according to the degree of soiling.
- 
- Check all pockets on garments to make sure that they are empty.
- 
- Remove any detachable metal items (badges, paperclips, safety pins etc).
 - Zips should be closed, duvet covers and pillow cases should be buttoned up and any loose straps should be tied up. This will help to prevent other garments from getting damaged during the wash.
 - Woollens and knitted coloured fabrics should be turned inside out before being washed in the appliance.
 - Small delicate items (tights, baby socks, etc) should be placed in either a washing net or a zipped pillow case.
 - Curtains should be handled with particular care. All plastic hooks or metal strips must be removed before being washed in the appliance.
- 
- Coloured items and whites should be washed in separate wash cycles.
- 
- New garments often contain an excess of dye, therefore it is advisable to wash them separately for their first wash.
 - Garments should be unfolded and shook out before being placed inside the machine.

A selection of wash care symbols

Washing							
	Boiling temp 95°C	Normal temp 60°C	Normal temp 40°C	Delicate temp 40°C	Delicate temp 30°C	Hand wash only	Wool seal
	Do not wash!	Bleachable in cold water	Do not bleach!				
Dry cleaning							
	All solvents	All but TRI	Benzine only	Do not clean!			
Spin dryer							
	Normal	Low	High	Do not dry!	Hang to dry	Drip dry	Dry flat
Ironing							
	110°C	150°C	200°C	Do not iron!			

- The wash care symbols should be used to help you to select the most suitable wash programme. They will also help you to sort your laundry into different loads, depending on the fabric type and the highest temperature which the garment can be washed at.
- If the wash care label does not appear in the above table, then please refer to the washing machine programme chart. This gives more detailed descriptions of the types of fabric that are suitable to be washed using a particular wash programme.

Detergents and conditioners



Note: Only detergents suitable for use in automatic washing machines should be used.

The amount of detergent that you need to use in your appliance, will depend on:

- **The degree of soiling.** Lightly soiled garments in general require less detergent.
- **The size of the wash load.** A smaller wash load will require a reduction in the amount of detergent.
- **The hardness of your tap water.** The harder your water is, then the more detergent you will need to use. The detergent manufacturers normally give guidance as to how much extra detergent should be used, depending on the hardness of the water.

Low temperatures

- The enzymes in biological washing detergents work best at low temperatures to provide excellent cleaning and stain removal results but not as low as 20°C.
- Liquid or gel detergents are particularly suitable for low temperature washing as they dissolve easier and quicker than powders or tablets.

Water softening agents

If your tap water is hard, then it may be prudent to utilise a water softening agent. This will help to ensure that the appliance does not become clogged with hard water deposits. You may also find that it will allow you to lessen the amount of detergent that you are using.



Warning

When using any detergent or water softening agent, the recommendations of the manufacturer should be followed.

Wash programme table

The wash cycle times are intended as a guide only. The actual time used may vary due to different water pressure, initial water temperature, etc.

Program	Max. Load	Temperature	Energy Consumption	Water Consumption	Washing Time	Spin Drying Performance
Prewash	6kg	40°C	/	/	2:04	/
*) Cotton	6kg	60°C	0.808kWh	57.7L	3:00	53%
*) Cotton	3kg	60°C	0.811kWh	45.0L	3:00	/
*) Cotton	3kg	40°C	0.602kWh	43.5L	2:49	/
Synthetics	3kg	40°C	/	/	1:10	/
Wool	1kg	--	/	/	0:45	/
Delicates	1kg	--	/	/	0:45	/
Selfclean	/	90°C	/	/	1:00	/
Spin	6kg	/	/	/	0:12	/
Rinse	6kg	/	/	/	0:24	/
Quick	2kg	--	/	/	0:15	/
Underwear	3kg	60°C	/	/	1:51	/
Mix	6kg	30°C	/	/	1:12	/
*) Energy label program settings: 1. "Cotton+ 40°C+Intense Max speed" 2. "Cotton+ 60°C+Intense Max speed"						

The standard 40° and 60° cotton programmes are suitable to clean normally soiled cotton laundry and they are the most efficient programmes in terms of combined energy and water consumption. The actual water temperature may differ from the declared cycle temperature.



Note: The wash cycle times that are quoted and shown by the LED display, are intended as a guide only. Please note that factors external to the machine, e.g. the temperature of your water supply, your water pressure etc. can affect the time it takes for the wash cycle to complete.

Wash programme table

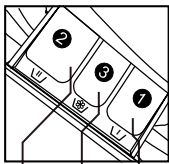
	Program	Temperature					Recommended laundry	Preset spin speed/rpm
		Maximum	Preset	2	3	1		
1	Prewash	-- to 90°C	40°C	<input checked="" type="checkbox"/>	<input type="checkbox"/>	<input checked="" type="checkbox"/>	Heavy soiling	1000
2	Cotton	-- to 90°C	40°C	<input checked="" type="checkbox"/>	<input type="checkbox"/>	<input checked="" type="checkbox"/>	Cotton fabrics	1000
3	Synthetic	-- to 60°C	40°C	<input checked="" type="checkbox"/>	<input type="checkbox"/>	<input checked="" type="checkbox"/>	Fast colour synthetics	1000
4	Wool	-- to 40°C	--	<input checked="" type="checkbox"/>	<input type="checkbox"/>	<input checked="" type="checkbox"/>	Woolen fabrics	600
5	Delicates	-- to 40°C	--	<input checked="" type="checkbox"/>	<input type="checkbox"/>	<input checked="" type="checkbox"/>	Cotton or synthetics	600
6	Selfclean	90°C	90°C	<input checked="" type="checkbox"/>	<input checked="" type="checkbox"/>	<input checked="" type="checkbox"/>	/	1000
7	Spin	--	/	<input checked="" type="checkbox"/>	<input checked="" type="checkbox"/>	<input checked="" type="checkbox"/>	/	1000
8	Rinse	--	/	<input checked="" type="checkbox"/>	<input type="checkbox"/>	<input checked="" type="checkbox"/>	/	1000
9	Quick	-- to 30°C	--	<input checked="" type="checkbox"/>	<input type="checkbox"/>	<input checked="" type="checkbox"/>	Slight-soil cotton, linen and synthetic fabrics	800
10	Underwear	-- to 90°C	60°C	<input checked="" type="checkbox"/>	<input type="checkbox"/>	<input checked="" type="checkbox"/>	Cotton fabrics	1000
11	Mix	-- to 60°C	30°C	<input checked="" type="checkbox"/>	<input type="checkbox"/>	<input checked="" type="checkbox"/>	Different materials	1000
<input checked="" type="checkbox"/> Yes <input checked="" type="checkbox"/> No <input type="checkbox"/> Optional								

Wash programme guidance

- The default setting column shows the wash temperature and spin speed that the appliance will automatically select for a particular wash programme. It is possible to override these settings, using the spin speed selection button and temperature selection button.
- **Important:** You should make sure that the spin speed and temperature that you select are appropriate for the garments that you are washing.
- The wash cycle times that are quoted and shown by the LED display, are intended as a guide only. Please note that factors external to the machine, e.g. the temperature of your water supply, your water pressure etc., can affect the time it takes for the wash cycle to complete.
- If you select the rinse hold option, the machine will not spin the clothing at the end of a wash cycle. If you pick this option, then the machine will stop with water inside of the drum.
- **Important:** Before opening the door of the appliance, you **MUST** press the start/pause button to resume the wash cycle which will drain the remaining water.

Selecting a wash programme

1. Load your laundry and put detergent in the relevant compartment(s) of the detergent drawer.
2. Close the porthole door firmly.
3. Select the most appropriate wash programme for the garments that you are washing, by turning the programme selector knob.
The washing machine will automatically select a spin speed and wash temperature for the wash programme that you have chosen.
4. If you press the spin selection button you can adjust the spin speed. The LED display will show the spin speed that you have chosen.
5. If you press the temperature selection button you can adjust the wash temperature. The LED display will show the wash temperature that you have chosen.
6. Select any programme options that you require (Rinse Hold, Extra Rinse, Delay Start and Intense Wash) by using the relevant buttons.
Any programme option that you select, will affect the length of time that the wash cycle will take to complete.
7. Press the Start/Pause button.
After approximately 5 seconds, you will hear your washing machine start the cycle.
Throughout the cycle, the LED display will countdown the remaining time of the cycle that is in progress.

Selecting a wash programme



Note: If there is a power failure or the plug is pulled out of the socket when a wash cycle is in progress. Once power has been restored, the wash programme will continue.

At the end of a wash cycle

- The washing machine will stop automatically when it has completed a wash cycle.
- The LED display will show the word "End".
- At the end of the drain programme, the door will remain locked for 2 - 3 minutes before it is possible to open the door and take out the garments.

Pausing a wash programme

1. Press the Start/Pause button whilst a wash cycle is in progress and the appliance will go into pause status.
In pause status, the Start/Pause indicator neon will be light.
2. Press the Start/Pause button again and the wash cycle will continue.

Cancelling a wash programme

- Press the Start/Pause button whilst a wash programme is in progress and the appliance will go into pause status.
Turn the wash programme selection knob until it is at the 'OFF' position.



Warning

Before opening the porthole door, you **MUST** drain the appliance; otherwise there may still be water in the drum when you open the door.

- Turn the wash programme selection knob to the spin programme then press the Start/Pause button.
- The appliance will then drain the water that is left in the drum and spin the clothes.
- The washing machine will stop automatically when it has completed the spin cycle.
- At the end of the spin programme, the door will remain locked for 2 – 3 minutes before it is possible to open the door and take out the garments.

Spin speed selection button

- If you press the speed selection button, then the spin speed be displayed and each press will scroll through the speed options for that particular wash programme.

Selecting a wash programme

Temperature selection button

- If you press the temperature selection button the wash temperature will be displayed. By pressing the temperature button you can scroll through the temperature options for the chosen wash programme.

Rinse Hold option button

- If you press the Rinse Hold option button, the indicator neon above it will light.
- When the wash cycle reaches the final rinse, instead of draining the water away, it will suspend the wash load in cold water.
- When you want to spin the wash load, press the Rinse Hold option button again. The indicator neon will go out and the spin stage of the wash cycle will take place.

Extra rinse option button

- If you press the extra rinse option button, the indicator neon above it will light.
- If you select this option, an additional rinse will be performed for the selected wash programme.

Delay wash programme

- If you press the delay start button you can programme the wash cycle to commence at a period of time in the future.
- You should select your wash programme as normal, but instead of pressing the Start/Pause button to get the wash cycle to commence. You should press the delay start button.
- Each time the delay start button is pressed, the length of time will increase by 30 minutes.
- It is possible to delay the start of the wash cycle by a maximum of 24 hours.



Note: The displayed delay time is THE END time of the washing programme, therefore the delay time **MUST** be longer than the programmes running time. For example, "06:00" means the wash programme will end in 6 hours. If the wash cycle is 01:30 hours, then the actual delay time will be 4 hours and 30 minutes.

- Press the Start/Pause button and the countdown time will commence. The LED display will countdown the remaining time until the wash cycle commences.
- Once the delay start time has been reached, the wash programme that you have previously selected will start. The LED display will then countdown the remaining time of the wash cycle that is in progress.

Selecting a wash programme

Intense wash button

- Press this button to select the “intense” wash programme option.
- The appliance will then increase the washing time of the main wash.
- The increased time will depend on the wash cycle and the temperature, or any other selected options, however the time remaining will be displayed.

Child lock

- Your appliance has a child lock option. If this is set, it will mean that the control panel is locked and nobody can affect the operation of the wash programme once it has started.
- The child lock should be activated once a wash programme and any programme options that you wish to use have been selected.
- Press the Start/Pause button to commence the wash cycle. Then press the delay button and the Extra Rinse button simultaneously for three seconds.
- The child lock symbol will appear on the LED display.
- When the child lock is engaged, all other buttons on the control panel are disabled.
- To switch the child lock off, you should press the Extra Rinse button and the delay button simultaneously again for three seconds. The child lock symbol will go out.

Door lock

- Your appliance has a door lock which will be activated at the beginning of a wash cycle to prevent access to the machine while it is operating. You must wait until this symbol has gone out before attempting to open the door.

Power off memory

- If there is an abrupt power failure, the power off memory remember the preset or running operation and will resume when the power is restored.

Care and Maintenance

In daily use

- Once a wash cycle has completed, you should pull out the detergent drawer slightly, so it can dry out.
- Leave the porthole door ajar for a short while after a wash cycle has completed. This should help to prevent stagnant smells and to protect the door seal.
- Close the water tap.
- We suggest that you disconnect the appliance from your mains supply, when it is not in use.

Control panel and washing machine cabinet



Caution: Do not use any abrasive cleaner or household polish on either the control panel or operating parts.

- Wipe over the control panel and the external surface of the machine using a brand new damp cloth with warm water.
- If you ever spill any liquid detergent or conditioner from the detergent drawer onto the washing machine cabinet, then these should be cleaned up immediately as they could be corrosive.

Detergent drawer

Occasionally the detergent drawer should be cleaned.

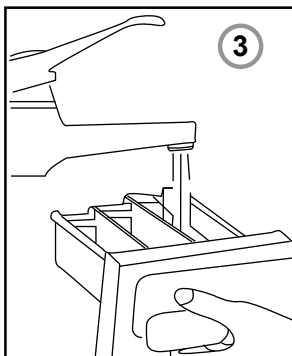
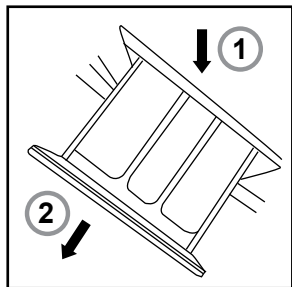

- Open the detergent drawer and then remove the drawer by depressing the central button (1) and pulling it forward (2).
- Use warm water and a brush to thoroughly clean the three compartments of the detergent drawer (3).
- Clean the area that the detergent drawer slides into with a brush.
- Replace the detergent drawer by placing it back into the slot. Then slide the drawer fully back into position.

Care and Maintenance

The washing machine drum

The drum of your washing machine is constructed from stainless steel. However if there are objects that can rust placed inside the drum, then it is possible for the drum to become stained.



Caution: Do not use a de-scaling agent, iron/steel wool or scouring agents to clean the drum of your appliance.

- Remove any rust stains on the drum with an appropriate stainless steel cleaning agent.

Door

- You should regularly check to see if any deposits have formed, or there are any foreign bodies in the rubber door gasket. This sits inside the opening of the porthole door.

The appliance must be accessible for the engineer to perform any necessary repair. If your appliance is installed in such a way that an engineer is concerned that damage will be caused to the appliance or your kitchen, then they will not complete a repair.

This includes situations where appliances have been tiled in, sealed in with sealant, have wooden obstructions placed in front of the appliance - like plinths, or any installation other than the one specified by the manufacturer has been completed.

Please refer to the conditions of guarantee that appear on the warranty card that you receive with the appliance.



Note: The manufacturer operates a policy of continuous improvement and reserves the right to adjust and modify its products without prior notification.

Cleaning the drain pump filter

**Warning**

Switch off your washing machine and disconnect the plug from your mains supply.

**Warning**

Do not perform this operation if the appliance has stuck on a cycle, until the water inside of the machine has cooled sufficiently. Otherwise the water that comes out of the drain pump filter may still be hot.

You should clean out the filter approximately once every month. If the drain pump filter is not cleaned regularly, then your appliance may find it difficult to pump out water efficiently.

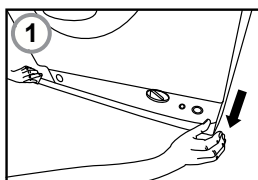

- 1) Open the service panel.
Locate the drain pump filter in the bottom right hand corner of the appliance.

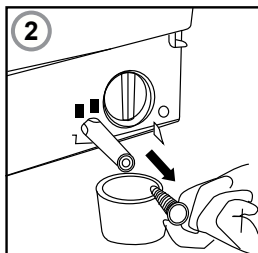

- 2) Pull out the bail tube that is to the left of the drain pump filter. Place the end of the tube into an adequately sized bowl. Remove the bung from the end of the tube.

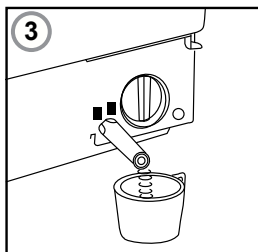

- 3) Drain the water.

Cleaning the drain pump filter

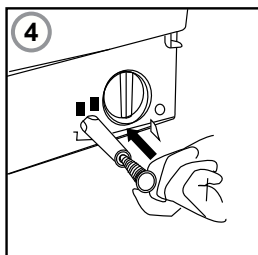

- 4) Replace the bung once the excess water has drained.

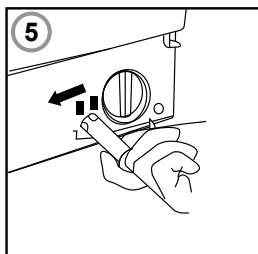

- 5) Push the bail tube back into the appliance.

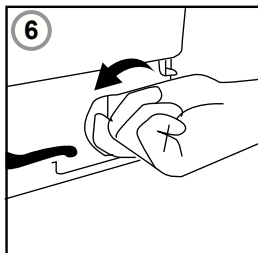

- 6) Place a towel on the floor below the filter to absorb any small amount of water that may remain in the filter housing. Unscrew the filter and remove.

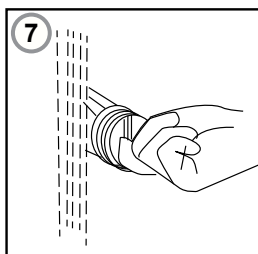

- 7) Wash the filter with running water and ensure that all debris has been removed.

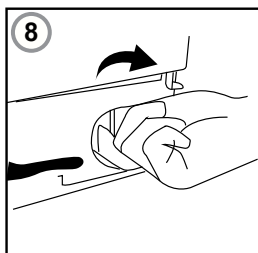

- 8) Refit the clean filter and tighten clockwise.

- 9) Replace the service panel.

Cleaning the water inlet filter

Clean the water inlet filter regularly to prevent blockage to the water supply by foreign bodies.

Always pull the power plug out before cleaning.

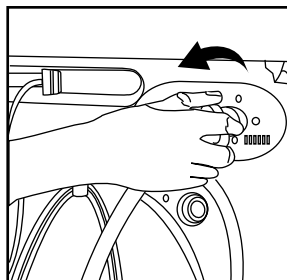

- 1) Turn off water supply at the tap. Unscrew the inlet water pipe on the back of the appliance.

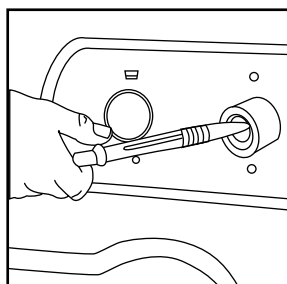

- 2) Clean the filter with a fine brush (i.e. a toothbrush).

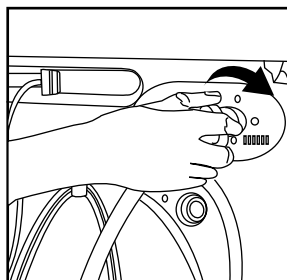

- 3) Refit the inlet water pipe securely to the inlet valve at the back of the appliance. Turn on the water supply and check for leaks before reinstalling.

Winter storage

You should install and/or store your appliance in a location where it will not be subjected to freezing temperatures.

General troubleshooting

Water under the washing machine

- Tighten the drain pump filter.
- Check the drain and inlet hose and make sure that they are fully tightened and not damaged.

Washing machine vibrates during the spin cycle

- Check that the transit bolts have been removed (see *Installation section*).
- Make sure that the washing machine is installed on a flat and level floor.
- Ensure that all four feet are resting firmly on the floor, by pressing down on each corner and making sure that the appliance is stable.
- If it is unstable then follow the *Positioning and levelling the appliance section*.

Poor spin results

- Clean the drain pump (see *Cleaning the drain pump filter section*).

Water in the detergent dispenser

- Although there will be some water residue left in the detergent dispenser after a wash cycle has completed. If the drawer is full of water then you may need to clean the detergent dispenser.

Spinning starts late or the machine does not spin

- The imbalance control system has activated because the laundry is unevenly distributed in the drum.
- The appliance will redistribute the laundry by reversing the drum rotation. This may take several attempts before the laundry is evenly distributed and normal spinning can resume.
- If the laundry is still not evenly distributed after 10 minutes, the machine will not spin. In the event of this, redistribute the load manually and select the programme again.



Note: Uneven load distribution can be caused by too large a wash load or too small a wash load. It can also occur if a single item is washed inside the appliance.

Further troubleshooting

The following circumstances do not constitute problems. Do not contact the Service Centre until the problem has been confirmed.

Fault	Cause	Solution
Washing machine fails to operate.	Poor connection to the power supply.	Check connection to the power supply.
	Power failure.	Check the power supply.
	The washer door is not properly closed.	Close the washer door properly.
	Machine has not been switched on.	Make sure the machine is switched on.
Washing machine cannot be filled with water.	The "Start/Pause" button is not pressed.	Press the "Start/Pause" button.
	Water tap is not turned on.	Turn on the water tap.
	Water pressure is less than 0,03 Mpa.	Check water pressure.
	The inlet hose is kinked.	Check the inlet hose.
	Water supply failure.	Ensure there is a water supply.
	The program knob is not properly set.	Set the program knob properly.
	The washer door is not properly closed.	Close the washer door properly.
	The inlet hose filter is blocked.	Unblock the inlet hose filter.
Machine is draining while being filled.	The height of the drain hose is below 80cm.	Install drain hose within 80-100cm of height.
	The drain hose is in water.	Make sure the drain hose is not in water.
Drainage failure.	Drain hose is blocked.	Unblock the drain hose.
	Drain hose end is higher than 100cm above the floor level.	Make sure the drain hose end is between 80-100cm above floor level.
	The filter is blocked.	Unblock the filter.

Further troubleshooting

Fault	Cause	Solution
Strong vibration while spinning.	Not all transportation bolts have been removed.	Remove all transportation bolts.
	Washing machine is located on an uneven surface or is not level.	Make sure the washing machine is on an even surface and levelled.
	Machine has been over loaded.	Reduce amount of laundry in the drum.
Operation stops before completing wash cycle.	Water or electricity failure.	Check the water and power supplies.
Operation stops for a certain period of time.	Washing machine gives an error message.	Check error codes.
	Washing machine has stopped and full of water on final rinse	Check rinse hold has not been selected. If it has press the rinse hold button or the Start/Pause button again to cancel it.
Excessive foam in the drum, which is spilled to the detergent dispenser.	The detergent is not suitable for automatic washing machines	Check if your detergent is correct.
	Excessive use of detergent.	Reduce amount of detergent in the detergent dispenser.
The indicated program duration changes during the cycle.	The program duration will be adjusted during the cycle due to external factors.	This is normal and doesn't affect the functionality.
Spinning fails.	Unbalance of the garments.	Check the loading. Add/remove garments if required. If the load is okay redistribute garments and run a spin program again.

Poor wash results

My garments are looking grey and there are limescale deposits present in the drum of my washing machine.

- There is not enough detergent being added.
- The incorrect detergent is being used.
- Stains are not being pre-treated.
- The correct wash programme or wash temperature was not selected.

I have followed the advice given above, but my garments are still coming out with grey stains on them.

- The garments are soiled with oils, ointments or grease. Try using specialist stain treatments. Rewash the garments ensuring the correct wash temperature has been selected.
- Fabric conditioner has come into contact with the garments. This could be due to overfilling the fabric conditioner compartment. If this happens try to wash out these stains as quickly as you can and try to avoid getting conditioner on the garments in future.

After the final rinse, I can still see foam.

- Modern detergents can result in there still being foam in the final rinse, this does not mean that the washing is not being rinsed properly.

There is white residue on my garments when I remove them from the appliance.

- Modern detergents can contain insoluble contents, and white residue after a wash cycle is not necessarily a sign of the garments not being rinsed properly.
- You should shake out the garment or brush it off. In future possibly turn the garment inside out before it is washed. You may wish to move from a powder detergent and switch to a liquid detergent instead.

Removing stains

Garments that are covered in stains, grease or are heavily soiled may need to be pre-washed or soaked before being placed inside of the washing machine.

- Soaking helps to remove protein-type stains, like blood, milk or grass.
- Pre-washing helps to loosen soil before the main wash.

Poor wash results

Stain removal rules

- Use warm water for soaking or pre-washing stained laundry. Hot water can set stains.
- Most stains are easier to remove when they are fresh.
- Before treating any stain try to establish; what kind of stain it is, how old the stain is, what the fabric type is and whether the fabric is colourfast (check the care label to find this out).
- Washing and drying can fix some stains.
- When bleach is recommended, use a mild fabric bleach that is safe for the fabric.
- If you need to use a stain remover, put the stained area face down on a paper towel or white cloth. Apply the stain remover to the back of the stain. This forces the stain off the fabric, instead of through it.

Stain removal guide

Stain	Removal method
Alcoholic beverages	The stain should be first washed with cold water, then wiped with glycerine and water and rinsed with water mixed with vinegar.
Shoe polish	The stain should be softly scratched without ruining the material, then rubbed with detergent and rinsed. In case it is not eliminated, rub with 1 unit of pure alcohol (96 degrees) mixed in 2 units of water and then washed with lukewarm water.
Tea and coffee	Stretch the stained area of material on the top of a container and pour water as hot as the material can endure on it. If the type of material is suitable, wash it with lye (Do not use lye on coloured clothes).
Chocolate and cocoa	Leave your clothes in cold water and rub with soap or detergent, wash it in the highest temperature that the material type can endure. If there is still a stain of oil left, wipe with oxygenated water (in proportion of 3%).
Tomato paste	Scrape the dried pieces without ruining the material, then leave in cold water for about 30 minutes and wash by rubbing with detergent.
Meat broth or egg	Eliminate the dried stain residues and wipe with a sponge or soft cloth wetted in cold water. Rub with detergent and wash with diluted lye (Do not use lye on coloured clothes).
Grease and oil stains	First wipe the residues. Rub the stain with detergent and then wash with lukewarm soapy water.
Mustard	First apply glycerine to the stained area. Rub with detergent and then wash. If the stain still does not disappear, wipe with alcohol (on synthetic and coloured cloth, a mixture of 1 unit alcohol, 2 units water should be used).
Blood stain	Lay your clothes in cold water for 30 minutes. If the stain still does not disappear, lay in mixture of water and ammonia (3 table-spoons of ammonia in 4 litres of water) for 30 minutes.
Cream, ice cream and milk	Lay your clothes in cold water and rub the stained area with detergent. If the stain has still not disappeared, apply lye on the fabric of your clothes in proper proportion (Do not use lye on coloured clothes).

Stain removal guide

Stain	Removal method
Mould	Mould stains should be cleaned as soon as possible. The stain should be washed with detergent, and if it does not disappear, it should be wiped with oxygenated water (in proportion of 3%).
Ink	Hold the stained area under cold water and wait until the inky water completely runs off. Then rub with water diluted with lemon juice and detergent. Wait 5 minutes and then wash.
Fruit	Stretch the stained area of your clothes on the top part of a container and pour cold water on it. Do not pour hot water on the stain. Wipe with cold water and apply glycerine. Wait for 1-2 hours and rinse after wiping with a few drops of white vinegar.
Grass stain	Rub the stained part with detergent. If the type of fabric is suitable for use of lye, wash it with lye. Rub your woollen clothes with alcohol (for coloured one, a mixture of 1 unit pure alcohol and 2 units of water).
Oil paint	The stain should be eliminated before it dries by applying thinner on it. Then it should be rubbed with detergent and washed.
Burnt stain	If your fabric is suitable for the use of lye (<i>Do not use lye on coloured clothes</i>), you can add lye into your washing water. For woollen fabrics, a cloth dampened in oxygenated water should be pressed on the stain and it should be ironed with a dry cloth on it. It should be washed after rinsing well.

Technical and legal information

Recycling and disposal

BWM60CL Washing Machine

Technical specifications

Model number	BWM60CL
Rated capacity of stand programme and cotton	6kg
Energy efficiency class	A++
Maximum spin speed of standard cotton programme	1200rpm
Electrical details	
Supply voltage	220-240V~, 50Hz
Supply connection	13A

Recycling and disposal

Environmental protection

Waste electrical products should not be disposed of with household waste. Please recycle where facilities exist. Check with your Local Authority or retailer for recycling advice.



The symbol on the product or its packaging indicates that this product cannot be treated as normal household waste. This product must be handed over to an electric and electronic equipment collection point for recycling.

On ensuring that this product is disposed of correctly, you will help to avoid possible negative consequences for the environment and public health, which could occur if this product is not handled correctly. To receive more detailed information about recycling this product, contact your local government, domestic waste disposal services or the outlet where the product was bought.



Warning

Before discarding an old appliance, switch off and disconnect it from the power supply. Cut off and render any plug useless. Cut the cable off directly behind the appliance to prevent misuse. This should be undertaken by a competent person. Disable the door lock to make sure that children cannot get stuck inside the appliance.

Guarantee

This appliance is covered by a full manufacturer's 2 year parts and 2 year labour guarantee and covers all parts and labour costs associated with the repair of the appliance in a domestic environment. We will repair any defect that arises due to faulty materials or workmanship and use genuine manufacturers parts.

All claims must be supported with the original receipt or other reasonable proof of purchase.

If, during the guarantee period, the appliance becomes irreparable as agreed by the engineer approved by GAA then we reserve the right, at our discretion, to exchange the defective product with a replacement appliance at GAA's sole cost. If the same product is no longer available an alternative will be offered with the same functions as the faulty item.

After an appliance has been repaired or replaced any remaining balance of the GAA guarantee will be valid and any further call outs during this prescribed period will be covered by GAA on the replacement appliance.

Should any person other than an authorized engineer modify or attempt to repair the appliance then the warranty will be invalid.

The guarantee applies to the UK mainland, Scotland, Ireland, ROI and France but is not transferable between EU countries.

This guarantee is non-transferable to any other person or product.
The guarantee is covered by UK law and is in addition to and does not diminish your legal rights.

Extended parts only warranty

As testimony to our commitment to you as a valued customer of Cooke & Lewis, we will offer you an additional 3 years parts warranty absolutely free.

If during the extended parts warranty period the appliance fails and it is considered uneconomical to repair our Customer Service Department will offer you the opportunity to purchase the same or equivalent model at a discounted price.

All parts supplied free of charge under the extended warranty must be fitted by our approved engineers and will be subject to a call out charge to fit the part.

Guarantee

Exclusions to the guarantee

This guarantee does NOT cover:

Appliances that have been damaged or neglected as a result of failure to store, assemble, install, use or care of the products in accordance with the manufacturer's instructions - GAA will not accept responsibility under this guarantee if a product is damaged or becomes defective due to, misuse, neglect, wilful or accidental damage or act of god.

Normal wear and tear.

Consumable items such as carbon filters and bulbs.

Claims arising from non-domestic use or commercial environment.

Any gas appliance not fitted by a gas safe qualified installer.

If no fault is found then GAA reserves the right to charge for the call out at the going rate.

In the course of the service work carried out it may be necessary to remove the built in appliance from its fitted position. If the appliance is glued, grouted or tiled in such a manner that it cannot be removed, it is the responsibility of the customer/installer to remove and reinstall the appliance to facilitate the repair.

This Guarantee does not affect your statutory rights.

The guarantee is offered by GAA Ltd, 1301-1303 Lu Plaza,
2 Wing Yip St, Kwun Tong, Kowloon, Hong Kong.

Customer Service

To arrange an in guarantee service call, please contact customer services on the following numbers.

UK & Northern Ireland

Phone: 0844 800 1128

Email: uksupport@apelson.co.uk

Web: www.myspareparts.co.uk

Republic of Ireland (Eire)

Phone: 014475261

CE Declaration of Conformity



MANUFACTURER: CATA

ADDRESS: C/ Ter nº 2, Torelló 08570 - Barcelona (Spain)

We hereby certify that the mentioned accessory complies with the essential requirements of the European Directives applicable, including their modifications and the corresponding transpositions from the national law.

MACHINE APPLICATION: BWM60CL

TYPE : Washing Machine

EC DIRECTIVES APPLIED: Comply with the European Directives 2006/95/CE: LVD and the 2004/108/CE: EMC

APPLIED HARMONIZED STANDARDS:

EN 60335-2-25/A2:2006

EN 60335-2-6/A2:2008

EN 60335-1/A13:2008

EN 62233:2008

APPLIED INTERNATIONAL TECHNICAL STANDARDS AND SPECIFICATIONS: ISO9001.2008

PLACE: Torelló

David Sala
Technical Manager

This appliance respects laws of the suppression of radio-interference. The Manufacturer has a policy of continuous product improvement, it reserves the right to adapt and carry out any modification considered necessary without prior warning.

B&Q plc,
Chandlers Ford, Hants,
SO53 3LE United Kingdom
www.diy.com

01

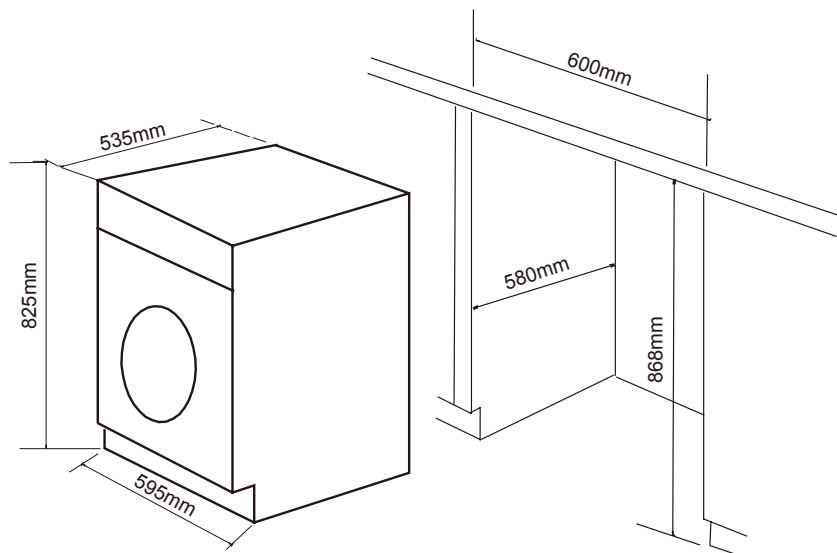

Appliance dimensions	Aperture dimensions
Height: 825mm	868mm
Width: 595mm	600mm
Depth: 535mm	580mm

**WARNING**

THIS INSTALLATION MUST BE COMPLETED BY A SUITABLY QUALIFIED PERSON. THE MANUFACTURER ONLY SANCTIONS THE INSTALLATION GIVEN IN THIS INSTRUCTION MANUAL. YOU SHOULD KEEP THE TRANSIT PACKAGING, IN CASE YOU NEED TO TRANSPORT THE MACHINE IN THE FUTURE.

Unpacking the machine and preparing for use.



Note: The bottom cover **MUST** be installed before your washing machine is used for the first time, **AND** before removing the transit bolts.

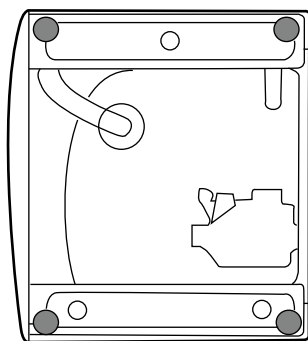

Lay down the washing machine on its side and remove the four feet by unscrewing them.

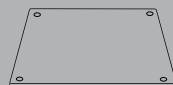
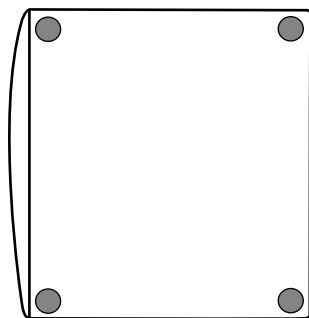

[03] x 1

Place the bottom cover [3] over the bottom of the appliance and align the four screw holes with the four feet holes. You can then secure the feet back onto the appliance, thus securing the bottom cover in place.

04

Removing the transit bolts



Note: The transit bolts **MUST** be removed before your washing machine is used for the first time.

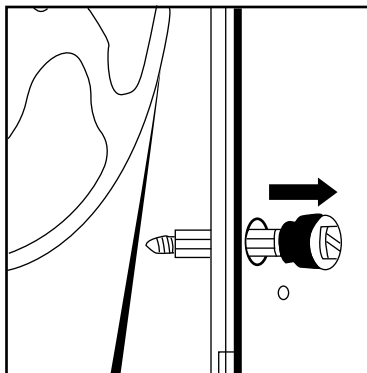

Remove the four transit bolts from the back of the appliance. The transit bolts stop the drum from rotating and reduce vibrations during transit.

05

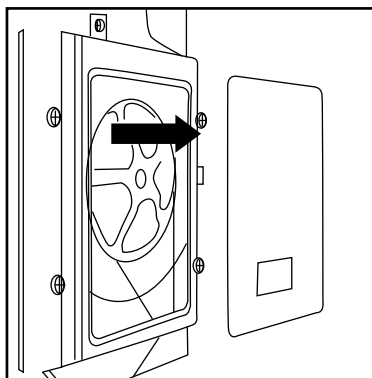

If required, you can remove the back cover of the appliance using a crosshead screwdriver to assist in removing the transit bolts.

06

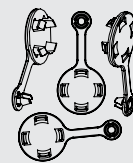

[04] x 4

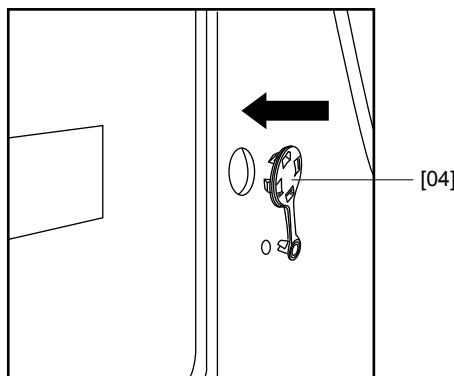

1. Insert the plastic caps (blanking plugs [4]) that are supplied, into the holes that you have removed the transit bolts from.
2. Keep the transportation bolts in a safe place for future use, should it be required.

Positioning and levelling the appliance

Place the washing machine on a solid and level floor surface.

DO NOT PLACE THE WASHING MACHINE ON A CARPET.

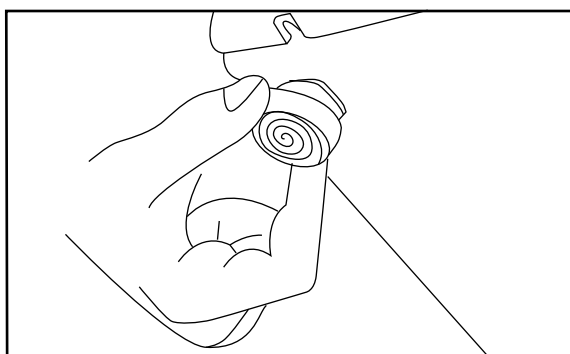

07

Loosen the adjustable feet that are positioned on the base of the appliance.

41

08

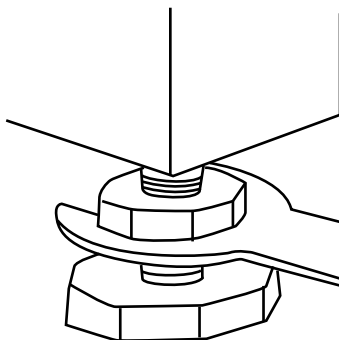

Slacken off the lock nut on each of the washing machine feet using a spanner.

09

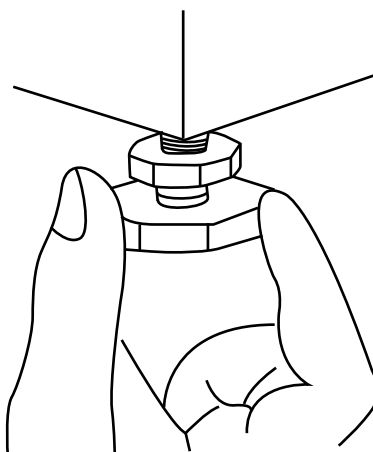

Adjust the feet to level off the washing machine.

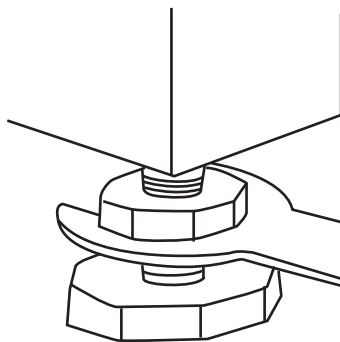

Once levelled correctly, you should tighten the lock nut back up on each of the washing machine feet using a spanner.



Important

When the washing machine is positioned in the location where it will be used. Make sure that all four feet are resting firmly on the floor, by pressing down on each corner and checking that the appliance stands still.

Connecting to the mains water supply



Important

The washing machine should never be connected to the water mains using an existing inlet hose, ***YOU MUST*** utilise the inlet hose that is provided with the appliance.

Your appliance should only be connected to a cold water supply.

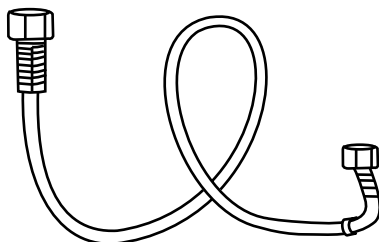

Take out the attached inlet hose [01].

12

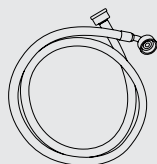

[01] x 1

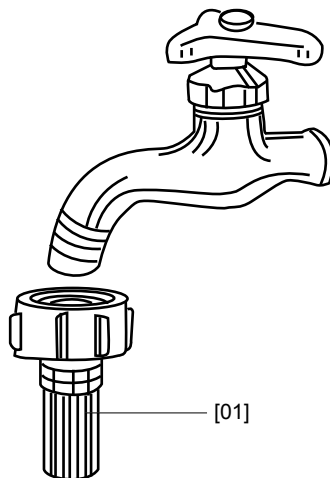

Attach the inlet hose [01] vertically to the spiral tap for the washing machine.

13

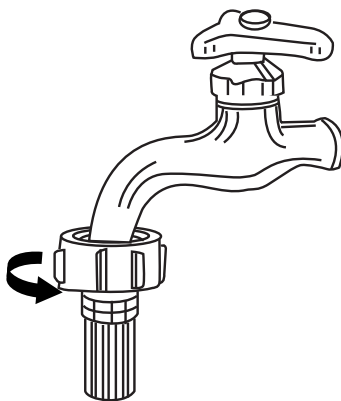

Screw the tap tightly in the direction of the screw thread of the inlet hose [01].

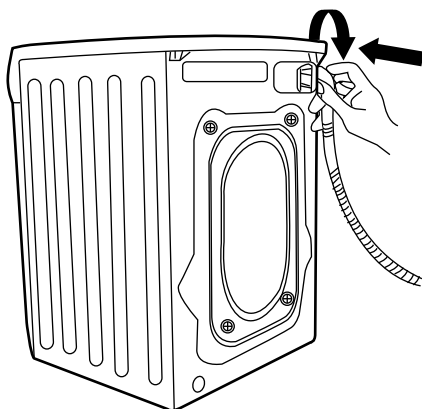

Connect the hose to the water inlet at the back of the washing machine.



Important

When connecting the screw thread of the inlet hose and the inlet valve, prevent the screw thread from being secured incorrectly or it will wear or leak.

Do not over bend the inlet hose or this will cause damage.

Water outlet

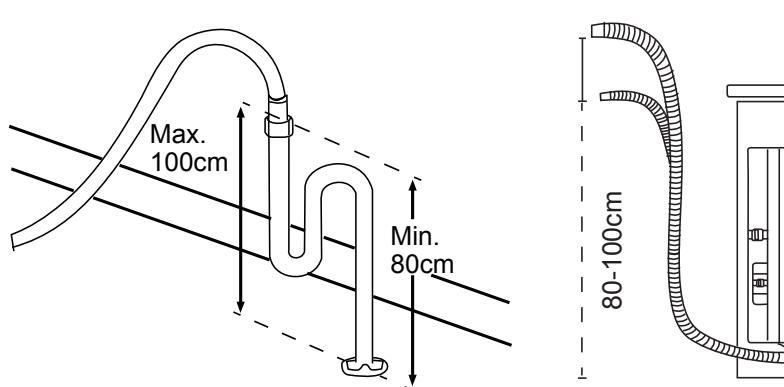

16

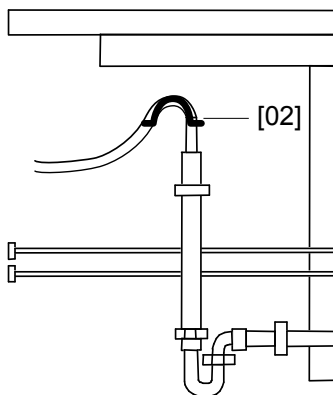
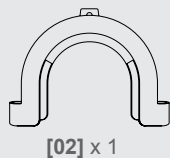

Secure the drain hose, so that it cannot move whilst the washing machine is in use.

Place the end of the drain hose on your drain pipe. Push it a short way down into your drain pipe.



Caution

Do not insert the drain hose too deeply into the water pipe, as this may cause siphoning.

NEVER EXTEND THE DRAINAGE HOSE FROM ITS ORIGINAL LENGTH.

17

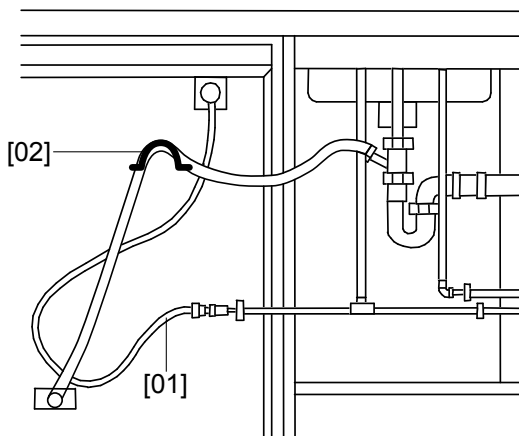

Alternatively, the drain hose can be connected directly to a sink waste. Ensure the U bend [02] is secured as high as possible to prevent water flowing from the sink back into the washing machine. (fixing screw for the U-bend is not supplied)

Fitting the furniture door

18

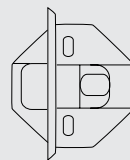
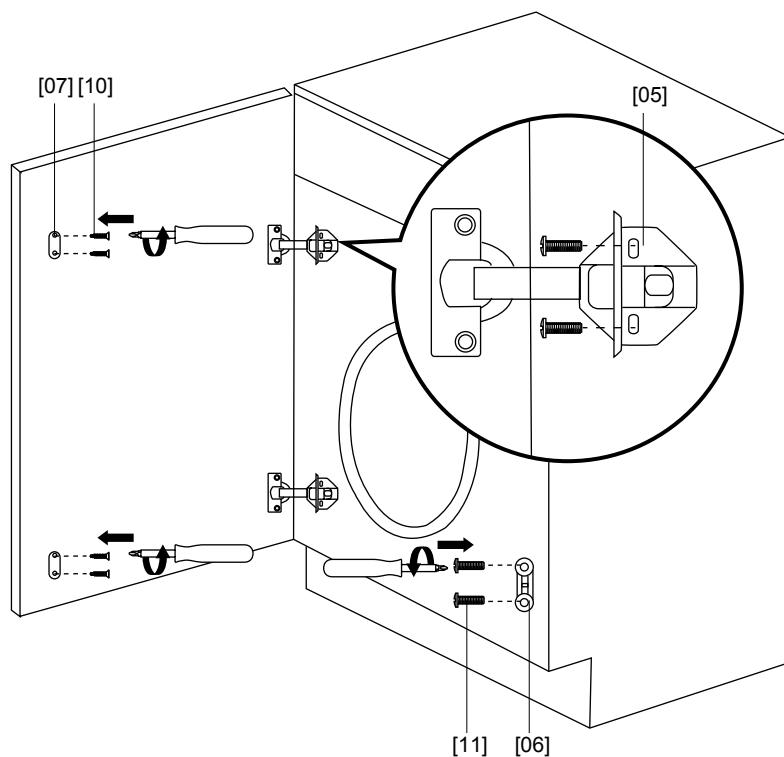

[05] x 2



[06] x 2



[07] x 2

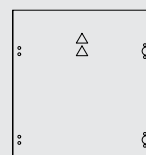

[08] x 1

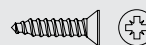

[10] x 8



[11] x 8

1. Please refer to the building in template for instructions on how to fit your integrated appliance and connect the furniture door to the product.
2. Mount the furniture door to the cabinet of the washing machine, using the hinges supplied.
3. Fix the magnet assembly to the front of the washing machine and the furniture door.

Connection to a power supply



Warning

As your appliance is a built in product, the electrical socket must still be accessible once the appliance is installed.

Consult the rating plate, located on the back of the appliance BEFORE making the electrical connections. Ensure that the voltage reaching the plug, is the same as that on the rating plate.

DO NOT REMOVE THE RATING PLATE AS THE INFORMATION ON IT IS IMPORTANT.

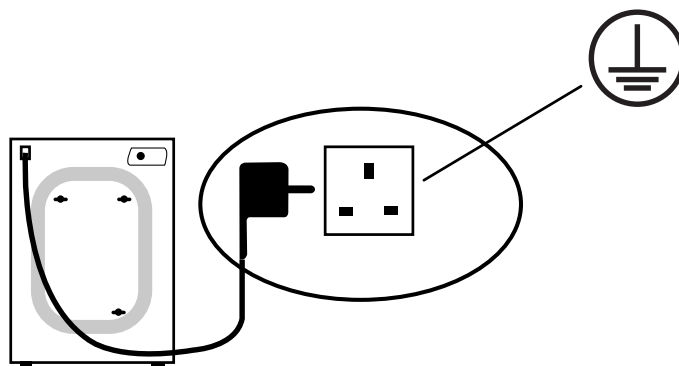

The moulded plug that is supplied with the appliance must be placed into an earthed and insulated socket.

Broken or damaged power leads must only be replaced by a suitably qualified person. A power lead of a similar type must be used in replacement.



Caution

We do not recommend that this appliance is connected to an extension lead.

Before first use maintenance wash

1. When your washing machine has been correctly installed, we recommend that you perform a "self-clean" maintenance wash cycle.
2. This will check that all aspects of the installation are correct; it will also remove any deposits that may have been left on the drum by the manufacturing process.
3. Select the "Self Clean" wash programme.
4. A small quantity of detergent should be used during this maintenance wash.









B&Q plc,
Chandlers Ford, Hants,
SO53 3LE United Kingdom
www.diy.com
