



Oven: TPOVF60

Version:02

Date:2016-07-01

Product reference code: TPOVF60B

TPOVF60 Exploded drawing

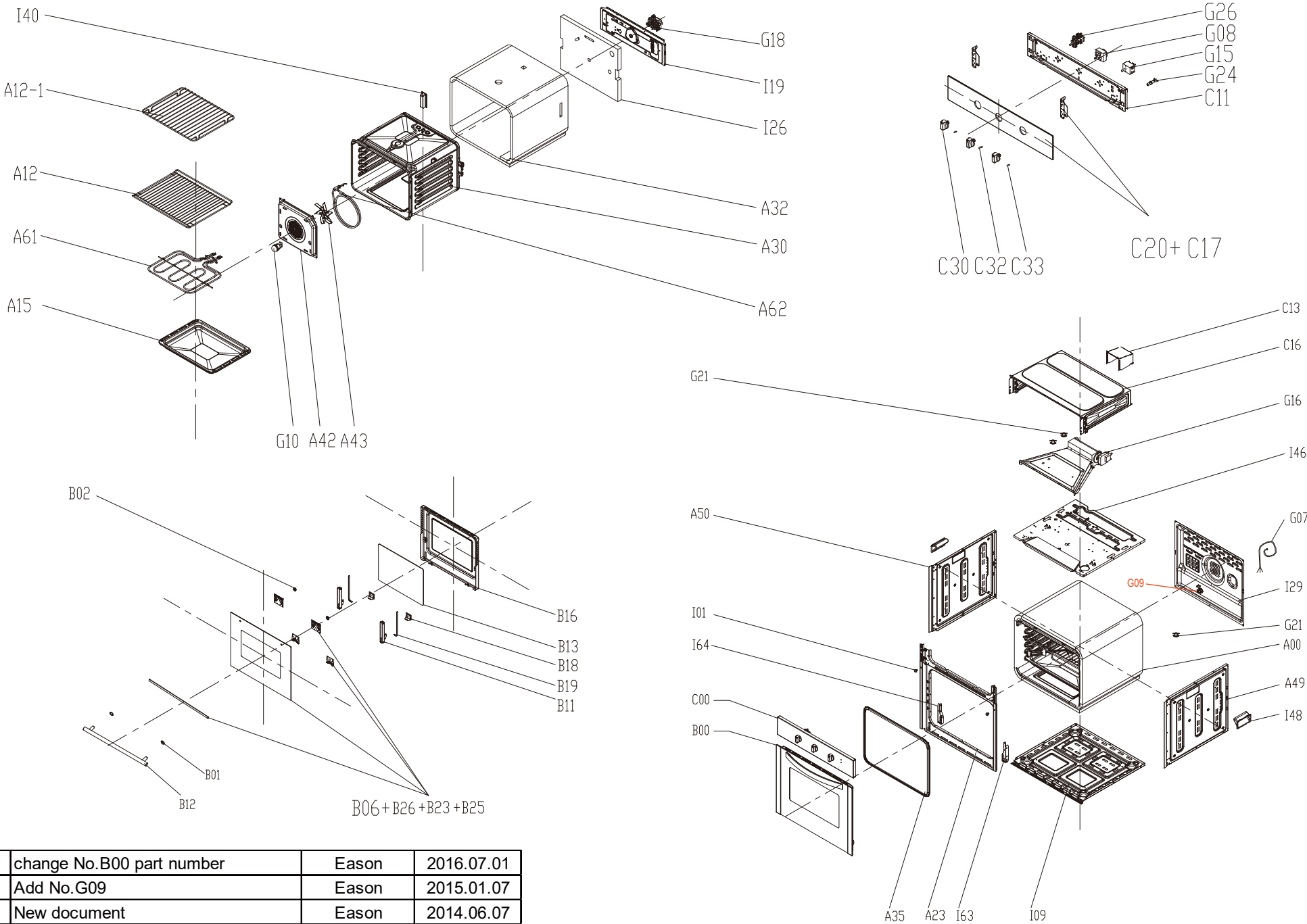

02	change No.B00 part number	Eason	2016.07.01
01	Add No.G09	Eason	2015.01.07
00	New document	Eason	2014.06.07
Index	Modify description	Modified by	Date

TPOVF60 parts list

NO.	part code	part description	quantity
A23	261500616702	front plate	1
A35	262101400124	cavity sealing ring	1
A49	261561500800	encloser(Right)	1
A50	261561400800	encloser(Left)	1
C13	261561900400	control panel back cover	1
C16	261561800600	control panel cover	1
G07	261201002601	power cord	1
G16	291201300005	cooling fan motor	1
G21	261201301360	thermostat 70℃	1
G21	261201301240	thermostat 90℃	1
I01	291599900023	fastener assembly	1
I09	261561700400	Following encloser	1
I29	261561600400	back cover	1
I46	261561201602	top cover	1
I48	261331200200	handle box	2
I63	261504501200	hinge fixed frame (Right)	1
I64	261504501100	hinge fixed frame (Left)	1
G09	261257100050	electrical connection block	1
A00	\	cavity ass'y	
A12	291501300035	bake rack	1
A12-1	261568901401	bake tray rack	1
A15	261504406700	bake tray (deep)	1
A30	261500129800	cavity	1
A32	262100600066	Cavity insulation	1
A42	261562000401	convection motor cover	1
A43	261508200600	convection fan blade	1
A61	261201701083	metal heating element*(top)	1
A62	261201702190	turbo heating element	1
G10	261257700038	lamp	1
G18	261204100130	convection motor	1
I19	261564600300	insulation cover	1
I26	262100600063	back insulation	1
I40	261564400600	exhaust pipe	1
B00	293600106108	door ass'y	1
B01	262100800105	door handle cushion	2
B02	291300600021	handle support	2
B06	291502000011	door decoration	1
B11	291502100015	door hinge ass'y	2
B12	261509400902	door handle	1
B13	262155000038	door inner glass	1
B16	261500204301	door frame ass'y	1
B18	261563702101	door strengthen bracket	2
B19	262155500014	Door sealing ring	2
B23	291599900021	door frame bracket	1
B25	291599900020	door frame bracket(Left)	2
B26	291800800417	door outer glass	2
C00	293600106114	control panel ass'y	1
C11	261561001701	control panel holder	1
C17	261563800900	control panel bracket	2
C20	291800800441	control panel glass	1
C30	291301000111	knob	3
C32	291503600001	knob sharpnel	1
C33	251560002259	knob sharpnel	2
G08	261201800312	timer	1
G15	261257000041	energy controller	1
G24	291202300001	indicator	1
G26	261205200660	switch on-off	1