



Oven:UBMFM603.1

Version:00

Date:2016-10-12

Product reference code:UBMFM603.1

UBMFM603.1 Exploded drawing

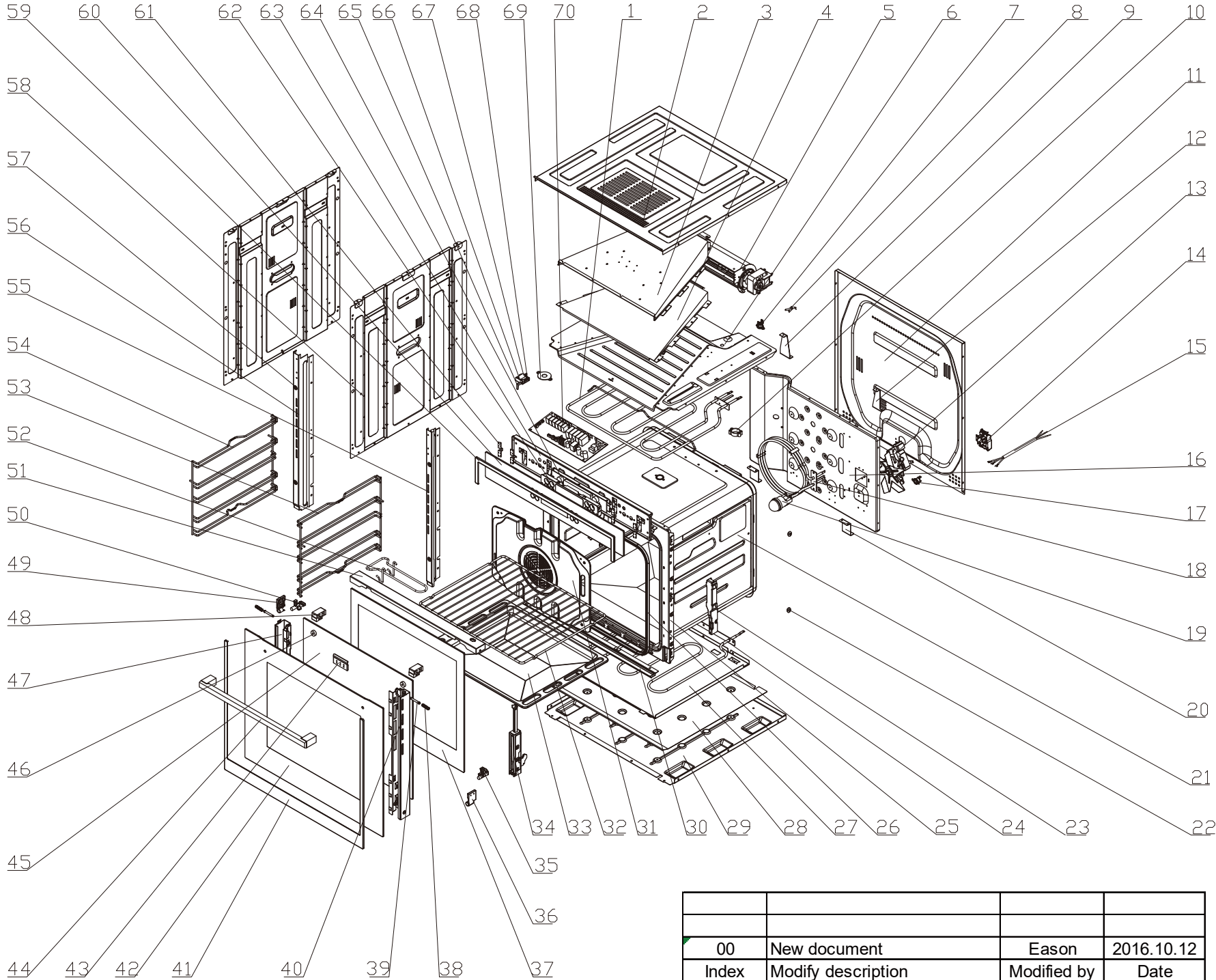

00	New document	Eason	2016.10.12
Index	Modify description	Modified by	Date

UBMFM603.1 parts list

No.	part code	Part description	Qty	Remark	chinese description
1	33303094	top heating element	1		顶层电热管-AD-K28(J)-17
2	33031018	shell top cover	1		外壳上盖板-AD-K28(J)-08
3	33028004	Discharge flue upper cover plate	1		排烟道上盖板-自洁烤箱专用
4	33026004	Flue cover plate	1		排烟道中盖板-自洁烤箱专用
5	33313037	Cooling fan assembly	1		散热风机组件-配双排气系统（800转）
6	33027002	Discharge flue baseboard	1		排烟道底板-自洁烤箱专用
7	33310001	Cooling thermostat	1		散热温控器-65度
8	33323004	Thermometer probe assembly	1		测温探头组件-自洁烤箱专用
9	33027024	Discharge flue baseboard Support block	1		排烟道底板支撑块(右)-AD-K28(J)-07
10	33215019	Chimney	1		排烟筒-AD-K28(J)-10
11	33030026	shell rear cover plate	1		外壳后盖板-AD-K28(J)-05
12	33027023	Discharge flue baseboard Support block (left)	1		排烟道底板支撑块(左)-AD-K28(J)-06
13	33315002	Circulating fan assembly	1		循环风机组件-(划一型号): HY6020V240H
14	33305009	Junction box	1		接线盒-奥地利进口
15	33304065	Power cord	1		巴西插头-1.1米-H05VV-F(F-153P)
16	33016002	Cavity rear support	1		内胆后支架-PN-K14-04
17	33308012	Overheat protector	1		过热保护器-120℃-PN-K19-06
18	33303027	Rear heating element	1		背部电热管-三圈
19	33302002	Lamp assembly	1		灯头组件
20	33027030	Shell baseboard connect block	2		外壳底板连接块-AD-K28(J)-16
21	33058064	cavity ring assem	1		内胆圈组件(PN-K20(A))-70升机械
22	33141007	rail bracket bottom fixed seat	4		导轨支架下固定座(不带导轨支架垫板)-PN-K14-14C
23	33005089	hinge fixed board	2		铰链固定板-AD-K28(J)-16
24	33303002	Bottom heating element	1		底层电热管
25	33018226	Cavity panel	1		内胆面板（全触摸）-AD-K28(S)-10-01
26	33003005	Bottom heating element fixed board	1		底层电热管固定板-AD-K28(J)-11
27	33003006	Bottom insulation fibre heat shield	1		底部保温纤维隔热板-AD-K28(J)-12
28	33029016	Shell baseboard	1		外壳底板-AD-K28(J)-04
29	33803002	Door sealing assembly	1		门封条组件
30	33027031	Cavity panel under bracing	1		内胆面板下支撑-AD-K25(J)-14
31	33001029	Rear heating element baffle	1		背部电热管挡板-PN-K20-03(不带转动孔)
32	33170001	shelf	2		搁架
33	33224003	Tray	1		油脂收集盘（K1-08）-新工艺
34	30400600025	Hinge assembly	2		铰链组件-17号铰链
35	33014141	Inner glass low right fixed block	1		内玻璃右下固定块-AD-K28(J)-20-17
36	33014139	Active shaft right fixed block	1		活动转轴右固定块-AD-K28(J)-20-15
37	33103051	Inner glass	1		内玻璃-AD-K28（J）-20-07
38	33005073	Up door bracket detent spring	2		门上支架卡销弹簧-AD-K28(J)-20-11
39	33005072	Up door bracket detent	2		门上支架卡销-AD-K28(J)-20-10
40	33014135	Door frame right bracket	1	Please buy combination	门框右支架-AD-K28(J)-20-02
47	33014134	Door frame left bracket	1		门框左支架-AD-K28(J)-20-01
41	33015277	Door panel decorating plate	1		门面板装饰板(IX02)-AD-K28(J)-20-14C（12mm窄边）
42	33102656	Door panel	1		门面板-418-AD-K28(J)-20-04H-镀膜
43	33006012	Handle fixed board	1		拉手固定板-PN-K13-20-07（黑色亮光喷塑后）
44	30400700002	Handle-H1	1		
45	33104042	Middle glass	1		中间玻璃-AD-K28(J)-20-06
46	33214005	Handle fixed assembly	2		拉手固定套-PN-K14-60-09
48	33219019	Middle glass upper fixed block	2		中间玻璃上固定块-AD-K28(J)-20-03
49	33014138	Active shaft left fixed block	1		活动转轴左固定块-AD-K28(J)-20-14
50	33014140	Inner glass low left fixed block	1		内玻璃左下固定块-AD-K28(J)-20-16
51	33014129	Upper door bracket	1		门上支架-AD-K28(J)-20-09
52	33172001	Grasp	1		搁架抓手
53	33140008	Right rail bracket	1		右导轨支架-PN-K14-16
54	33140007	Left rail bracket	1		左导轨支架-PN-K14-15
55	33014137	shell right bracket	1		外壳右支架-AD-K28(J)-03
56	33014136	shell left bracket	1		外壳左支架-AD-K28(J)-02
57	33239001	Oven fix assembly	4		烤箱安装套
58	33032016	Shell left and right side plate	2		外壳左右侧板-AD-K28(J)-09
59	34039003	Control panel decorate	1	Please buy combination	控制面板装饰片-IX03
60	33101548	Switch panel	1		开关面板（全触摸）-AD-K28(S)-20-01-镀膜
61	33006001	Switch panel connect panel	4		开关面板连接板
62	33322008	Screen fixed box	1		显示板固定盒-PN-K19-02
63	33018200	Switch panel fixed board	1		开关面板固定板(配机械自洁显示屏)-AD-K28(JSP)-01
64	33321073	touch display board	1		触摸显示板-AD-K28(S)-01
65	33005006	Door switch slider	1		门开关滑块-K12-80-02
66	33005005	Door switch fixed board	1		门开关固定板-K12-80-01
67	33301020	Door switch	1		门开关-PN-K12-80-04
68	33319002	Door switch spring	1		门开关弹簧-PN-K12-80-03
69	33215025	Chimney baffle	1		排烟筒遮挡板(10mm孔)PN-K13-59B
70	33321009	Touch power board	1		自洁触摸屏电源板