

UBCIRCA60BK 60CM ROUND GLASS COOKER HOOD

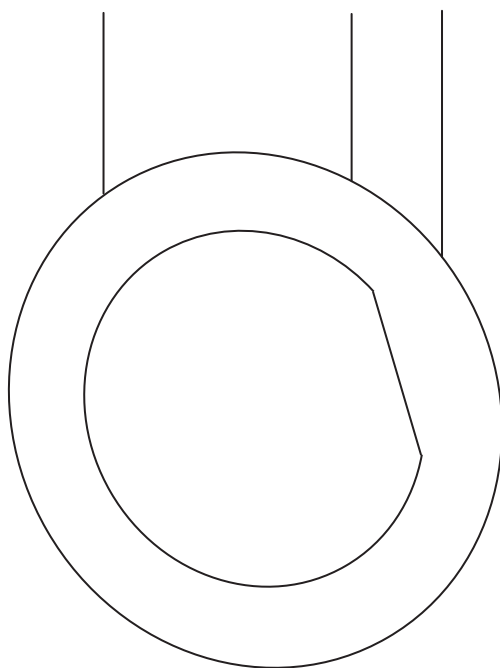

GB IE



WARNING: Read the instructions before using the appliance.

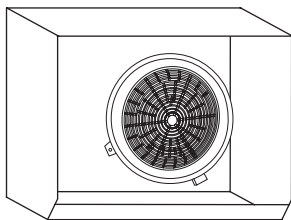

[01] x 1

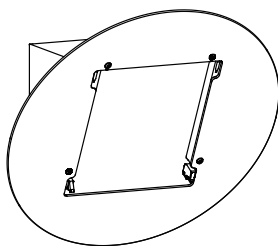

[02] x 1

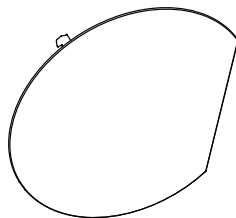

[03] x 1

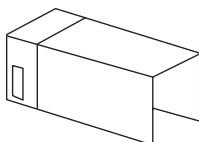

[04] x 2



[05] x 1

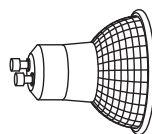

[06] x 2

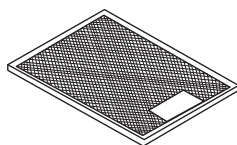

[07] x 1

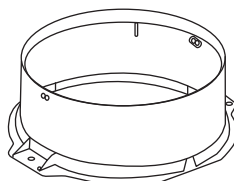

[08] x 1

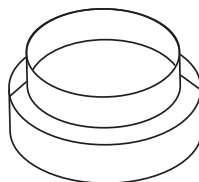

[09] x 1



[10] x 5

1 : 1



[12] x 5 (3.9 x 32mm)



[13] x 10 (3.4 x 8mm)

Let's get started...

These instructions are for your safety. Please read through them thoroughly before use and retain them for future reference.



Getting **started...**

Your product	04
Before you start	04
Safety	05



In more **detail...**

Operation	10
Care and maintenance	11
Troubleshooting	14
Recycling and disposal	15
Technical and legal information	15
Guarantee	18
CE Declaration of conformity	20



Appendix...

Installation	21
---------------------	----

Your product Before you start

Your product

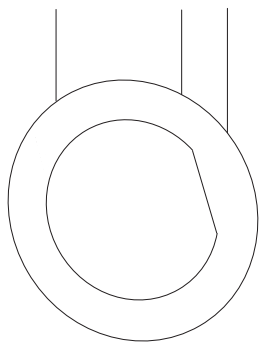

Installation guide
located at the end of
the guidebook

Things to check before you start

- ☒ To avoid the risks that are always present when you use an electrical appliance it is important that this cooker hood is installed correctly and that you read the safety instructions carefully to avoid misuse and hazards. We recommend that you keep this instruction booklet for future reference and pass it on to any future owners. After unpacking the cooker hood please check that it is not damaged. If in doubt, do not use the appliance but contact Customer Services on 0844 800 1128 (UK) and 01 4475261 (Ireland).
- ☒ Check the package and make sure you have all of the parts listed.
- ☒ Decide on the appropriate location for your product.
- ☒ If this product contains glass please take care when fitting or handling to prevent personal injury or damage to the product.
- ☒ The specifications plate is available on this appliance. This plate displays all the necessary identification information for ordering replacement parts.
- ☒ If you sell the appliance, give it away, or leave it behind when you move house, make sure you also pass on this manual so that the new owner can become familiar with the appliance and its safety warnings.

You will need

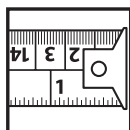
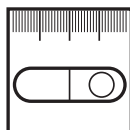

Accessories not supplied



SELF ADHESIVE ALUMINIUM TAPE

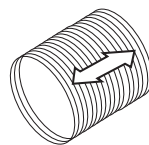

Ø125mm or Ø150mm VENT PACK 2 (UK & IE)



MODEL NUMBER: 02859396

CARBON FILTER ORDERING HOTLINE

0344 800 1128 (UK)

014475261 (IE)

Safety

These instructions are for your safety. Please read through them thoroughly prior to installation and retain them for future reference.



- All installation work must be carried out by a competent person or qualified electrician.
- This appliance must be installed correctly by a suitably qualified person, strictly following the manufacturer's instructions.



This appliance complies with all current European safety legislation, however, the Manufacturer must emphasise that this compliance does not prevent the surfaces of the appliance from heating up during use and remaining hot during its operation.

- ☑ Accessible parts may become hot during use. Young children should be kept away. Care should be taken to avoid touching the appliance.
- ☑ The Manufacturer highly recommends that this appliance be kept out of the reach of babies and small children.
- ☑ This appliance can be used by children aged from 8 years and above and persons with reduced physical, sensory or mental capabilities or lack of experience and knowledge if they have been given supervision or instruction concerning use of the appliance in a safe way and understand the hazards involved. Children shall not play with the appliance. Cleaning and user maintenance shall not be made by children unless they are older than 8 and supervised.
- ☑ Keep the appliance and its cord out of reach of children less than 8 years.
- ☑ Means for disconnection must be incorporated in the fixed wiring in accordance with the wiring rules. An all-pole disconnection switch having a contact separation of at least 3 mm in all poles should be connected in fixed wiring.
- ☑ Regularly check the power plug and power cord for damage. If the supply cord is damaged, it must be replaced by the manufacturer, its service agent or similarly qualified persons in order to avoid a hazard.

- ☑ Do not allow the electric cables to touch the hot parts of the appliance.
- ☑ Make sure that the power cord is not caught under or in the appliance and avoid damage to the power cable.
- ☑ Do not install the appliance outdoors in a damp place or in an area which may be prone to water leaks such as under or near a sink unit. In the event of a water leak allow the machine to dry naturally.
- ☑ Do not use flammable sprays in close vicinity to the appliance.
- ☑ Please dispose of the packing material carefully.
- ☑ Do not use flammable sprays in close vicinity to the appliance.
- ☑ We also recommend that great care be taken during use and cleaning. Read the cleaning and maintenance sections for this appliance carefully.
- ☑ A steam cleaner is not to be used.
- ☑ The appliance is not intended to be operated by means of external timer or separated remote-control system.

- ☑ The appliance is for domestic use only.
- ☑ **Warning:** Consult local regulations regarding fumes outlets. Do not connect the hood to a fume, ventilation or hot air duct. Confirm that room ventilation is appropriate with the local authorities. Make sure the maximum air extraction flow rate for the appliances in the room does not exceed 4 Pa (0.04 mbar). The room must have adequate ventilation if an extractor hood is used simultaneously with appliances that run on gas or other fuels. The air must not be discharged into a flue that is used for exhausting fumes from appliances burning gas or other fuels. Regulations regarding air extraction must be complied with.
- ☑ **Warning:** Before connecting the hood: switch off the electricity supply and check that the supplied voltage and frequency coincide with that indicated on the appliance nameplate.
- ☑ **Warning:** The hood may stop working during an electrostatic discharge (e.g. lightning). This involves no risk of damage. Switch off the electricity supply to the hood and reconnect after one minute.

- ☒ To avoid the risk of fire, clean the metal filter regularly and closely watch and regulate pans containing hot oil.
- ☒ Do not use the hood if it shows signs of damage or imperfection. Contact customer services.
- ☒ Flambe cooking must not be carried out underneath this appliance.
- ☒ When installing the appliance, make sure that the following distances between the top of cooker or hob and the lowest part of the cooker hood must be observed:
 - > Gas hobs: 650mm.
 - > Electric hobs: 435mm.
- ☒ The Manufacturer declines all liability for personal or material damage as a result of misuse or incorrect installation of this appliance.



Warning

There is a risk of electric shock and fire if cleaning is not carried out in accordance with the instructions.

Product functions

- This appliance extracts the air of the kitchen to remove the odours and keep an optimum level of air quality inside the room, it also allows you to illuminate the cooking area.







Switching on/off

- Switch on the appliance at the switched fused connection unit. The appliance is ready for use.

Touch control panel



This panel is located on the front part of the hood and includes:

-  Filter cleaning alert indicator/switch (ref. 1). Activated when you need to clean the aluminium grease filters and deactivated with a single press.
-  Control for setting the timer of the motor (ref. 2). The extractor will operate for 5 minutes at the current speed and 5 minutes at each of the lower speeds until coming to a complete stop.
-  Control for the light (ref. 3). Allows the light to be regulated by pressing and holding down.
-  On/off control of the motor (ref. 4).
-  Extractor fan speed 1 button.
-  Extractor fan speed 2 button.
-  Extractor fan speed 3 button.

To obtain the best results from your cooker hood it is recommended that you leave it switched on for 15 minutes after you have finished cooking.

Care and maintenance



Warning

Always switch off the electricity supply before carrying out maintenance work on the hood. In the event of a fault, contact customer services.

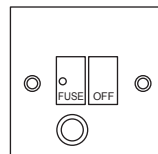

Bulb replacement

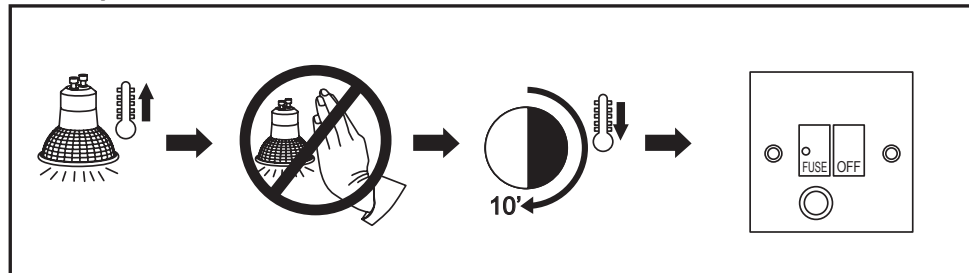

Note

Please follow Active charcoal filter replacement steps on next page, before attempting to remove the bulb.

The bulb may be hot, leave it 10 minutes before removing it.

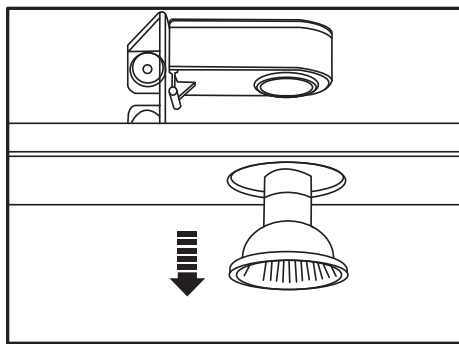
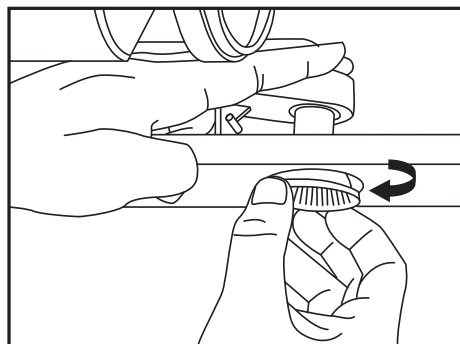
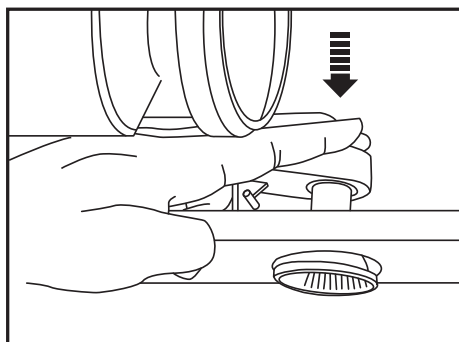
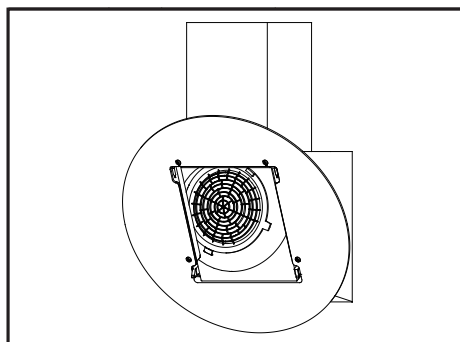

Active charcoal filter replacement

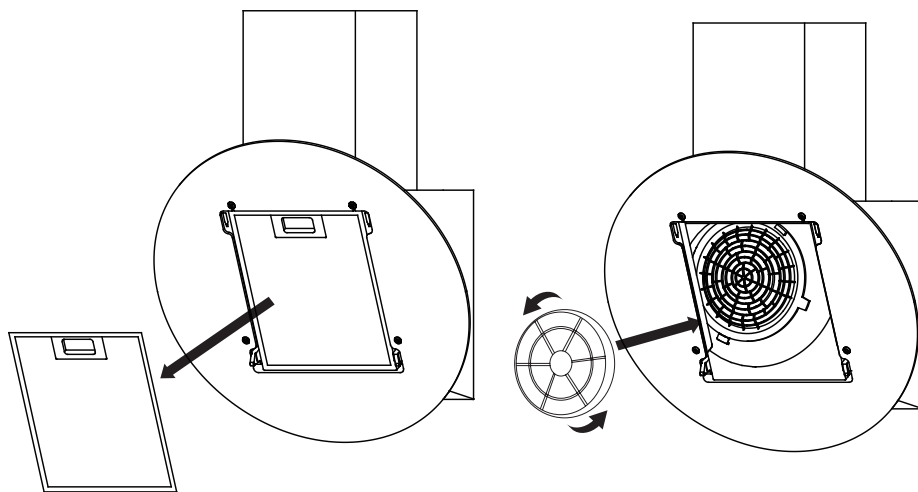
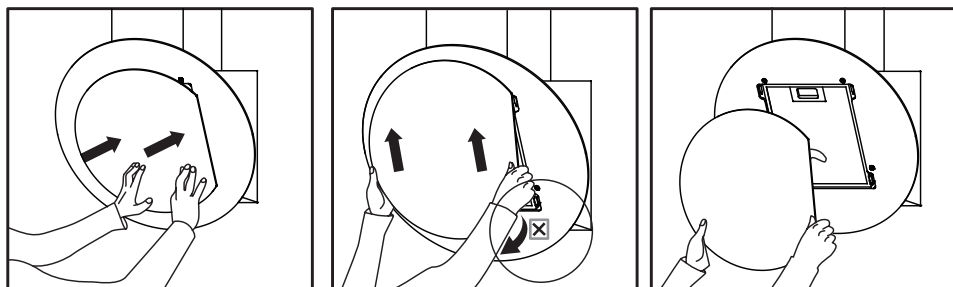

1x ACTIVE CHARCOAL FILTER

MODEL NUMBER: 02859396

CARBON FILTER ORDERING HOTLINE

0344 800 1128 (UK)

Aluminium filters replacement

Aluminium filters:

Use non-corrosive, liquid detergent or a stainless steel cleaner.

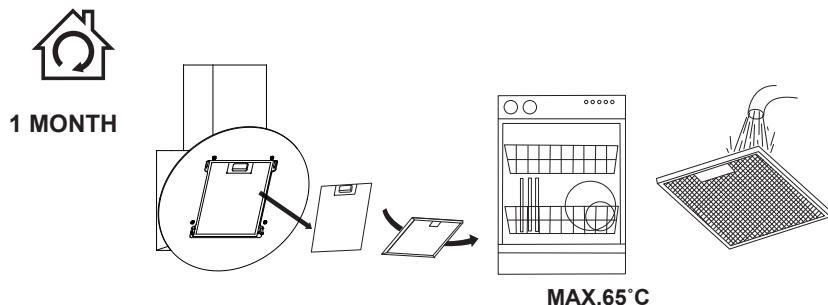

Aluminium filters: To avoid fires, clean thoroughly once a month. To do so, remove the filters and wash with hot water and detergent. If using a dishwasher, position the filters vertically to improve the cleaning process.

Active charcoal filters:

Replace every 3 months.

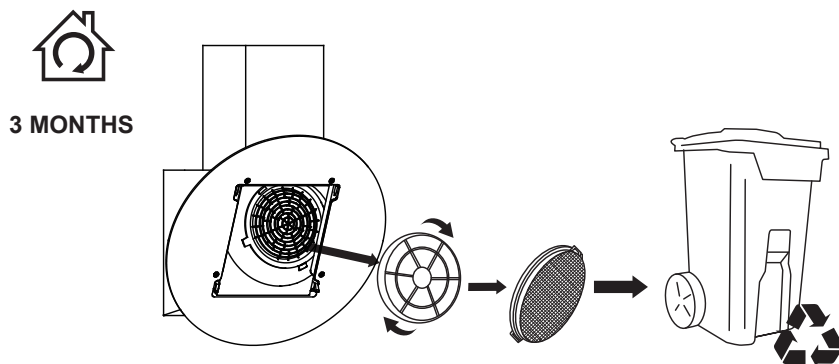

Important: Increase the filter cleaning/replacement frequency if the hood is used for more than 2 hours a day. Always use genuine filters from the manufacturer.

Troubleshooting

Fault	Cause	Solution
Excessive vibration.	The appliance is not installed properly on the brackets.	Take down the appliance and check it is properly fixed.
	The fan blade is damaged.	Switch off the appliance. Repair to be carried out by qualified service personnel only.
	The fan motor is not fixed tightly.	
Light on, but motor does not work.	The fan blade is jammed.	
	The motor is damaged.	
Both light and motor do not work.	Light bulb blown.	Replace with a bulb with correct rating.
	Power connection loose.	Check power supply.
Suction performance reduced.	Speed may be too low.	Select a higher speed.
	Distance between the cooker hood and the hob is too great.	Readjust the distance to: Gas hobs: 650mm Electric hobs: 435mm
	Aluminium grease filter is dirty.	Clean filters. See <i>Care and maintenance</i> section.
	Top vent might be obstructed.	Clear any obstruction.
	Optional vent kit might be twisted.	Ensure that the vent kit is fitted to the manufacturers instructions.
Works normally but cooking smells linger.	Charcoal filter not fitted in recirculation mode or charcoal filter is full of grease.	Fit charcoal filter if recirculating or change the filter. See <i>Care and maintenance</i> section.

Recycling and disposal

Environmental protection

Waste electrical products should not be disposed of with household waste. Please recycle where facilities exist. Check with your Local Authority or retailer for recycling advice.



The symbol on the product or its packaging indicates that this product cannot be treated as normal household waste. This product must be handed over to an electric and electronic equipment collection point for recycling.

On ensuring that this product is disposed of correctly, you will help to avoid possible negative consequences for the environment and public health, which could occur if this product is not handled correctly. To receive more detailed information about recycling this product, contact your local government, domestic waste disposal services or the outlet where the product was bought.

Technical specifications

Supply voltage	220-240V~, 50Hz
Power consumption - Fan	140W
Power consumption - Luminary	2 x 4W Max LED
Power consumption - Total	148W
Protection class	II
Light bulb	3.5W (GU10) LED (supplied)

Wiring

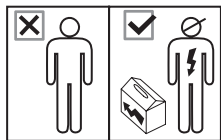

All installation work must be carried out by a competent person or qualified electrician.
Before connecting the mains supply ensure that the mains voltage corresponds to the voltage on the rating plate.



WARNING: THIS APPLIANCE MUST NOT BE EARTHED.

Mains Supply could be connected to the Mains Voltage by Direct Connection

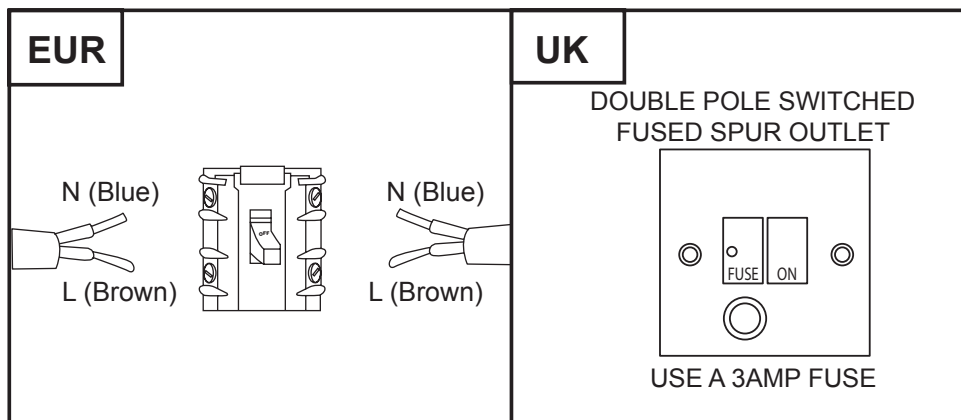

Direct Connection

If the appliance is being connected directly to the mains an omnipolar circuit-breaker must be installed with a minimum opening of 3mm between contacts.

The installer must ensure that the correct electrical connection has been made and that it complies with wiring diagram.

The cable must not be bent or compressed.

Regularly check the power plug and power cord for damage. If the supply cord is damaged, it must be replaced by a special cord or assembly available from the manufacturer or its service agent.

Technical and legal information

The Manufacturer declines all liability for damage caused to persons and objects due to incorrect or improper installation of the appliance.

Electrical Requirements

Any permanent electrical installation must comply with the latest I.E.E. regulations and local electricity company regulations. For your own safety a qualified electrician or contractor who is on the roll of the National Inspection Council for Electrical Installation Contracting (NICEIC) should undertake the electrical installation.

Electrical Connection

Before connecting the mains supply ensure that the mains voltage corresponds to the voltage on the rating plate inside the appliance.



WARNING: THIS APPLIANCE MUST NOT BE EARTHED

The appliance is supplied with a 2-core mains cable and must be connected to the electricity supply via a double pole switch having a 3mm minimum contact gap on each connector.

For UK only

A Switched Fused Connection Unit to BS 1363 Part 4 is recommended.

The fuse must be rated at 3 Amps.

The wires in the mains lead are coloured in accordance with the following code:

Brown = L - Live

Blue = N - Neutral

The connection point must be placed in a position adjacent to the appliance so as to be readily accessible for an engineer in the event of a breakdown.

Manufacturer's Guarantee

This appliance is covered by a full manufacturers 2 year parts and 2 year labour guarantee and covers all parts and labour costs associated with the repair of the appliance in a domestic environment. We will repair any defect that arises due to faulty materials or workmanship and use genuine manufacturers parts.

All claims must be supported with the original receipt or other reasonable proof of purchase.

If, during the guarantee period, the appliance become irreparable as agreed by the engineer approved by Apelson Appliances UK Ltd then we reserve the right, at our discretion, to exchange the defective product with a replacement appliance at Apelson Appliances UK Ltd sole cost. If the same product is no longer available an alternative will be offered with the same functions as the faulty item.

After an appliance has been repaired or replaced any remaining balance of the Apelson Appliances UK Ltd guarantee will be valid and any further call outs during this prescribed period will be covered by Apelson Appliances UK Ltd on the replacement appliance.

Should any person other than an authorised engineer modify or attempt to repair the appliance then the warranty will be invalid.

The guarantee applies to the UK and Ireland and is not transferable between other EU countries.

This guarantee is non-transferable to any other person or product.

This guarantee is covered by UK law but does not diminish your legal rights.

EXTENDED PARTS ONLY WARRANTY

As testimony to our commitment to you as a valued customer of Apelson Appliances UK Ltd, we will offer you an additional 3 years parts warranty absolutely free.

If during the extended parts warranty period the appliance fails and it is considered uneconomical to repair our Customer Service Department will offer you the opportunity to purchase the same or equivalent model at a discounted price.

All parts supplied free of charge under the extended warranty must be fitted by our approved engineers and will be subject to a call out charge to fit the parts.

EXCLUSIONS TO THE GUARANTEE

This guarantee does NOT cover:

Appliances that have been damaged or neglected as a result of failure to store, assemble, install, use or care for the products in accordance with the manufacturers instructions - Apelson Appliances UK Ltd will not accept responsibility under this guarantee if a product is damaged or becomes defective due to, misuse, neglect, wilful or accidental damage or act of god.

Normal wear and tear.

Consumable items such as carbon filters and bulbs.

Claims arising from non-domestic use or commercial environment.

Any gas appliance not fitted by a gas safe qualified installer.

If no fault is found then Apelson Appliances UK Ltd reserves the right to charge for the call out at the going rate of £55.00 plus VAT.

If in the course of the service work carried out it may be necessary to remove a built-in appliance from its fitted position. If the appliance is glued, grouted or tiled in such a manner that it cannot be removed, it is the responsibility of the customer / installer to remove and reinstall the appliance to facilitate the repair.

This guarantee does not affect your statutory rights.

This guarantee is offered by Apelson Appliances UK Ltd, Unit 3 Normandy Landings, Pope Street, Castleford, West Yorkshire, WF6 2AG.

USEFUL CONTACTS

SPARES

Apelson Appliances UK Ltd

Phone: 0344 800 1128

Email: uksupport@apelson.co.uk

Web: www.spareszone.co.uk

SERVICE AND GUARANTEE

Apelson Appliances UK Ltd

Phone: 0344 800 1128

Email: uksupport@apelson.co.uk

Web: www.spareszone.co.uk

CE Declaration of Conformity

**MANUFACTURER: CATA****ADDRESS: C/ Ter nº 2, Torelló 08570 - Barcelona (Spain)**

We hereby certify that the mentioned accessory complies with the essential requirements of the European Directives applicable, including their modifications and the corresponding transpositions from the national law.

MACHINE APPLICATION: UBCIRCA60BK**TYPE:** Decorative Cooker Hood**EC DIRECTIVES APPLIED:** Comply with the European Directives 2006/95/CE: LVD
and the 2004/108/CE: EMC
2011/65/EU:RoHS**APPLIED HARMONIZED
STANDARDS:**

Standard EN 60335-1 Safety of household and similar electrical appliances
Standard EN 60335 part 2-31, particular requirements for range hoods
Standard EN 55014 Limits and methods of measurement of radio disturbance
Standard EN 61000-3-2 Electromagnetic compatibility limits for harmonic.
Standard EN 61000-4-5 Electromagnetic compatibility (EMC)

APPLIED INTERNATIONAL TECHNICAL**STANDARDS AND SPECIFICATIONS: ISO9001.2008****PLACE: Torelló**

David Sala

Technical Manager

This appliance respects laws of the suppression of radiointerference.
As the Manufacturer has a policy of continuous product improvement, it reserves the right to adapt and carry out any modification considered necessary without prior warning.

DUCTED OPTION

RECIRCULATION OPTION



01

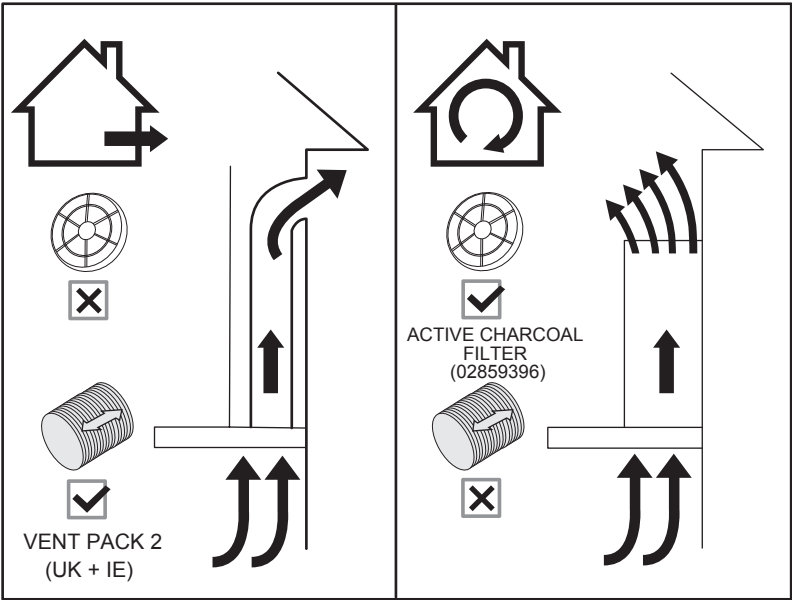

You can choose two type of installation:

- Ducted option
- Recirculation option

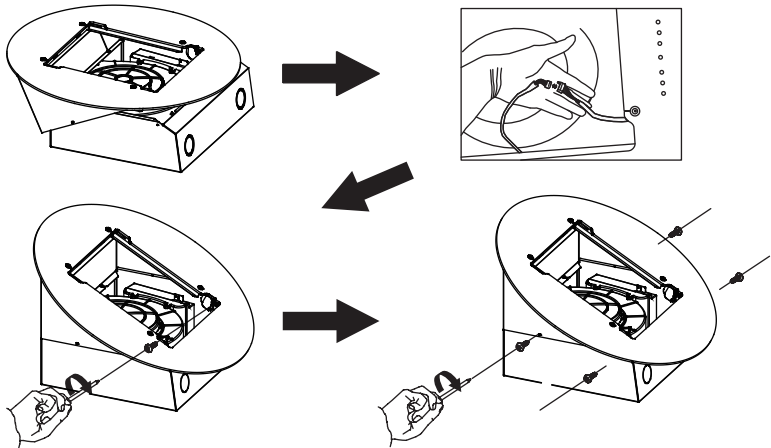

02



[13] x 6

Connect the electric cable and fix the metal box and motor to the glass and metal work.

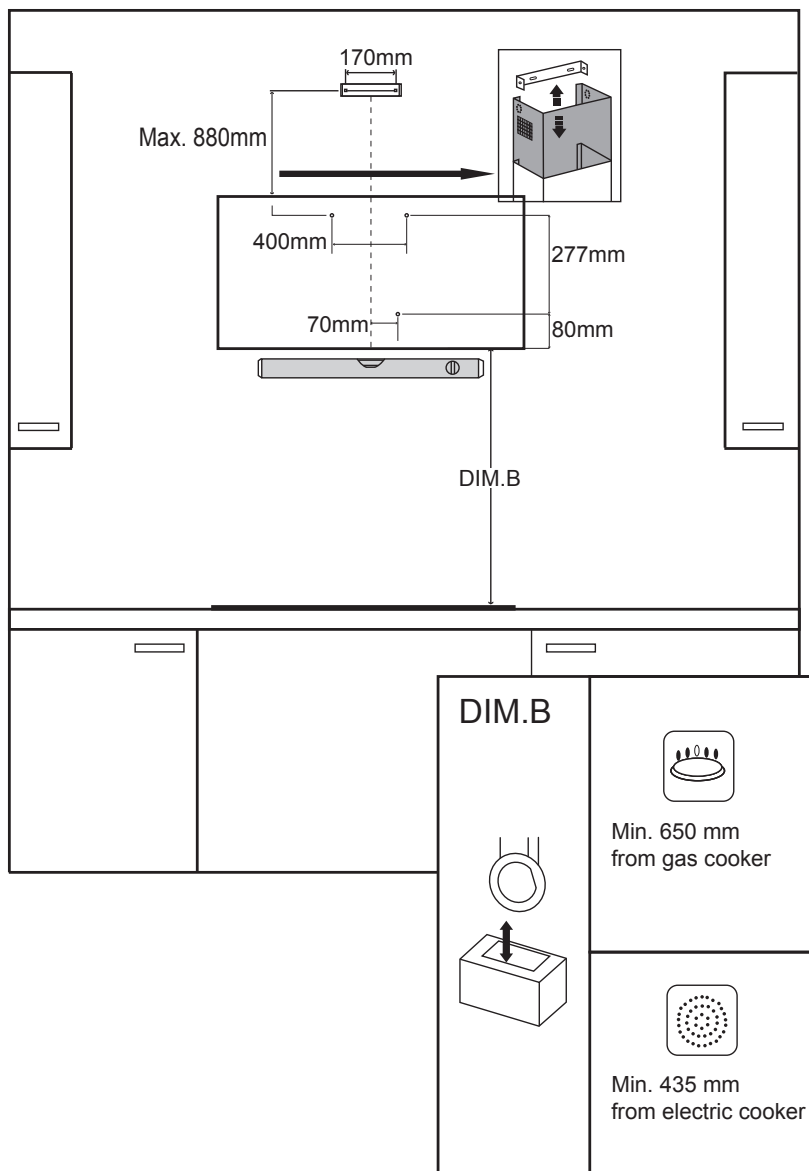

Mark the holes on the kitchen wall to fix the cooker hood.

The wall plugs supplied are suitable for solid walls only. When fixing to any other type of wall use suitable alternative fixings.

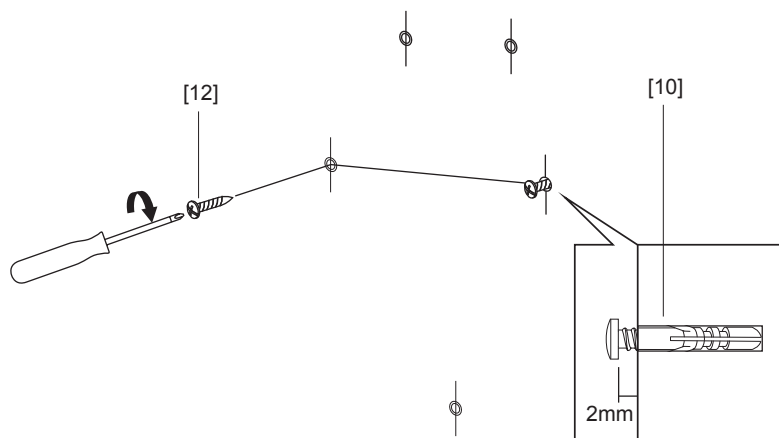

[10] x 5

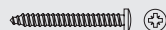

[12] x 2

Drill five holes, and then insert the wall plugs in all the holes. Now insert screws in the middle two holes.

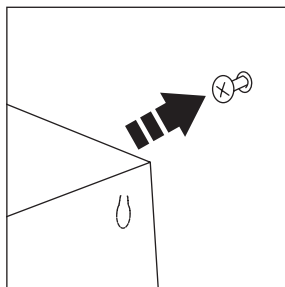
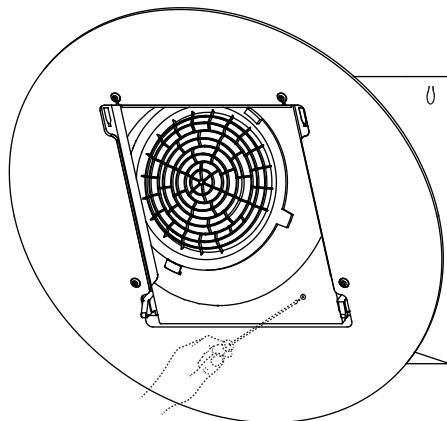

[12] x 1

Position the hood over the top two screws then insert the bottom screws from inside the hood, tighten screws to secure.

06



[05] x 1

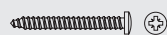

[12] x 2

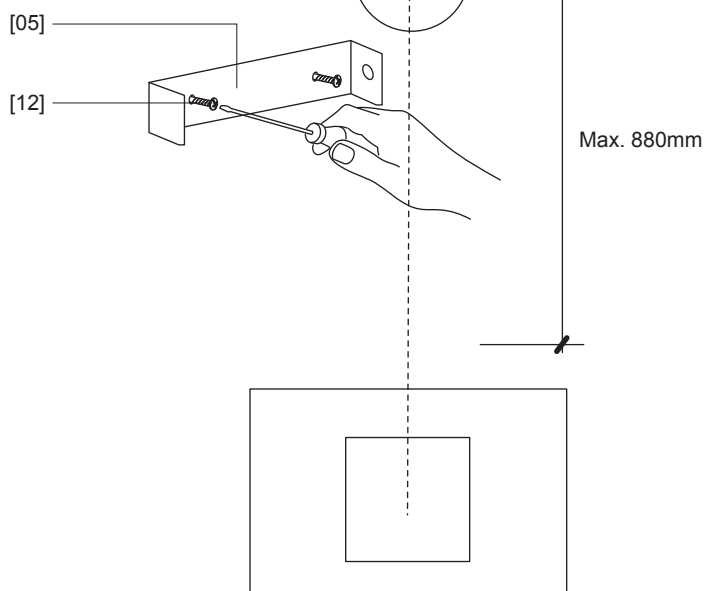

Fix the top bracket to the wall.

07

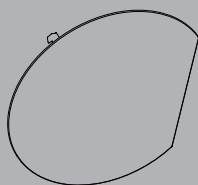

[03] x 1

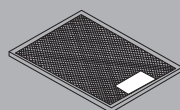

[07] x 1

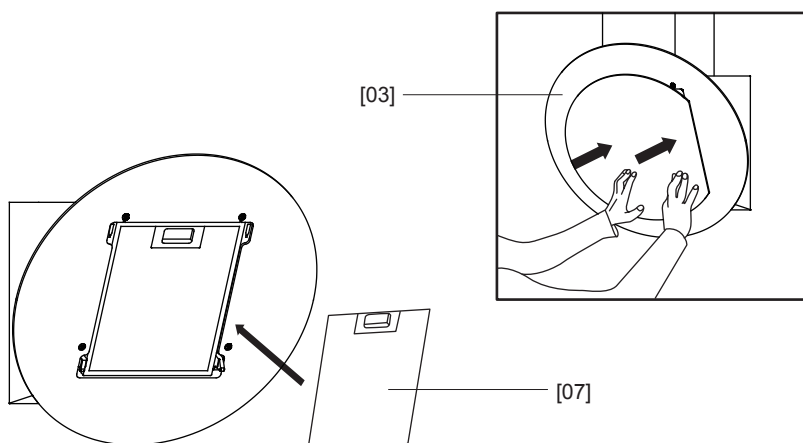

Replace the aluminium filter and fix front glass panel.

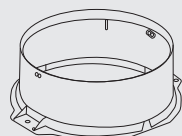
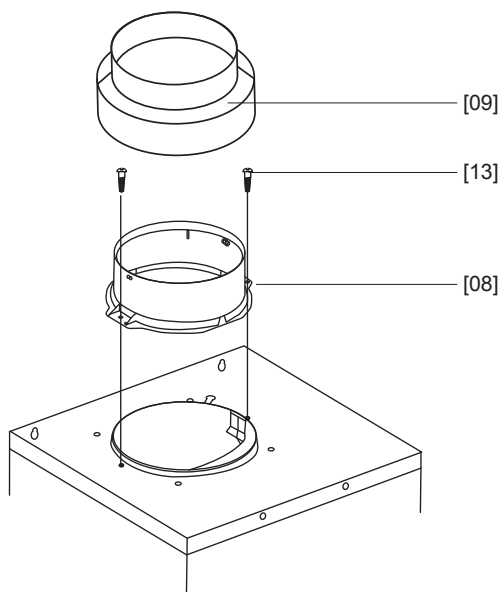

[08] x 1

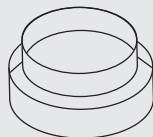

[09] x 1



[13] x 2

Fix the collar and the reducer if required.

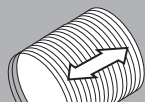
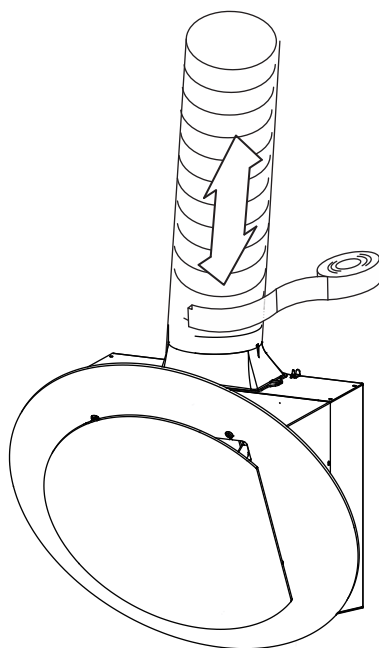

Ø125mm or Ø150mm
Vent Pack 2
(UK + IE)
x 1

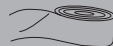

Fix the ducting tube Ø125mm or Ø150mm using tape or clamp.

10

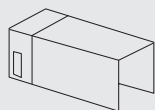

[04] x 2

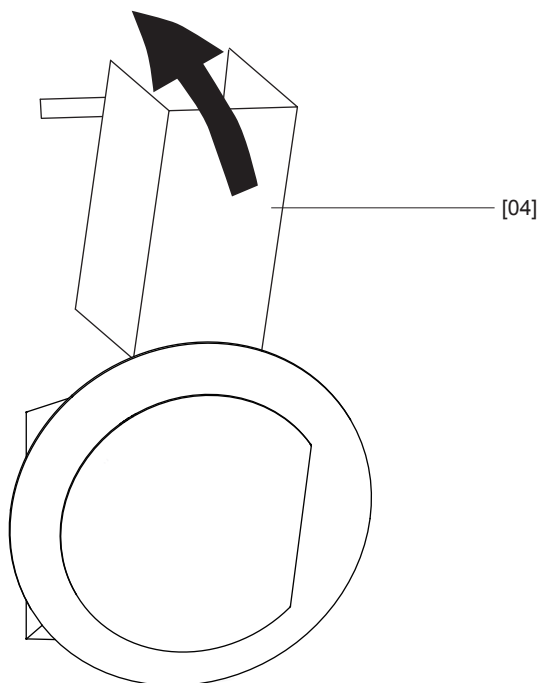

Fix to the wall the top bracket and place the decorative tubes.

11



[13] x 2

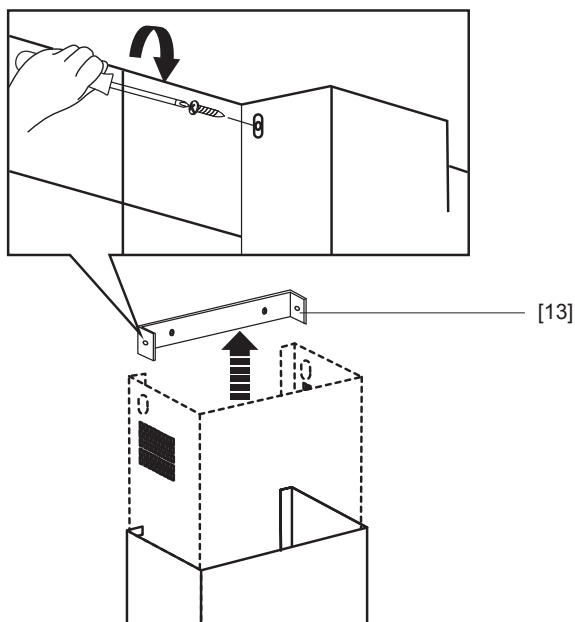

Fix the chimney to the top bracket using two screws. Connect top of the ducting tube to vent kit as per manufacturers instructions.

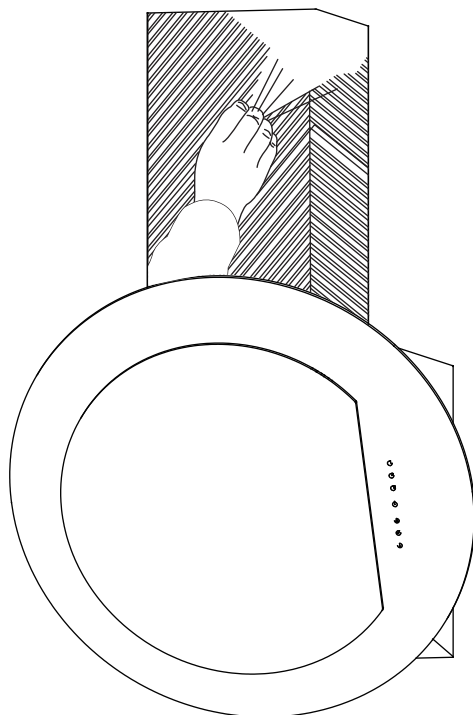

Remove the protection film.

For electrical connection see *Technical and legal information* section.

[illegible]