



Glass Gas Hob:UBGHD90GG

Version:00

Date:2014-05-23

UBGHD90GG Exploded drawing

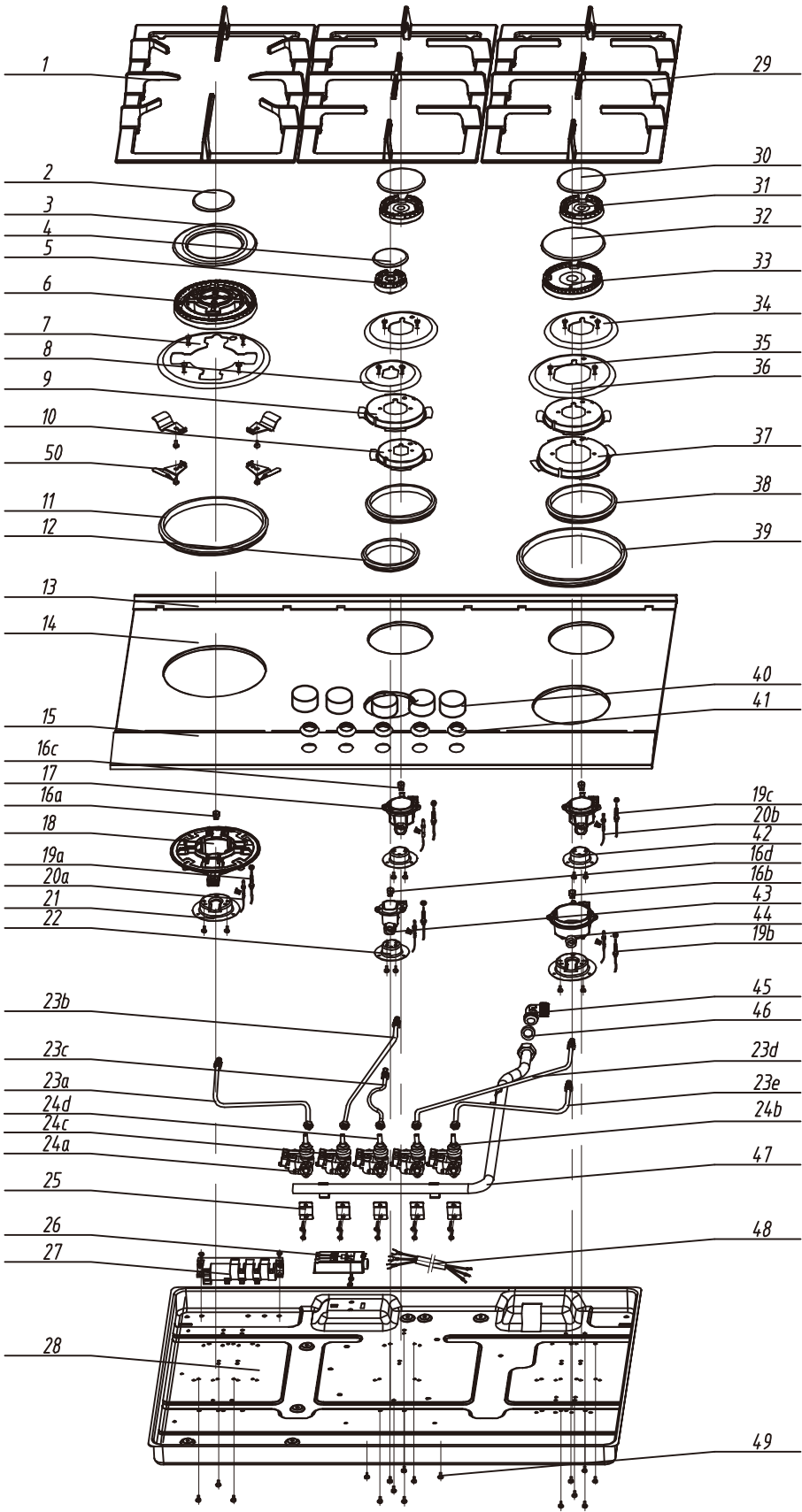

00	New document	Eason	2014. 5. 23
Index	Modify description	Modified by	Date

UBGHD90GG parts list

NO.	Part code	Part description	Quantity
.1	32248042	iron casting pan supporter	1
.2	32210009	inner burner cap- (Italy II)	1
.3	32211009	outer burner cap- (Italy II)	1
.4	32212009	auxiliary burner cap (Italy)	1
.5	32221001	auxiliary aluminum burner cap-(Italy)	1
.6	32220014	triple ring aluminium cap (Italy II)	1
.7	32233042	triple ring Vitreous enamel decorative circle-after enameling.	1
.8	32233045	auxiliary Vitreous enamel decorative circle-after enameling.	1
.9	32101036	locating ring for semid rapid burner	2
.10	32101037	locating ring for auxiliary burner	1
.11	32121007	waterproof ring for triple ring water pond	1
.12	32121009	waterproof ring for auxiliary water pond	1
.13	32257016	rear decorating plate for panel	1
.14	32171440	black glass panel	1
.15	32257015	front decorating plate for panel	1
.16a	32192051	328 nozzle	1
16b	32192010	medium nozzle	1
16c	32192006	328 semi rapid nozzle	2
16d	32192013	auxiliary nozzle	1
17	32202004	semid rapid burner (Italy)	2
18	32200005	triple ring burner (Italy)	1
19a	32312010	thermocouple	1
19b	32312005	thermocouple	2
19c	32312004	thermocouple	2
20a	32300015	procelain pin	1
20b	32300008	semi rapid spark pin	2
20c	32300006	semi rapid spark pin	1
21	32242003	triple ring tray	2
22	32242004	auxiliary tray	1
23a	32164252	aluminium pipe with safety device A-SABAF burner	1
23b	32164227	aluminium pipe with safety device B	1
23c	32164228	aluminium pipe with safety device C	1
23d	32164232	aluminium pipe with safety device D	1
23e	32164233	aluminium pipe with safety device E	1
24a	32113013	valve	1
24b	32113014	valve	1
24c	32113028	valve	2
24d	32113027	valve	1
25	32001012	hodler after electroplate	5
26	32311013	binding post	1
27	32304006	four hole impulse	1
28	32002071	Chassis panel	1
29	32248043	iron casting pan supporter	2
30	32213006	semid rapid burner cap (Italy)	2
31	32222003	semid rapid aluminium burner cap - (Italy)	2
32	32214006	medium rapid burner cap (Italy)	1
33	32223002	medium aluminium burner cap - (Italy)	1
34	32233044	auxiliary Vitreous enamel decorative circle-after enameling.	2
35	20106011	screw-inox	12
36	32233043	medium Vitreous enamel decorative circle-after enameling.	1
37	32101035	locating ring for medium burner	1
38	32121008	waterproof ring for semid rapid water pon	2
39	32121006	waterproof ring for medium water pon	1
40	32244031	K21 knob	5
41	32120003	waterproof ring for Switch	5
42	32242005	semid rapid tray	2
43	32201001	auxiliary burner- (Italy)	1
44	32203002	medium burner- (Italy)	1
45	32243006	air inlet elbow	1
46	32258016	sealing gasket	1
47	32160162	air inlet pipe-French elbow	1
48	32307004	power cord	1
49	20105004	self taping screw	7
50	32101034	locating plate for triple ring burner	4