

Induction Hob:UBTCC60MZ

Product reference code:UBTCC60MZ

Modified by:Eason

Modification:

00_2017.06.22 New document

01_2017.07.05 Update No.6 part number

02_2018.03.12 Replace No.9/25/26/27/28/29/30/31 part number

UBTCC60MZ Exploded drawing

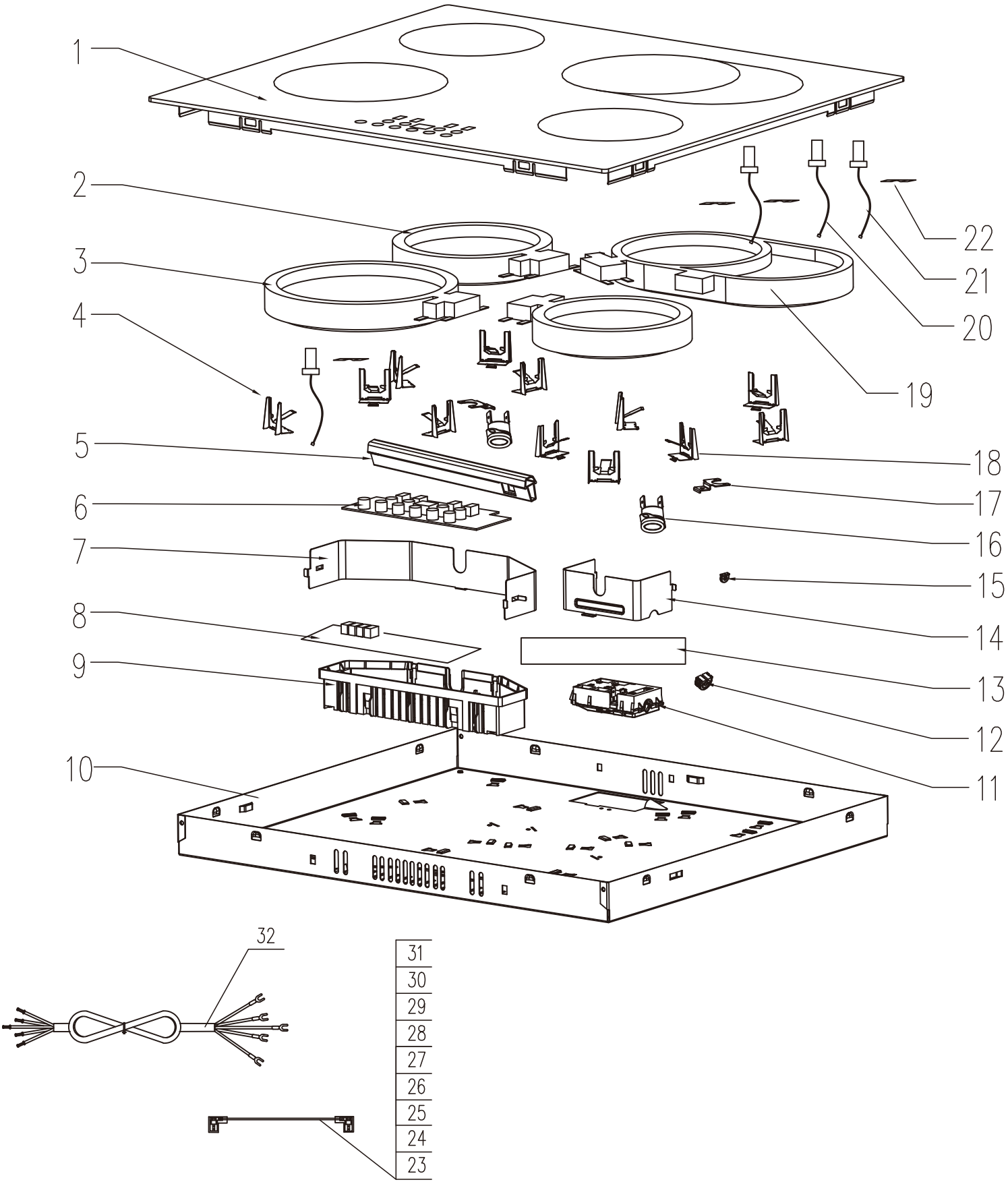

UBTCC60MZ parts list

No.	Part Code	Name	Qty	Remark
1	202010047	C6603R ceramic glass	1	
2	703040006	heating element 1200W	2	
3	703040008	heating element 2200W	1	
4	701050001	Spring bracket 01	7	
5	704010001	Adiabatic silicone strip	1	
6	602030020	Display board C6603R	1	
7	701010004	Adiabatic bracket 01	1	
8	602010005	Power board H03	1	
9	202030003	C60 PCB box	1	replace 702010003
10	701010003	C60 bottom case	1	
11	703030001	Terminal box assy 1	1	
12	704010002	Front Silicone sealed strip	1	
13	708020001	C60 insulation cotton	1	
14	701010005	Insulation cotton	1	
15	704010003	Back Silicone strip	1	
16	703090001	Thermostat	2	
17	701010008	Thermostat bracket	2	
18	701050002	Spring bracket 02	6	
19	703040009	heating element 2000W	1	
20	703080001	Thermocouple assy 1	2	
21	703080002	Thermocouple assy 2	2	
22	701010007	Thermocouple bracket	4	
23	703020002	Wires 2	1	
24	703020003	Wires 3	2	
25	202040005	Wire components 05	1	replace 703020006
26	202040006	Wire components 06	1	replace 703020007
27	202040007	Wire components 07	2	replace 703020008
28	202040008	Wire components 08	1	replace 703020010
29	202040009	Wire components 09	2	replace 703020011
30	202040010	Wire components 10	2	replace 703020014
31	202040013	Wire components 13	1	replace 703020016
32	703010002	5 cord cable	1	
Accessory bag				
	708010003	Installation fixture	1 set	
	708010008	Sealing strip	1	

UBTCC60MZ Wiring diagram

